

OFFICIAL DESCRIPTION CHANGE

OFFICE: Research and Analytics

EFFECTIVE DATE: 12-24-2002

ENTERED BY: Paul Mauer

ENTERED DATE: 1-14-2025

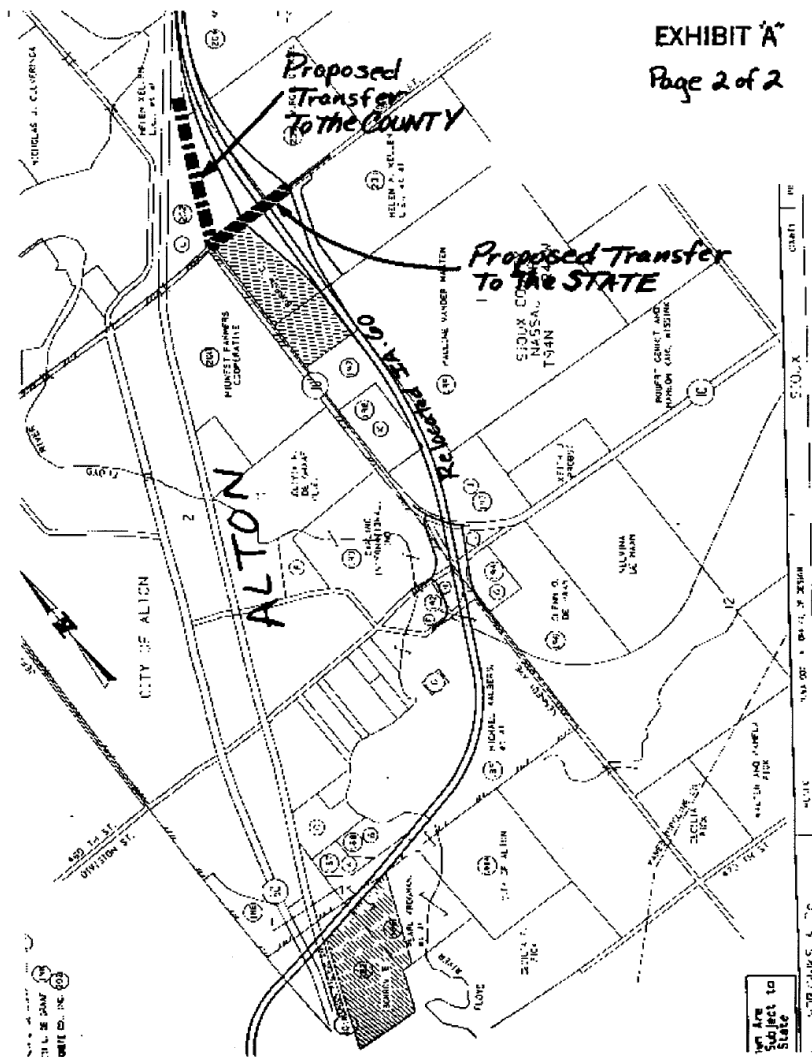

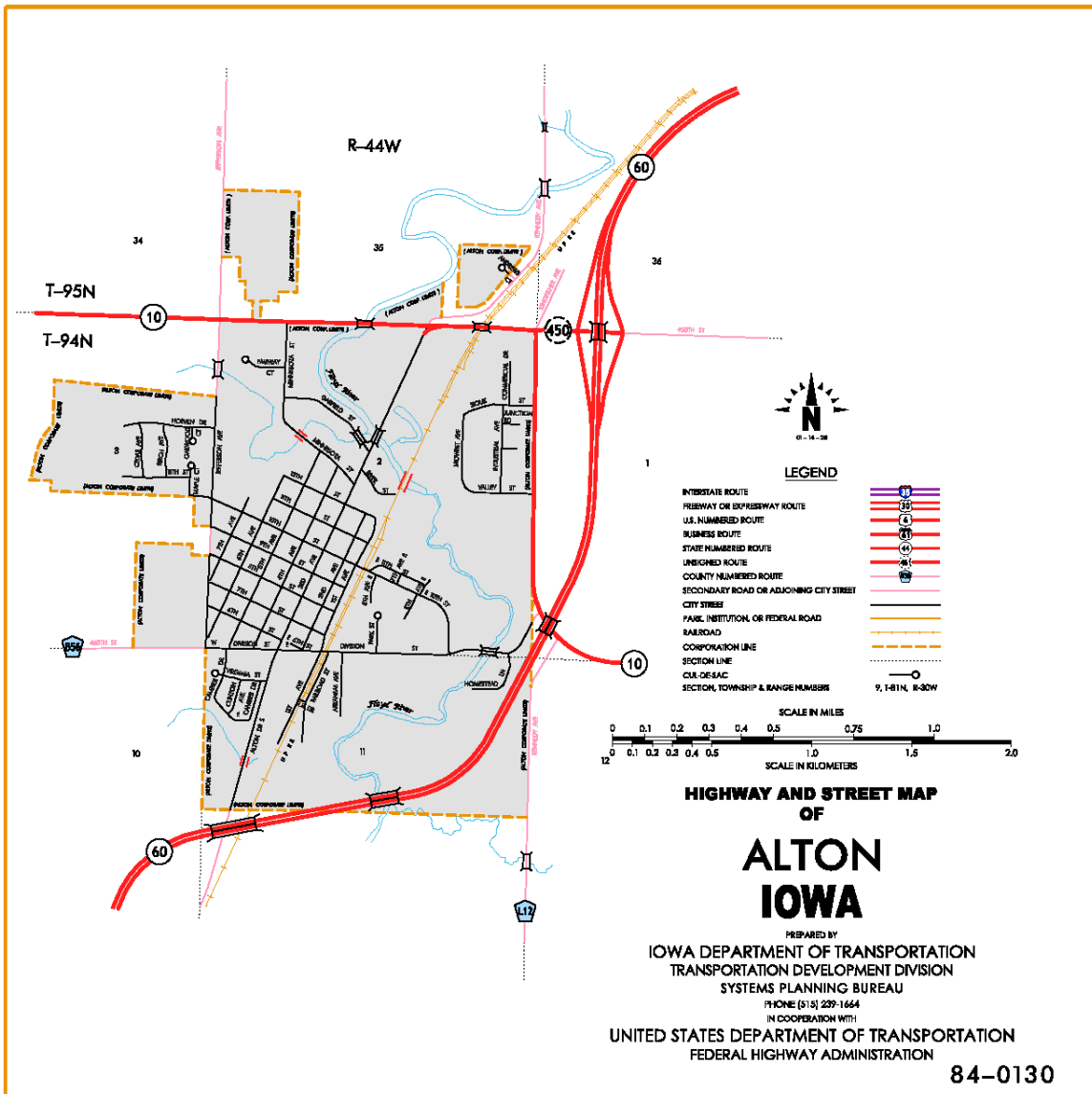

DISCUSSION/BACKGROUND:

Due to the relocation of Iowa 60, the portion of existing 450th Street in Sioux County was transferred over to the state in Agreement No. 2002-TJ-015 and designated as Iowa 450 to connect Iowa 10 to the relocated Iowa 60.

PROPOSAL/ACTION RECOMMENDATION:

New description – Unsigned Iowa 450 and its extension in Sioux County described as follows:

Beginning at the SW corner of Section 36–T95N–R44W near the northeast corporation line of Alton, connecting with 450th Street; thence east along the south boundary line of Section 36–T95N–R44W for approximately 1485 feet (0.28 miles) to the east Relocated Iowa 60 ramp bifurcation point.