

OFFICIAL DESCRIPTION CHANGE

OFFICE: Transportation Data

ENTERED BY: Stefani Wonders

ENTERED DATE: 09-14-2006

DISCUSSION/BACKGROUND:

Due to a review of our Primary System records, the primary route description for Interstate 29 in Harrison County was found to be in slight error and therefore was re-written.

PROPOSAL/ACTION RECOMMENDATION:

New Description – Interstate 29 and its extensions in Harrison County described as follows:

Beginning on the Harrison-Pottawattamie County line at a point approximately 2042 feet west of the SE Corner Section 33-T78N-R44W, Harrison County (NE Corner Section 4-T77N-R44W, Pottawattamie County); thence in a northwesterly direction to a point approximately 951 feet south of the NW Corner Section 33-T78N-R44W; thence continuing in a northwesterly and northerly direction through Section 32-T78N-R44W to a point near the NE Corner Section 32-T78N-R44W; thence in a northerly direction through Sections 29 and 20-T78N-R44W to a point near the NE Corner Section 20-T78N-R44W (junction US 30); thence in a northerly and northwesterly direction through Sections 17, 8, 5, and 6-T78N-R44W, Section 1-T78N-R45W, Sections 33, 32, 29, 30, and 19-T79N-R44W; thence continuing in a northwesterly and northerly direction through Sections 24, 13, 12, 1, and 2-T79N-R45W, Sections 35, 26, 23, 14, 11, and 2-T80N-R45W, and Sections 35, 26, 23, 22, 15, 16, 9, 4 and 5-T81N-R45W to the Harrison-Monona County line 1744 feet west and 224 feet south of the NE Corner Section 5-T81N-R45W, Harrison County.

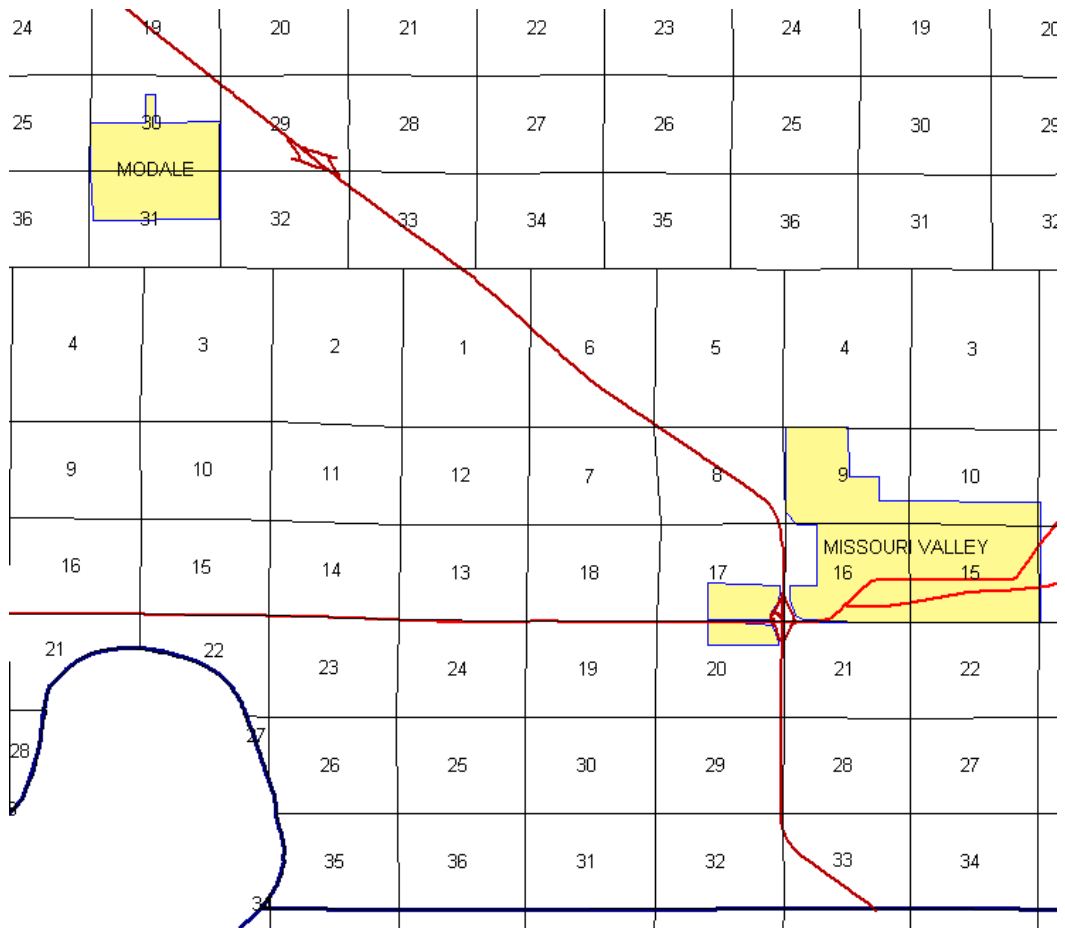

10	11	12	7	8
15	14	13	18	17
22	23	24	19	20
27	26	25	38	29
34	35	36	31	32
3	2	1	6	5
10	11	12	7	8
15	14	13	18	17
22	23	24	19	20
27	26	25	30	29

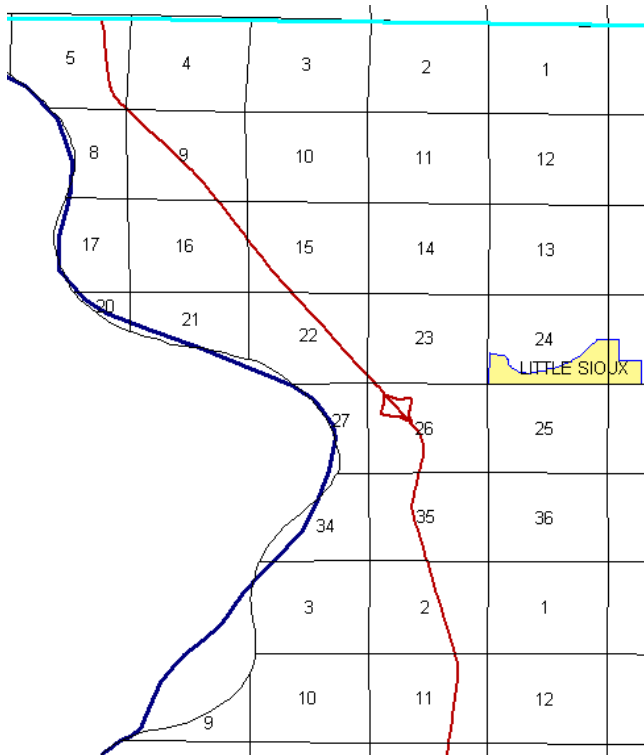

COMMISSION ORDER

DIVISION: Planning & Research

COMMISSION ORDER NUMBER: PR-79-272

SUBMITTED BY: C.I. MacGillivray

MEETING DATE: 11-2-78

DISCUSSION/BACKGROUND:

Due to a review of our Primary Road System Records Interstate 29 in Harrison County should be deleted and the new description added should be officially included into the Primary Road System.

Interstate 29 begins on the Harrison-Pottawattamie County line approximately 3 ½ miles south and 1 mile west of Missouri Valley, and

travels generally northwesterly to the Harrison–Monona County line approximately 2 miles east of the Missouri River.

PROPOSAL/ACTION RECOMMENDATION:

Locate Interstate 29 in Harrison County as follows:

Beginning on the Harrison–Pottawattamie County line at a point approximately 1400 feet west of the SE Corner Section 33–T78N–R44W Harrison County (NE Corner Section 4–T77N–R44W Pottawattamie County); thence in a northwesterly direction to a point approximately 700 feet south of the NW Corner Section 33–T78N–R44W; thence continuing in a northwesterly and northerly direction through Section 32–T78N–R44W to a point near the NE Corner Section 32–T78N–R44W; thence in a northerly direction through Sections 29 and 20–T78N–R44W to a point near the NE Corner Section 20–T78N–R44W (junction US 30); thence in a northerly direction through Section 17–T78N–R44W to a point near the NE Corner of Section 17–T78N–R44W; thence in a northwesterly direction through Sections 3, 5, and 6–T78N–R44W; thence continuing in a northwesterly direction through Section 1–T78N–R45W and Sections 33, 32, 29, 30, and 19–T79N–R44W; thence continuing in a northwesterly direction through Sections 24, 13, 12, and 1–T79N–R45W to a point near the W $\frac{1}{4}$ Corner Section 1–T79N–R45W; thence in a northerly direction through Section 2–T79N–R45W and Sections 35, 26, 23, 14 and 11–T80N–R45W; thence in a northerly, northwesterly and northerly direction through Sections 2–T80N–R45W and Sections 35, 26, 23, 22, 15, 16, 9, 4 and 5–T81N–R45W to the Harrison–Monona County line near the NE Corner Section 5–T81N–R45W.

NOW, THEREFORE: Be it resolved that the Iowa Department of Transportation approve the location of Interstate 29, Harrison County, Iowa.

NOTE: To become effective upon the adoption of this resolution.

OFFICIAL DESCRIPTION CHANGE**COUNTY:** Harrison**ROUTE:** Interstate 29**APPROVAL DATE:** 12-7-66

Beginning on the Harrison-Pottawattamie County line at a point approximately 1400 feet west of the SE Corner Section 33-T78N-R44W Harrison County (NE Corner Section 4-T77N-R44W Pottawattamie County); thence in a northwesterly direction to a point approximately 700 feet south of the NW Corner Section 33-T78N-R44W; thence continuing in a northwesterly and northerly direction thru Section 32-T78N-R44W to a point 45 feet west of the NE Corner Section 32-T78N-R44W; thence in a northerly direction thru Sections 29 and 20-T78N-R44W to a point near the NE Corner Section 20-T78N-R44W; thence in a northerly direction to a point near the NE Corner Section 17-T78N-R44W; thence in a northwesterly direction through Sections 8, 5, and 6-T78N-R44W; thence continuing in a northwesterly direction through Section 1-T78N-R45W and Sections 33, 32, 29, 30, and 19-T79N-R44W; thence continuing in a northwesterly direction through Sections 24, 13, 12, and 1-T79N-R45W to a point near the SW Corner NW ¼ Section 1-T79N-R45W; thence in a northerly direction through Section 2-T79N-R45W and Sections 35, 26, 23, 14, and 11-T80N-R45W; thence in a northerly, northwesterly and northerly direction through Sections 2, 35, 26, 23, 22, 15, 16, 9, and 5-T81N-R45W to the Monona County line near the NE Corner Section 5-T81N-R45W.