

OFFICIAL DESCRIPTION CHANGE

OFFICE: Research and Analytics

EFFECTIVE DATE: 10-2-2019

COUNTY: Story

ROUTE: Interstate 35

ENTERED BY: Paul Mauer

ENTERED DATE: 12-23-2019

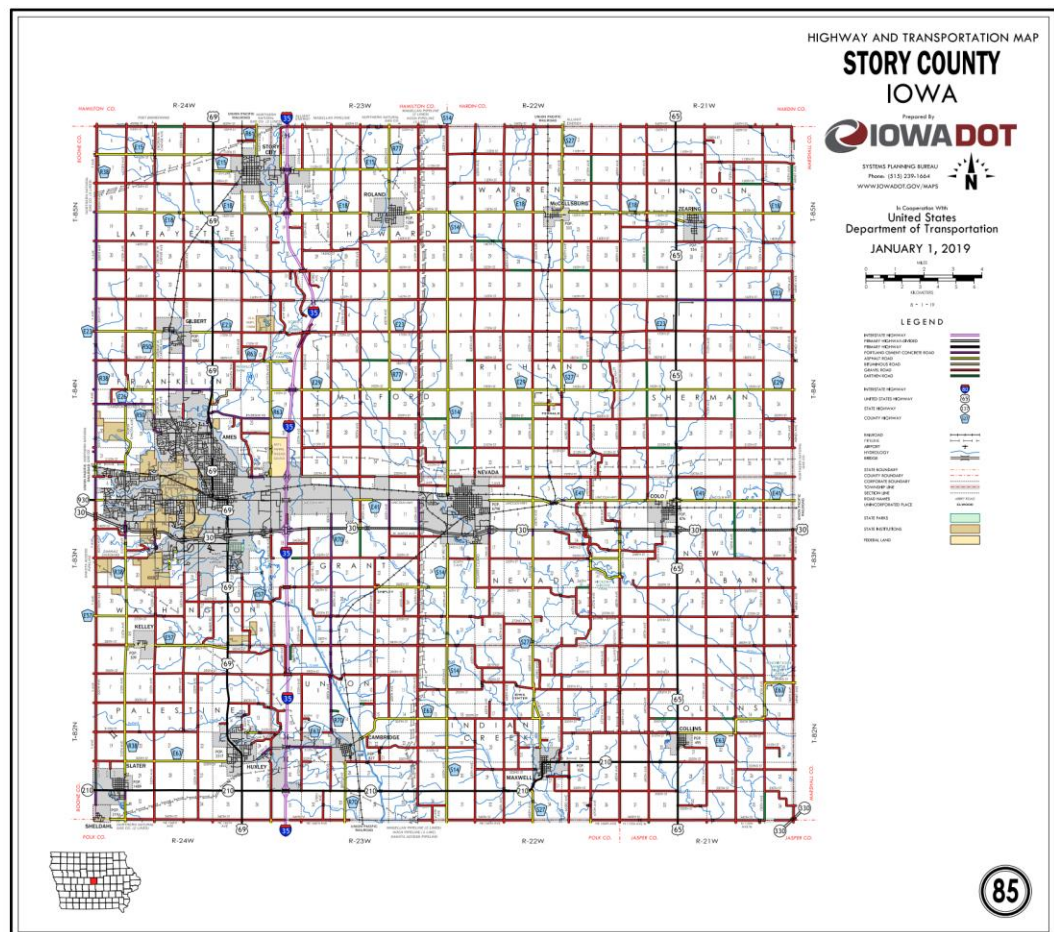

New Description – Interstate 35 and its extensions in Story County described as follows:

Beginning on the Story-Polk County line at a point near the S $\frac{1}{4}$ Corner Section 31-T82N-R23W, Story County (N $\frac{1}{4}$ Corner Section 6-T81N-R23W, Polk County); thence northerly through Section 31-T82N-R23W (junction Iowa 210)

to the south corporation line of Huxley at a point near the N ¼ Corner of said Section 31.

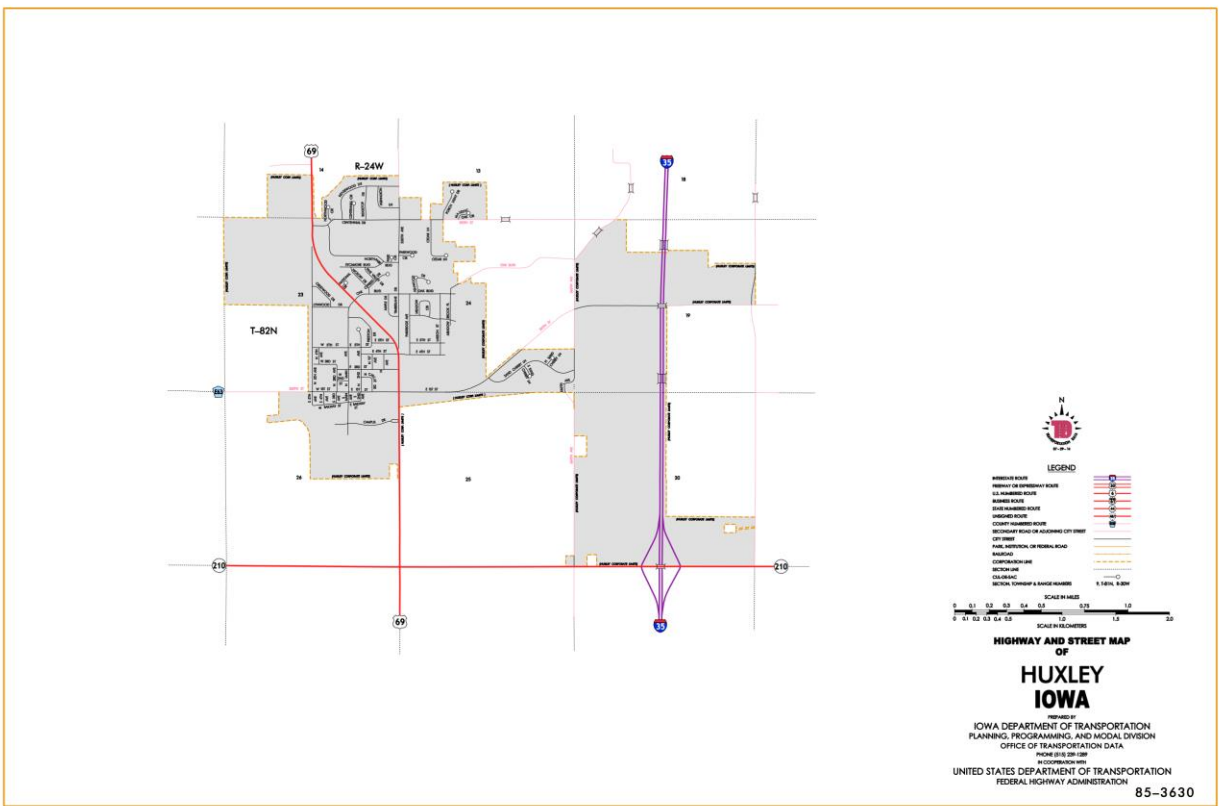

Huxley:

Beginning on an unnamed street at the south corporation line; thence northerly to the north corporation line.

Beginning again on the north corporation line of Huxley; thence northerly through Sections 19, 18, 7 and 6-T82N-R23W, Sections 31, 30, 19, 18 (junction US 30), and 7-T83N-R23W to the south corporation line of Ames.

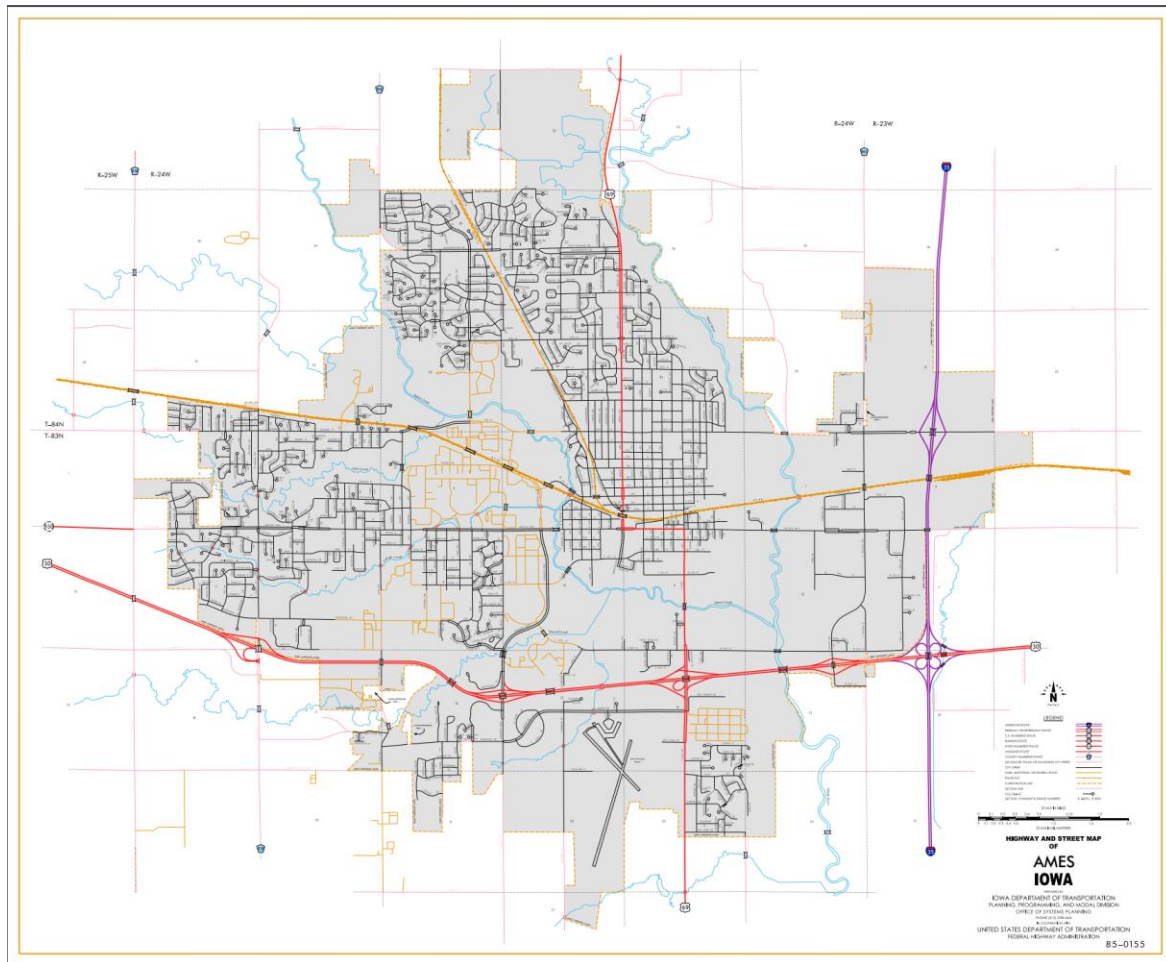

Ames:

Beginning at the south corporation line; thence northerly to the north corporation line (approximately 537 feet east of the Center Section 31-T84N-R23W).

Beginning again on the north corporation line of Ames; thence northerly and northeasterly through Sections 31, 30, 19, 18, 7, 8 and 5-T84N-R23W to a point near the Center Section 5-T84N-R23W; thence in a northwesterly direction through Section 5-T84N-R23W and Sections 32, 29 and 30-T85N-R23W to a point near the N ¼ Corner of Section 30-T85N-R23W; thence northerly through Sections 19, 18, 7 and 6-T85N-R23W to the Story-Hamilton County line near the N ¼ Corner Section 6-T85N-R23W, Story County (S ¼ Corner Section 31-T86N-R23W, Hamilton County).

OFFICIAL DESCRIPTION CHANGE

OFFICE: Transportation Data

ENTERED BY: Stefani Wonders

ENTERED DATE: 09-18-2006

DISCUSSION/BACKGROUND:

Due to a review of our Primary System records, the primary route description for Interstate 35 in Story County was revised.

PROPOSAL/ACTION RECOMMENDATION:

New Description – Interstate 35 and its extensions in Story County described as follows:

Beginning on the Story-Polk County line at a point near the S $\frac{1}{4}$ Corner Section 31-T82N-R23W, Story County (N $\frac{1}{4}$ Corner Section 6-T81N-R23W, Polk County); thence northerly through Section 31-T82N-R23W to the south corporation line of Huxley connecting with an unnamed street (point near the N $\frac{1}{4}$ Corner of said Section 31).

Huxley:

Beginning on an unnamed street at the south corporation line; thence northerly to the north corporation line (point near the Center Section 30-T82N-R23W).

Beginning again on the north corporation line of Huxley connecting with an unnamed street; thence northerly on said unnamed street through Sections 30 and 19-T82N-R23W to the south corporation line of Huxley connecting with an unnamed street (approximately 372 feet north of the S $\frac{1}{4}$ Corner of said Section 19).

Huxley:

Beginning on an unnamed street at the south corporation line; thence northerly on said unnamed street to the north corporation line (approximately 529 feet north of the S $\frac{1}{4}$ Corner of said Section 19).

Beginning again on the north corporation line of Huxley connecting with an unnamed street; thence northerly through Sections 19, 18, 7 and 6-T82N-R23W, Sections 31, 30, 19, 18, and 7-T83N-R23W to the south corporation line of Ames connecting with an unnamed street (point near the N $\frac{1}{4}$ Corner of said Section 7).

Ames:

Beginning on the south corporation line of Ames connecting with an unnamed street; thence northerly on said unnamed street to the north corporation line (approximately 537 feet east of the Center Section 31-T84N-R23W).

Beginning again on the north corporation line of Ames connecting with an unnamed street; thence northerly and northeasterly through Sections 31, 30, 19, 18, 7, 8 and 5-T84N-R23W to a point near the Center Section 5-T84N-R23W; thence in a northwesterly direction through Section 5-T84N-R23W and Sections 32, 29 and 30-T85N-R23W to a point near the N $\frac{1}{4}$ Corner of Section 30-T85N-R23W; thence northerly through Sections 19, 18, 7 and 6-T85N-R23W to the Story-Hamilton County line near the N $\frac{1}{4}$ Corner Section 6-T85N-R23W, Story County (S $\frac{1}{4}$ Corner Section 31-T86N-R23W, Hamilton County).

24	19	20	21
25	30	29	28
36	31	32	33
1	6	5	4
12	7	8	9
13	18	17	16
24	19	20	21
25	30	29	28
36	31	32	33

New Description – Interstate 35 and its extension in Story County described as follows:

Beginning on the Story-Polk County line at a point approximately 98 feet west of the S $\frac{1}{4}$ Corner Section 31-T82N-R23W, Story County (N $\frac{1}{4}$ Corner Section 6-T81N-R23W, Polk County); thence north following substantially the quarter section line through Section 31-T82N-R23W to a point approximately 95 feet west of the N $\frac{1}{4}$ Corner Section 31-T82N-R23W; thence north, northeast and north following substantially the quarter section line through Sections 30, 19, 18, 7 and 6-T82N-R23W to a point approximately 156 feet east of the N $\frac{1}{4}$ Corner Section 6-T82N-R23W; thence north following substantially the quarter section line through Sections 31, 30, 19 and 18-T83N-R23W to a point approximately 270 feet south and 190 feet west of the N $\frac{1}{4}$ Corner Section 18-T83N-R23W (junction US 30); thence north following substantially the quarter section line through Section 18 and 7-T83N-R23W to a point on the south corporation line of Ames, connecting with an unnamed street.

Ames:

Beginning on the south corporation line of Ames connecting with an unnamed street; thence north on said unnamed street to the north corporation line.

Beginning again on the north corporation line of Ames, connecting with an unnamed street; thence north following substantially the quarter section line through Section 6-T83N-R23W and Sections 31, 30, 19, 18 and 7-T84N-R23W to a point near the S $\frac{1}{4}$ Corner of Section 7-T84N-R23W; thence in a northeasterly direction through Sections 7, 8 and 5-T84N-R23W to a point near the center of Section 5-T84N-R23W; thence in a northwesterly direction through Section 5-T84N-R23W and Sections 32, 29 and 30-T85N-R23W to a point near the N $\frac{1}{4}$ Corner of Section 30-T85N-R23W; thence north following substantially the quarter section line through Sections 19, 18, 7 and 6-T85N-R23W to the Story-Hamilton County line near the N $\frac{1}{4}$ Corner Section 6-T85N-R23W, Story County (S $\frac{1}{4}$ Corner Section 31-T86N-R23W, Hamilton County).

COMMISSION ORDER

DIVISION: Planning & Research

COMMISSION ORDER NUMBER: PR-79-272

SUBMITTED BY: C.I. MacGillivray

MEETING DATE: 11-2-78

DISCUSSION/BACKGROUND:

Due to a review of our Primary interstate System Records Interstate 35 in Story County should be officially included into the Primary Interstate System.

PROPOSAL/ACTION RECOMMENDATION:

It is recommended that the description of Interstate 35 in Story County, as referred in the attached detailed description, be included in the Primary Interstate System effective upon the adoption of this resolution.

Locate Interstate 35 and its extension in Story County as follows:

Beginning on the Story-Polk County line at a point approximately 98 feet west of the S $\frac{1}{4}$ Corner Section 31-T82N-R23W, Story County (N $\frac{1}{4}$ Corner Section 6-T81N-R23W, Polk County); thence northerly following substantially the quarter section line through Section 31-T82N-R23W to a point approximately 95 feet west of the N $\frac{1}{4}$ Corner Section 31-T82N-R23W; thence northerly, northeasterly and northerly following substantially the quarter section line through Sections 30, 19, 18, 7 and 6-T82N-R23W to a point approximately 156 feet east of the N $\frac{1}{4}$ Corner Section 6-T82N-R23W; thence northerly following substantially the quarter section line through Sections 31, 30, 19 and 18-T83N-R23W to a point approximately 270 feet south and 190 feet west of the N $\frac{1}{4}$ Corner Section 18-T83N-R23W (junction US 30); thence northerly following substantially the quarter section line through Section 18 and 7-T83N-R23W to a point on the south corporation line of the City of Ames connecting with an unnamed street.

Ames:

Beginning on the south corporation line of the City of Ames connecting with an unnamed street; thence in a northerly direction on said unnamed street to the north corporation line.

Beginning again on the north corporation line of the City of Ames, connecting with an unnamed street, thence in a northerly direction following substantially the quarter section line through Section 6-T83N-R23W and Sections 31, 30, 19, 18 and 7-T84N-R23W to a point near the S $\frac{1}{4}$ Corner of Section 7-T84N-R23W; thence in a northeasterly direction through Sections 7, 8, and 5-T84N-R23W to a point near the center of Section 5-T84N-R23W; thence in a northwesterly direction through Section 5-T84N-R23W and Sections 32, 29 and 30-T85N-R23W to a point near the N $\frac{1}{4}$ Corner of Section 30-T85N-R23W; thence in a northerly direction following substantially the quarter section line

through Sections 19, 18, 7 and 6-T85N-R23W to the Story-Hamilton County line near the N $\frac{1}{4}$ Corner Section 6-T85N-R23W Story County (S $\frac{1}{4}$ Corner Section 31-T86N-R23W, Hamilton County).

OFFICIAL DESCRIPTION CHANGE

County: Story

ROUTE: Interstate 35

APPROVAL DATE: 12-7-66

Beginning on the Story-Polk County line at a point approximately 98 feet west of the S $\frac{1}{4}$ Corner Section 31-T82N-R23W, Story County (N $\frac{1}{4}$ Corner Section 6-T81N-R23W, Polk County); thence northerly following substantially the quarter section line through Section 31-T82N-R23W to a point approximately 95 feet west of the N $\frac{1}{4}$ Corner Section 31-T82N-R23W; thence northerly, northeasterly and northerly following substantially the quarter section line through Sections 30, 19, 18, 7 and 6-T82N-R23W to a point approximately 156 feet east of the N $\frac{1}{4}$ Corner Section 6-T82N-R23W; thence northerly following substantially the quarter section line through Sections 31, 30, 19 and 18-T83N-R23W to a point approximately 270 feet south and 190 feet west of the N $\frac{1}{4}$ Corner Section 18-T83N-R23W; thence northerly following substantially the quarter section line through Section 18 and 7-T83N-R23W to a point on the south corporation line of the City of Ames connecting with an unnamed street.

Beginning again on the north corporation line of the City of Ames, connecting with an unnamed street, thence in a northerly direction following substantially the quarter section line through Section 6--T83N-R23W and Sections 31, 30, 19, 18 and 7-T84N-R23W to a point near the S $\frac{1}{4}$ Corner of Section 7-T84N-R23W; thence in a northeasterly direction through Sections 7, 8, and 5-T84N-R23W to a point near the center of Section 5-T84N-R23W; thence in a northwesterly direction

through Section 5-T84N-R23W and Sections 32, 29, 30-T85N-R23W to a point near the N ¼ Corner of Section 30-T85N-R23W; thence in a northerly direction following substantially the quarter section line through Sections 19, 18, 7 and 6-T85N-R23W to the Story-Hamilton County line near the N ¼ Corner Section 6-T85N-R23W Story County (S ¼ Corner Section 31-T86N-R23W Hamilton County).

OFFICIAL DESCRIPTION CHANGE

County: Story

CITY OF: Ames

ROUTE: Interstate 35

APPROVAL DATE: 12-7-66

Beginning on the south corporation line of the City of Ames connecting with an unnamed street; thence in a northerly direction on said unnamed street to the north corporation line.

Adopted: 12-7-66

RESOLUTION adding to the Primary Interstate System and Federal Aid Interstate System and providing a description of the same.

Interstate 35

BE IT RESOLVED by the Iowa State Highway Commission that the following described road in Story County be added to the Primary Interstate Road System and Federal Aid Interstate Road System.

Beginning at a point near the N ¼ Corner of Section 7-T83N-R23W; thence in a northerly direction following substantially the quarter section line through Section 6-T83N-R23W and Sections 31, 30, 19, 18 and 7-T84N-R23W to a point near the S ¼ Corner of Section 7-T84N-R23W;

thence in a northeasterly direction through Sections 7, 8, and 5-T84N-R23W to a point near the center of Section 5-T84N-R23W; thence in a northwesterly direction through Section 5-T84N-R23W and Sections 32, 29, 30-T85N-R23W to a point near the N $\frac{1}{4}$ Corner of Section 30-T85N-R23W; thence in a northerly direction following substantially the quarter section line through Sections 19, 18, 7, and 6-T85N-R23W to the Story-Hamilton County line near the N $\frac{1}{4}$ Corner Section 6-T85N-R23W Story County (S $\frac{1}{4}$ Corner Section 31-T86N-R23W Hamilton County).

Access Control Classification:

This section of road upon completion and opening to traffic will be a Class I Road.

BE IT FURTHER RESOLVED that the attached description of Interstate 35 and Federal Aid Interstate Road in Story County be adopted, and shall become effective on passage of this resolution.