

OFFICIAL DESCRIPTION CHANGE**OFFICE:** Transportation Data**ENTERED BY:** Stefani Wonders**ENTERED DATE:** 09-13-2006**DISCUSSION/BACKGROUND:**

Due to a review of our Primary System records, the primary route description for Interstate 35 in Decatur County was found to be in slight error and therefore was re-written.

PROPOSAL/ACTION RECOMMENDATION:

New Description – Interstate 35 and its extensions in Decatur County described as follows:

Beginning on the Iowa-Missouri State line at a point near the SW Corner of Section 26-T67N-R27W, Decatur County; thence in a northeasterly direction through Sections 26, 23, 24, 13, and 12-T67N-R27W, Sections 7 (junction US 69), 6, and 5-T67N-R26W, and Sections 32, 33, 28, 21, and 16 to a point near the NE Corner of Section 16-T68N-R26W; thence northerly through Sections 9 and 4-T68N-R26W and Section 34-T69N-R26W (junction Iowa 2) to a point near the NW Corner of Section 34-T69N-R26W; thence in a northeasterly, northerly, and northeasterly direction through Sections 27, 22, 15, 10, and 3-T69N-R26W and Sections 34, 35, 26, 23, 24, 13, 12, and 1-T70N--R26W to the Decatur-Clarke County line at a point near the N ¼ Corner of

Section 1–T70N–R26W, Decatur County (S $\frac{1}{4}$ Corner of Section
36–T71N–R26W, Clarke County).

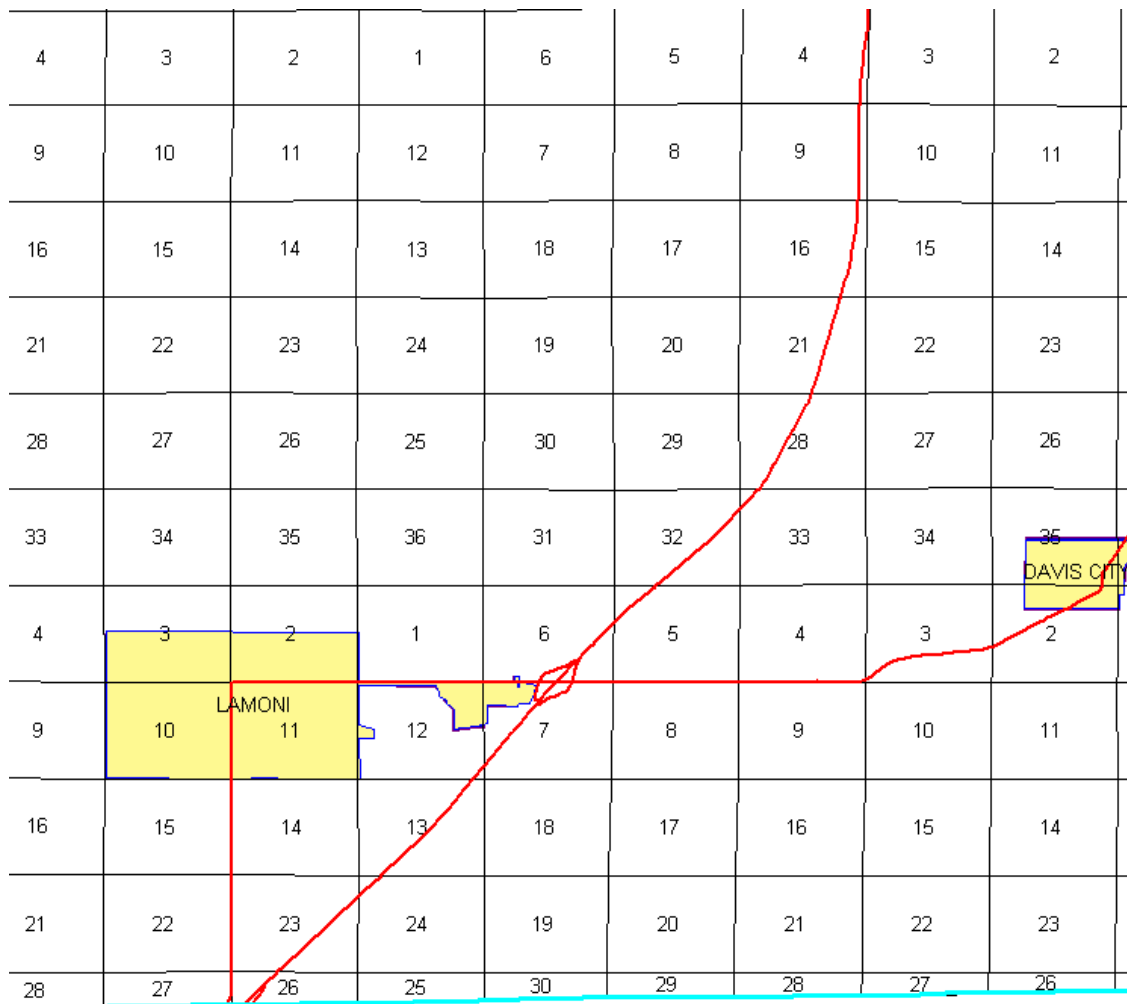

6	5	4	3	2	1	6
7	8	9	10	11	12	7
18	17	16	15	14	13	18
19	20	21	22	23	24	19
30	29	28	27	26	25	30
31	32	33	34	35	36	31
6	5	4	3	2	1	6
7	8	9	10	11	12	7
18	17	16	15	14	13	18
19	20	21	22	23	24	19
30	29	28	27	26	25	30
31	32	33	34	35	36	31
6	5	4	3	2	1	6
7	8	9	10	11	12	7
18	17	16	15	14	13	18
19	20	21	22	23	24	19
30	29	28	27	26	25	30
31	32	33	34	35	36	31
6	5	4	3	2	1	6

COMMISSION ORDER

DIVISION: Planning & Research

COMMISSION ORDER NUMBER: PR-79-272

SUBMITTED BY: C.I. MacGillivray

MEETING DATE: 11-2-78

DISCUSSION/BACKGROUND:

Due to a review of our Primary Road System Records, Interstate 35 in Decatur County should be deleted and the new description added should be officially included into the Primary Road System.

PROPOSAL/ACTION RECOMMENDATION:

It is recommended that the old description of Interstate 35 in Decatur County be deleted and the new description, as referred in the attached detailed description, be included in the Primary Road System effective upon the adoption of this resolution.

Locate Interstate 35 in Decatur County as follows:

Beginning on the Iowa–Missouri State line at a point near the SW Corner of Section 26–T67N–R27W, Decatur County; thence in a northeasterly direction through Sections 26, 23, 24, 13, and 12–T67N–R27W and Sections 7 (junction US 69), 6, and 5–T67N–R26W; thence continuing northeasterly through Sections 32, 33, 28, 21, and 16 to a point near the NE Corner of Section 16–T68N–R26W; thence northerly approximately on the section line through Sections 9, 4, and 3–T68N–R26W and Section 34–T69N–R26W, (junction Iowa 2) to a point near the NW Corner of Section 34–T69N–R26W; thence in a northeasterly, northerly, and northeasterly direction through Sections 27, 22, 15, 10, and 3–T69N–R26W and Sections 34, 35, 26, 23, 24, 13, 12, and 1–T70N–R26W to the Decatur–Clarke County line at a point near the N $\frac{1}{4}$ Corner of Section 1–T70N–R26W, Decatur County (S $\frac{1}{4}$ Corner of Section 36–T71N–R26W, Clarke County).

COMMISSION RESOLUTION

DIVISION: Planning & Research

COMMISSION ORDER NUMBER: 74–778

SUBMITTED BY: Gene R. Mills

MEETING DATE: 6-26-74

Locate Interstate 35 in Decatur County as follows:

Beginning on the Iowa-Missouri State Line at a point near the SW Corner of Section 26-T67N-R27W, Decatur County; thence in a northeasterly direction through Sections 26, 23, 24, 13 and 12-T67N-R27W and Sections 18, 7, 6 and 5-T67N-R26W; thence continuing northeasterly through Sections 32, 33, 28, 21 and 16 to a point near the NE Corner of Section 16-T68N-R26W; thence northerly approximately on the section line through Sections 9, 10, 4 and 3-T68N-R26W and Sections 33 and 34-T69N-R26W to a point near the NW Corner of Section 34-T69N--R26W; thence in a northeasterly, northerly, and northeasterly direction through Sections 27, 22, 15, 10 and 3-T69N-R26W and Sections 34, 35, 26, 23, 24, 13, 12 and 1-T70N-R26W to the Decatur-Clarke County line at a point near the N $\frac{1}{4}$ Corner of Section 1-T70N-R26W, Decatur County (S $\frac{1}{4}$ Corner of Section 36-T71N-R26W Clarke County).

NOW, THEREFORE: Be it resolved that the Iowa State Highway Commission approve the location of Interstate 35 in Decatur County, Iowa.

REVISED: 1978