

OFFICIAL DESCRIPTION CHANGE

OFFICE: Research and Analytics

EFFECTIVE DATE: 8-19-2019

COUNTY: Pottawattamie

ROUTE: Interstate 80

ENTERED BY: Paul Mauer

ENTERED DATE: 12-20-2019

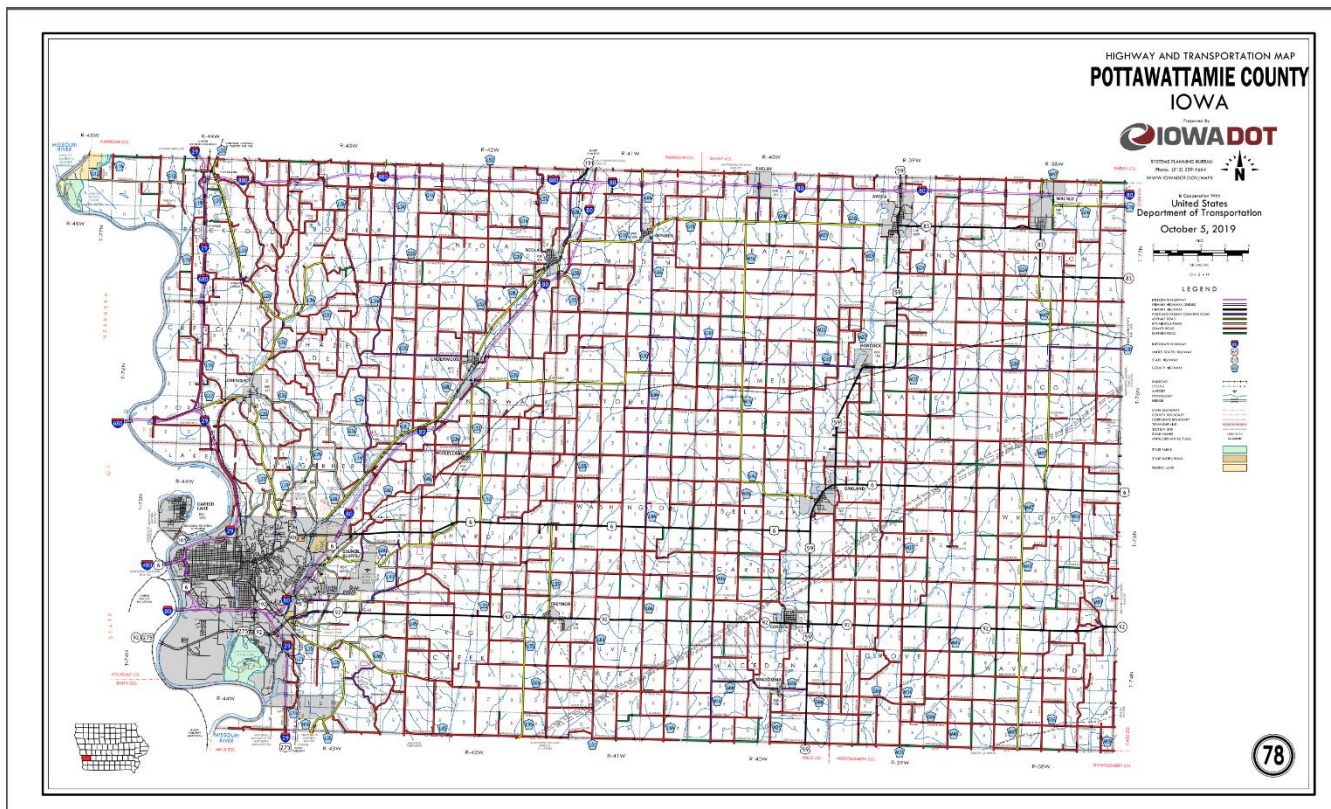

New Description – Interstate 80 and its extensions in Pottawattamie County described as follows:

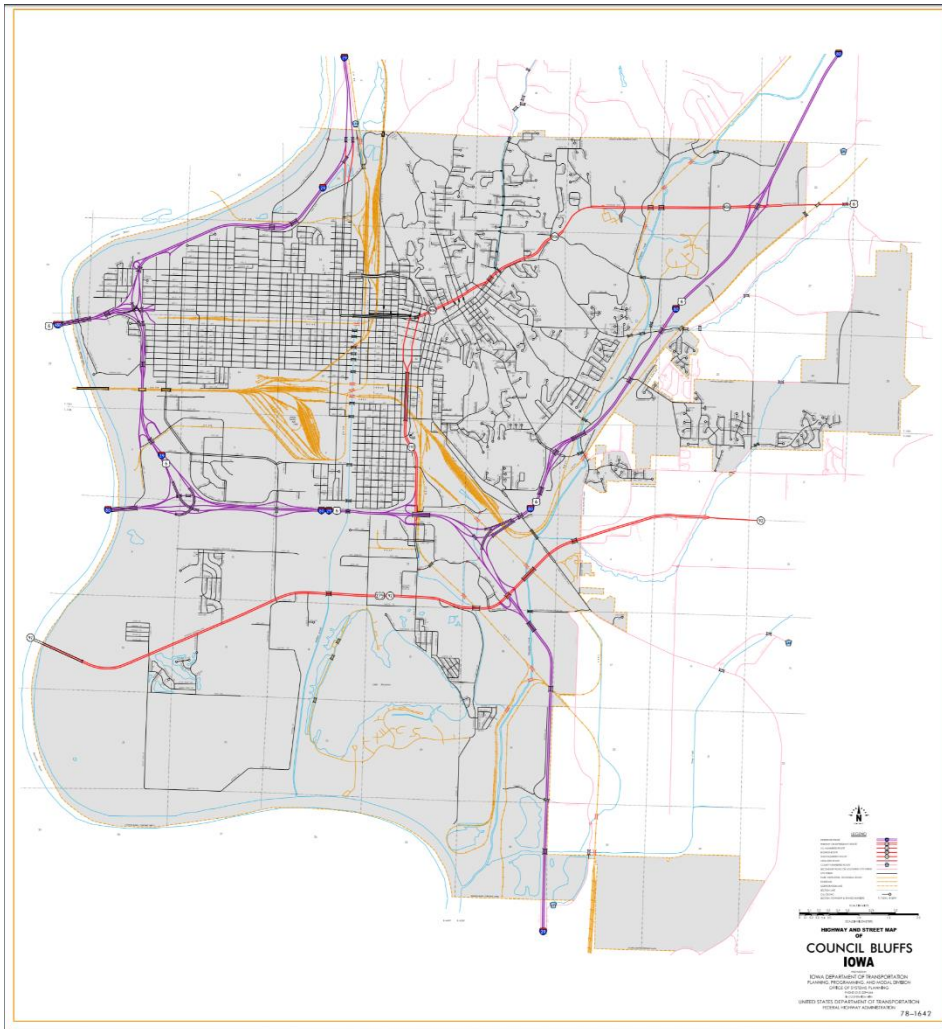

Council Bluffs:

Beginning at the Iowa-Nebraska State line (west corporation line) (approximately 4483 feet west and 624 feet south of the NE Corner Section 9-T74N-R44W); thence easterly through Sections 9, 10 (west junction of Interstate 29 and US 6), 11, and 12-T74N-R44W (junction Iowa 192) to a point approximately 2160 feet west and 200 feet south of the NE Corner of said Section 12; thence easterly through Section 12 and Section 7-T74N-R43W to the east junction of Interstate 29; thence northeasterly through Sections 7, 6, and 5-T74N-R43W and Sections 32, 28, 21, and 22-T75N-R43W (east junction of US 6 and junction of Iowa 906) to the north corporation line (approximately 2132 feet east of the NW Corner of said Section 22).

Beginning again on the north corporation line of Council Bluffs; thence northeasterly through Sections 15, 10, 11, 2, and 1-T75N-R43W, Section 36-T76N-R43W, Sections 31, 32, 29, 20, 21, 16, 15, 10, 3, and 2-T76N-R42W, Sections 35, 36, and 25-T77N-R42W, and Sections 30, 19, 18, 17, 8 and 5-T77N-R41W to the junction of Interstate 680 (approximately the Center of said Section 5); thence easterly through the center part of Sections 5, 4, 3, 2, and 1-T77N-R41W, Sections 6, 5 and 4-T77N-R40W to the west corporation line of Shelby.

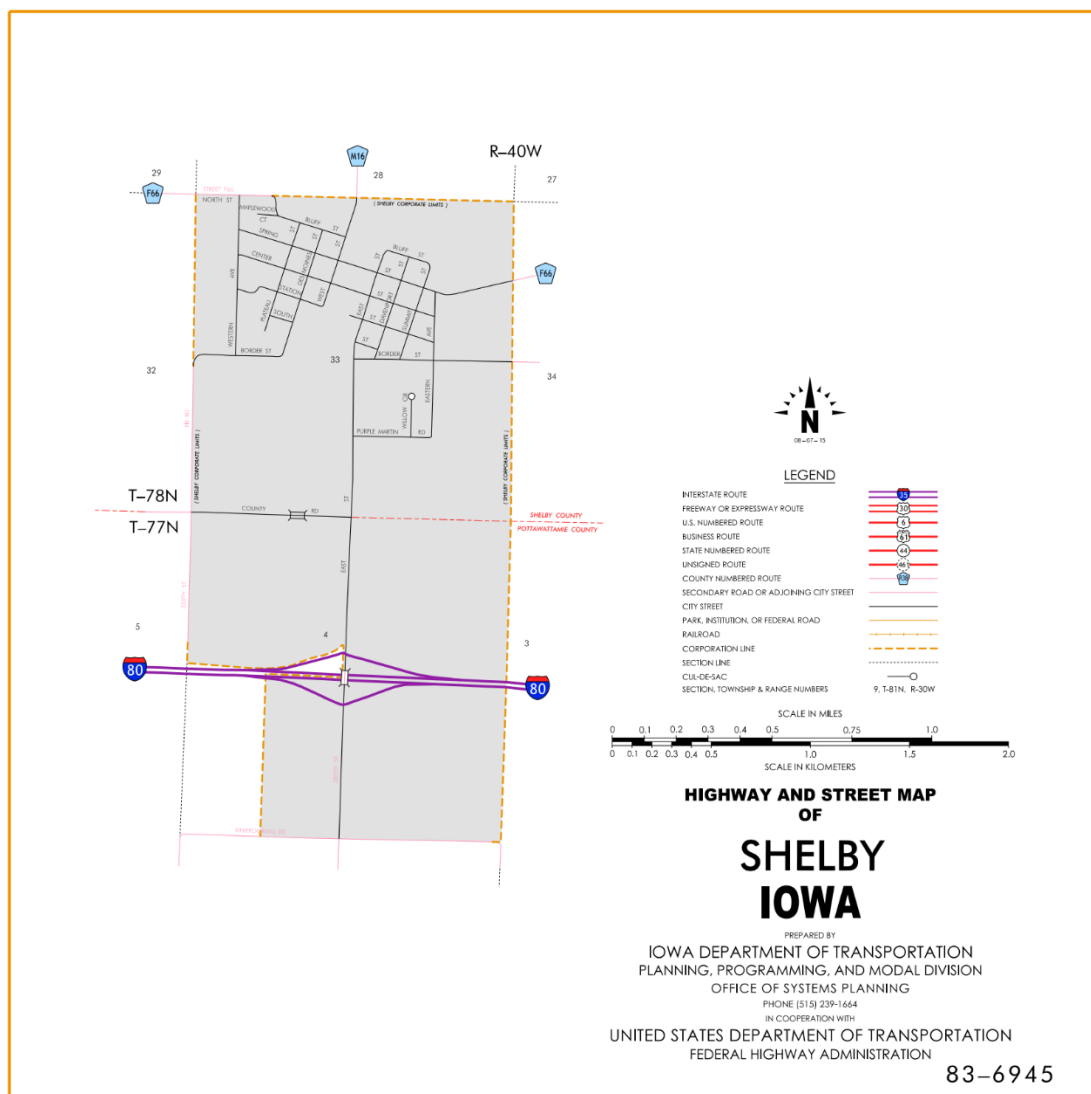

Shelby:

Beginning at the west corporation line; then east to the east corporation line.

Beginning again at the east corporation line of Shelby; thence east through Sections 3, 2 and 1-T77N-R40W and Sections 6, 5, 4, (junction US 59) 3, 2 and 1-T77N-R39W and Sections 6 and 5-T77N-R38W to the west corporation line of Walnut (approximately 270 feet south of the E ¼ Corner of said Section 5).

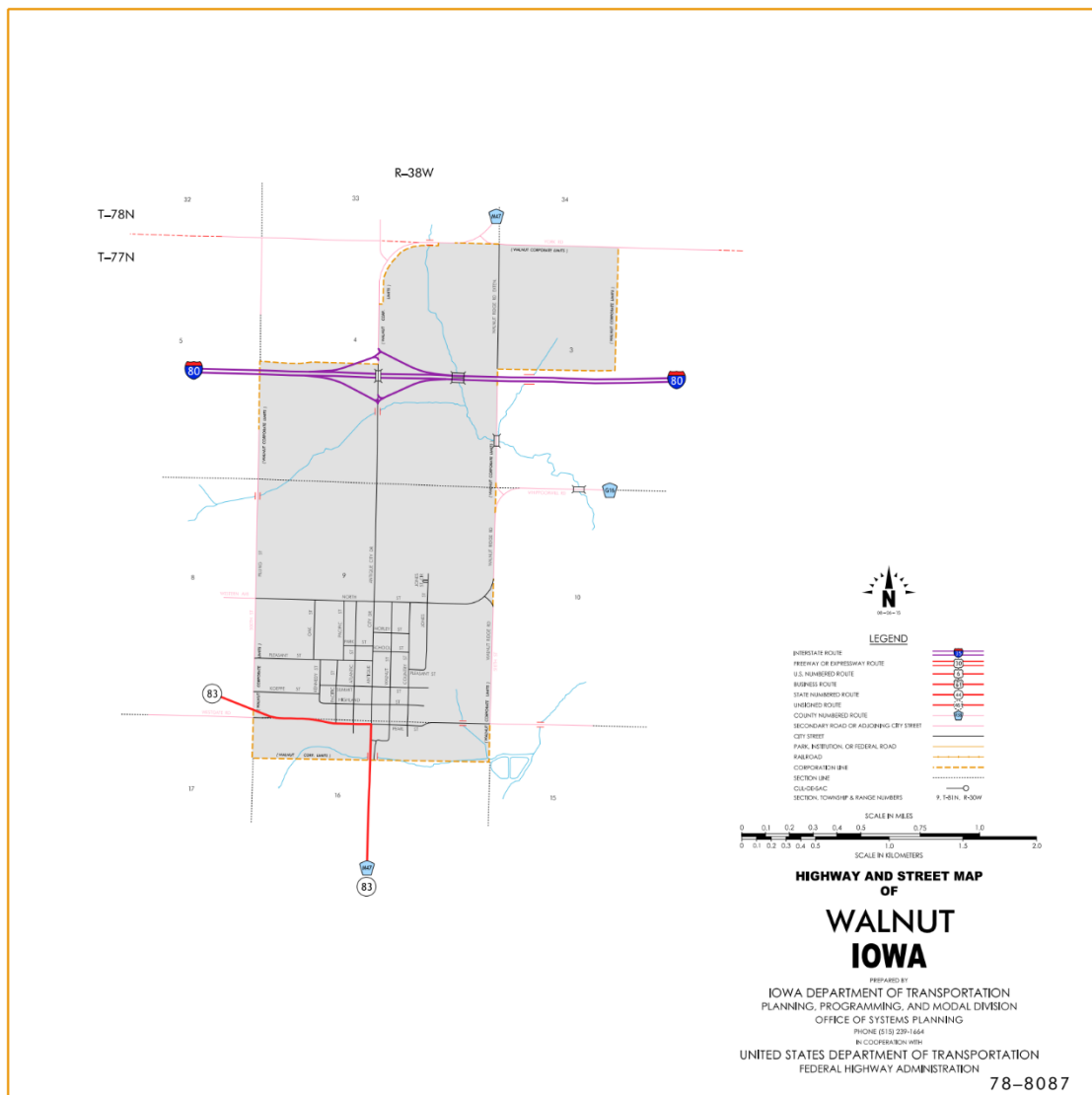

Walnut:

Beginning at the west corporation line; thence easterly to the east corporation line (approximately 258 feet south and 112 feet west of the E $\frac{1}{4}$ Corner Section 4-T77N-R38W).

Beginning again on the east corporation line of Walnut; thence easterly through Sections 4, 3, 2, and 1-T77N-R38W to the Pottawattamie-Cass County line at a point near the E $\frac{1}{4}$ Corner Section 1-T77N-R38W, Pottawattamie county (W $\frac{1}{4}$ Corner Section 6-T77N-R37W Cass County).

OFFICIAL DESCRIPTION CHANGE

OFFICE: Transportation Data

ENTERED BY: Stefani Wonders

ENTERED DATE: 09-13-2006

DISCUSSION/BACKGROUND:

Due to a review of our Primary System records, the primary route description for Interstate 80 in Pottawattamie County was found to be in slight error and therefore was re-written.

PROPOSAL/ACTION RECOMMENDATION:

New Description – Interstate 80 and its extensions in Pottawattamie County described as follows:

Council Bluffs:

Beginning on an unnamed street at the Iowa-Nebraska State line (west corporation line) (approximately 4483 feet west and 624 feet south of the NE Corner Section 9-T74N-R44W); thence easterly through Sections 9, 10, 11, and 12-T74N-R44W to a point approximately 2160 feet west and 200 feet south of the NE Corner of said Section 12; thence southeasterly through Section 12 and Section 7-T74N-R43W to the east junction of Interstate 29 (approximately 1574 feet south and 646 feet east of the NW

Corner of said Section 7); thence northeasterly through Sections 7, 6, and 5-T74N-R43W and Sections 32, 28, 21, and 22-T75N-R43W to the north corporation line (approximately 2132 feet east of the NW Corner of said Section 22).

Beginning again on the north corporation line of Council Bluffs connecting with an unnamed street; thence northeasterly through Sections 15, 10, 11, 2, and 1-T75N-R43W, Section 36-T76N-R43W, Sections 31, 32, 29, 20, 21, 16, 15, 10, 3, and 2-T76N-R42W, Sections 35, 36, and 25-T77N-R42W, and Sections 30, 19, 18, 17, 8 and 5-T77N-R41W to the junction of Interstate 680 (approximately the Center of said Section 5); thence easterly through the center part of Sections 5, 4, 3, 2, and 1-T77N-R41W, Sections 6, 5, 4, 3, 2 and 1-T77N-R40W and Sections 6, 5, 4, (junction US 59) 3, 2 and 1-T77N-R39W and Sections 6 and 5-T77N-R38W to the west corporation line of Walnut connecting with an unnamed street (approximately 270 feet south of the E $\frac{1}{4}$ Corner of said Section 5).

Walnut:

Beginning on an unnamed street at the west corporation line; thence easterly to the east corporation line (approximately 258 feet south and 112 feet west of the E $\frac{1}{4}$ Corner Section 4-T77N-R38W).

Beginning again on the east corporation line of Walnut connecting with an unnamed street; thence easterly through Sections 4, 3, 2, and 1-T77N-R38W to the Pottawattamie-Cass County line at a point near the E $\frac{1}{4}$ Corner Section 1-T77N-R38W, Pottawattamie county (W $\frac{1}{4}$ Corner Section 6-T77N-R37W Cass County).

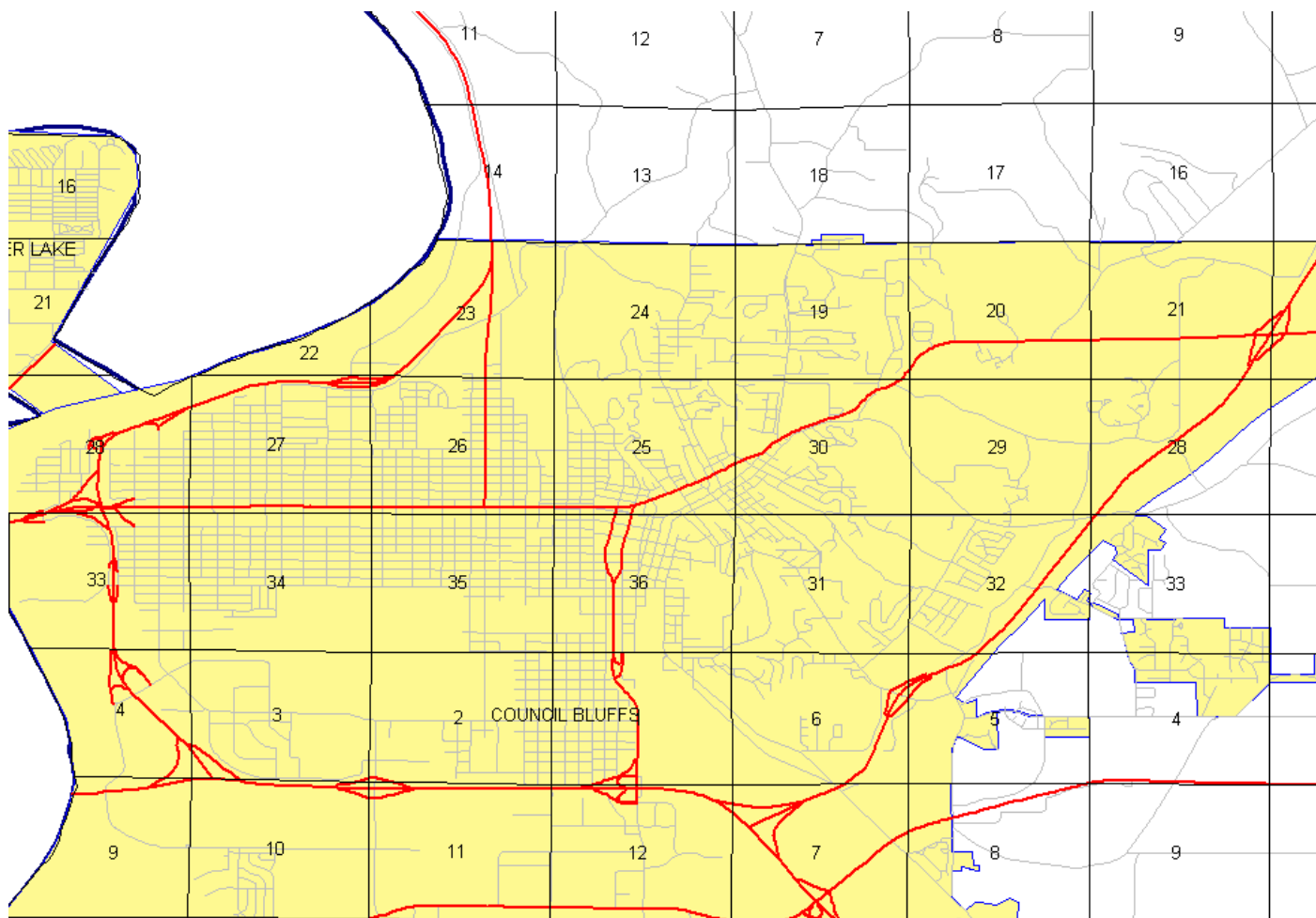

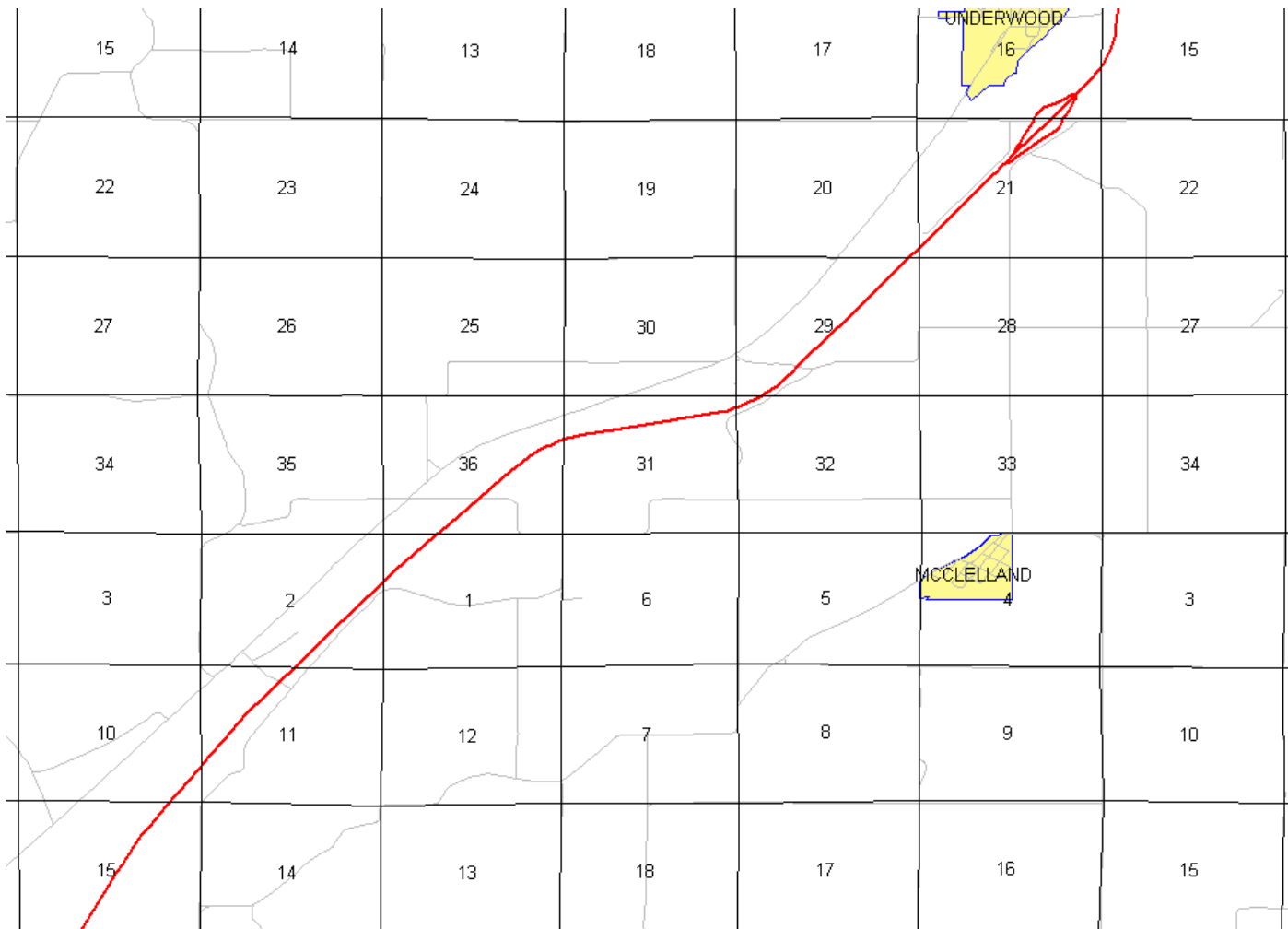

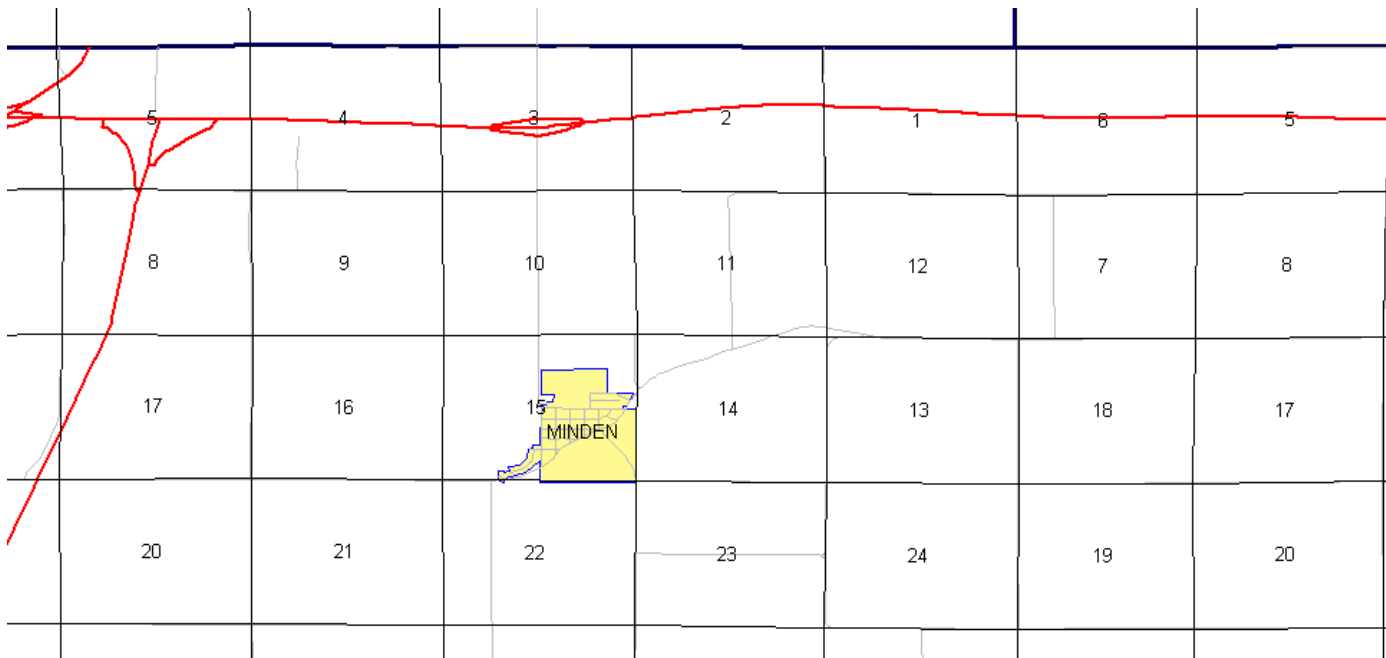
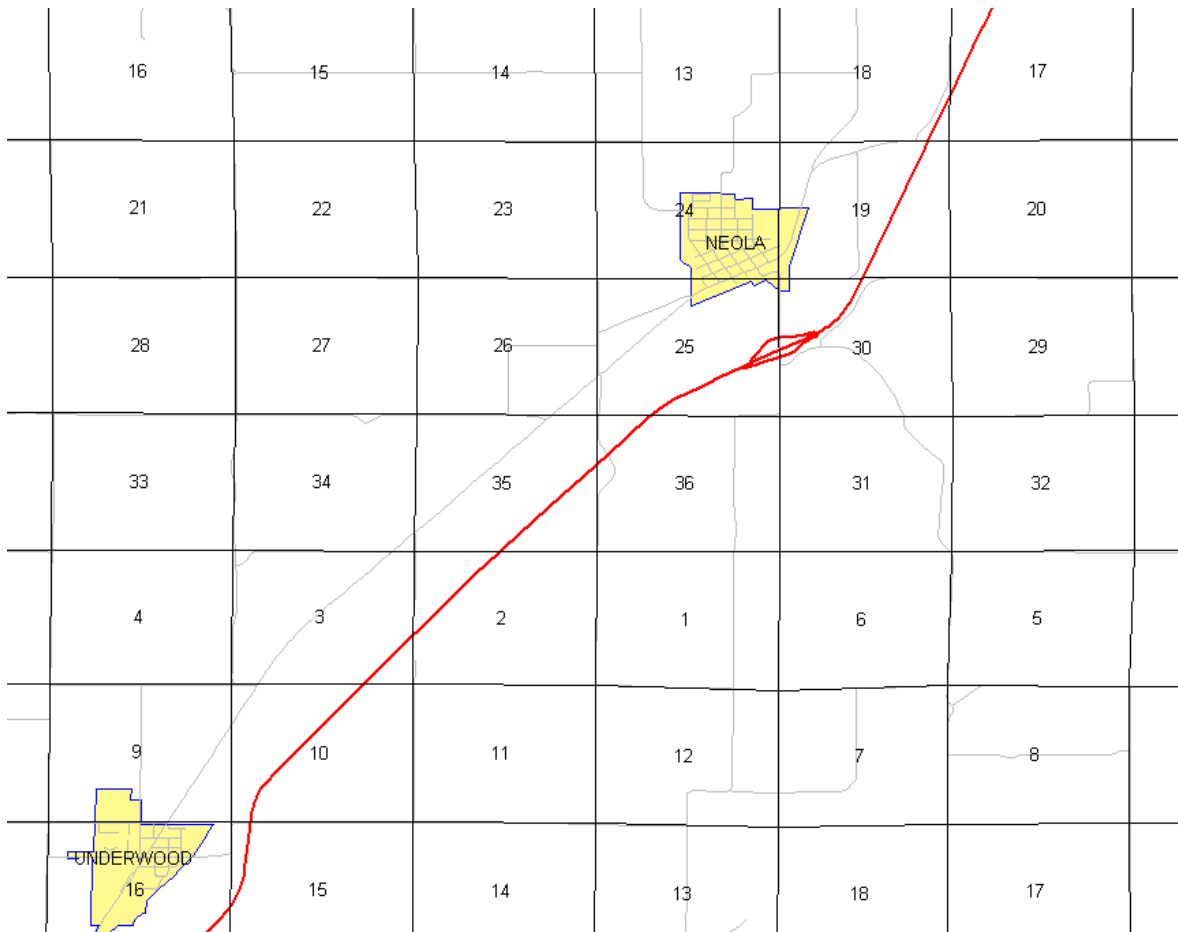

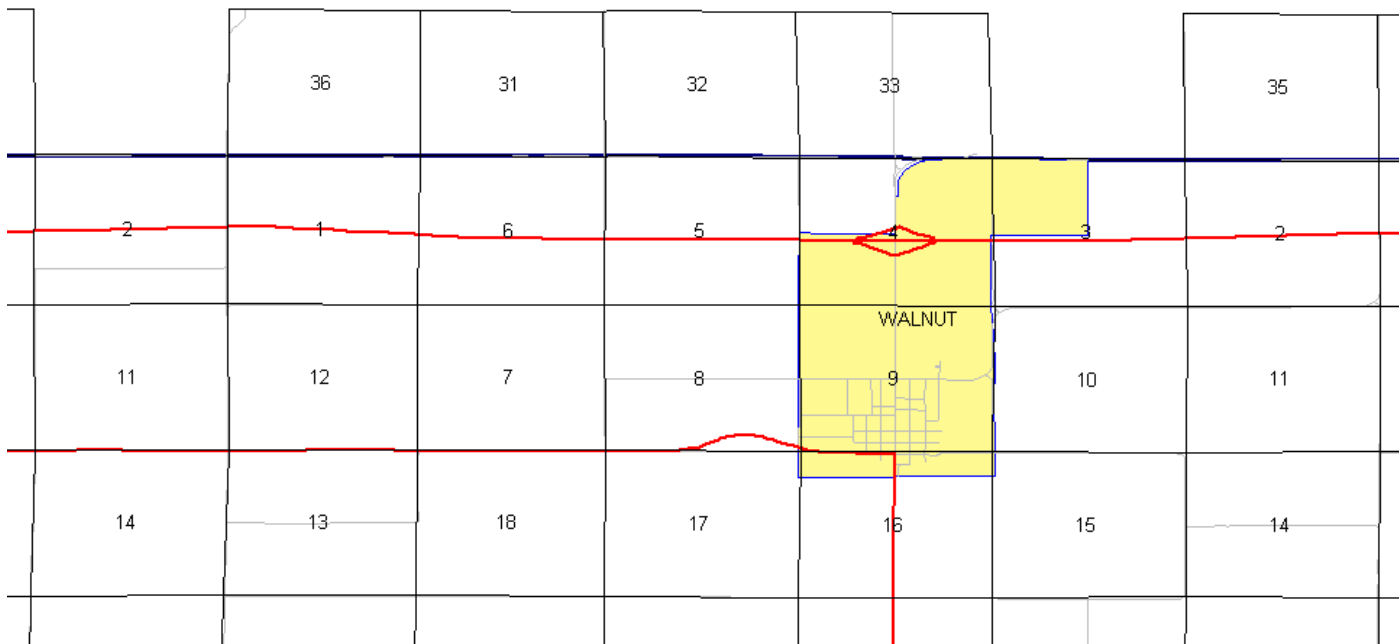
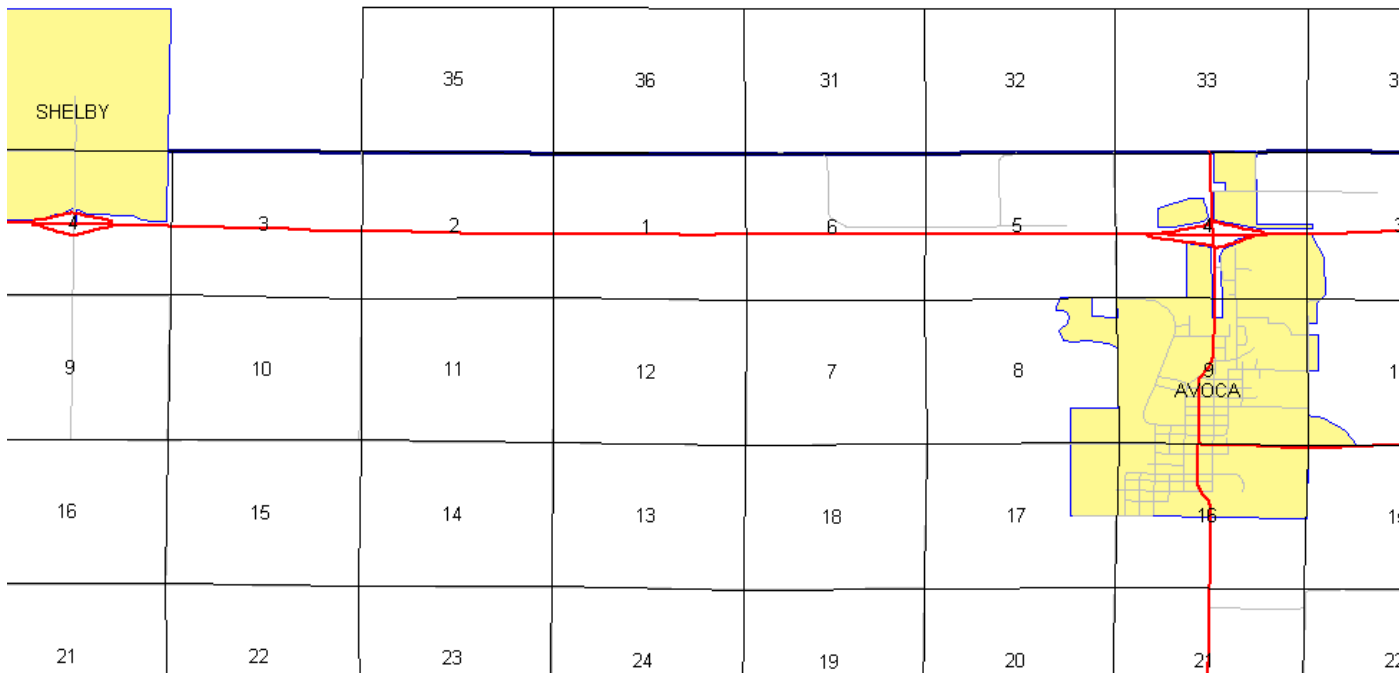

COMMISSION ORDER

DIVISION: Planning & Research

COMMISSION ORDER NUMBER: PR-79-272

SUBMITTED BY: C.I. MacGillivray

MEETING DATE: 11-2-78

DISCUSSION/BACKGROUND:

Due to a review of our Primary Road System records Interstate 80 in Pottawattamie County should be deleted and the new description added should be officially included into the Primary System.

Interstate 80 begins on the Iowa–Nebraska State line at the west corporation line of Council Bluffs, and travels generally easterly, northeasterly and easterly via Council Bluffs to the Pottawattamie–Cass County line approximately ½ mile south of the NE Corner of Pottawattamie County, Iowa.

PROPOSAL/ACTION RECOMMENDATION:

Locate Interstate 80 and its extension in Pottawattamie County as follows:

Council Bluffs:

Beginning on an unnamed street on the Interstate 80 Bridge over the Missouri River at the Iowa–Nebraska State line (west corporation line); thence easterly near the approximate section line through Sections 9, 4, 3, 2 and 1–T74N–R44W to a point near the S ¼ Corner Section 1–T74N–R44W; thence southeasterly and northeasterly through Sections 1 and 12–T74N–R44W, Sections 7, 6 and 5–T74N–R43W and Sections 32, 29, 28, 21 and 22–T75N–R43W to the north corporation line connecting with an unnamed street.

Beginning on the north corporation line of the City of Council Bluffs connecting with an unnamed street; thence northeasterly through Sections 15, 10, 11, 2 and 1–T75N–R43W; Section 36–T76N–R43W; Sections 31, 32, 29, 20, 21, 16, 15, 10, 3 and 2–T76N–R42W; Sections 35, 36 and 25–T77N–R42W, and Sections 30, 19, 18, 17, 8 and 5–T77N–R41W to a point (junction Interstate 680) near the center of Section 5–T77N–R41W; thence easterly through the center part of Sections 5, 4, 3, 2, and 1–T77N–R41W, Sections 6, 5, 4, 3, 2 and

1-T77N-R40W and Sections 6, 5, 4, (junction US 59) 3, 2 and 1-T77N-R39W and Sections 6, 5, 4, 3, 2, and 1-T77N-R38W to the Pottawattamie-Cass County line at a point near the E ¼ Corner Section 1-T77N-R38W, Pottawattamie county (W ¼ Corner Section 6-T77N-R37W Cass County).

NOW, THEREFORE: Be it resolved that the Iowa Department of Transportation approve the location of Interstate 80 in Pottawattamie County, Iowa.

NOTE: To become effective upon the adoption of this resolution.

COMMISSION RESOLUTION

DIVISION: Planning & Research

COMMISSION ORDER NUMBER: 74-772

SUBMITTED BY: Gene R. Mills

MEETING DATE: 6-26-74

Locate Interstate 80 and its extension in Pottawattamie County as follows:

Beginning on the north corporation line of the City of Council Bluffs connecting with an unnamed street; thence northeasterly through Sections 15, 10, 11, 2 and 1-T75N-R43W; thence northeasterly through Section 36-T76N-R43W; thence northeasterly through Sections 31, 32, 29, 20, 21, 16, 15, 10, 3 and 2-T76N-R42W; thence northeasterly through Sections 35, 36, and 25-T77N-R42W; thence northeasterly through Sections 30, 19, 20, 17, 8 and 5-T77N-R41W to a point near the center of Section 5-T77N-R41W (junction Interstate 680); thence easterly through approximately the center of Sections 5, 4, 3, 2 and 1-T77N-R41W; thence easterly through approximately the center of Sections 6, 5, 4, 3, 2 and 1-T77N-R40W; thence easterly through approximately the center of Sections 6, 5, 4, 3, 2 and 1-T77N-R39W; thence easterly through approximately the center of Sections 6, 5, 4, 3, 2

and 1-T77N-R38W; thence easterly to the Pottawattamie-Cass County line at a point near the NE Corner SE ¼ Section 1-T77N-R38W, Pottawattamie County (NW Corner SW ¼ Section 6-T77N-R37W (Cass County)).

Council Bluffs

Beginning on the Interstate 80 Bridge over the Missouri River Bridge at the Iowa-Nebraska State line (west corporation line); thence easterly along the approximate section line (parallel to 29th Avenue) to a point near the N ¼ Corner of Section 12-T74N-R44W (near intersection of 29th Avenue and South 4th Street); thence southeasterly, easterly, and northeasterly to a point on Pomona Avenue midway between Madison Avenue and Mosquito Creek; thence northeasterly approximately paralleling the Chicago Great Western Railroad to the north corporation line of Council Bluffs.

NOW, THEREFORE: Be it resolved that the Iowa State Highway Commission approve the location of Interstate 80 and its extension in Pottawattamie County, Iowa.

COMMISSION RESOLUTION

DIVISION: Planning & Research

COMMISSION ORDER NUMBER: 74-15

MEETING DATE: 1-9-74

Remove Interstate 80N in Pottawattamie County as follows:

Beginning at a point on Interstate 29 near the SE Corner of Section 4-T77N-R44W; thence in an easterly direction through the south part of Sections 4, 3, 2 and 1-T77N-R44W; thence continuing in an easterly direction through Sections 6 and 5-T77N-R43W to a point near the S ¼ Corner Section 5-T77N-R43W; thence in a northeasterly direction

through Sections 5 and 4-T77N-R43W to a point near the center of Section 4-T77N-R43W; thence in an easterly direction following substantially the quarter section line to a point near the NE Corner SE ¼ Section 5-T77N-R41W.

NOW, THEREFORE: Be it resolved that the Iowa State Highway Commission approve the removal of Interstate 80N in Pottawattamie County, Iowa.

NOTE: To become effective upon adoption of this resolution.

OFFICIAL DESCRIPTION CHANGE

COUNTY: Pottawattamie

ROUTE: Interstate 80N

APPROVAL DATE: 12-7-68

Beginning at a point on Interstate 29 near the SE Corner of Section 4-T77N-R44W; thence in an easterly direction through the south part of Sections 4, 3, 2, and 1-T77N-R44W; thence continuing in an easterly direction through Sections 6 and 5-T77N-R43W to a point near the S ¼ Corner Section 5-T77N-R43W; thence in a northeasterly direction through Sections 5 and 4-T77N-R43W to a point near the center of Section 3-T77N-R43W; thence in an easterly direction following substantially the quarter section line through Sections 3, 2, 1-T77N-R43W and Sections 6, 5, 4, 3, 2, and 1-T77N-R42W and Sections 6 and 5-T77N-R41W to a point near the NE Corner SE ¼ Section 5-T77N-R41W.

OFFICIAL DESCRIPTION CHANGE

COUNTY: Pottawattamie

ROUTE: Interstate 80

APPROVAL DATE: 12-7-66

Beginning at a point near the NW Corner SW $\frac{1}{4}$ of Section 5-T77N-R41W; thence in an easterly direction following substantially the quarter section line to the Pottawattamie-Cass County line at a point near the NE Corner SE $\frac{1}{4}$ Section 1-T77N-R38W, Pottawattamie County (NW Corner SW Section 6-T77N-R37W, Cass County).

Adopted 12-7-66

BE IT RESOLVED by the Iowa State Highway Commission that the following described road in Pottawattamie County be added to the Primary Interstate Road System and Federal Aid Interstate Road System.

Access Control Classification:

This section of road upon completion and opening to traffic will be a Class I Road.

BE IT FURTHER RESOLVED that the attached description of Interstate 80 in Pottawattamie County be adopted, and shall become effective on passage of this resolution.