

New Description – Interstate 380 and its extensions in Linn County described as follows:

Beginning on the Linn–Johnson County line approximately 2368 feet east of the SW Corner Section 33–T82N–R07W, Linn County (NW Corner Section 4–T81N–R07W, Johnson County); thence northerly to the south corporation line of Cedar Rapids (approximately 1286 feet north and 2274 feet east of the SW Corner of said Section 33).

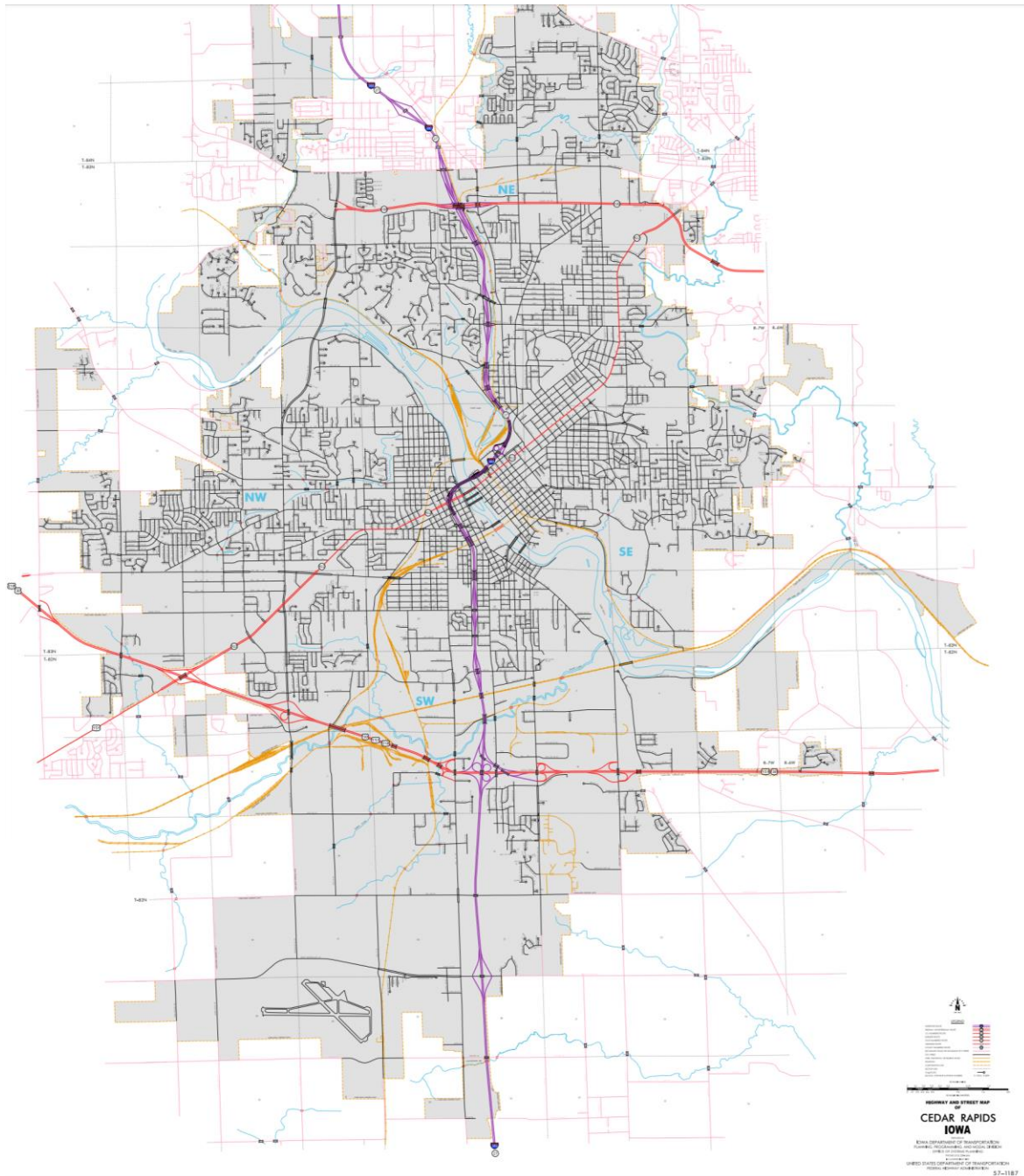

Cedar Rapids:

Beginning at the south corporation line; thence northerly through Sections 33, 28, 21, 16, 9 (junction US 30/US 151 and US 218), and 4-T82-N-R07W and Sections 33 and 28-T83N-R07W to approximately 2303 feet east and 1089 feet north of the SW Corner of said Section 28 (junction Iowa 922); thence northwesterly, northeasterly, and northwesterly through Sections 28, 21, and 16-T83N-R07W to approximately 3137 feet west and 1600 feet north of the SE Corner of said Section 16; thence northerly through Sections 16 and 9-T83N-R07W to approximately 3917 feet east and 1484 feet south of the NW Corner of said Section 9; thence northwesterly through Sections 9 and 4-T83N-R07W (junction Iowa 100) to the north corporation/south corporation of Hiawatha (approximately 676 feet east and 809 feet south of the NW Corner of said Section 4).

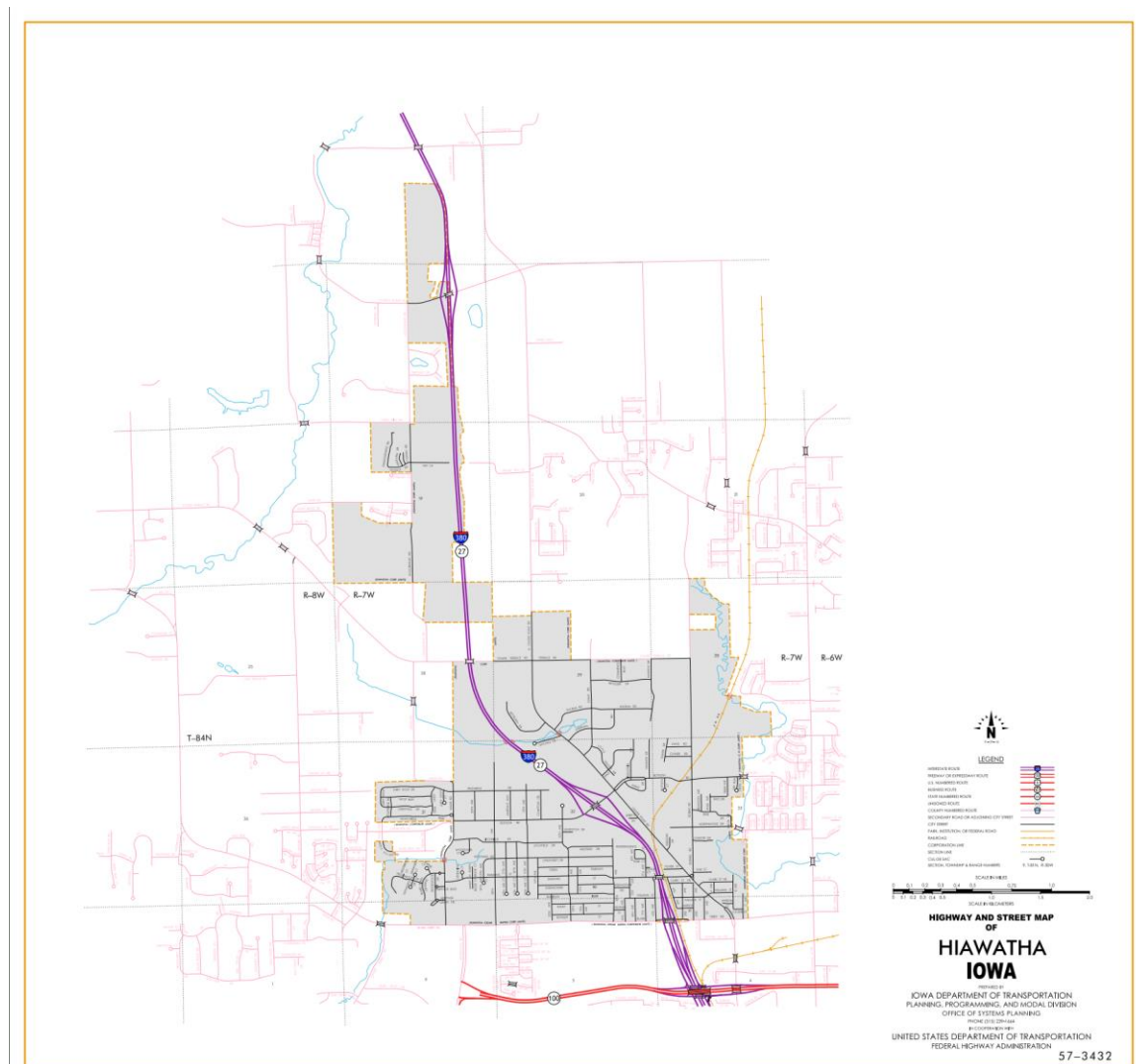

Hiawatha:

Beginning at the south corporation line; thence northwesterly through Section 4-T83N-R07W and Sections 33, 32, 29, and 30-T84N-R07W to the north corporation line/south corporation line of Cedar Rapids (approximately 1021 feet west of the E $\frac{1}{4}$ Corner of said Section 30).

Cedar Rapids:

Beginning at the south corporation line/north corporation line of Hiawatha; thence northwesterly to the north corporation line/south corporation line of Hiawatha (approximately 1316 feet north and 1132 feet west of the E $\frac{1}{4}$ Corner Section 30-T84N-R07W).

Hiawatha:

Beginning at the south corporation line/north corporation line of Cedar Rapids; thence northerly through Sections 19 and 18-T84N-R07W; thence northerly and northwesterly through Section 7-T84N-R07W to the north corporation line.

Beginning again on the north corporation line of Hiawatha; thence northwesterly through Sections 7, and 6-T84N-R07W and Sections 36, 35, 26, 23, 22, 21, 16, 17, 8, 7, and 6-T85N-R08W to the Linn-Benton County line at a point near the W $\frac{1}{4}$ Corner Section 6-T85N-R08W, Linn County (E $\frac{1}{4}$ Corner Section 1-T85N-R09W, Benton County).

OFFICIAL DESCRIPTION CHANGE

OFFICE: Transportation Data

ENTERED BY: Stefani Wonders

ENTERED DATE: 09-18-2006

DISCUSSION/BACKGROUND:

Due to a review of our Primary System records, the primary route description for Interstate 380 in Linn County was revised.

PROPOSAL/ACTION RECOMMENDATION:

New Description – Interstate 380 and its extensions in Linn County described as follows:

Beginning on the Linn–Johnson County line approximately 2368 feet east of the SW Corner Section 33–T82N–R7W, Linn County (NW Corner Section 4–T81N–R7W, Johnson County); thence northerly to the south corporation line of Cedar Rapids connecting with an unnamed street (approximately 1286 feet north and 2274 feet east of the SW Corner of said Section 33).

Cedar Rapids:

Beginning on an unnamed street at the south corporation line; thence northerly through Sections 33, 28, 21, 16, 9, and 4–T82–N–R7W and Sections 33 and 28–T83N–R7W to approximately 2303 feet east and 1089 feet north of the SW Corner of said Section 28; thence northwesterly, northeasterly, and northwesterly through Sections 28, 21, and 16–T83N–R7W to approximately 3137 feet west and 1600 feet north of the SE Corner of said Section 16; thence northerly through Sections 16 and 9–T83N–R7W to approximately 3917 feet east and 1484 feet south of the NW Corner of said Section 9; thence northwesterly through Sections 9 and 4–T83N–R7W to the north corporation/south corporation of Hiawatha connecting with an unnamed street (approximately 676 feet east and 809 feet south of the NW Corner of said Section 4).

Hiawatha:

Beginning on an unnamed street at the south corporation line; thence northwesterly on said unnamed street through Section 4–T83N–R7W and Sections 33, 32, 29, and 30–T84N–R7W to the north corporation

line/south corporation line of Cedar Rapids connecting with an unnamed street (approximately 1021 feet west of the E $\frac{1}{4}$ Corner of said Section 30).

Cedar Rapids:

Beginning on an unnamed street at the south corporation line/north corporation line of Hiawatha; thence northwesterly on said unnamed street to the north corporation line/south corporation line of Hiawatha connecting with an unnamed street (approximately 1316 feet north and 1132 feet west of the E $\frac{1}{4}$ Corner Section 30-T84N-R7W).

Hiawatha:

Beginning on an unnamed street at the south corporation line/north corporation line of Cedar Rapids; thence northwesterly on said unnamed street to the north corporation line (approximately 1252 feet west of the NE Corner Section 30-T84N-R7W).

Beginning again on the north corporation line of Hiawatha connecting with an unnamed street; thence northerly and northwesterly through Sections 19, 18, 7, and 6-T84N-R7W and Sections 36, 35, 26, 23, 22, 21, 16, 17, 8, 7, and 6-T85N-R8W to the Linn-Benton County line at a point near the W $\frac{1}{4}$ Corner Section 6-T85N-R8W, Linn County (E $\frac{1}{4}$ Corner Section 1-T85N-R9W, Benton County).

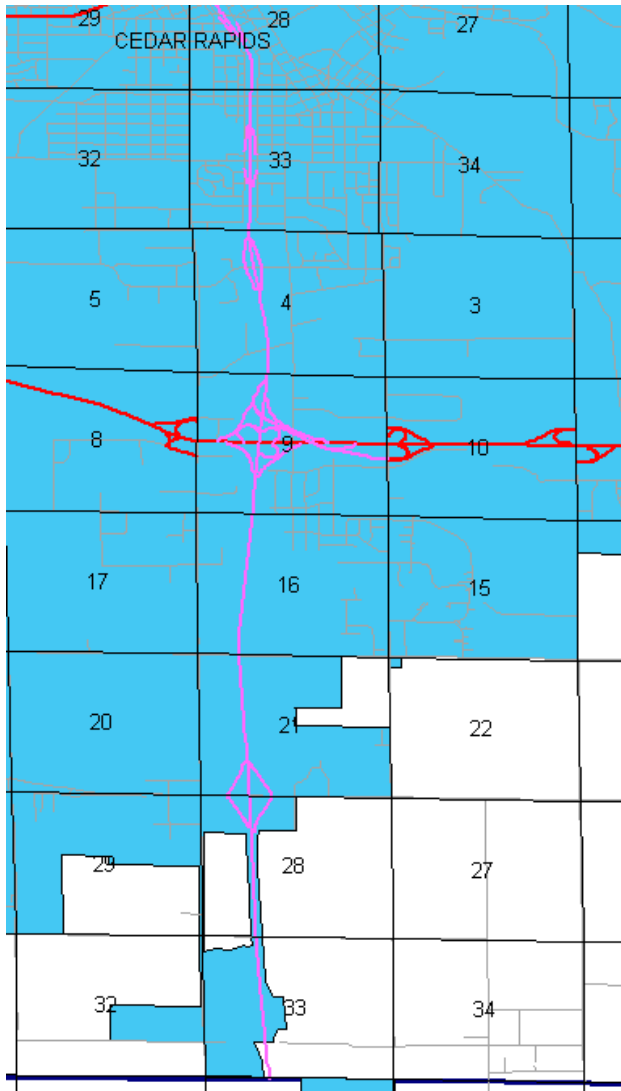

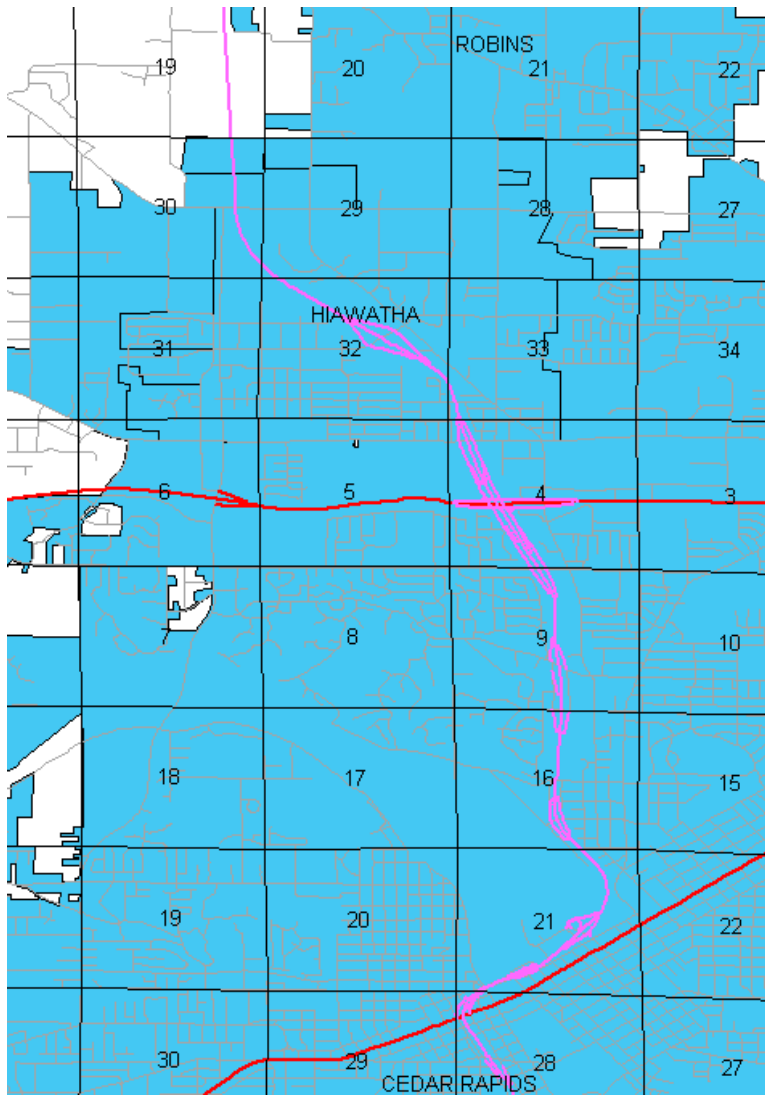

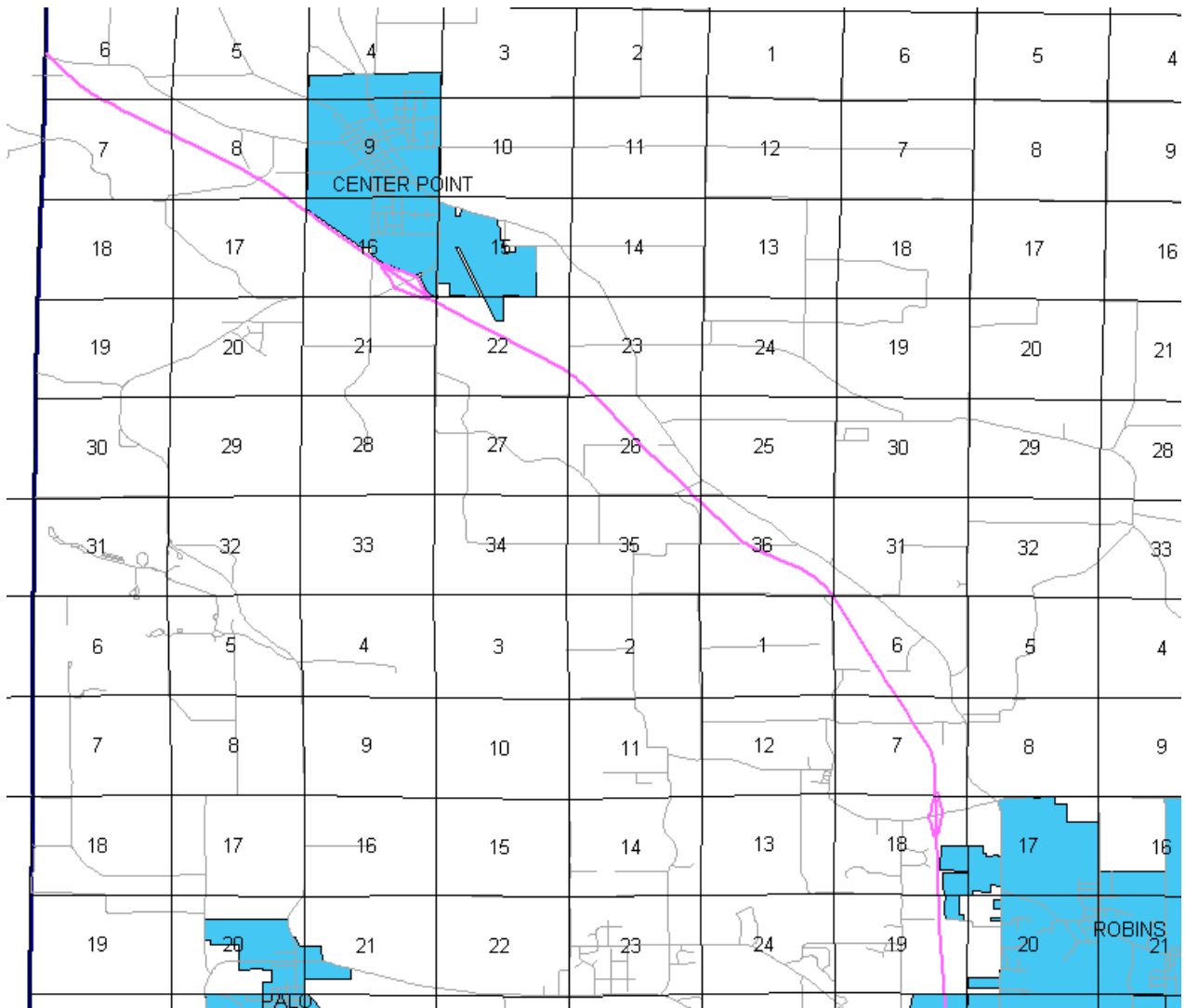

STAFF ACTION

OFFICE: Transportation Inventory

STAFF ACTION NUMBER: S-02-1137

SUBMITTED BY: Peggi Knight

SUBMITTAL DATE: 06-12-2002

DISCUSSION/BACKGROUND:

New Description – Interstate 380 and its extensions in Linn County described as follows:

Beginning on the Johnson County Line near the S ¼ Corner Section 33–T82N–R7W; thence in a northerly direction through Sections 33–T82N–R7W to south corporation line of the City of Cedar Rapids, connecting with an unnamed street (approximately 1760 feet east and 1300 feet north of the SE Corner Section 33–T82N–R7W).

Cedar Rapids:

Beginning on the south corporation line, connecting with an unnamed street (approximately 1760 feet east and 1300 feet north of the SE Corner Section 33–T82N–R7W); thence in a northerly, northwesterly, and northerly direction on said unnamed street to a point on Wilson Avenue Southwest approximately midway between "L" Street Southwest and Third Street Southwest; thence northerly on said unnamed street to a point approximately midway between "L" Street Southwest and Third Street Southwest at Twelfth Avenue Southwest; thence northwesterly on said unnamed street approximately midway between Third Street Southwest and Fourth Street Southwest to First Avenue West; thence curving northeasterly on said unnamed street across the Cedar River to a point near Third Street Northeast and "A" Avenue Northeast; thence northeasterly on said unnamed street to a point near Twelfth Street Northeast and "D" Avenue Northeast extended westerly; thence northwesterly on said unnamed street to a point near "H" Avenue Northeast and Tenth Street Northeast; thence generally northerly on unnamed street to a point near Coldstream Avenue; thence generally northerly on unnamed street to a point near Glass Road; thence northerly and northwesterly on unnamed street to a point near 42nd Street; thence northwesterly on unnamed street to Collins Avenue Northeast (junction Iowa 100); thence northwesterly to Blairs Ferry Road (north corporation line of Cedar Rapids) (south corporation line of Hiawatha).

Hiawatha:

Beginning on an unnamed street at the south corporation line (Blairs Ferry Road); thence northwesterly on said unnamed street to Boysen

Road; thence continuing northwesterly on said unnamed street to the north corporation line (south corporation line of the City of Cedar Rapids), connecting with an unnamed street (approximately 750 feet west of the E ¼ Corner Section 30–T84N–R7W).

Cedar Rapids:

Beginning on the south corporation line (north corporation line of Hiawatha), connecting with an unnamed street (approximately 750 feet west of the E ¼ Corner Section 30–T84N–R7W); thence northerly on said unnamed street approximately 1300 feet to the north corporation line.

Beginning again on the north corporation line of the City of Cedar Rapids, connecting with an unnamed street; thence northerly and northwesterly through Sections 30, 19, 18, 7, and 6–T84N–R7W and Sections 36, 35, 26, 23, 22, 21, 16, 17, 8, 7, and 6–T85N–R8W to the Linn–Benton County line at a point near the W ¼ Corner Section 6–T85N–R8W, Linn County (E ¼ Corner Section 1–T85N–R9W, Benton County).

PROPOSAL/ACTION RECOMMENDATION:

It is recommended that the old description of Interstate 380 and its extensions in Linn County be deleted and the new description be included in the Primary Road System.

STAFF ACTION

OFFICE: Transportation Inventory

STAFF ACTION NUMBER: S–85–413

SUBMITTED BY: Patrick R. Cain

SUBMITTAL DATE: 10–18–84

DISCUSSION/BACKGROUND:

Interstate 380 was opened to traffic to a junction with Iowa 101 north of Urbana in Benton County August 14, 1984. The official description of Interstate 380 in Linn County should be revised to reflect this opening.

Interstate 380 begins at the Linn-Johnson County line approximately 2 miles south of Cedar Rapids and travels northerly and northwesterly via the cities of Cedar Rapids and Hiawatha to the Linn-Benton County line approximately 2 miles west and ¼ mile north of the city of Center Point.

PROPOSAL/ACTION RECOMMENDATION:

It is recommended to approve revising the description of Interstate 380 in Linn County and including the new description in the Primary Road System.

New Description – Interstate 380 and its extensions in Linn County described as follows:

Beginning at the Johnson County line near the S ¼ Corner Section 33-T82N-R7W; thence in a northerly direction through Sections 33 and 28-T82N-R7W to the south corporation line of the City of Cedar Rapids connecting with an unnamed street.

Cedar Rapids:

Beginning on an unnamed street at the south corporation line; thence in a northerly, northwesterly, and northerly direction on said unnamed street to a point on Wilson Avenue Southwest approximately midway between "L" Street Southwest and Third Street Southwest; thence northerly on said unnamed street to a point approximately midway between "L" Street Southwest and Third Street Southwest at Twelfth Avenue Southwest; thence northwesterly on said unnamed street approximately midway between Third Street Southwest and Fourth Street Southwest to First Avenue West; thence curving northeasterly on said unnamed street across the Cedar River to a point near Third Street Northeast and "A" Avenue Northeast; thence northeasterly on said unnamed street to a point near

Twelfth Street Northeast and "D" Avenue Northeast extended westerly; thence northwesterly on said unnamed street to a point near "H" Avenue Northeast and Tenth Street Northeast; thence generally northerly on unnamed street to a point near Coldstream Avenue; thence generally northerly on unnamed street to a point near Glass Road; thence northerly and northwesterly on unnamed street to a point near 42nd Street; thence northwesterly on unnamed street to Collins Avenue Northeast (junction Iowa 100); thence northwesterly to Blairs Ferry Road (north corporation line of Cedar Rapids) (south corporation line of Hiawatha).

Hiawatha:

Beginning on an unnamed street at the south corporation line (Blairs Ferry Road); thence northwesterly on said unnamed street to Carpenter Road; thence continuing northwesterly on said unnamed street to the north corporation line.

Beginning again on the north corporation line of Hiawatha connecting with an unnamed street; thence northerly and northwesterly through Sections 30, 19, 18, 7 and 6-T84N-R7W and Sections 36, 35, 26, 23, 22, 21, 16, 17, 8, 7 and 6-T85N-R8W to the Linn-Benton County line at a point near the W ¼ Corner Section 6-T85N-R8W Linn County (E ¼ Corner Section 1-T85N-R9W, Benton County).

COMMISSION ORDER

DIVISION: Planning & Research

COMMISSION ORDER NUMBER: PR-82-456

SUBMITTED BY: Patrick R. Cain

MEETING DATE: 1-5-82

DISCUSSION/BACKGROUND:

Interstate 380 begins on the Linn–Johnson County line near the northwest corner of the City of Shueyville, and travels generally northerly to the City of Cedar Rapids.

Due to the construction of an additional portion of Interstate 380 in the City of Cedar Rapids, opened to traffic on December 4, 1981, Interstate 380 in Linn County should be deleted from the Primary Road System and new description added should be officially included into the Primary Road System.

PROPOSAL/ACTION RECOMMENDATION:

It is recommended the commission approve deleting the present description of Interstate 380 in Linn County from the primary road system and approve including the attached new description of Interstate 380 in the primary road system.

Locate Interstate 380 and its extension in Linn County as follows:

Beginning at the Johnson county line near the S ¼ Corner Section 33–T82N–R7W; thence in a northerly direction through Sections 33 and 28–T82N–R7W to the south corporation line of the City of Cedar Rapids connecting with an unnamed street.

Cedar Rapids:

Beginning on an unnamed street at the south corporation line; thence in a northerly, northwesterly, and northerly direction on said unnamed street to a point on Wilson Avenue Southwest approximately midway between "L" Street Southwest and Third Street Southwest; thence northerly on said unnamed street to a point approximately midway between "L" Street Southwest and Third Street Southwest at Twelfth Avenue Southwest; thence northwesterly on said unnamed street approximately midway between Third Street Southwest and Fourth Street Southwest to First Avenue West; thence curving northeasterly on said unnamed street across the Cedar River to a point near Third Street Northeast and "A" Avenue

Northeast; thence northeasterly on said unnamed street to a point near Twelfth Street Northeast and "D" Avenue Northeast extended westerly; thence northwesterly on said unnamed street to a point near "H" Avenue Northeast and Tenth Street Northeast; thence generally northerly on unnamed street to a point near Coldstream Avenue.

REVISED: 10-18-84

COMMISSION ORDER

DIVISION: Planning & Research

COMMISSION ORDER NUMBER: PR-79-272

SUBMITTED BY: C.I. MacGillivray

MEETING DATE: 11-2-78

DISCUSSION/BACKGROUND:

Due to a review of our Primary Road System records Interstate 380 in Linn County should be deleted and the new description added should be officially included into the Primary Road System.

PROPOSAL/ACTION RECOMMENDATION:

It is recommended that the old description of Interstate 380 in Linn County be deleted and the new description, as referred in the attached detailed description, be included in the Primary Road System effective upon the adoption of this resolution.

Locate Interstate 380 and its extensions in Linn County as follows:

Beginning at the Johnson County line near the S ¼ Corner Section 33-T82N-R7W; thence in a northerly direction through Sections 33 and 28-T82N-R7W to the south corporation line of the City of Cedar Rapids connecting with an unnamed street.

Cedar Rapids:

Beginning on an unnamed street at the south corporation line; thence in a northerly, northwesterly, and northerly direction on said unnamed street to a point on Wilson Avenue Southwest approximately midway between "L" Street Southwest and Third Street Southwest; thence northerly on said unnamed street to a point approximately midway between "L" Street Southwest and Third Street Southwest at Twelfth Avenue Southwest; thence northwesterly on said unnamed street approximately midway between Third Street Southwest and Fourth Street Southwest to First Avenue West; thence curving northeasterly on said unnamed street across the Cedar River to a point near Third Street Northeast and "A" Avenue Northeast; thence northeasterly on said unnamed street to a point near Twelfth Street Northeast and "D" Avenue Northeast extended westerly; thence northwesterly on said unnamed street to a point near "H" Avenue Northeast and Tenth Street Northeast.

REVISED: 1-5-82

COMMISSION RESOLUTION

DIVISION: Planning & Research

COMMISSION ORDER NUMBER: 69-1272

SUBMITTED BY: Raymond L. Kassel

MEETING DATE: 9-17-69

Beginning at the Johnson County Line near the S $\frac{1}{4}$ Corner Section 33-T82N-R7W; thence in a northerly direction to the south corporation line of the city of Cedar Rapids.

Cedar Rapids:

Beginning on an unnamed street at the south corporation line; thence in a northerly, northwesterly, and northerly direction on said unnamed street to a point on Wilson Avenue Southwest approximately midway between "L" Street Southwest and Third Street Southwest; thence northerly on said unnamed street to a point approximately midway between "L" Street Southwest and Third Street Southwest at Twelfth Avenue Southwest; thence northwesterly on said unnamed street approximately midway between Third Street Southwest and Fourth Street Southwest to First Avenue West; thence curving northeasterly on said unnamed street across the Cedar River to a point near Third Street Northeast and "A" Avenue Northeast; thence northeasterly on said unnamed street to a point near Twelfth Street Northeast and "D" Avenue Northeast extended westerly; thence northwesterly on said unnamed street to a point near "H" Avenue Northeast and Tenth Street Northeast; thence northerly and northeasterly on said unnamed street to the north corporation line.

Hiawatha:

Beginning on an unnamed street at the south corporation line; thence northwesterly on said unnamed street to Blairs Ferry Road, (FAS 976).

NOW THEREFORE: Be it resolved that the Iowa State Highway Commission approve the location of Interstate 380 in Linn County, Iowa.

NOTE: To become effective upon adoption of this resolution.

REVISED: 1978