

OFFICIAL ROUTE DESCRIPTION CHANGE

OFFICE: Research and Analytics

EFFECTIVE DATE: 09-01-2020

COUNTY: Dubuque

ROUTE: Iowa 3

ENTERED BY: Paul Mauer

ENTERED DATE: 08-14-2020

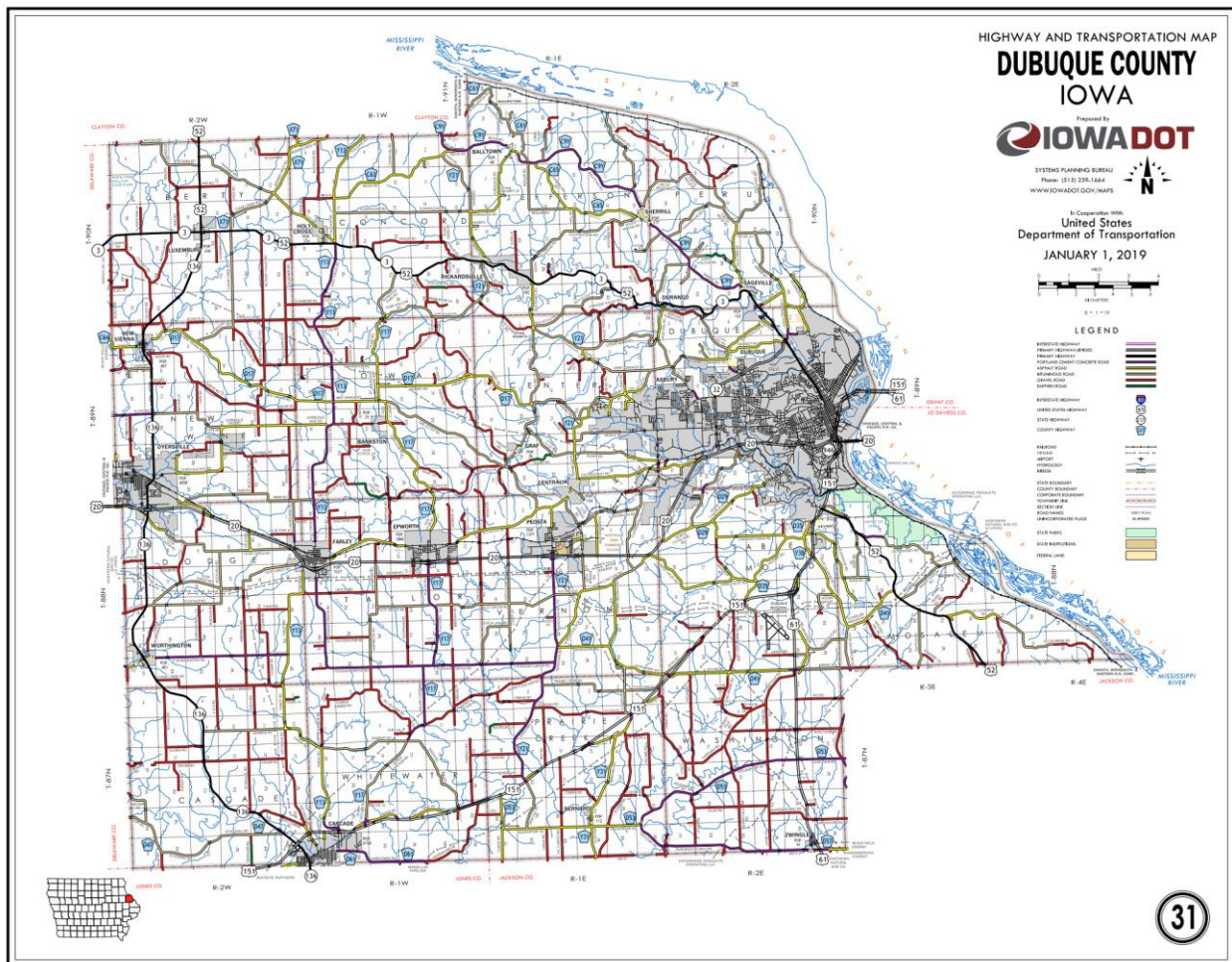

New Description – Iowa 3 and its extensions in Dubuque County described as follows:

Beginning on the Dubuque-Delaware County line at a point approximately 600 feet south of the NW Corner of Section 19-T90N-R2W, Dubuque County (NE Corner of Section 24-T90N-R2W, Delaware County); thence northeast to a point approximately 1,100 feet east of the NW Corner of Section 19-T90N-R2W; thence east following substantially the section line of Sections 19, 20 and 21-T90N-R2W to the west corporation line of Luxemburg, connecting with Main Street.

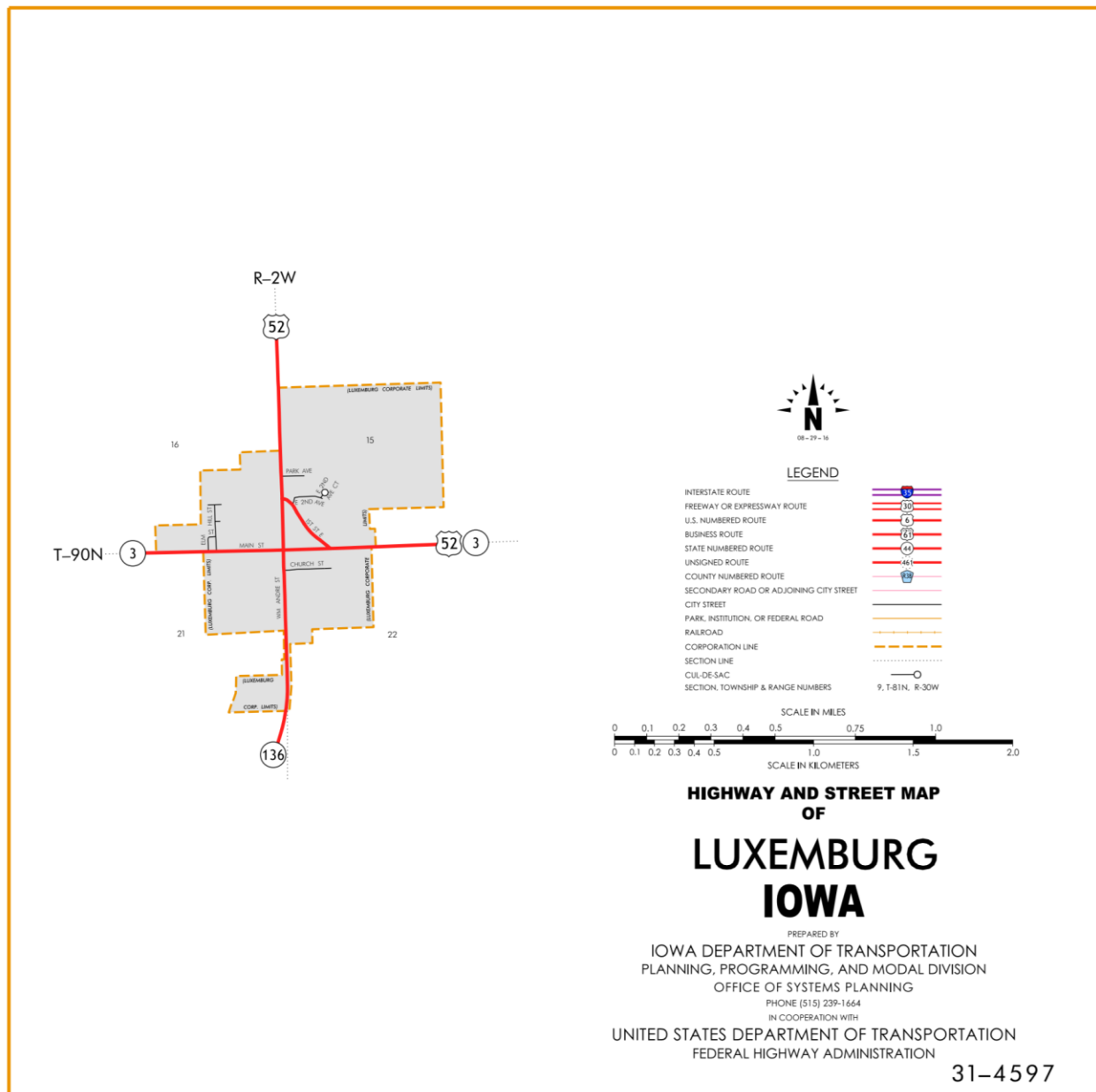

Luxemburg:

Beginning on Main Street at the west corporation line; thence east on Main Street to the east corporation line.

Beginning again on the east corporation line of Luxemburg connecting with Main Street; thence east following substantially the section line of Sections 22 and 23-T90N-R2W to a point approximately 1,300 feet west of the NE Corner of Section 23-T90N-R2W; thence in a southeasterly direction through Sections 23 and 24-T90N-R2W to a point approximately 500 feet west of the E $\frac{1}{4}$ Corner of Section 24-T90N-R2W; thence east following substantially the center section line of Section 24-T90N-R2W and Section 19-T90N-R1W to the west corporation line of Holy Cross.

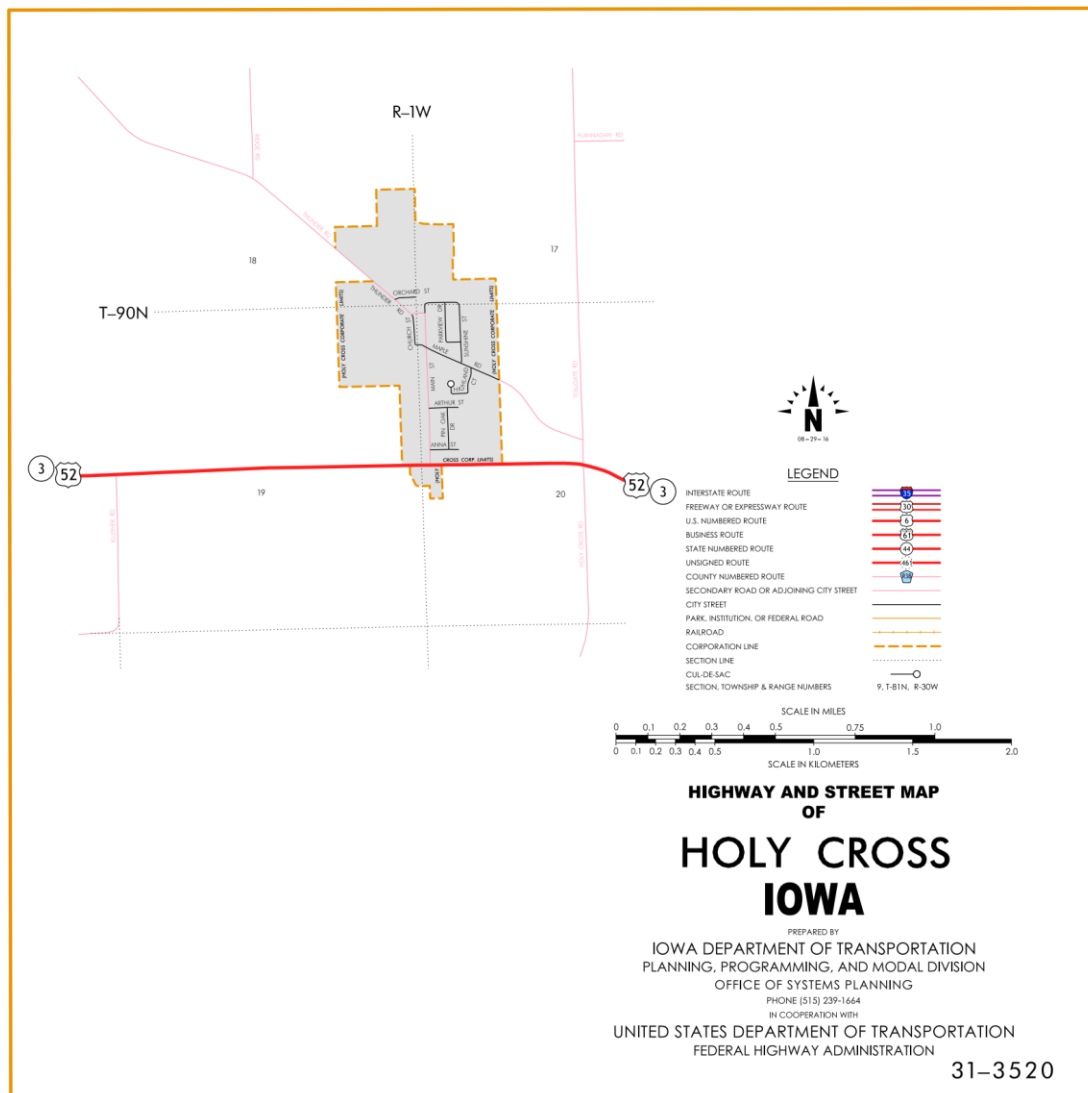

Holy Cross:

Beginning at the west corporation line; thence east to the east corporation line.

Beginning again at the west corporation line of Holy Cross; thence east to a point near the center of Section 20-T90N-R1W; thence in a southeasterly and easterly direction through Sections 20, 21, 28, 27, 26 and 25-T90N-R1W to the west corporation line of Rickardsville. and Section 30-T90N-R1E to the west corporation line of Rickardsville connecting with Main Street.

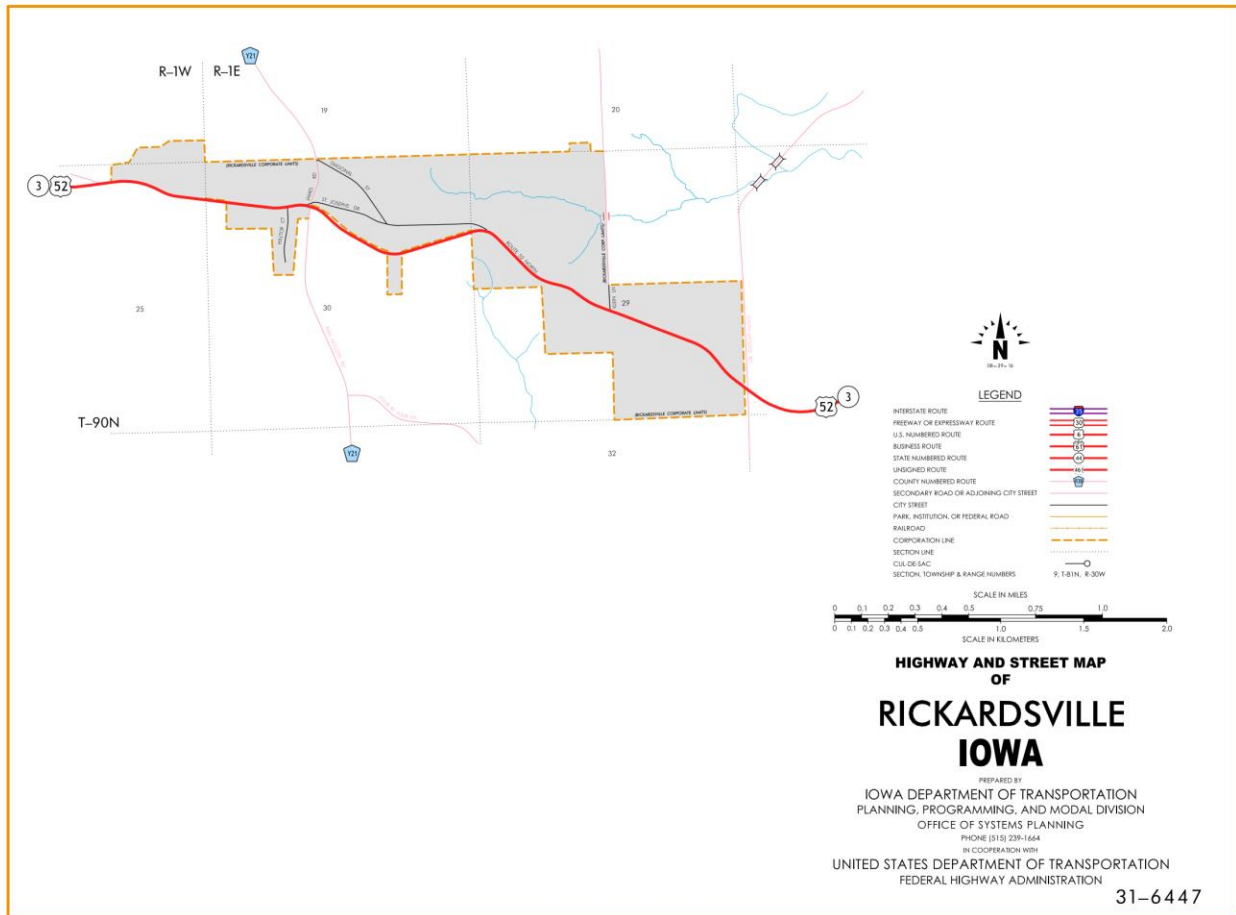

Rickardsville:

Beginning at the west corporation line; thence easterly to the east corporation line.

Beginning again at the west corporation line of Rickardsville (approximately 745 feet south of the NW Corner of Section 30-T90N-R1E); thence east through Section 30-T90N-R1E to the west corporation line of Rickardsville.

Rickardsville:

Beginning at the west corporation line; thence easterly to the east corporation line.

Beginning again on the east corporation line of Rickardsville, connecting with Main Street; thence southeast through Sections 30 and 29-T90N-R1E to the west corporation line of Rickardsville, connecting with Main Street.

Rickardsville:

Beginning again on Main Street at the west corporation line; thence southeast on Main Street to the east corporation line.

Beginning again on the east corporation line of Rickardsville, connecting with Main Street; southeasterly through Sections 28, 27, 26, 35 and 36-T90N-R1E, and Section 31-T90N-R2E to the west corporation line of Durango.

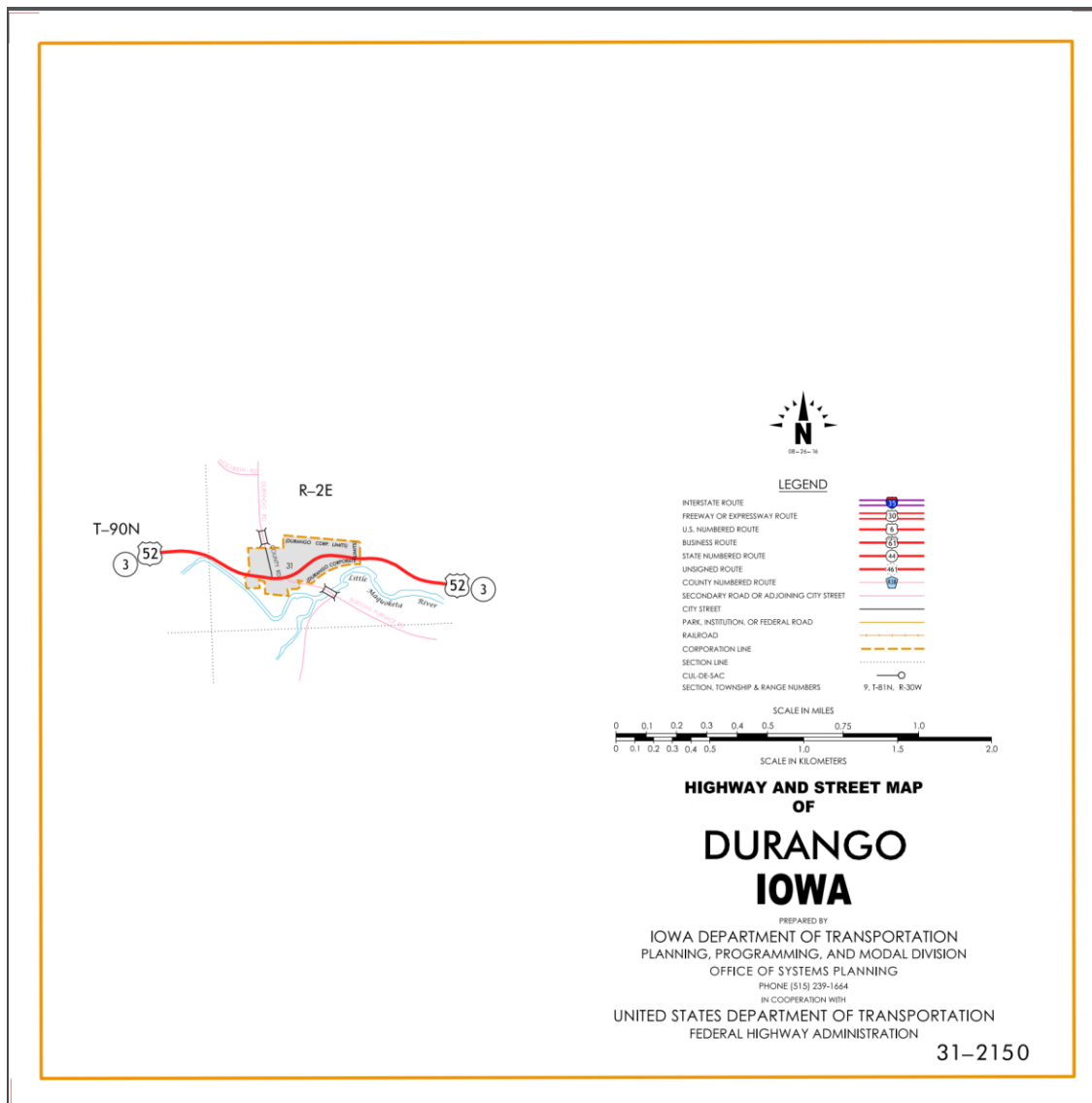

Durango:

Beginning at the west corporation line; thence easterly, northeasterly, and easterly to the east corporation line.

Beginning again on the east corporation line of Durango, connecting with an unnamed street; thence in an easterly and southeasterly direction through Sections 31 and 32-T90N-R2E and Section 5-T89N-TR2E to a point approximately 700 feet south and 700 feet west of the NE Corner of Section

5-T89N-R2E; thence in a northeasterly and southeasterly direction through Section 5-T89N-R2E and Section 33 T90N-R2E to the south corporation line of Sageville.

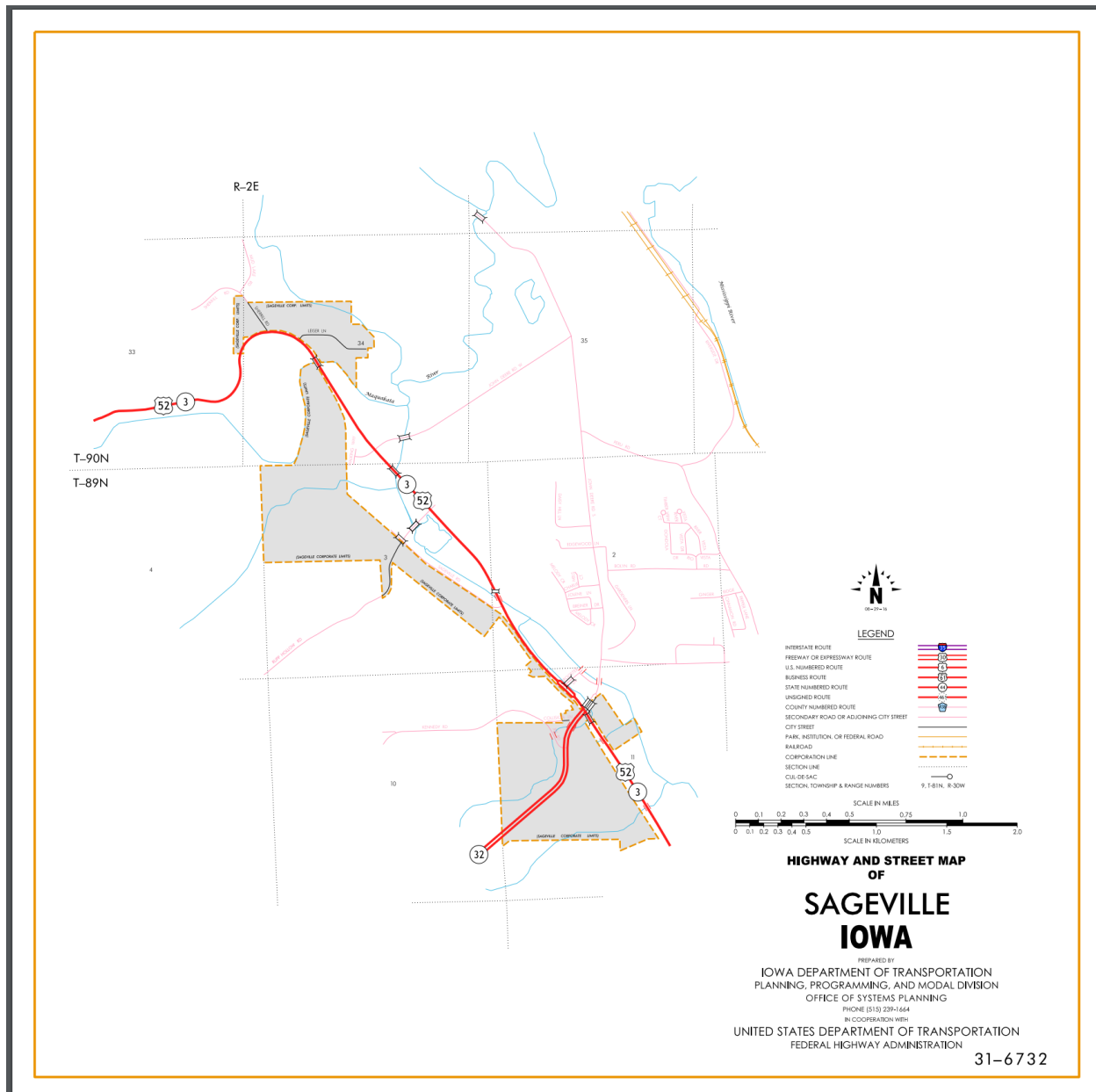

Sageville:

Beginning at the south corporation line; thence northeasterly to the east corporation line.

Beginning again at the east corporation line of Sageville; east and southeasterly through Section 34-T90N-R2E and Sections 3, 2 and 11-T89N-R2E to the north corporation line of Sageville.

Sageville:

Beginning at north corporation line; thence southeasterly to be south corporation line.

Beginning again at the south corporation line of Sageville; thence southeast through Section 11-T89N-R2E to the north corporation line of Dubuque, connecting with Central Avenue.

OFFICIAL ROUTE DESCRIPTION CHANGE

OFFICE: Research and Analytics

EFFECTIVE DATE: 10-30-2019

COUNTY: Dubuque

ROUTE: Iowa 3

ENTERED BY: Paul Mauer

ENTERED DATE: 10-30-2019

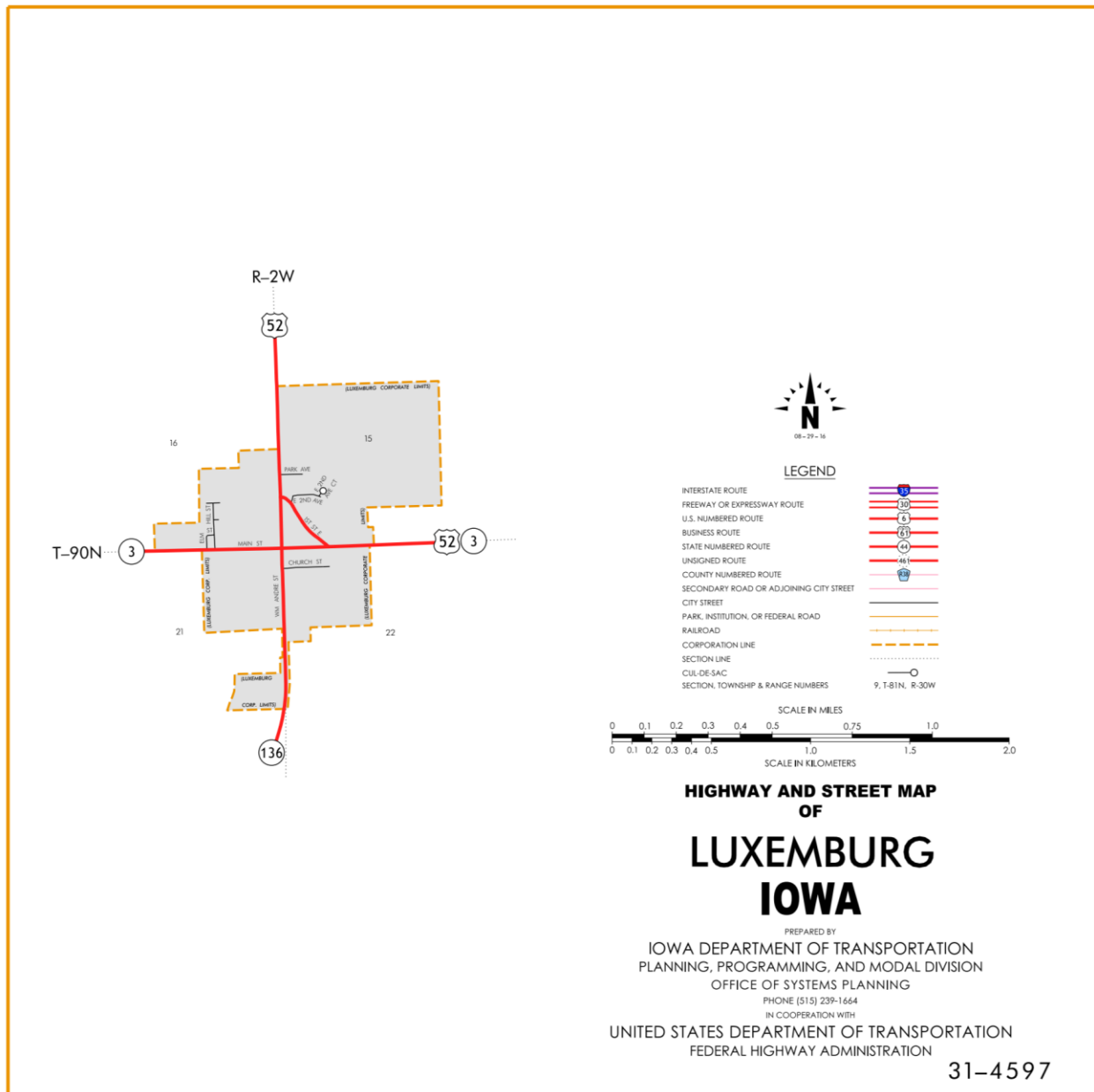

Luxemburg:

Beginning on Main Street at the west corporation line; thence east on Main Street to the east corporation line.

Beginning again on the east corporation line of Luxemburg connecting with Main Street; thence east following substantially the section line of Sections 22

and 23-T90N-R2W to a point approximately 1,300 feet west of the NE Corner of Section 23-T90N-R2W; thence in a southeasterly direction through Sections 23 and 24-T90N-R2W to a point approximately 500 feet west of the E ¼ Corner of Section 24-T90N-R2W; thence east following substantially the center section line of Section 24-T90N-R2W and Section 19-T90N-R1W to the west corporation line of Holy Cross.

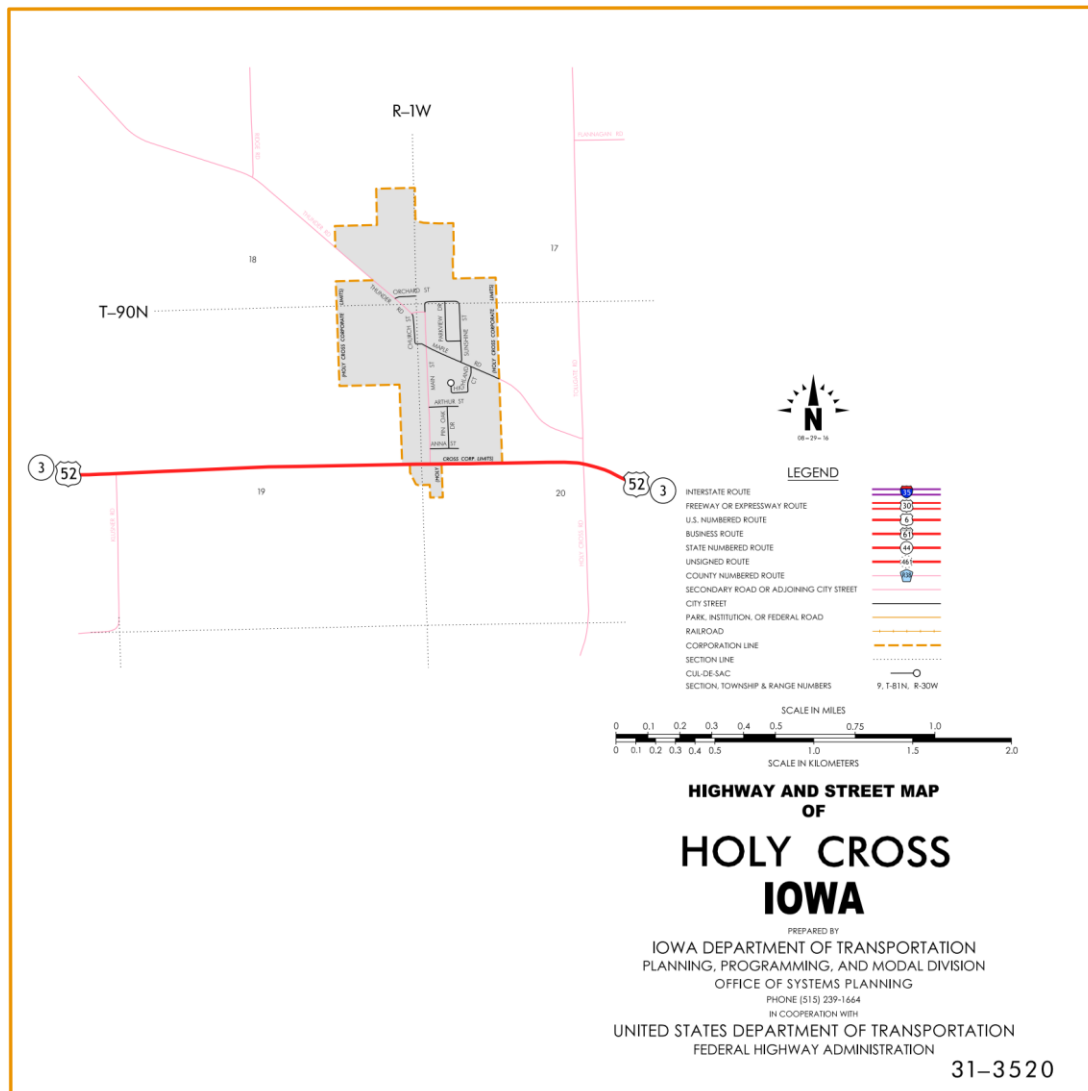

Holy Cross:

Beginning at the west corporation line; thence east to the east corporation line.

Beginning again at the west corporation line of Holy Cross; thence east to a point near the center of Section 20-T90N-R1W; thence in a southeasterly and easterly direction through Sections 20, 21, 28, 27, 26 and 25-T90N-R1W to the west corporation line of Rickardsville. and Section 30-T90N-R1E to the west corporation line of Rickardsville connecting with Main Street.

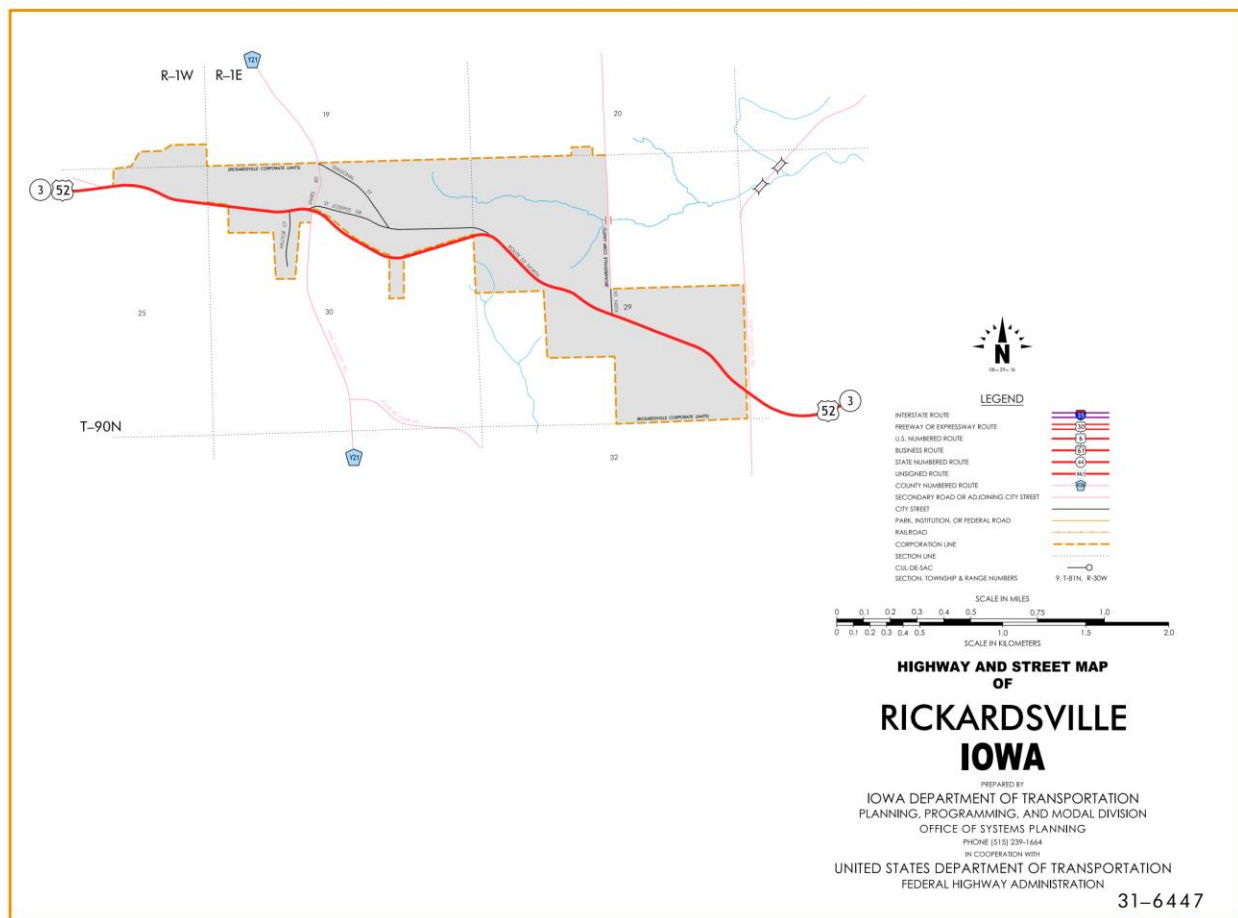

Rickardsville:

Beginning at the west corporation line; thence easterly to the east corporation line.

Beginning again at the west corporation line of Rickardsville (approximately 745 feet south of the NW Corner of Section 30-T90N-R1E); thence east through Section 30-T90N-R1E to the west corporation line of Rickardsville.

Rickardsville:

Beginning at the west corporation line; thence easterly to the east corporation line.

Beginning again on the east corporation line of Rickardsville, connecting with Main Street; thence southeast through Sections 30 and 29-T90N-R1E to the west corporation line of Rickardsville, connecting with Main Street.

Rickardsville:

Beginning again on Main Street at the west corporation line; thence southeast on Main Street to the east corporation line.

Beginning again on the east corporation line of Rickardsville, connecting with Main Street; southeasterly through Sections 28, 27, 26, 35 and 36-T90N-R1E, and Section 31-T90N-R2E to the west corporation line of Durango.

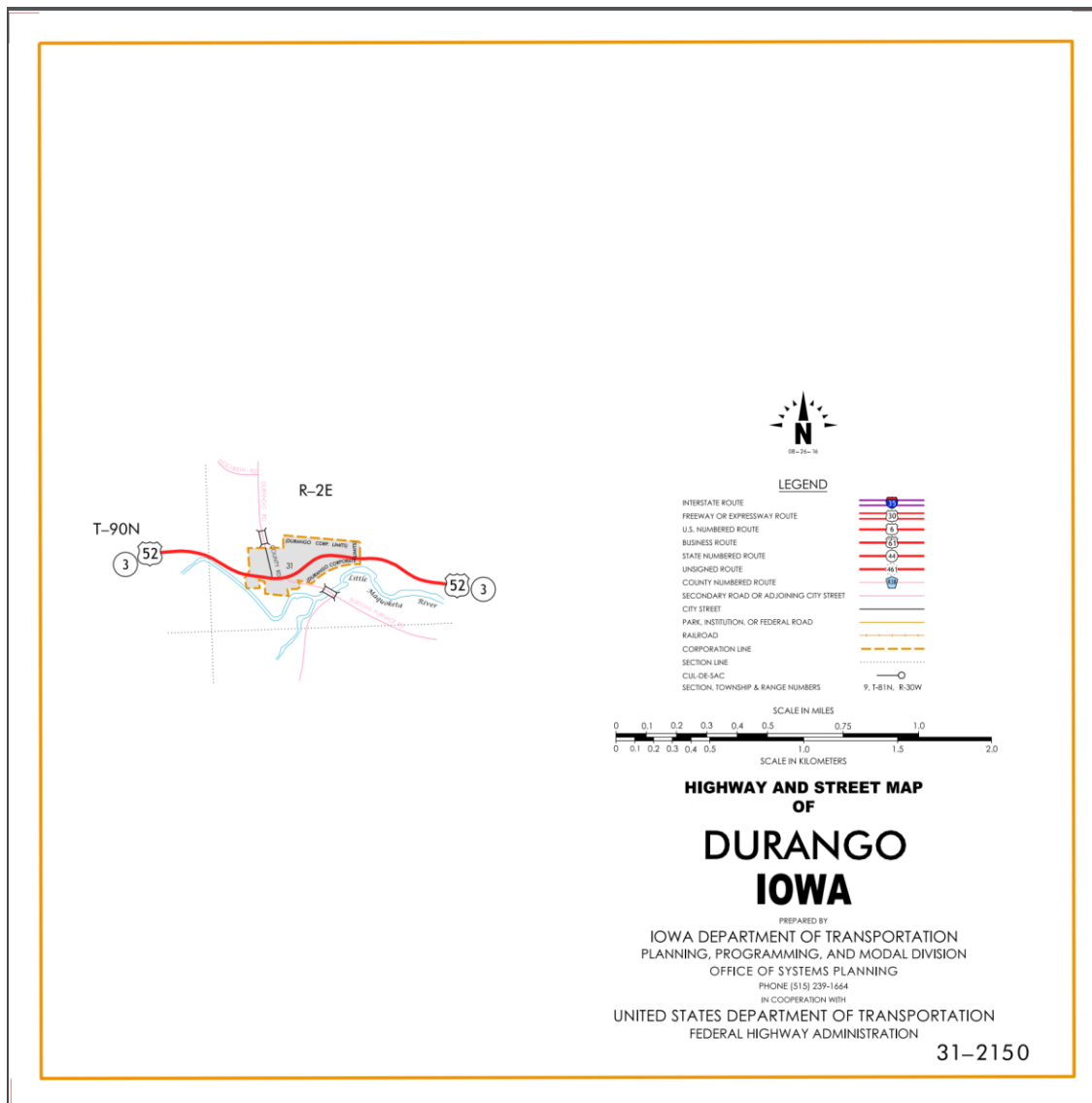

Durango:

Beginning at the west corporation line; thence easterly, northeasterly, and easterly to the east corporation line.

Beginning again on the east corporation line of Durango, connecting with an unnamed street; thence in an easterly and southeasterly direction through Sections 31 and 32-T90N-R2E and Section 5-T89N-TR2E to a point approximately 700 feet south and 700 feet west of the NE Corner of Section

5-T89N-R2E; thence in a northeasterly and southeasterly direction through Section 5-T89N-R2E and Section 33 T90N-R2E to the south corporation line of Sageville.

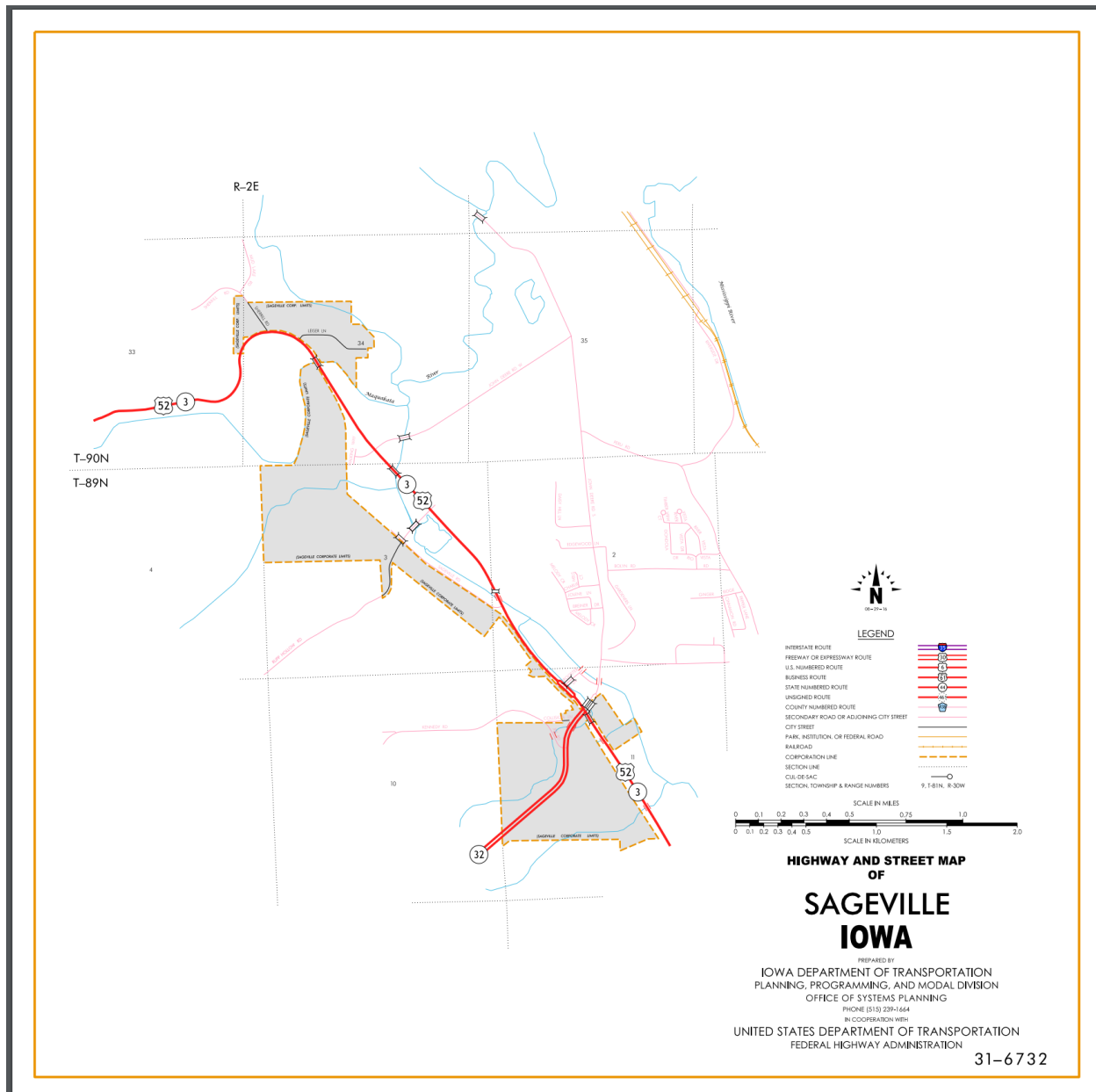

Sageville:

Beginning at the south corporation line; thence northeasterly to the east corporation line.

Beginning again at the east corporation line of Sageville; east and southeasterly through Section 34-T90N-R2E and Sections 3, 2 and 11-T89N-R2E to the north corporation line of Sageville.

Sageville:

Beginning at north corporation line; thence southeasterly to be south corporation line.

Beginning again at the south corporation line of Sageville; thence southeast through Section 11-T89N-R2E to the north corporation line of Dubuque, connecting with Central Avenue.

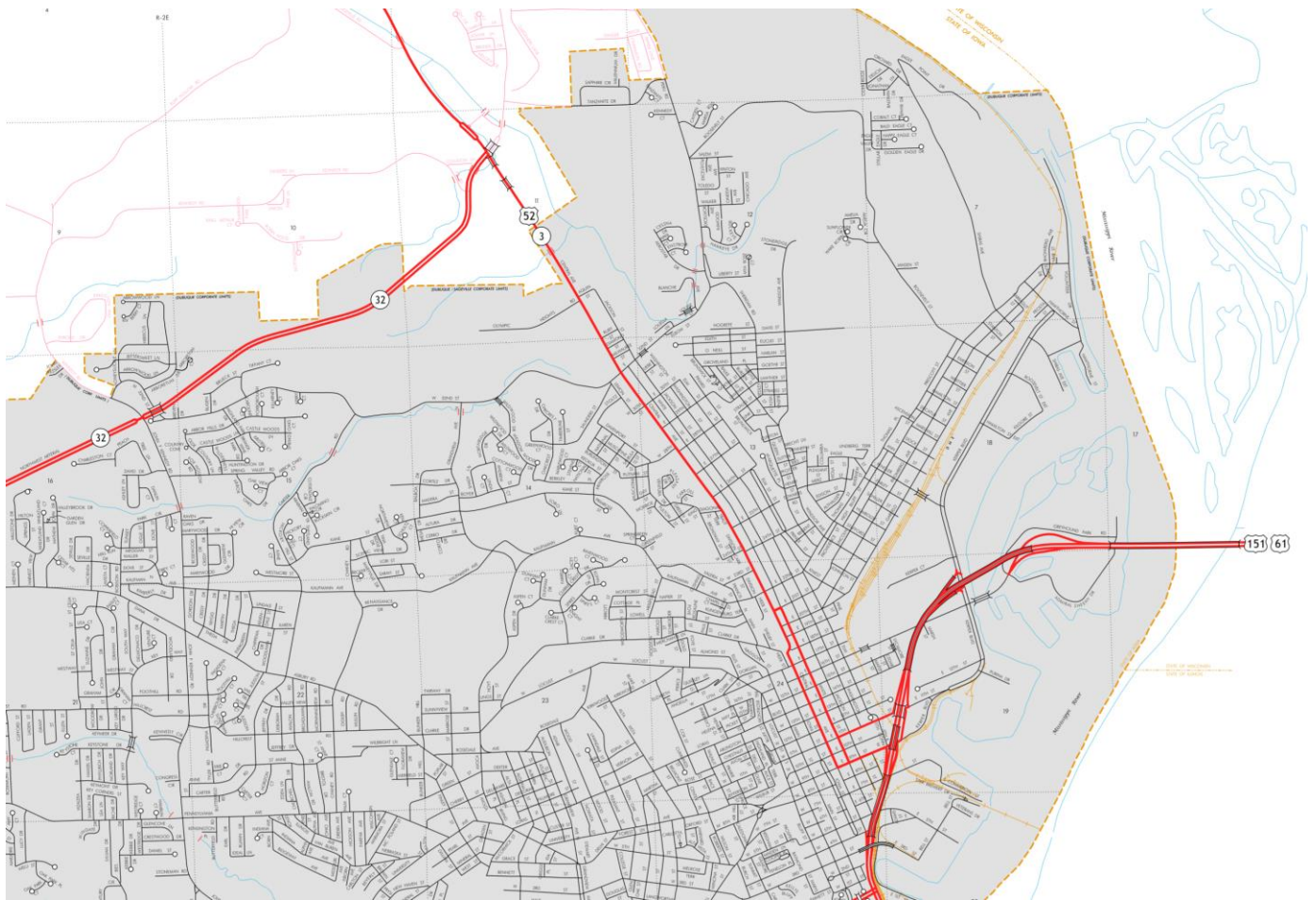

Dubuque:

Beginning on Central Avenue at the north corporation line; thence southeasterly on Central Avenue to 21st Street (begin one-way southbound); thence continuing southeasterly on Central Avenue to East 9th Street; thence northeasterly on East 9th Street to southbound on-ramp; thence southbound on US 61, US 151 and US 52 (end one-way southbound).

Also

Beginning at northbound off-ramp of US 61, US 151 and US 52 t near East 6th Street; thence northeast on off-ramp (begin one-way northbound) to 11th Street; thence southwesterly on 11th Street to White Street; thence northwesterly

on White Street to 21st Street; thence southwesterly on 21st Street to Central Avenue (end one-way northbound).

STAFF ACTION

OFFICE: Transportation Data

STAFF ACTION NUMBER: S-96-1235

SUBMITTED BY: Patrick R. Cain

SUBMITTAL DATE: 3-5-96

DISCUSSION/BACKGROUND:

Due to the relocation of Iowa 3 in Dubuque in 1993, the official description in the Primary Road System should be revised to reflect this change.

Transfer of Jurisdiction Agreement 93-TJ-004 between the Iowa Department of Transportation and the City of Dubuque transferred the section of Central Avenue to the city on October 18, 1993.

At the same time the section of White Street which was already the city's, but being used by the Department of Transportation was given back to the city.

PROPOSAL/ACTION RECOMMENDATION:

It is recommended that the old description of Iowa 3 in Dubuque County be deleted from the Primary Road System and the new description, as described in the attachment, be included in the Primary Road System.

New Description – Iowa 3 and its extensions in Dubuque County described as follows:

Beginning on the Dubuque–Delaware County line at a point approximately 600 feet south of the NW Corner of Section 19–T90N–R2W, Dubuque County (NE Corner of Section 24–T90N–R2W, Delaware County); thence northeast to a point approximately 1,100 feet east of the NW Corner of Section 19–T90N–R2W; thence east following substantially the section line of Sections 19, 20 and 21–T90N–R2W to the west corporation line of Luxemburg, connecting with Main Street.

Luxemburg:

Beginning on Main Street at the west corporation line; thence east on Main Street to the east corporation line.

Beginning again on the east corporation line of Luxemburg connecting with Main Street; thence east following substantially the section line of Sections 22 and 23–T90N–R2W to a point approximately 1,300 feet west of the NE Corner of Section 23–T90N–R2W; thence in a southeasterly direction through Sections 23 and 24–T90N–R2W to a point approximately 500 feet west of the E $\frac{1}{4}$ Corner of Section 24–T90N–R2W; thence east following substantially the center section line of Section 24–T90N–R2W and Sections 19 and 20–T90N–RIW to a point near the center of Section 20–T90N–RIW; thence in a southeasterly and easterly direction through Sections 20, 21, 28, 27, 26 and 25–T90N–RIW and Section 30–T90N–RIE to the west corporation line of Rickardsville connecting with Main Street.

Rickardsville:

Beginning on Main Street at the west corporation line; thence southeast on Main Street to the east corporation line.

Beginning again on the east corporation line of Rickardsville, connecting with Main Street; thence southeast through Sections 30 and 29–T90N–RIE to the west corporation line of Rickardsville, connecting with Main Street.

Rickardsville:

Beginning again on Main Street at the west corporation line; thence southeast on Main Street to the east corporation line.

Beginning again on the east corporation line of Rickardsville, connecting with Main Street; southeasterly through Sections 28, 27, 26, 35 and 36–T90N–R1E, and Section 31–T90N–R2E to the west corporation line of Durango, connecting with an unnamed street.

Durango:

Beginning on an unnamed street at the west corporation line; thence easterly, northeasterly, and easterly on unnamed street to the east corporation line.

Beginning again on the east corporation line of Durango, connecting with an unnamed street; thence in an easterly and southeasterly direction through Sections 31 and 32–T90N–R2E and Section 5–T89N–TR2E to a point approximately 700 feet south and 700 feet west of the NE Corner of Section 5–T89N–R2E; thence in a northeasterly and southeasterly direction through Section 5–T89N–R2E and Sections 33 and 34–T90N–R2E and in a southeasterly direction through Sections 3, 2 and 11–T89N–R2E to the north corporation line of Dubuque, connecting with Central Avenue.

Dubuque:

Beginning on Central Avenue at the north corporation line; thence southeasterly on Central Avenue to 21st Street (begin one-way southbound); thence continuing southeasterly on Central Avenue to East 9th Street; thence northeasterly on East 9th Street to southbound on-ramp; thence southbound to unnamed street (end one-way southbound).

Also

Beginning at northbound off-ramp of unnamed street near East 6th Street; thence northeast on off-ramp (begin one-way northbound) to 11th Street; thence southwesterly on 11th Street to White Street; thence northwesterly on White Street to 21st Street; thence southwesterly on 21st Street to Central Avenue (end one-way northbound).

STAFF ACTION

OFFICE: Transportation Data

STAFF ACTION NUMBER: S-96-1236

SUBMITTED BY: Patrick R. Cain

SUBMITTAL DATE: 2-14-96

DISCUSSION/BACKGROUND:

Due to the relocation of several routes in Dubuque in 1991, the routing for Iowa 3 was revised and the official description in the Primary Road System should be revised to reflect this change.

PROPOSAL/ACTION RECOMMENDATION:

It is recommended that the old description of Iowa 3 in Dubuque County be deleted from the Primary Road System and the new description, as described in the attachment, be included in the Primary Road System.

New Description – Iowa 3 and its extensions in Dubuque County described as follows:

Beginning on the Dubuque-Delaware County line at a point approximately 600

feet south of the NW Corner of Section 19-T90N-R2W, Dubuque County (NE Corner of Section 24-T90N-R2W, Delaware County); thence northeast to a point approximately 1,100 feet east of the NW Corner of Section 19-T90N-R2W; thence east following substantially the section line of Sections 19, 20 and 21-T90N-R2W to the west corporation line of Luxemburg, connecting with Main Street.

Luxemburg:

Beginning on Main Street at the west corporation line; thence east on Main Street to the east corporation line.

Beginning again on the east corporation line of Luxemburg connecting with Main Street; thence east following substantially the section line of Sections 22 and 23-T90N-R2W to a point approximately 1,300 feet west of the NE Corner of Section 23-T90N-R2W; thence in a southeasterly direction through Sections 23 and 24-T90N-R2W to a point approximately 500 feet west of the E $\frac{1}{4}$ Corner of Section 24-T90N-R2W; thence east following substantially the center section line of Section 24-T90N-R2W and Sections 19 and 20-T90N-RIW to a point near the center of Section 20-T90N-RIW; thence in a southeasterly and easterly direction through Sections 20, 21, 28, 27, 26 and 25-T90N-RIW and Section 30-T90N-RIE to the west corporation line of Rickardsville connecting with Main Street.

Rickardsville:

Beginning on Main Street at the west corporation line; thence southeast on Main Street to the east corporation line.

Beginning again on the east corporation line of Rickardsville, connecting with Main Street; thence southeast through Sections 30 and 29-T90N-RIE to the west corporation line of Rickardsville, connecting with Main Street.

Rickardsville:

Beginning again on Main Street at the west corporation line; thence southeast on Main Street to the east corporation line.

Beginning again on the east corporation line of Rickardsville, connecting with Main Street; southeasterly through Sections 28, 27, 26, 35 and 36-T90N-R1E, and Section 31-T90N-R2E to the west corporation line of Durango, connecting with an unnamed street.

Durango:

Beginning on an unnamed street at the west corporation line; thence easterly, northeasterly and easterly on unnamed street to the east corporation line.

Beginning again on the east corporation line of Durango, connecting with an unnamed street; thence in an easterly and southeasterly direction through Sections 31 and 32-T90N-R2E and Section 5-T89N-TR2E to a point approximately 700 feet south and 700 feet west of the NE Corner of Section 5-T89N-R2E; thence in a northeasterly and southeasterly direction through Section 5-T89N-TR2E and Sections 33 and 34-T90N-R2E and in a southeasterly direction through Sections 3, 2 and 11-T89N-R2E to the north corporation line of Dubuque, connecting with Central Avenue.

Dubuque:

Beginning on Central Avenue at the north corporation line; thence southeasterly on Central Avenue to 21st Street (begin one-way southbound); thence continuing southeasterly on Central Avenue to 4th Street (end one-way southbound).

Also

Beginning at the intersection of 4th and White Street (begin one-way northbound); thence northwesterly on White Street to 21st Street; thence southwesterly on 21st Street to Central Avenue (end one-way northbound).

OFFICIAL DESCRIPTION CHANGE

COUNTY: Dubuque

ROUTE: Iowa 3

STAFF ACTION NUMBER: S-87-718

APPROVAL DATE: 12-18-86

New Description – Iowa 3 and its extensions in Dubuque County described as follows:

Beginning on the Dubuque-Delaware county line at a point approximately 600 feet south of the NW Corner of Section 19-T90N-R2W, Dubuque County (NE Corner of Section 24-T90N-R2W, Delaware County); thence northeast to a point approximately 1,100 feet east of the NW Corner of Section 19-T90N-R2W; thence east following substantially the section line of Sections 19, 20, and 21-T90N-R2W to the west corporation line of Luxemburg, connecting with Main Street.

Luxemburg:

Beginning on Main Street at the west corporation line; thence east on Main Street to the east corporation line.

Beginning again on the east corporation line of Luxemburg connecting with Main Street; thence east following substantially the section line of Sections 22 and 23-T90N-R2W to a point approximately 1,300 feet west of the NE Corner of Section 23-T90N-R2W; thence in a southeasterly direction through Sections

23 and 24-T90N-R2W to a point approximately 500 feet west of the E ¼ Corner of Section 24-T90N-R2W; thence east following substantially the center section line of Section 24-T90N-R2W and Sections 19 and 20-T90N-R1W to a point near the center of Section 20-T90N-R1W; thence in a southeasterly and easterly direction through Sections 20, 21, 28, 27, 26, and 25-T90N-R1W and Section 30-T9N-R1E to the west corporation line of Rickardsville connecting with Main Street.

Rickardsville:

Beginning on Main Street at the west corporation line; thence southeast an Main Street to the east corporation line.

Beginning again on the east corporation line of Rickardsville, connecting with Main Street; thence southeast through Sections 30 and 29-T90N-R1E to the west corporation line of Rickardsville, connecting with Main Street.

Rickardsville:

Beginning again on Main Street at the west corporation line; thence southeast on Main Street to the east corporation line.

Beginning again on the east corporation line of Rickardsville, connecting with Main Street; southeasterly through Sections 28, 27, 26, 35, and 36-T90N-R1E, and Section 31-T90N-R2E to the west corporation line of Durango, connecting with an unnamed street.

Durango:

Beginning on an unnamed street at the west corporation line; thence easterly, northeasterly and easterly on unnamed street to the east corporation line.

Beginning again on the east corporation line of Durango, connecting with an unnamed street; thence in an easterly and southeasterly direction through Sections 31 and 32-T90N-R2E and Section 5-T89N-R2E to a point approximately 700 feet south and 700 feet west of the NE Corner of Section 5-T89N-R2E; thence in a northeasterly and southeasterly direction through Section 5-T89N-R2E and Sections 33 and 34-T90N-R2E and in a southeasterly direction through Sections 3, 2, and 11-T89N-R2E to the north corporation line of Dubuque, connecting with Central Avenue.

Dubuque:

Beginning on Central Avenue at the north corporation line; thence southeasterly on Central Avenue to 21st Street (Begin one-way southbound); thence continuing southeasterly on Central Avenue to 5th Street; thence southwesterly on 5th Street to Bluff Street; thence southeasterly on Bluff Street to Dodge Street (US 20) (end one-way southbound).

Also with a spur

Beginning at the intersection of Dodge and Locust Street; thence northerly (one-way northbound) and Locust Street to 4th Street; thence easterly an 4th Street to White Street; thence northwesterly on White Street to 21st Street; thence southwesterly on 21st Street to Central Avenue (end one-way northbound).

COMMISSION ORDER

DIVISION: Planning & Research

COMMISSION ORDER NUMBER: PR-82-746

SUBMITTED BY: Patrick R. Cain

MEETING DATE: 6-8-82

DISCUSSION/BACKGROUND:

In Dubuque County, Iowa 3 begins at the Delaware County line approximately three miles west of Luxemburg, and travels in an easterly and southeasterly direction to US 20 in the City of Dubuque via the cities of Luxemburg, Rickardsville, Durango and Dubuque.

The official description of Iowa 3 in Dubuque County was found to be incorrect in our official records. The existing description should be replaced with the corrected version.

PROPOSAL/ACTION RECOMMENDATION:

It is recommended the commission approve deleting the present description of Iowa 3 in Dubuque County from the primary road system and approve including the attached new description of Iowa 3 in the primary road system.

Locate Iowa 3 and its extensions in Dubuque County as follows:

Beginning on the Dubuque–Delaware county line at a point approximately 600 feet south of the NW Corner of Section 19–T90N–R2W, Dubuque County (NE Corner of Section 24–T90N–R2W, Delaware County); thence in a northeasterly direction to a point approximately 1,100 feet east of the NW Corner of Section 19–T90N–R2W; thence east following substantially the section line of Sections 19, 20, and 21–T90N–R2W to the west corporation line of the City of Luxemburg, connecting with an unnamed street.

Luxemburg:

Beginning at the west corporation line connecting with an unnamed street; thence easterly to the east corporation line connecting with an unnamed street.

Beginning again on the east corporation line of the City of Luxemburg connecting with an unnamed street; thence east following substantially the section line of Sections 22 and 23-T90N-R2W to a point approximately 1300 feet west of the NE Corner of Section 23-T90N-R2W; thence in a southeasterly direction through Sections 23 and 24-T90N-R2W to a point approximately 500 feet west of the E $\frac{1}{4}$ Corner of Section 24-T90N-R2W; thence east following substantially the center section line of Section 24-T90N-R2W and Sections 19 and 20-T90N-R1W to a point near the center of Section 20-T90N-R1W; thence in a southeasterly and easterly direction through Sections 20, 21, 28, 27, 26, and 25-T90N-R1W and Section 30-T90N-R1E to the west corporation line of the City of Rickardsville connecting with an unnamed street.

Rickardsville:

Beginning at the west corporation line connecting with an unnamed street; thence easterly to the east corporation line.

Beginning again on the east corporation line of the City of Rickardsville, connecting with an unnamed street; thence southeasterly through Sections 30 and 29-T90N-R1E to the west corporation line of the City of Rickardsville, connecting with an unnamed street.

Rickardsville:

Beginning again on the west corporation line connecting with an unnamed street; thence southeasterly to the east corporation line connecting with an unnamed street.

Beginning again on the east corporation line of the City of Rickardsville, connecting with an unnamed street; southeasterly through Sections 28, 27, 26, 35, and 36-T90N-R1E, and Section 31-T90N-R2E to the west corporation line of the City of Durango, connecting with an unnamed street.

Durango:

Beginning at the west corporation line connecting with an unnamed street; thence easterly, northeasterly and easterly to the east corporation line connecting with an unnamed street.

Beginning again on the east corporation line of the City of Durango, connecting with an unnamed street; thence in an easterly and southeasterly direction through Sections 31 and 32-T90N-R2E and Section 5-T89N-R2E to a point approximately 700 feet south and 700 feet west of the NE Corner of Section 5-T89N-R2E; thence in a northeasterly and southeasterly direction through Sections 5 and 4-T89N-R2E and Sections 33 and 34-T90N-R2E and in a southeasterly direction through Sections 3, 2, and 11-T89N-R2E to the north corporation line of the City of Dubuque, connecting with an unnamed street.

Dubuque:

Beginning on the north corporation line connecting with an unnamed street; thence southeasterly, southwesterly, and southeasterly to Dodge Street.

Also with a spur

Beginning at the intersection of Dodge and Locust Streets; thence northerly (one-way northbound), northeasterly, northwesterly, and westerly to Central Avenue (end one-way northbound).

COMMISSION ORDER

DIVISION: Planning & Research

COMMISSION ORDER NUMBER: PR-79-272

SUBMITTED BY: C.I. MacGillivray

MEETING DATE: 11-2-78

DISCUSSION/BACKGROUND:

Due to a review of our Primary Road System records, Iowa 3 in Dubuque County should be deleted and the new description added should be officially included into the Primary Road System.

Iowa 3 begins at the Dubuque-Delaware County line approximately 3 miles west of Luxemburg traveling in an easterly and southeasterly direction to junction US 20 in Dubuque via the cities of Luxemburg, Rickardsville, Durango, and Dubuque, Iowa.

PROPOSAL/ACTION RECOMMENDATION:

Locate Iowa 3 and its extensions in Dubuque County as follows:

Beginning on the Dubuque-Delaware County line at a point approximately 600 feet south of the NW Corner of Section 19-T90N-R2W, Dubuque County (NE Corner of Section 24-T90N-R2W, Delaware County); thence in a northeasterly direction to a point approximately 1,100 feet east of the NW Corner of Section 19-T90N-R2W; thence east following substantially the section line of Sections 19, 20, and 21-T90N-R2W to the west corporation line of the City of Luxemburg, connecting with an unnamed street.

Luxemburg:

Beginning at the west corporation line connecting with an unnamed street; thence easterly to the east corporation line connecting with an unnamed street.

Beginning again on the east corporation line of the City of Luxemburg connecting with an unnamed street; thence east following substantially the section line of Sections 22 and 23-T90N-R2W to a point approximately 1300

feet west of the NE Corner of Section 23–T90N–R2W; thence in a southeasterly direction through Sections 23 & 24–T90N–R2W to a point approximately 500 ft. west of the E ¼ Corner of Section 24–T90N–R2W; thence east following substantially the center of section line of Section 4–T90N–R2W and Sections 19 and 20–T90N–R1W to a point near the center of Section 20–T90N–R1W; thence in a southeasterly and easterly direction through Sections 20, 21, 28, 27, 26, and 25–T90N–R1W and Section 30–T90N–R1E to the west corporation line of the City of Rickardsville connecting with an unnamed street.

Rickardsville:

Beginning at the west corporation line connecting with an unnamed street; thence easterly to the east corporation line.

Beginning again on the east corporation line of the City of Rickardsville, connecting with an unnamed street; thence southeasterly through Section 30–T90N–R1E to the west corporation line of the City of Rickardsville, connecting with an unnamed street.

Rickardsville:

Beginning again on the west corporation line connecting with an unnamed street; thence southeasterly to the east corporation line connecting with an unnamed street.

Beginning again on the east corporation line of the City of Rickardsville, connecting with an unnamed street, southeasterly through Sections 28, 27, 26, 35, and 36–T90N–R1E, and Section 31–T90N–R2E to the west corporation line of the City of Durango, connecting with an unnamed street.

Durango:

Beginning at the west corporation line connecting with an unnamed street; thence easterly, northeasterly and easterly to the east corporation line connecting with an unnamed street.

Beginning again on the east corporation line of the City of Durango, connecting with an unnamed street; thence in an easterly and southeasterly direction through Sections 31 and 32-T90N-R2E and Section 5-T89N-R2E to a point approximately 700 feet south and 700 feet west of the NE Corner of Section 5-T89N-R2E; thence in a northeasterly and southeasterly direction through Section 5-T89N-R2E and Sections 33 and 34-T90N-R2E and in a southeasterly direction through Sections 3, 2, and 11-T89N-R2E to the north corporation line of the City of Dubuque, connecting with an unnamed street.

Dubuque:

Beginning on the north corporation line connecting with an unnamed street; thence southeasterly, southwesterly, and southeasterly to Dodge Street.

Also with a spur

Beginning at the intersection of Dodge and Locust Streets; thence northerly (one-way northbound), northeasterly, northwesterly, and westerly to Central Avenue (end one-way northbound).

NOW, THEREFORE: Be it resolved that the Iowa Department of Transportation approve the location of Iowa 3, Dubuque County, Iowa.

NOTE: To become effective upon the adoption of this resolution.

REVISED: 6-8-82

COMMISSION ORDER

DIVISION: Planning & Research

SUBMITTED BY: Raymond L. Kassel

MEETING DATE: 10-5-76

DISCUSSION/BACKGROUND:

Due to a review of our Primary Road System records, Iowa 3 in Dubuque County should be deleted and the new description added should be officially included into the Primary Road System.

Iowa 3 begins at the Dubuque–Delaware County line approximately 3 miles west of Luxemburg traveling in an easterly and southeasterly direction to junction US 20 in Dubuque via the cities of Luxemburg, Rickardsville, Durango, and Dubuque, Iowa.

PROPOSAL/ACTION RECOMMENDATION:

Locate Iowa 3 and its extensions in Dubuque County as follows:

Beginning on the Dubuque–Delaware County line at a point approximately 600 feet south of the NW Corner of Section 19–T90N–R2W, Dubuque County (NE Corner of Section 24–T90N–R2W, Delaware County); thence in a northeasterly direction to a point approximately 1,100 feet east of the NW Corner of Section 19–T90N–R2W; thence east following substantially the section line of Sections 19, 20, and 21–T90N–R2W to the west corporation line of the City of Luxemburg, connecting with an unnamed street.

Luxemburg:

Beginning at the west corporation line connecting with an unnamed street; thence easterly to the east corporation line connecting with an unnamed street.

Beginning again on the east corporation line of the City of Luxemburg connecting with an unnamed street; thence east following substantially the section line of Sections 22 and 23-T90N-R2W to a point approximately 1300 feet west of the NE Corner of Section 23-T90N-R2W; thence in a southeasterly direction through Sections 23 & 24-T90N-R2W to a point approximately 500 ft. west of the E $\frac{1}{4}$ Corner of Section 24-T90N-R2W; thence east following substantially the center of section line of Section 24-T90N-R2W and Sections 19 and 20-T90N-R1W to a point near the center of Section 20-T90N-R1W; thence in a southeasterly and easterly direction through Sections 20, 21, 28, 27, 26, and 25-T90N-R1W and Section 30-T90N-R1E to the west corporation line of the City of Rickardsville connecting with an unnamed street.

Rickardsville:

Beginning at the west corporation line connecting with an unnamed street; thence easterly to the east corporation line.

Beginning again on the east corporation line of the City of Rickardsville, connecting with an unnamed street; thence southeasterly through Section 30-T90N-R1E to the west corporation line of the City of Rickardsville, connecting with an unnamed street.

Rickardsville:

Beginning again on the west corporation line connecting with an unnamed street; thence southeasterly to the east corporation line connecting with an unnamed street.

Beginning again on the east corporation line of the City of Rickardsville, connecting with an unnamed street, southeasterly through Sections 28, 27, 26, 35, and 36-T90N-R1E, and Section 31-T90N-R2E to the west corporation line of the City of Durango, connecting with an unnamed street.

Durango:

Beginning at the west corporation line connecting with in unnamed street; thence easterly, northeasterly and easterly to the east corporation line connecting with an unnamed street.

Beginning again on the east corporation line of the City of Durango, connecting with an unnamed street; thence in an easterly and southeasterly direction through Sections 31 and 32-T90N-R2E and Section 5-T89N-R2E to a point approximately 700 feet south and 700 feet west of the NE Corner of Section 5-T89N-R2E; thence in a northeasterly and southeasterly direction through Section 5-T89N-R2E and Sections 33 and 34-T90N-R2E and in a southeasterly direction through Sections 3, 2, and 11-T89N-R2E to the north corporation line of the City of Dubuque, connecting with an unnamed street.

Dubuque:

Beginning on the north corporation line connecting with an unnamed street; thence southeasterly, southwesterly, and southeasterly to Dodge Street.

Also with a spur

Beginning at the intersection of Dodge and Locust Streets; thence northerly (one-way northbound), northeasterly, northwesterly, and westerly to Central Avenue (end one-way northbound).

NOW, THEREFORE: Be it resolved that the Iowa Department of Transportation approve the location of Iowa 3, Dubuque County, Iowa.

NOTE: To become effective upon the adoption of this resolution.

COMMISSION ORDER

DIVISION: Planning & Research

SUBMITTED BY: Raymond L. Kassel

DISCUSSION/BACKGROUND:

Iowa 3 was relocated north of Dubuque. The new alignment of Iowa 3 in Dubuque County should be officially included in the State Primary System. In accord with the project agreement with the Dubuque County Board of Supervisors, disposition of sections of the old alignment should be made.

PROPOSAL/ACTION RECOMMENDATION:

Locate Iowa 3 and its extension in Dubuque County as follows:

Beginning on the Dubuque-Delaware County Line at a point approximately 600 feet south of the NW Corner of Section 19-T90N-R2W, Dubuque County (NE Corner of Section 24-T90N-R3W, Delaware County); thence in a northeasterly direction to a point approximately 1,100 feet east of the NW Corner of Section 19-T90N-R2W; thence east following substantially the section line to the west corporation line of the City of Luxemburg, connecting with Main Street.

Beginning again on the east corporation line of the City of Luxemburg connecting with Main Street; thence east following substantially the section line to a point approximately $\frac{1}{4}$ mile west of the NE Corner of Section 23-T90N-R2W; thence in a southeasterly direction to a point approximately 500 feet west of the E $\frac{1}{4}$ Corner of Section 24-T90N-R2W; thence east following substantially the quarter section line to a point near the center of Section 20-T90N-R1W; thence in an easterly direction through Sections 20, 21, 28, 27, 26, and 25-T90N-R1W to the west corporation line of the City of Rickardsville connecting with Main Street.

Beginning again on the east corporation line of the City of Rickardsville, connecting with Main Street; thence southeasterly to the west corporation line of the City of Rickardsville, connecting with Main Street.

Beginning again on the east corporation line of the City of Rickardsville, connecting with Main Street; southeasterly through Sections 28, 27, 26, 35 and 36-T90N-R1E, and part of Section 31-T90N-R2E to the west corporation line of the City of Durango, connecting with an unnamed street.

Beginning again on the east corporation line of the City of Durango, connecting with an unnamed street on the north side of the Chicago Great Western Railroad; thence in an easterly and southeasterly direction along the north side of the Chicago Great Western Railroad and substantially parallel thereto through Sections 31 and 32-T90N-R2E and Section 5-T89N-R2E to a point approximately 700 feet south and 700 feet west of the NE Corner of Section 5-T89N-R2E; thence in a northeasterly and southeasterly direction through Sections 33 and 34-T90N-R2E and in a northeasterly direction through Section 3, 2 and 11-T89N-R2E to the north corporation line of the City of Dubuque, connecting with Central Avenue.

Rickardsville

Commencing on Main Street on the west corporation line; thence easterly to the east corporation line.

Beginning again on the west corporation line connecting with Main Street; thence southeasterly to the east corporation line.

Dubuque

Beginning on the north corporation line connecting with Central Avenue; thence southeasterly on Central Avenue to 21st Street (begin one-way southbound);

thence continuing southeasterly on Central Avenue to 5th Street; thence southwesterly on 5th Street to Bluff Street; thence southeasterly on Bluff Street to Dodge Street (US 20) (end one-way southbound).

Beginning at the intersection of Dodge and Locust Streets; thence northerly (one-way northbound) and Locust Street to Fourth Street; thence easterly on Fourth Street to White Street; thence northwesterly on White Street to Twenty-first Street; thence southwesterly on Twenty-first Street to Central Avenue (End one-way northbound); thence northwesterly on Central Avenue to the north corporation line.

NOW, THEREFORE: Be it resolved that the Iowa Department of Transportation approve the location of Iowa 3 and its extension in Dubuque County, Iowa.

NOTE: In accordance with the Agreement signed by the Dubuque County Board of Supervisors, dated September 3, 1974, two sections of old Iowa 3, the first from approximately 300 feet north of the intersection with Rupp Road southerly approximately six tenths (0.6) of a mile to the connection of old Iowa 3 with new Iowa 3, the second, a short 500 foot section of old Iowa 3 just west of the north junction of Iowa 386 and new Iowa 3 will revert to the Dubuque County Secondary System. This is to become effective upon adoption of this resolution.

OFFICIAL DESCRIPTION CHANGE

COUNTY: Dubuque

CITY OF: Dubuque

ROUTE: Iowa 3

APPROVAL DATE: 3-9-76

Beginning on the north corporation line connecting with Central Avenue; thence southeasterly on Central Avenue to 21st Street (begin one-way southbound); thence continuing southeasterly on Central Avenue to 5th Street; thence southwesterly on 5th Street to Bluff Street; thence southeasterly on Bluff Street to Dodge Street (US 20) (end one-way southbound).

Beginning at the intersection of Dodge and Locust Streets; thence northerly (one-way northbound) and Locust Street to Fourth Street; thence easterly on Fourth Street to White Street; thence northwesterly on White Street to Twenty-first Street; thence southwesterly on Twenty-first Street to Central Avenue (end one-way northbound); thence northwesterly on Central Avenue to the north corporation line.

OFFICIAL DESCRIPTION CHANGE

COUNTY: Dubuque

ROUTE: Iowa 3

APPROVAL DATE: 3-9-76

Beginning on the Dubuque-Delaware County line at a point approximately 600 feet south of the NW Corner of Section 19-T90N-R2W, Dubuque County (NE Corner of Section 24-T90N-R3W, Delaware County); thence in a northeasterly direction to a point approximately 1,100 feet east of the NW Corner of Section 19-T90N-R2W; thence east following substantially the section line to the west corporation line of the City of Luxemburg, connecting with Main Street.

Beginning again on the east corporation line of the City of Luxemburg connecting with Main Street; thence east following substantially the section line to a point approximately $\frac{1}{4}$ mile west of the NE Corner of Section 23-T90N-R2W; thence in a southeasterly direction to a point approximately 500 feet west of the E $\frac{1}{4}$ Corner of Section 24-T90N-R2W; thence east following substantially the quarter section line to a point near the center of Section 20-T90N-R1W; thence in an easterly direction through Sections 20, 21, 28, 27, 26, and 25-T90N-R1W to the west corporation line of the City of Rickardsville connecting with Main Street.

Beginning again on the east corporation line of the City of Rickardsville, connecting with Main Street; thence southeasterly to the west corporation line of the City of Rickardsville, connecting with Main Street.

Beginning again on the east corporation line of the City of Rickardsville, connecting with Main Street, southeasterly through Sections 28, 27, 26, 35, and

36-T90N-R1E, and part of Section 31-T90N-R2E to the west corporation line of the City of Durango, connecting with an unnamed street.

Beginning again on the east corporation line of the City of Durango, connecting with an unnamed street on the north side of the Chicago Great Western Railroad; thence in an easterly and southeasterly direction along the north side of the Chicago Great Western Railroad and substantially parallel thereto through Sections 31 and 32-T90N-R2E and Section 5-T89N-R2E to a point approximately 700 feet south and 700 feet west of the NE Corner of Section 5-T89N-R2E; thence in a northeasterly and southeasterly direction through Sections 33 and 34-T90N-R2E and in a southeasterly direction through Sections 3, 2, and 11-T89N-R2E to the north corporation line of the City of Dubuque, connecting with Central Avenue.

OFFICIAL DESCRIPTION CHANGE

COUNTY: Dubuque

CITY OF: Rickardsville

ROUTE: Iowa 3

APPROVAL DATE: 3-9-76

Commencing on Main Street on the west corporation line; thence easterly to the east corporation line.

Beginning again on the west corporation line connecting with Main Street; thence southeasterly to the east corporation line.

OFFICIAL DESCRIPTION CHANGE

COUNTY: Dubuque

CITY OF: Rickardsville

ROUTE: Iowa 3 and Iowa Alternate 52 Extensions

APPROVAL DATE: 7-1-65

Commencing on Main Street at the east corporation line; thence northwesterly 6,396 feet to the corporation line and section line of Section 29 and 30-T90W-R1E.

Commencing on Main Street and corporation line 3,576 feet northwesterly of the section line of Section 29 and 30 on Iowa 3 and Iowa Alternate 52; thence westerly 2,042 feet to the west corporation line approximately 575 feet north of the SW corner of the NW $\frac{1}{4}$ of the NW $\frac{1}{4}$ of Section 30-T90N-R1E.

REVISED: 12-30-66

OFFICIAL DESCRIPTION CHANGE

COUNTY: Dubuque

CITY OF: Dubuque

ROUTE: Iowa 3

APPROVAL DATE: 11-23-48

Beginning at the intersection of Dodge and Locust Streets; thence northerly on Locust Street to 4th Street; thence easterly on 4th Street to Central Avenue; thence northwesterly on Central Avenue to the north corporation line.

OFFICIAL DESCRIPTION CHANGE

COUNTY: Dubuque

ROUTE: Iowa 3

APPROVAL DATE: 5-15-45

Beginning on the Dubuque-Delaware County line at a point approximately 600 feet south of the NW Corner of Section 19-T90N-R2W, Dubuque County (NE Corner of Section 24-T90N-R3W, Delaware County); thence in a northeasterly direction to a point approximately 1,100 feet east of the NW Corner of Section 19-T90N-R2W; thence east following substantially the section line to the west corporation line of the Town of Luxemburg, connecting with Main Street.

Beginning again on the east corporation line of the Town of Luxemburg connecting with Main Street; thence east following substantially the section line to a point approximately $\frac{1}{4}$ mile west of the NE Corner of Section 23-T90N-R2W; thence in a southeasterly direction to a point approximately

500 feet west of the E ¼ Corner of Section 24-T90N-R2W; thence east following substantially the quarter section line to a point near the center of Section 20-T90N-R1W; thence in an easterly direction through Section 20, 21, 28, 27, 26, and 25-T90N-R1W, and Section 30, 29, 28, 27, 26, 35 and 36-T90N-R1E to the west corporation line of the Town of Durango, connecting with an unnamed street.

Beginning again on the east corporation line of the Town of Durango, connecting with an unnamed street on the north side of the Chicago Great Western Railroad; thence in an easterly and southeasterly direction along the north side of the Chicago Great Western Railroad and substantially parallel thereto through Section 31 and 32-T90N-R2E and Section 5-T89N-R2E to a point approximately 700 feet south and 700 feet west of the NE Corner of Section 5-T89N-R2E; thence in a northeasterly and southeasterly direction through Section 33 and 34-T90-R2E and in a southeasterly direction through Section 3, 2 and 11-T89N-R2E to the north corporation line of the City of Dubuque, connecting with Central Avenue.

OFFICIAL DESCRIPTION CHANGE

COUNTY: Dubuque

CITY OF: Luxemburg

ROUTE: Iowa 3

APPROVAL DATE: 1-24-40

Commencing on Main Street at the west corporation line; thence easterly on Main Street to the east corporation line.

NOTE: Revised from Iowa 10 to Iowa 3 May 15, 1945.

OFFICIAL DESCRIPTION CHANGE

COUNTY: Dubuque

CITY OF: Durango

ROUTE: Iowa 3

APPROVAL DATE: 1-24-40

Commencing on unnamed street at the west corporation line; thence easterly, northeasterly and easterly on unnamed street to the east corporation line.

NOTE: Revised from Iowa 10 to Iowa 3, May 15, 1945.