

Roadways may or may not have edge lines. When the free flow roadway has edge lines but the stop controlled roadway does not, end edge lines at the end of returns (marked by ▲ s). When the stop controlled roadway has edge lines but the free flow roadway does not, end edge lines at the end of returns (marked by ■ s). If both roadways have edge lines, continue edge lines around the returns.

For line information, see PM-110.

For projects not on the Primary system the following substitutions may be made. See plan sheets for substitutions.

- ELW6 → ELW4
- BCY6 → BCY4
- NPY6 → NPY4
- DCY6 → DCY4

① Broken Centerline changes to No Passing Zone Line or Double Centerline if required by sight distance.

Possible Contract Item:
Pavement Marking Line Items

Possible Tabulation:
108-22

←

LEGEND

BCY6

Direction of Traffic

ELW6

Broken Centerline (Yellow)

Edge Line Right (White)

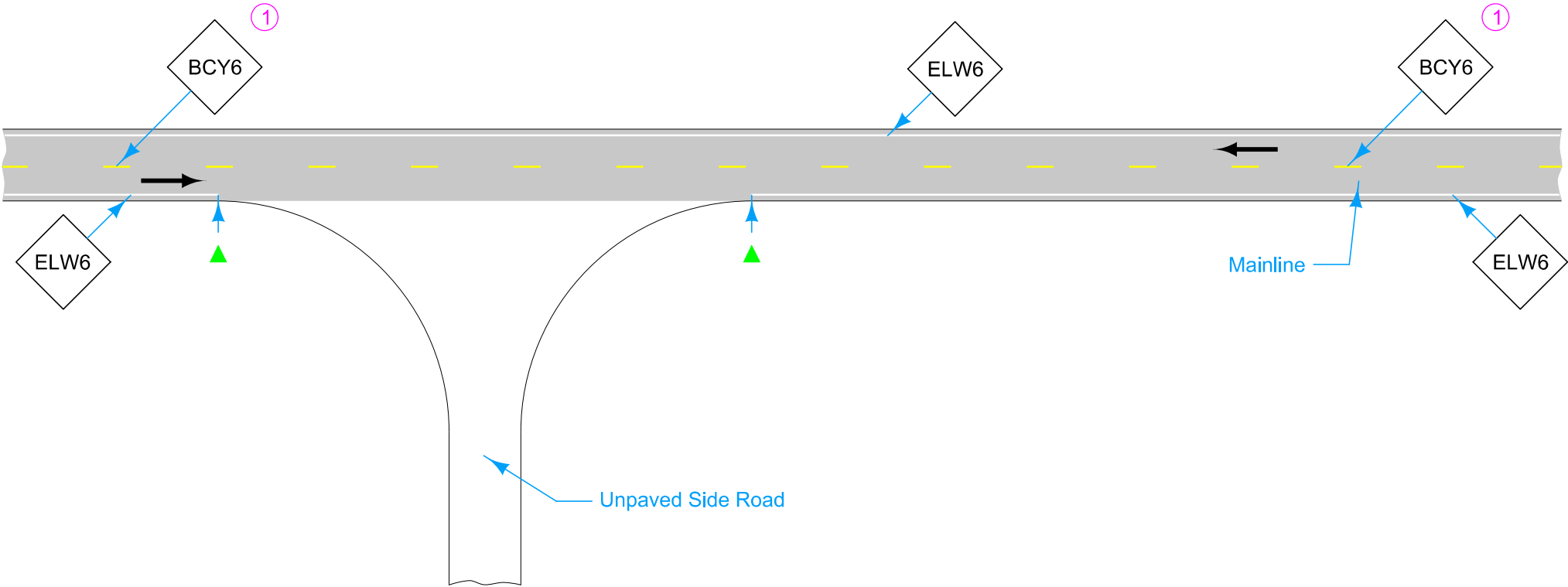

IOWA | DOT

STANDARD ROAD PLAN

REVISION

210-15-24

PM-420

SHEET 1 of 2

REVISIONS: Modified line widths from 4 inches to 6 inches.

Shant Miller

APPROVED BY DESIGN METHODS ENGINEER

TWO-LANE ROADWAY

WITH NO TURN LANES

(ONE-WAY STOP CONDITION)

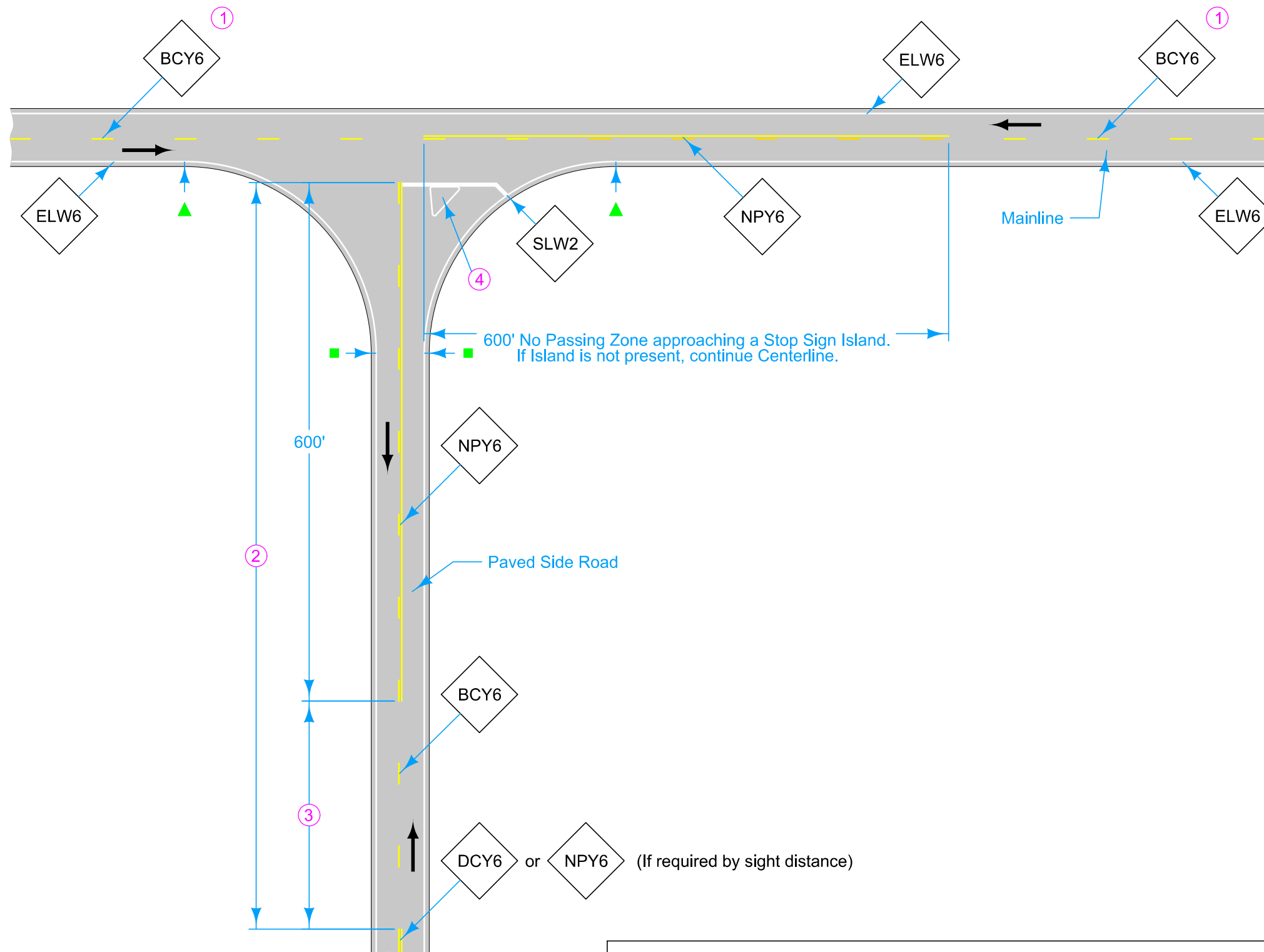

- ① Broken Centerline changes to No Passing Zone Line or Double Centerline if required by sight distance.
- ② If less than 1000 feet, extend Yellow Line to Stop Line.
- ③ If less than 400 feet, join Yellow Lines.
- ④ For Island information, see PM-120.

| LEGEND | | | |
|--------|----------------------------|------|-------------------------------|
| ← | Direction of Traffic | ELW6 | Edge Line Right (White) |
| BCY6 | Broken Centerline (Yellow) | NPY6 | No Passing Zone Line (Yellow) |
| DCY6 | Double Centerline (Yellow) | SLW2 | Stop Line (White) |

| | | |
|---|----------|---------------|
| IOWA DOT STANDARD ROAD PLAN | REVISION | |
| | 2 | 10-15-24 |
| | | PM-420 |
| | | SHEET 2 of 2 |
| REVISIONS: Modified line widths from 4 inches to 6 inches. | | |
| APPROVED BY DESIGN METHODS ENGINEER | | |
| TWO-LANE ROADWAY WITH NO TURN LANES (ONE-WAY STOP CONDITION) | | |