

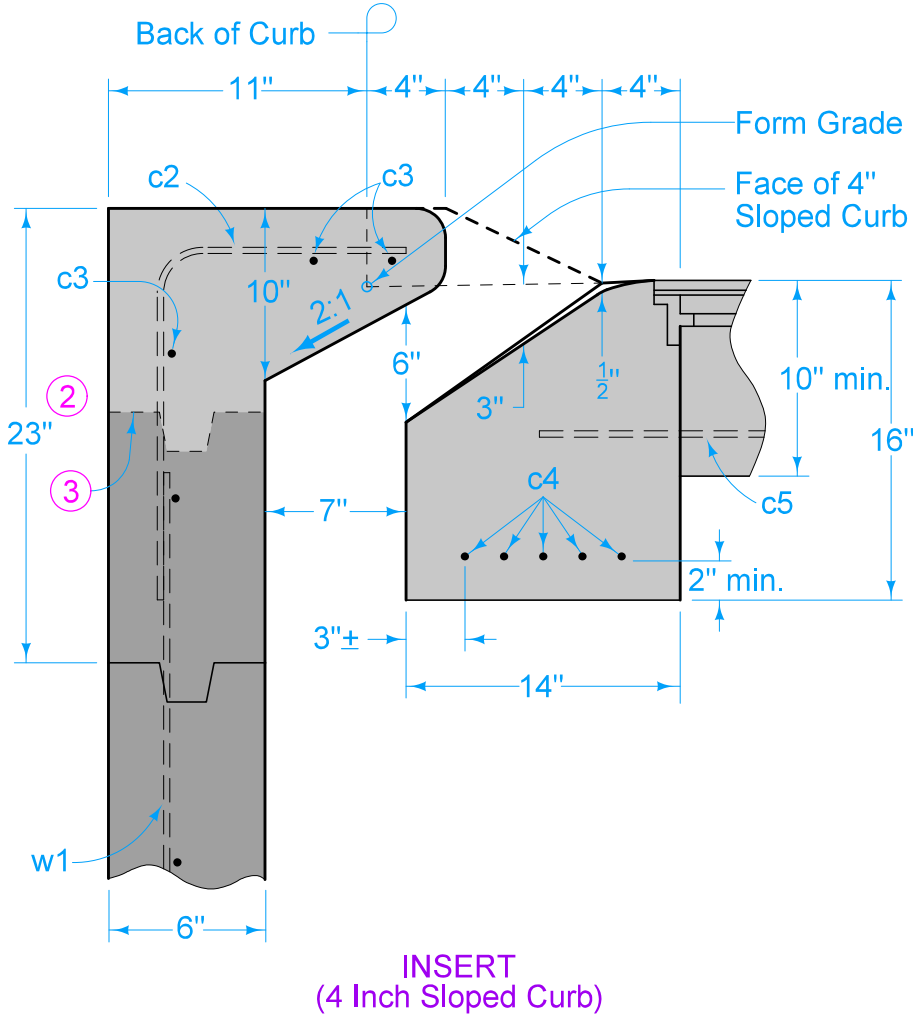

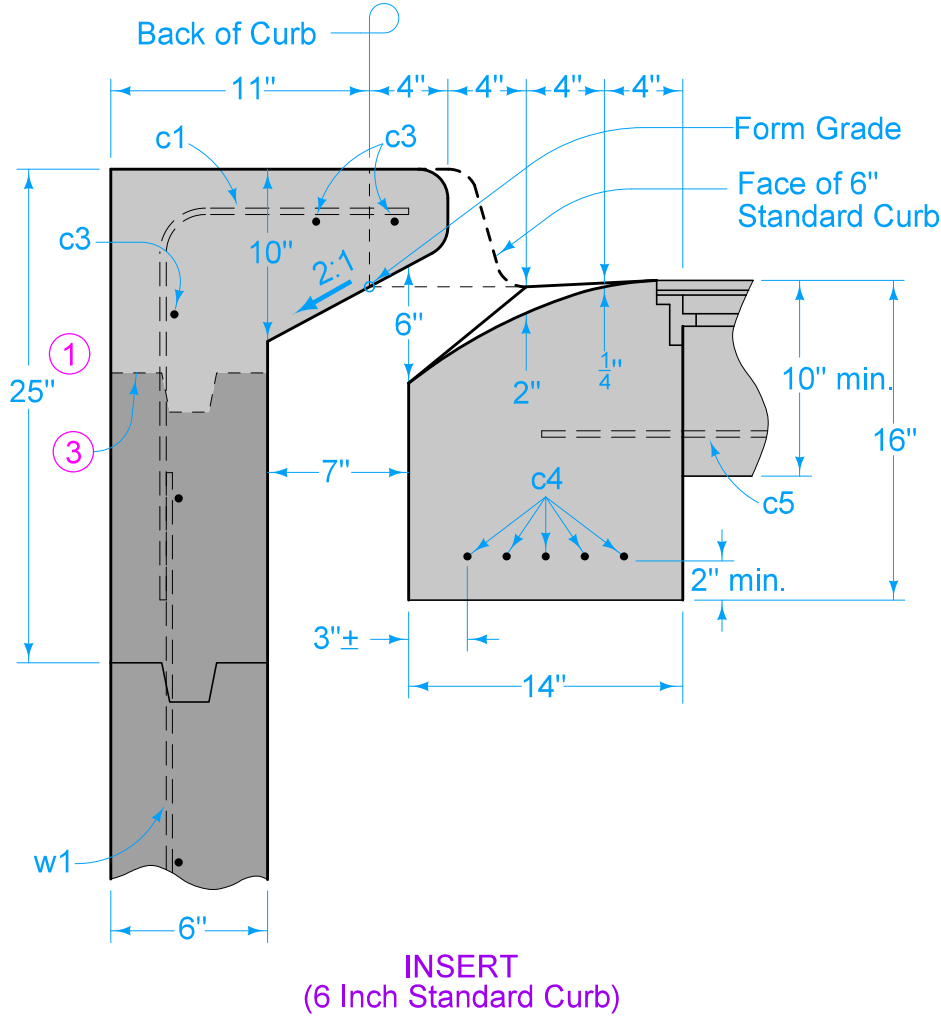

- ① 39 inches when attaching the SW-542 extension unit.
- ② 37 inches when attaching the SW-542 extension unit.
- ③ Additional keyed construction joint when attaching the SW-542 extension unit.



		REVISION		
		6	10-21-25	
		<b>SW-541</b>		
<b>FIGURE 6010.541</b>		<b>STANDARD ROAD PLAN</b>		
		<b>SHEET 1 of 2</b>		
REVISIONS: Updated Sudas and IDOT Logos.				
 SUDAS DIRECTOR		 DESIGN METHODS ENGINEER		
<b>OPEN-THROAT CURB INTAKE UNDER PAVEMENT</b>				

④ Top of well flush with pavement.

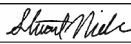
REINFORCING BAR LIST



Mark	Size	Location	Shape	Length	Spacing
b1	4	Base	——	4'-6"	11"
b2	4	Base	——	4'-6"	11"
w1	4	Wall	——	Wall Height minus 4"	14"
w2	4	Wall	——		12"
c1	4	Top	⌒	2'-7"	14"
c2	4	Top	⌒	2'-5"	14"
c3	4	Top	——	4'-8"	See Deta
c4	4	Top	——	4'-8"	See Deta
c5	4	Top	——	3'-2"	See Deta

#### MAXIMUM PIPE DIAMETER

Precast	30"
Cast-in-Place	36"

		REVISION	
		6	10-21-25
		<b>SW-541</b>	
<b>FIGURE 6010.541</b>	<b>STANDARD ROAD PLAN</b>	SHEET 2 of 2	

REVISIONS:	Updated Sudas and IDOT Logos.
------------	-------------------------------

	
SUDAS DIRECTOR	DESIGN METHODS ENGINEER

## OPEN-THROAT CURB INTAKE UNDER PAVEMENT