

ENTERED DATE: 11-8-2019

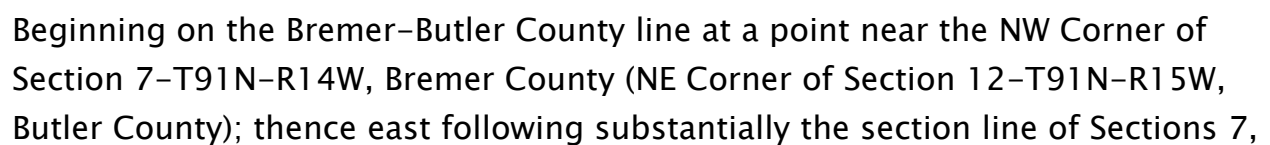

8, and 9-T91N-R14W to the west corporation line of Waverly connecting with Heritage Way.

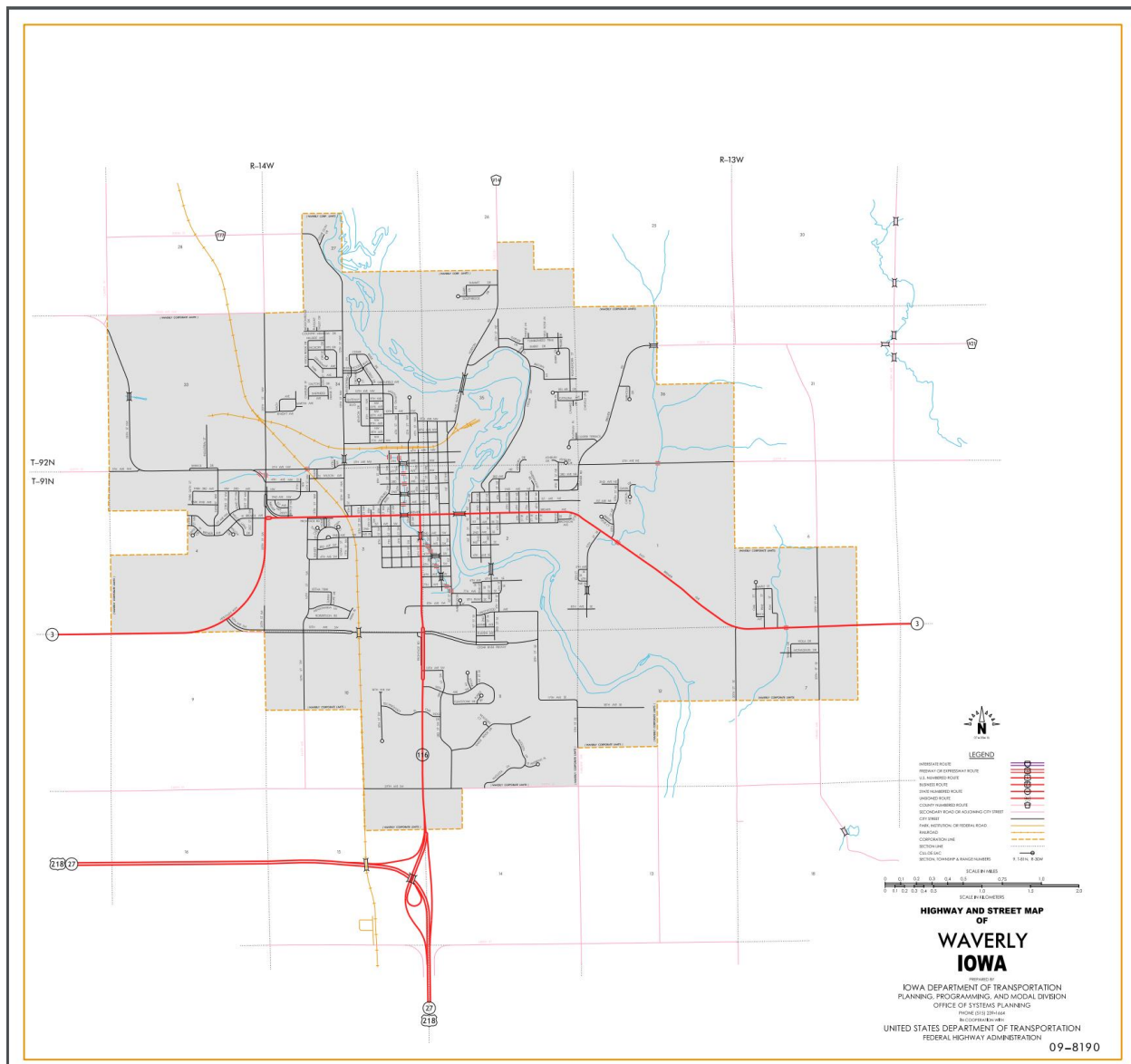

Waverly:

Beginning on Heritage Way at the west corporation line; thence northeast on Heritage Way to 20th Street Southwest; thence north on 20th Street Southwest to unnamed street; thence northeast on unnamed street to West Bremer

Avenue; thence east on West Bremer Avenue to East Bremer Avenue; thence east, southeast, and east on East Bremer Avenue to the east corporation line.

Beginning again at the east corporation line of Waverly connecting with East Bremer Avenue; thence east following substantially the section line of Sections 7, 6, 9, 10, 11, (junction US 63) and 12-T91N-R13W; Sections 7, 8, 9, 10, 11, and 12-T91N-R12W; and Sections 7, 8, 9, 10, 11, and 12-T91N-R11W to a point on the Bremer-Fayette County line near the NE Corner of Section 12-T91N-R11W, Bremer County (NW Corner of Section 7-T91N-R10W, Fayette County).

OFFICIAL DESCRIPTION CHANGE

COUNTY: Bremer

ROUTE: Iowa 3

STAFF ACTION NUMBER: S-87-691

APPROVAL DATE: 12-18-86

New Description – Iowa 3 and its extensions in Bremer County described as follows:

Beginning on the Bremer-Butler County line at a point near the NW Corner of Section 7-T91N-R14W, Bremer County (NE Corner of Section 12-T91N-R15W, Butler County); thence east following substantially the section line of Sections 7, 8, and 9-T91N-R14W to the west corporation line of Waverly connecting with Heritage Way.

Waverly:

Beginning on Heritage Way at the west corporation line; thence northeast on Heritage Way to 20th Street Southwest; thence north on 20th Street Southwest to unnamed street; thence northeast on unnamed street to West Bremer Avenue; thence east on West Bremer Avenue to East Bremer Avenue; thence east, southeast, and east on East Bremer Avenue to the east corporation line.

Beginning again at the east corporation line of Waverly connecting with East Bremer Avenue; thence east following substantially the section line of Sections 7, 6, 9, 10, 11, (junction US 63) and 12-T91N-R13W; Sections 7, 8, 9, 10, 11, and 12-T91N-R12W; and Sections 7, 8, 9, 10, 11, and 12-T91N-R11W to a point on the Bremer-Fayette County line near the NE Corner of Section 12-T91N-R11W, Bremer County (NW Corner of Section 7-T91N-R10W, Fayette County).

STAFF ACTION

OFFICE: Transportation Inventory

STAFF ACTION NUMBER: S-83-823

SUBMITTED BY: Patrick R. Cain

SUBMITTAL DATE: 4-4-83

DISCUSSION/BACKGROUND:

Iowa 3 begins at the Bremer-Butler County line approximately two and one-half miles west of the City of Waverly, and travels easterly via the City of Waverly to the Bremer-Fayette County line approximately seven miles east of the City of Readlyn.

Due to an annexation to the City of Waverly, the present description of Iowa 3 in Bremer County should be revised to reflect this change in corporate limits. Iowa 3 in the remainder of Bremer County remains unchanged.

PROPOSAL/ACTION RECOMMENDATION:

It is recommended to approve deleting the present description of Iowa 3 in Bremer County from the primary road system and approve including the attached new description of Iowa 3 in the primary road system.

Locate Iowa 3 and its extension in Bremer County as follows:

Beginning on the Bremer–Butler County line at a point near the NW Corner of Section 7–T91N–R14W, Bremer County (NE Corner of Section 12–T91N–R15W, Butler County); thence east following substantially the section line of Sections 7, 8, and 9–T91N–R14W to the west corporation line of the City of Waverly connecting with an unnamed street.

Waverly:

Beginning on the west corporation line, connecting with an unnamed street; thence northeasterly, northerly, easterly, southeasterly and easterly to the east corporation line, connecting with an unnamed street.

Beginning again at the east corporation line of the City of Waverly connecting with an unnamed street; thence east following substantially the section line of Sections 7, 8, 9, 10, 11, (junction US 63) and 12–T91N–R13W; Sections 7, 8, 9, 10, 11, and 12–T91N–R12W; and Sections 7, 8, 9, 10, 11, and 12–T91N–R11W to a point on the Bremer–Fayette County line near the NE Corner of Section 12–T91N–R11W, Bremer County (NW Corner of Section 7–T91N–R10W, Fayette County).

REVISED: 12-18-86

COMMISSION ORDER

DIVISION: Planning & Research

COMMISSION ORDER NUMBER: PR-79-272

SUBMITTED BY: C.I. MacGillivray

MEETING DATE: 11-2-78

DISCUSSION/BACKGROUND:

Due to a review of the Primary Road System Iowa 3 in Bremer County should be deleted and the new description should be officially included into the Primary System.

Iowa 3 begins at the Bremer-Butler County line approximately 2 ½ miles west of Waverly and travels easterly, northerly, and easterly through the City of Waverly; thence southeasterly and easterly intersecting with US 63 to the Bremer-Fayette County line approximately 7 miles east of Readlyn.

PROPOSAL/ACTION RECOMMENDATION:

Locate Iowa 3 and its extension in Bremer County as follows:

Beginning on the Bremer-Butler County line at a point near the NW Corner of Section 7-T91N-R14W, Bremer County (NE Corner of Section 12-T91N-R15W, Butler County); thence east following substantially the section line of Sections 7, 8, and 9-T91N-R14W to the west corporation line of the City of Waverly connecting with an unnamed street.

Waverly:

Beginning on the west corporation line, connecting with an unnamed street; thence northeasterly, northerly, easterly, southeasterly and easterly to the east corporation line, connecting with an unnamed street.

Beginning again at the east corporation line of the City of Waverly connecting with an unnamed street; thence east following substantially the section line of Sections 7, 8, 9, 10, 11 (junction US 63), 12-T91N-R13W continuing along the section line of Sections 7, 8, 9, 10, 11, and 12-T91N-R12W; thence continuing east following substantially the section line of Sections 7, 8, 9, 10, 11, and 12-T91N-R11W to a point on the Bremer-Fayette County line near the NE Corner of Section 12-T91N-R11W, Bremer County (NW Corner of Section 7-T91N-R10W, Fayette County).

NOW, THEREFORE: Be it resolved that the Iowa Department of Transportation approve the location of Iowa 3 in Bremer County, Iowa.

NOTE: To become effective upon the adoption of this resolution.

REVISED: 3-3-83

COMMISSION ORDER

DIVISION: Planning & Research

SUBMITTED BY: Raymond L. Kassel

MEETING DATE: 8-10-76

DISCUSSION/BACKGROUND:

Due to a review of the Primary Road System Iowa 3 in Bremer County should be deleted and the new description should be officially included into the Primary System.

Iowa 3 begins at the Bremer–Butler County line approximately 2 ½ miles west of Waverly and travels easterly, northerly, and easterly through the City of Waverly; thence southeasterly and easterly intersecting with US 63 to the Bremer–Fayette County line approximately 7 miles east of Readlyn.

PROPOSAL/ACTION RECOMMENDATION:

Located Iowa 3 and its extensions in Bremer County as follows:

Beginning on the Bremer–Butler County line at a point near the NW Corner of Section 7–T91N–R15W, Butler County; thence east following substantially the section line of Sections 7, 8, and 9–T91N–R14W to the west corporation line of the City of Waverly connecting with an unnamed street.

Waverly:

Beginning on the west corporation line, connecting with an unnamed street; thence northeasterly, northerly and easterly to the east corporation line, connecting with an unnamed street.

Beginning again at the east corporation line of the City of Waverly connecting with an unnamed street; thence in a southeasterly direction through Section 1–T91N–R14W and Section 6–T91N–R13W to a point approximately 500 feet east of the SW Corner of Section 6–T91N–R13W; thence east following substantially the section line of Sections 7, 8, 9, 10, 11 (junction US 63), 12–T91N–R13W continuing along the section line of Sections 7, 8, 9, 10, 11, and 12–T91N–R12W; thence continuing east following substantially the section line of Sections 7, 8, 9, 10, 11, and 12–T91N–R11W to a point on the Bremer–Fayette County line near the NE Corner Section 12–T91N–R11W, Bremer County (NW Corner of Section 7–T91N–R10W, Fayette County).

NOW THEREFORE: Be it resolved that the Iowa Department of Transportation approve the location of Iowa 3 in Bremer County, Iowa.

NOTE: To become effective upon the adoption of this resolution.

OFFICIAL DESCRIPTION CHANGE

COUNTY: Bremer

ROUTE: Iowa 3

APPROVAL DATE: 12–19–73

Beginning on the Bremer–Butler County line at a point near the NW Corner of Section 7–T91N–R14W, Bremer County (NE Corner of Section 12–T91N–R15W, Butler County); thence east following substantially the section line to the west corporation line of the City of Waverly connecting with an unnamed street.

Waverly:

Beginning on the west corporation line on an unnamed street; thence curving in a northeasterly and northerly direction on an unnamed street to West Bremer Avenue; thence east on West Bremer Avenue to the intersection of East Bremer Avenue and Fourth Street SW; thence east on East Bremer Avenue to the east corporation line.

Beginning again on the east corporation line of the City of Waverly connecting with Bremer Avenue; thence in a southeasterly direction through Section 1–T91N–R14W and Section 6–T91N–R13W to a point approximately 500 feet east of the SW Corner of Section 6–T91N–R13W; thence east following substantially the section line to the Bremer–Fayette County line at a point near the NE Corner of Section 12–T91N–R11W, Bremer County (NW Corner of Section 7–T91N–R10W, Fayette County).

OFFICIAL DESCRIPTION CHANGE

COUNTY: Bremer

ROUTE: Iowa 3

APPROVAL DATE: 5–15–45

Beginning on the Bremer–Butler County line at a point near the NW Corner of Section 7–T91N–R14W, Bremer County (NE Corner of Section 12–T91N–R15W, Butler County); thence east following substantially the section line to a point approximately 900 feet east of the N $\frac{1}{4}$ Corner of Section 9–T91N–R14W; thence north to the south corporation line of the City of Waverly, connecting with an unnamed street.

Beginning again on the east corporation line of the City of Waverly, connecting with Bremer Avenue; thence in a southeasterly direction through Section 1–T91N–R14W and Section 6–T91N–R13W to a point approximately 500 feet east of the SW Corner of Section 6–T91N–R13W; thence east following substantially the section line to the Bremer–Fayette

County line at a point near the NE Corner of Section 12-T91N-R11W,
Bremer County (NW Corner of Section 7-T91N-R10W, Fayette County).

OFFICIAL DESCRIPTION CHANGE

COUNTY: Bremer

APPROVAL DATE: 4-14-37

CONNECTING CURVES

Junction of Iowa 3 and US 218:

Beginning at a point on the west corporation line of the City of Waverly approximately 400 feet south of Bremer Avenue; thence north along the west corporation line of the City of Waverly to a point approximately 600 feet north of Bremer Avenue.

OFFICIAL DESCRIPTION CHANGE

COUNTY: Bremer

CITY OF: Waverly

ROUTE: Iowa 3

APPROVAL DATE: 2-5-36

Commencing on unnamed street at the south corporation line; thence northeasterly on unnamed street approximately 589 feet to Bremer Avenue; thence easterly on Bremer Avenue to the east corporation line.