

OFFICIAL DESCRIPTION CHANGE

OFFICE: Transportation Data

EFFECTIVE DATE: 07-01-2003

ENTERED BY: Stefani Wonders

ENTERED DATE: 08-21-2006

DISCUSSION/BACKGROUND:

Senate File 451 transferred Iowa 15 in its entirety, in Van Buren County, to city and county jurisdiction on July 1, 2003.

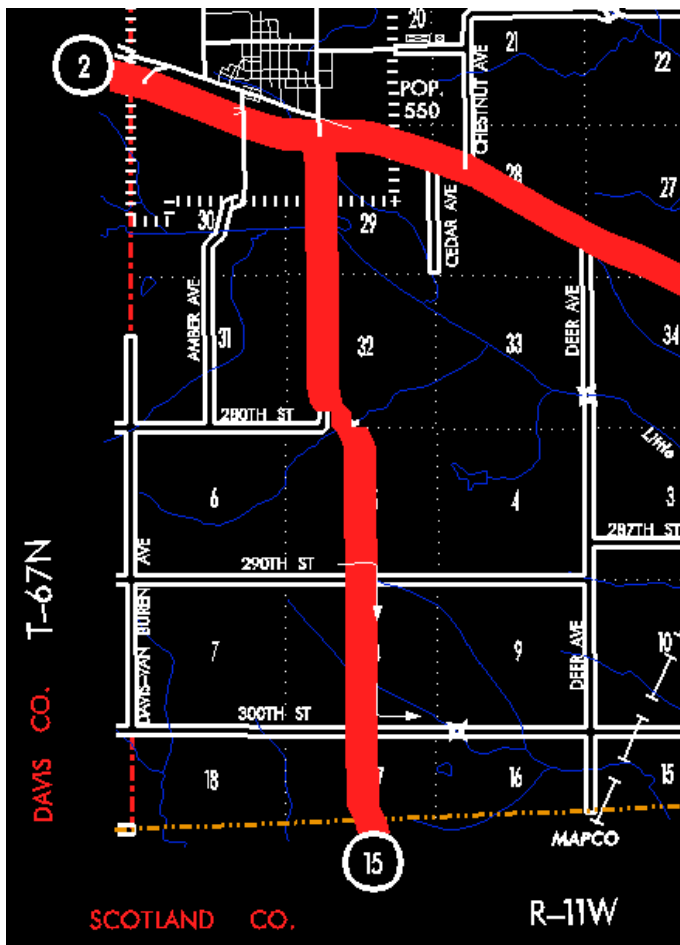

OFFICIAL DESCRIPTION CHANGE

COUNTY: Van Buren

ROUTE: Iowa 15

STAFF ACTION NUMBER: S-87-1506

APPROVAL DATE: 5-13-87

New Description – Iowa 15 and its extension in Van Buren County described as follows:

Beginning on the Iowa-Missouri State line at a point approximately 300 feet east of the S $\frac{1}{4}$ Corner Section 17-T67N-R11W; thence in a northwesterly direction through said Section 17 to a point approximately 1,000 feet north of the S $\frac{1}{4}$ Corner Section 17-T67N-R11W; thence north following substantially the center section line of Sections 17, 8 and 5-T67N-R11W to a point approximately 1,000 feet south of the N $\frac{1}{4}$ Corner Section 5-T67N-R11W; thence in a northwesterly direction through Section 5-T67N-R11W and Section 32-T68N-R11W to a point near the center of the SW $\frac{1}{4}$ Section 32-T68N-R11W; thence north following substantially the west quarter section line of Sections 32 and 29-T68N-R11W to the south corporation line of Milton, connecting with Sunrise Lane.

Milton:

Beginning on Sunrise Lane at the south corporation line; thence north on Sunrise Lane to the intersection of Iowa 2.

COMMISSION ORDER

DIVISION: Planning & Research

COMMISSION ORDER NUMBER: PR-79-272

SUBMITTED BY: C.I. MacGillivray

MEETING DATE: 11-2-78

DISCUSSION/BACKGROUND:

Iowa 15 begins on the Iowa–Missouri State line approximately 1 ½ miles east of the SW corner of Van Buren County, and travels generally northerly to Iowa 2 in Milton, Iowa.

Due to a review of our Primary Road System Records Iowa 15 in Van Buren County should be deleted and the new description added should be officially included into the Primary System.

PROPOSAL/ACTION RECOMMENDATION:

It is recommended that the old description of Iowa 15 in Van Buren County be deleted and the new description, as referred in the attached detailed description, be included in the Primary Road System effective upon the adoption of this resolution.

Locate Iowa 15 and its extension in Van Buren County as follows:

Beginning on the Iowa–Missouri State line at a point approximately 300 feet east of the S ¼ Corner Section 17–T67N–R11W; thence in a northwesterly direction through said Section 17 to a point approximately 1000 feet north of the S ¼ Corner Section 17–T67N–R11W; thence northerly following substantially the center section line of Sections 17, 18, and 5–T67N–R11W to a point approximately 1000 feet south of the N ¼ Corner Section 5T67N–R11W; thence in a northwesterly direction through Section 5–T67N–R11W and Section 32–T68N–R11W to a point near the center of the SW ¼ Section 32–T68N–R11W; thence northerly following substantially the west quarter section line of Sections 32 and 29–T68NR11W to the south corporation line of the City of Milton connecting with an unnamed street.

Milton:

Beginning on the south corporation line connecting with an unnamed street; thence northerly to Iowa 2.

REVISED: 5-13-87

COMMISSION RESOLUTION

DIVISION: Planning & Research

COMMISSION ORDER NUMBER: 70-212

SUBMITTED BY: Raymond L. Kassel

MEETING DATE: 2-18-70

Remove Iowa 15 Extension in Milton, Van Buren County, Iowa, as follows:

Beginning on East Road at the junction of relocated Iowa 2; thence north on East Road to Main Street. (Old Iowa 2)

NOW THEREFORE: Be it resolved that the Iowa State Highway Commission approve the revision of Iowa 15 in Milton, Van Buren County, Iowa.

NOTE: To become effective upon adoption of this resolution and in accordance with Urban Policy 2600-001-E7.

OFFICIAL DESCRIPTION CHANGE

COUNTY: Van Buren

CITY OF: Milton

ROUTE: Iowa 15

APPROVAL DATE: 2-18-70

Beginning on East Road at the south corporation line of the Town of Milton; thence in a northerly direction on East Road to its junction with Iowa 2.

OFFICIAL DESCRIPTION CHANGE

COUNTY: Van Buren

ROUTE: Iowa 15

APPROVAL DATE: 12-31-68

Beginning on the Iowa-Missouri State line at a point approximately 300 feet east of the S $\frac{1}{4}$ Corner Section 17-T67N-R11W; thence in a northwesterly direction to a point approximately 1000 feet north of the S $\frac{1}{4}$ Corner Section 17-T67N-R11W; thence north following substantially the quarter section line to a point approximately 1000 feet south of the N $\frac{1}{4}$ Corner Section 5-T67N-R11W; thence in a northwesterly direction to a point near the center of the SW $\frac{1}{4}$ Section 32-T68N-R11W; thence north following substantially the west quarter-quarter line of Section 32 and 29-T68N-R11 to the south corporation line of the Town of Milton, connecting with an extension of East Road.

Milton:

Beginning on an extension of East Road at the south corporation line; thence northerly on the extension of East Road to Main Street.