

**OFFICIAL DESCRIPTION CHANGE**

**OFFICE:** Transportation Data

**EFFECTIVE DATE:** 09-19-2003

**ENTERED BY:** Stefani Wonders

**ENTERED DATE:** 01-25-2005

**DISCUSSION/BACKGROUND:**

The portion of Iowa 16 that transferred with the Senate file 451 on July 1, 2003, transferred back to the Iowa Department of Transportation on September 19, 2003.

New Description – Iowa 16 and its extensions in Lee County described as follows:

Beginning at a point near the NW Corner Section 6-T69N-R7W, Lee County (NE Corner Section 1-T69N-R8W, Van Buren County) (SW Corner Section 31-T70N-R7W, Henry County); thence east along the Lee-Henry County line following substantially the section line of Section 6-T69N-R7W to a point approximately 600 feet east of the N  $\frac{1}{4}$  Corner Section 6-T69N-R7W; thence in a southeasterly, southerly, easterly, and southerly direction through Sections 6 and 7-T69N-R7W to a point near the SE Corner Section 7-T69N-R7W; thence east following substantially the section line of Sections 17, 16, 15, 14, and 13-T69N-R7W to the west corporation line of Houghton connecting with 1st Street (approximately 2720 feet east of the NW Corner of Section 13-T69N-R7W).

Houghton:

Beginning on 1st Street at the west corporation line; thence east on 1st Street to the east corporation line (approximately 830 feet east of the NW Corner of Section 18-T69N-R6W).

Beginning again on the east corporation line of Houghton connecting with 1st Street; thence east following substantially the section line of Sections 18, 17

(junction US 218), 16, 15, 14, and 13-T69N-R6W and Section 18-T69N-R5W to a point approximately 1100 feet west of the N  $\frac{1}{4}$  Corner of Section 18-T69N-R5W; thence curving in a southeasterly direction to a point approximately 1100 feet south of the N  $\frac{1}{4}$  Corner Section 18-T69N-R5W; thence south to a point approximately 200 feet south of the center of Section 18-T69N-R5W; thence curving in a southeasterly direction to a point approximately 1300 feet south and 1100 feet east of the center Section 18-T69N-R5W; thence east following substantially the south quarter section line of Sections 18, 17, and 16-T69N-R5W to a point approximately 1300 feet south and 700 feet west of the center Section 16-T69N-R5W; thence in a southeasterly direction through Sections 16, 21, and 22-T69N-R5W to a point approximately 1000 feet east of the W  $\frac{1}{4}$  Corner Section 22-T69N-R5W; thence east following substantially the center section line of Sections 22 and 23-T69N-R5W to a point approximately 1500 feet east of the W  $\frac{1}{4}$  Corner Section 23-T69N-R5W; thence in a southeasterly direction through Sections 23 and 24-T69N-R5W and Section 19, 30, 29, and 28-T69N-R4W to a point near the SE Corner Section 28-T69N-R4W; thence east following substantially the section line of Sections 34, 35, and 36-T69N-R4W to a point near the NE Corner Section 36-T69N-R4W; thence in a southeasterly direction through Section 31 and 32-T69N-R3W and Section 5-T68N-R3W to a approximately 980 feet south of the NE Corner Section 5-T68N-R3W (junction US 61)



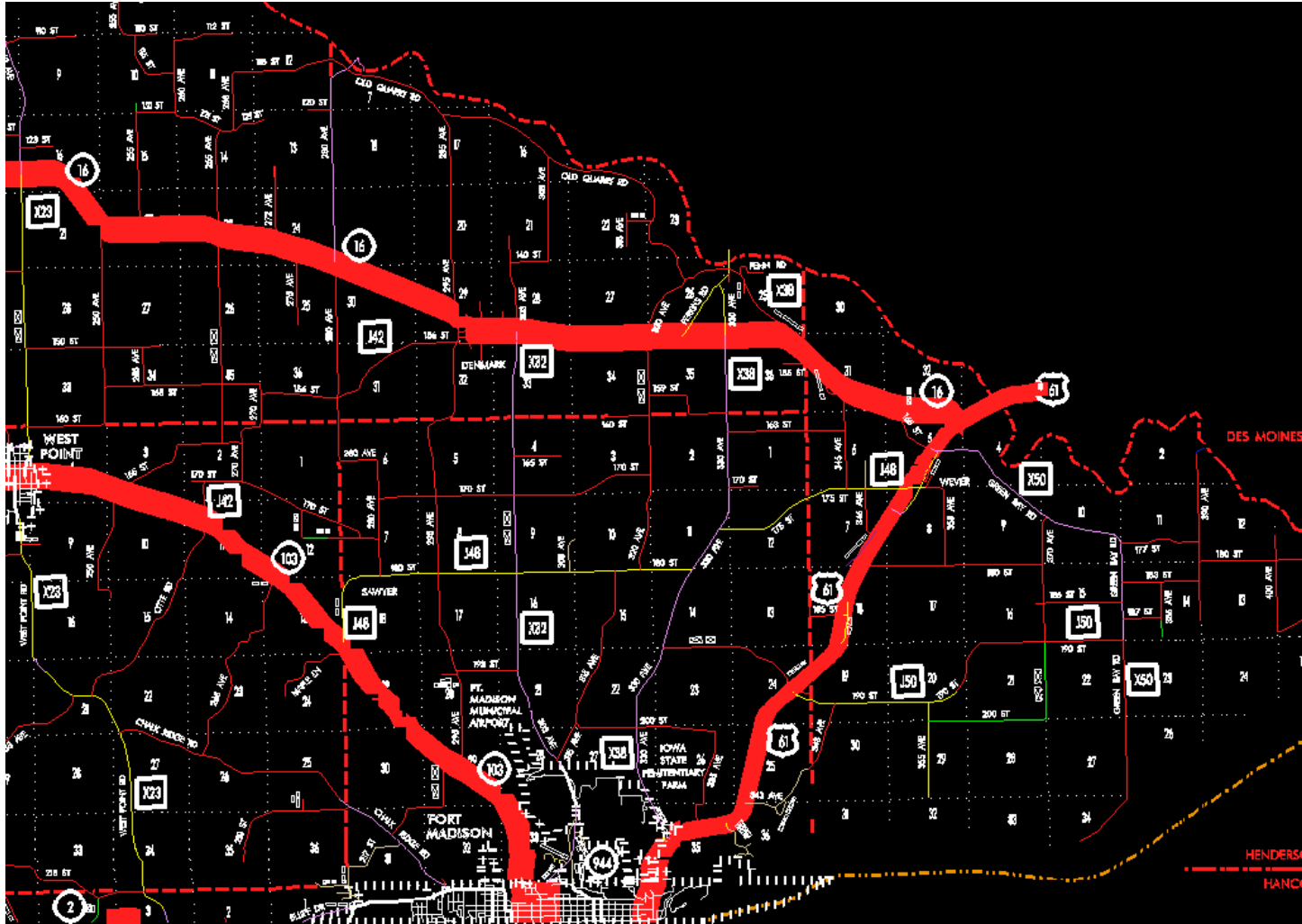

## OFFICIAL DESCRIPTION CHANGE

OFFICE: Transportation Data

EFFECTIVE DATE: 07-01-2003

ENTERED BY: Stefani Wonders

ENTERED DATE: 01-25-2005

## DISCUSSION/BACKGROUND:

Senate file 451 transferred that portion of Iowa 16 from the junction of US 218 at the NE Corner of Section 17-T69N-R5W; thence following substantially the

north section lines of Sections 16, 15, 14, and 13-T69N-R6W and Section 18-T69N-R5W to a point approximately 1100 feet west of the N  $\frac{1}{4}$  Corner of Section 18-T69N-R5W; thence curving in a southeasterly direction to a point approximately 1100 feet south of the N  $\frac{1}{4}$  Corner Section 18-T69N-R5W; thence south to a point approximately 200 feet south of the center of Section 18-T69N-R5W; thence curving in a southeasterly direction to a point approximately 1300 feet south and 1100 feet east of the center Section 18-T69N-R5W; thence east following substantially the south quarter section line of Sections 18, 17, and 16-T69N-R5W to a point approximately 1300 feet south and 700 feet west of the center Section 16-T69N-R5W; thence in a southeasterly direction through Sections 16, 21, and 22-T69N-R5W to a point approximately 1000 feet east of the W  $\frac{1}{4}$  Corner Section 22-T69N-R5W; thence east following substantially the center section line of Sections 22 and 23-T69N-R5W to a point approximately 1500 feet east of the W  $\frac{1}{4}$  Corner Section 23-T69N-R5W; thence in a southeasterly direction through Sections 23 and 24-T69N-R5W and Section 19, 30, 29, and 28-T69N-R4W to a point near the SE Corner Section 28-T69N-R4W; thence east following substantially the section line of Sections 34, 35, and 36-T69N-R4W to a point near the NE Corner Section 36-T69N-R4W; thence in a southeasterly direction through Section 31 and 32-T69N-R3W and Section 5-T68N-R3W to a approximately 980 feet south of the NE Corner Section 5-T68N-R3W (junction US 61) to county jurisdiction on July 1, 2003.

New Description - Iowa 16 and its extensions in Lee County described as follows:

Beginning at a point near the NW Corner Section 6-T69N-R7W, Lee County (NE Corner Section 1-T69N-R8W, Van Buren County) (SW Corner Section 31-T70N-R7W, Henry County); thence east along the Lee-Henry County line following substantially the section line of Section 6-T69N-R7W to a point approximately 600 feet east of the N  $\frac{1}{4}$  Corner Section 6-T69N-R7W; thence in a southeasterly, southerly, easterly, and southerly direction through Sections 6 and 7-T69N-R7W to a point near the SE Corner Section 7-T69N-R7W; thence east following substantially the section line of Sections 17, 16, 15, 14, and 13-T69N-R7W to the west corporation line of Houghton connecting with 1st

Street (approximately 2720 feet east of the NW Corner of Section 13–T69N–R7W).

Houghton:

Beginning on 1st Street at the west corporation line; thence east on 1st Street to the east corporation line (approximately 830 feet east of the NW Corner of Section 18–T69N–R6W).

Beginning again on the east corporation line of Houghton connecting with 1st Street; thence east following substantially the section line of Sections 18 and 17–T69N–R6W to the junction US 218 (NW Corner of Section 16–T69N–R6W).

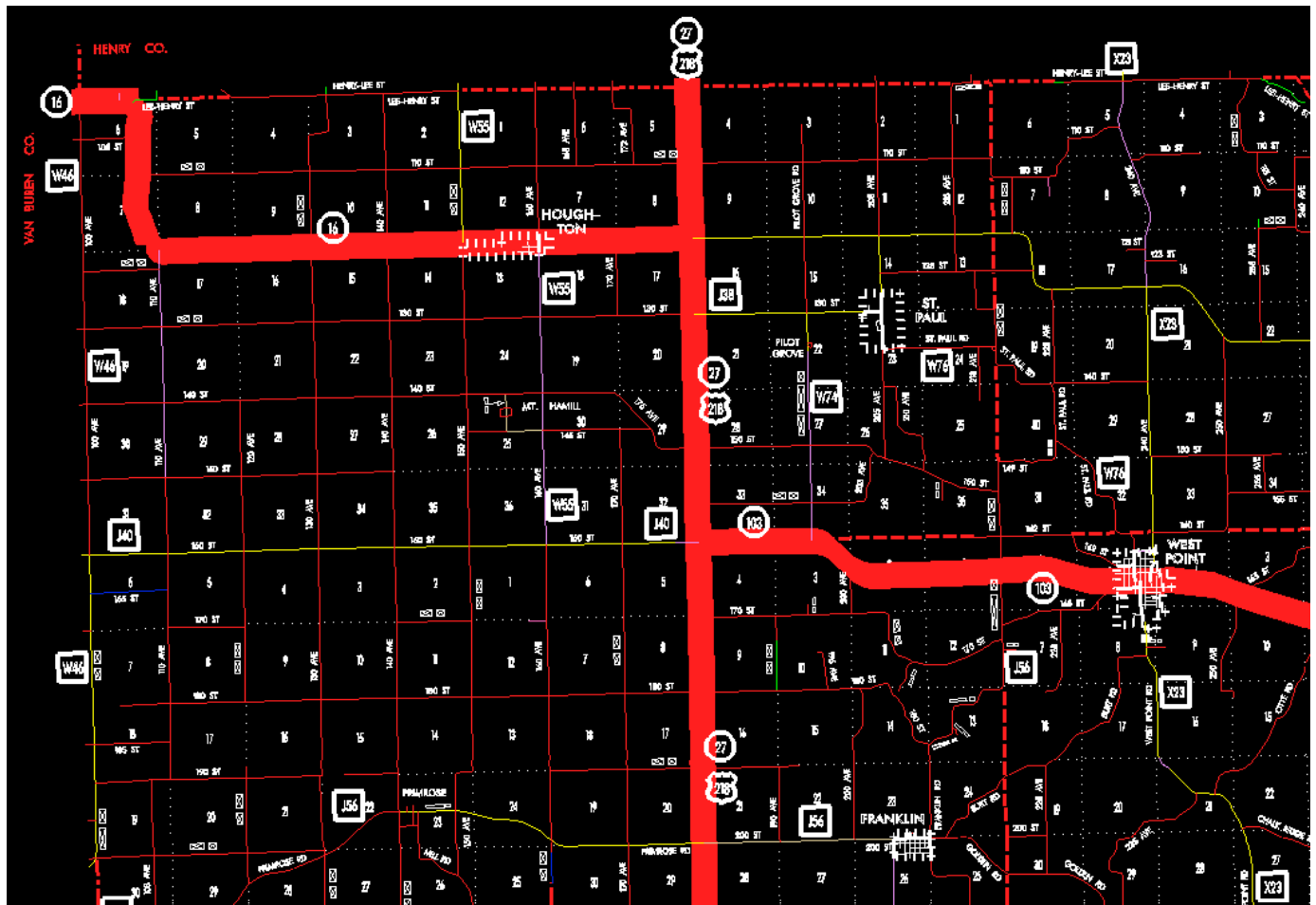

**OFFICIAL DESCRIPTION CHANGE**

**COUNTY:** Lee

**ROUTE:** Iowa 16

**STAFF ACTION NUMBER:** S-87-1538

**APPROVAL DATE:** 5-13-87

New description – Iowa 16 and its extensions in Lee County described as follows:

Beginning at a point near the NW Corner Section 6-T69N-R7W, Lee County (NE Corner Section 1-T69N-R8W, Van Buren County) (SW Corner Section 31-T70N-R7W, Henry County); thence east along the Lee-Henry County line following substantially the section line of Section 6-T69N-R7W to a point approximately 600 feet east of the N  $\frac{1}{4}$  Corner Section 6-T69N-R7W; thence in a southeasterly, southerly, easterly, and southerly direction through Sections 6 and 7-T69N-R7W to a point near the SE Corner Section 7-T69N-R7W; thence east following substantially the section line of Sections 17, 16, 15, 14, and 13-T69N-R7W to the west corporation line of Houghton connecting with 1st Street.

Houghton:

Beginning on 1st Street at the west corporation line; thence east on 1st Street to the east corporation line.

Beginning again on the east corporation line of Houghton connecting with 1st Street; thence east following substantially the section line of Sections 18, 17 (junction US 218); 16, 15, 14, and 13-T69N-R6W and Section 18-T69N-R5W to a point approximately 1100 feet west of the N  $\frac{1}{4}$  Corner of Section 18-T69N-R5W; thence curving in a southeasterly direction to a point approximately 1100 feet south of the N  $\frac{1}{4}$  Corner Section 18-T69N-R5W; thence south to a point approximately 200 feet south of the center of Section 18-T69N-R5W; thence curving in a southeasterly direction to a point

approximately 1300 feet south and 1100 feet east of the center Section 18-T69N-R5W; thence east following substantially the south quarter section line of Sections 18, 17, and 16-T69N-R5W to a point approximately 1300 feet south and 700 feet west of the center Section 16-T69N-R5W; thence in a southeasterly direction through Sections 16, 21, and 22-T69N-R5W to a point approximately 1000 feet east of the W ¼ Corner Section 22-T69N-R5W; thence east following substantially the center section line of Sections 22 and 23-T69N-R5W to a point approximately 1500 feet east of the W ¼ Corner Section 23-T69N-R5W; thence in a southeasterly direction through Sections 23 and 24-T69N-R5W and Section 19, 30, 29, and 28-T69N-R4W to a point near the SE Corner Section 28-T69N-R4W; thence east following substantially the section line of Sections 34, 35, and 36-T69N-R4W to a point near the NE Corner Section 36-T69N-R4W; thence in a southeasterly direction through Section 31 and 32-T69N-R3W and Section 5-T68N-R3W to a point near the NE Corner Section 5-T68N-R3W (junction US 61).

#### **COMMISSION ORDER**

**DIVISION:** Planning & Research

**COMMISSION ORDER NUMBER:** PR-79-272

**SUBMITTED BY:** C.I. MacGillivray

**MEETING DATE:** 11-2-78

#### **DISCUSSION/BACKGROUND:**

Due to a review of our Primary Road System records, Iowa 16 in Lee County should be deleted from the Primary Road System and the new description added should be officially included into the Primary Road System.

Iowa 16 begins at the Lee-Van Buren-Henry county line and travels in an easterly direction terminating at the junction US 61 near the Lee-Des Moines County line, via the City of Houghton, Iowa.



## **PROPOSAL/ACTION RECOMMENDATION:**

Locate Iowa 16 and its extension in Lee County, Iowa as follows:

Beginning at a point near the NW Corner Section 6-T69N-R7W, Lee County (NE Corner Section 1-T69N-R8W, Van Buren County) (SW Corner Section 31-T79N-R7W, Henry County); thence east along the Lee-Henry County line following substantially the section line of Section 6-T69N-R7W to a point approximately 600 feet east of the N  $\frac{1}{4}$  Corner Section 6-T69N-R7W; thence in a southeasterly, southerly, easterly, and southerly direction through Sections 6 and 7-T69N-R7W to a point near the SE Corner Section 7-T69N-R7W; thence east following substantially the section line of Sections 17, 16, 15 14, and 13-T69N-R7W to the west corporation line of the City of Houghton connecting with an unnamed street.

Houghton:

Beginning on the west corporation line connecting with an unnamed street; thence easterly to the east corporation line connecting with an unnamed street.

Beginning again on the east corporation line of the City of Houghton, connecting with an unnamed street; thence east following substantially the section line of Sections 18, 17 (junction US 218), 16, 15, 14 and 13-T69N-R6W and Section 18-T69N-R5W to a point approximately 1100 feet west of the N  $\frac{1}{4}$  Corner of Section 18-T69N-R5W; thence curving in a southeasterly direction to a point approximately 1100 feet south of the N  $\frac{1}{4}$  Corner Section 18-T69N-R5W; thence south to a point approximately 200 feet south of the center of Section 18-T69N-R5W; thence curving in a southeasterly direction to a point approximately 1300 feet south and 1100 feet east of the center Section 18-T69N-R5W; thence east following substantially the south quarter section line of Sections 18, 17, and 16-T69N-R5W to a point approximately 1300 feet south and 700 feet west of the center Section 16-T69N-R5W; thence in a southeasterly direction through Sections 16, 21, and 22-T69N-R5W to a point approximately 1000 feet east of the W  $\frac{1}{4}$  Corner Section 22-T69N-R5W; thence east following substantially the center section line of Sections 22 and

23-T69N-R5W to a point approximately 1500 feet east of the W ¼ Corner Section 23-T69N-R5W; thence in a southeasterly direction through Sections 23 and 24-T69N-R5W, and Sections 19, 30, 29, and 28-T69N-R4W to a point near the SE Corner Section 28-T69N-R4W; thence east following substantially the section line of Sections 34, 35, and 36-T69N-R4W to a point near the NE Corner Section 36-T69N-R4W; thence in a southeasterly direction through Section 31 and 32-T69N-R3W and Section 5-T68N-R3W to a point near the NE Corner Section 15-T68N-R3W (junction US 61).

NOW, THEREFORE: Be it resolved that the Iowa Department of Transportation approve the location of Iowa 16, Lee County, Iowa.

NOTE: To become effective upon the adoption of this resolution.

REVISED: 5-13-87

## **OFFICIAL DESCRIPTION CHANGE**

**COUNTY:** Lee

**ROUTE:** Iowa 16

**APPROVAL DATE:** 10-28-62

Beginning at a point near the NW Corner Section 6-T69N-R7W, Lee County (NE Corner Section 1-T69N-R8W, Van Buren County) (SW Corner Section 31-T79N-R7W, Henry County); thence east along the Lee-Henry County line to a point approximately 600 feet east of the N  $\frac{1}{4}$  Corner Section 6-T69N-R7W; thence in a southeasterly, southerly, easterly and southerly direction through Section 6 and 7-T69N-R7W to a point near the SE Corner Section 7-T69N-R7W; thence east following substantially the section line to the west corporation line of the Town of Houghton connecting with an unnamed street.

Houghton:

Commencing on an unnamed street at the west corporation line thence east on unnamed street to the east corporation line.

Beginning again at the east corporation line of the Town of Houghton; thence east following substantially the section line to a point approximately 1100 feet west of the N  $\frac{1}{4}$  Corner of Section 18-T69N-R5W; thence curving in a southeasterly direction to a point approximately 1100 feet south of the N  $\frac{1}{4}$  Corner Section 18-T69N-R5W; thence south to a point approximately 200 feet south of the center of Section 18-T69N-R5W; thence curving in a southeasterly direction to a point approximately  $\frac{1}{4}$  mile south and 1100 feet east of the center Section 18-T69N-R5W; thence east following substantially the south quarter-quarter line of Section 18, 17 and 16-T69N-R5W to a point approximately  $\frac{1}{4}$  mile south and 700 feet west of the center Section 16-T69N-R5W; thence in a southeasterly direction through Section 16, 21 and 22-T69N-R5W to a point approximately 1000 feet east of the W  $\frac{1}{4}$  Corner

Section 22-T69N-R5W; thence east following substantially the quarter section line to a point approximately 1500 feet east of the W  $\frac{1}{4}$  Corner Section 23-T69N-R5W; thence in a southeasterly direction through Section 23 and 24-T69N-R5W, and Section 19, 30, 29 and 28-T69N-R4W to a point near the SE Corner Section 29-T69N-R4W; thence east following substantially the section line to a point near the NE Corner Section 36-T69N-R4W; thence in a southeasterly direction across Section 31 and 32-T69N-R3W to connect with US 61 near the SE Corner Section 32-T69N-R3W.

REVISED: 11-28-62

**OFFICIAL DESCRIPTION CHANGE**

**COUNTY:** Lee

**APPROVAL DATE:** 4-14-37

Connecting Curves.

Junction of Iowa 16 and US 218:

Beginning at a point approximately 200 feet west of the SE Corner of Section 8-T69N-R6W; thence curving in a northeasterly direction to a point approximately 200 feet north of the SE Corner of Section 8-T69N-R6W.

Beginning at a point approximately 200 feet south of the NE Corner of Section 17-T69N-R6W; thence curving in a northwesterly direction to a point approximately 200 feet west of the NE Corner Section 17-T69N-R6W.