

ENTERED DATE: 08-28-2006

Senate File 451 transferred Iowa 50 in its entirety, in Webster County, to city and county jurisdiction on July 1, 2003.

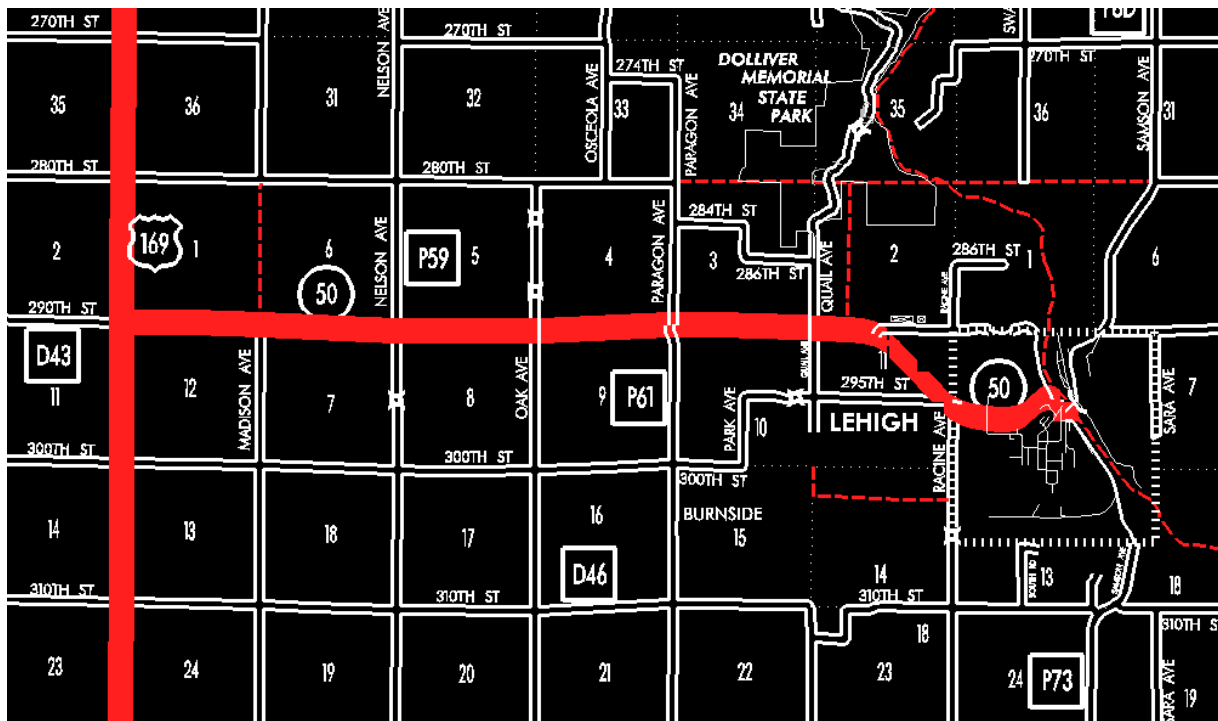

APPROVAL DATE: 5-13-87

New Description – Iowa 50 and its extension in Webster County described as follows:

Beginning at a point near the NW Corner Section 12–T87N–R29W (junction US 169); then east following substantially the section line of Section 12–T87N–R29W and Sections 7, 8, 9, 10 and 11–T87N–R28W to a point approximately 1,650 feet east of the NW Corner Section 11–T87N–R28W; then southeast through said Section 11 to the west corporation line of Lehigh, connecting with an unnamed street.

Lehigh:

Beginning on an unnamed street at the west corporation line; then southeast, east, northeast and southeast on unnamed street to Main Street.

COMMISSION ORDER

DIVISION: Planning & Research

COMMISSION ORDER NUMBER: PR–79–272

SUBMITTED BY: C. I. MacGillivray

MEETING DATE: 11–2–78

DISCUSSION/BACKGROUND:

Iowa 50 begins at US 169 approximately 7 miles west and 1 mile north of Lehigh, and travels generally easterly and southeasterly to a point in Lehigh, Iowa.

Due to a review of our Primary Road System Records Iowa 50 in Webster County should be deleted and the new description added should be officially included into the Primary System.

PROPOSAL/ACTION RECOMMENDATION:

It is recommended that the old description of Iowa 50 in Webster County be deleted and the new description, as referred in the attached detailed description, be included in the Primary Road System effective upon the adoption of this resolution.

Locate Iowa 50 and its extension in Webster County as follows:

Beginning at a point near the NW Corner Section 12-T87N-R29W (junction US 169); thence easterly following substantially the section line of Section 12-T87N-R29W and Sections 7, 8, 9, 10, and 11-T87N-R28W to a point approximately 1650 feet east of the NW Corner Section 11-T87N-R28W; thence southeasterly through said Section 11 to the west corporation line of the City of Lehigh connecting with an unnamed street.

Lehigh:

Beginning on the west corporation line connecting with an unnamed street; thence generally easterly and southeasterly to Miner Street.

REVISED: 5-13-87

OFFICIAL DESCRIPTION CHANGE

COUNTY: Webster

ROUTE: Iowa 50

APPROVAL DATE: 12-11-63

Beginning at a point near the NW Corner of Section 12-T78N-R29W; thence east following substantially the section line to a point near the NW Corner of Section 11-T87N-R28W; thence in a southeasterly direction through said Section 11 to the west corporation line of the Town of Lehigh at a point approximately 355 feet south of the W $\frac{1}{4}$ Corner of Section 12-T87N-R28W connecting with an unnamed street.

OFFICIAL DESCRIPTION CHANGE

COUNTY: Webster

CITY OF: Lehigh

ROUTE: Iowa 50

APPROVAL DATE: 4-3-51

Beginning at a point on the west corporation line of the town of Lehigh, connecting with an unnamed street; thence in a general easterly direction on said unnamed street to a point near the intersection of Bridge Street and Main Street; thence southeast on Main Street to the north line of Miner Street.