

OFFICIAL DESCRIPTION CHANGE

OFFICE: Transportation Data

EFFECTIVE DATE: 07-01-2003

ENTERED BY: Stefani Wonders

ENTERED DATE: 08-21-2006

DISCUSSION/BACKGROUND:

Senate File 451 transferred Iowa 55 in its entirety, in Wayne County, to city and county jurisdiction on July 1, 2003.

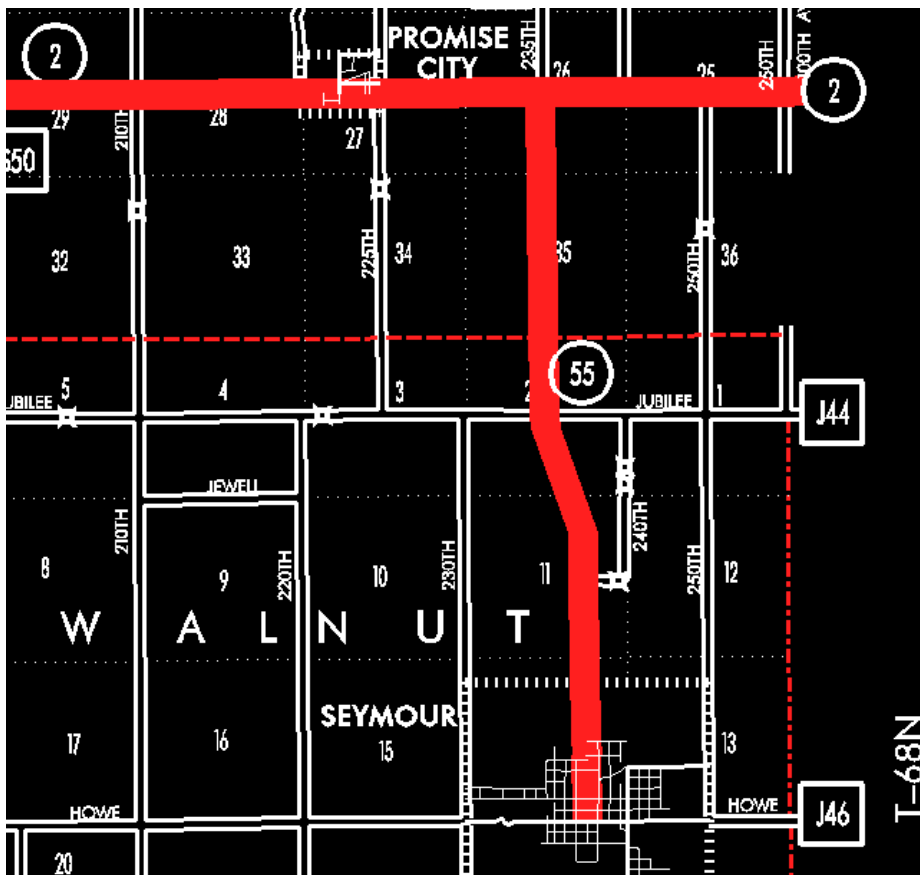

STAFF ACTION

OFFICE: Transportation Inventory

STAFF ACTION NUMBER: S-93-783

SUBMITTED BY: Patrick R. Cain

SUBMITTAL DATE: 12-11-92

DISCUSSION/BACKGROUND:

Transfer of jurisdiction agreement number 88-TJ-008 between the Iowa Department of Transportation and the City of Seymour, transferred a two-block portion (0.13 mile) of Iowa 55 to local jurisdiction on September 16, 1988.

The official description of Iowa 55 in Wayne County should be revised to reflect this change.

Iowa 55 begins in Seymour and travels northerly approximately 4 ½ miles to junction with Iowa 2.

PROPOSAL/ACTION RECOMMENDATION:

It is recommended to approve revising the official description of Iowa 55 in Wayne County and to include the attached new description in the primary road system.

New Description – Iowa 55 and its extension in Wayne County described as follows:

Seymour:

Beginning at the intersection of 5th Street and Main Street; thence north on 5th Street to the north corporation line.

Beginning at the north corporation line of Seymour connecting with 5th Street; thence north following substantially the east quarter section line of Sections 14 and 11-T68N-R20W to a point approximately 1,300 feet west of the E ¼ Corner Section 11-T68N-R20W; thence northwest

through Sections 11 and 2-T68N-R20W to a point near the center Section 2-T68N-R20W; thence north following substantially the center section line of Section 2-T68N-R20W and Sections 35 and 26-T69N-R20W to a point near the center of Section 26-T69N-R20W (junction Iowa 2).

OFFICIAL DESCRIPTION CHANGE

COUNTY: Wayne

ROUTE: Iowa 55

STAFF ACTION NUMBER: S-87-1502

APPROVAL DATE: 5-13-87

New Description – Iowa 55 and its extension in Wayne County described as follows:

Seymour:

Beginning at the west side of the intersection of 3rd Street and Main Street; thence west on Main Street to 5th Street; thence north on 5th Street to the north corporation line.

Beginning at the north corporation line of Seymour connecting with 5th Street; thence north following substantially the east quarter section line of Sections 14 and 11-T68N-R20W to a point approximately 1,300 feet west of the E $\frac{1}{4}$ Corner Section 11-T68N-R20W; thence northwest through Sections 11 and 2-T68N-R20W to a point near the center Section 2-T68N-R20W; thence north following substantially the center section line of Section 2-T68N-R20W and Sections 35 and 26-T69N-R20W to a point near the center of Section 26-T69N-R20W (junction Iowa 2).

REVISED: 12-11-92

COMMISSION ORDER

DIVISION: Planning & Research

COMMISSION ORDER NUMBER: PR-79-272

SUBMITTED BY: C. I. MacGillivray

MEETING DATE: 11-2-78

DISCUSSION/BACKGROUND:

Iowa 55 begins at a point in Seymour, and travels generally northerly approximately 4 ½ miles to a junction with Iowa 2.

Due to a review of our Primary Road System Records Iowa 55 in Wayne County should be deleted and the new description added should be officially included into the Primary System.

PROPOSAL/ACTION RECOMMENDATION:

It is recommended that the old description of Iowa 55 in Wayne County be deleted and the new description, as referred in the attached detailed description, be included in the Primary Road System effective upon the adoption of this resolution.

Locate Iowa 55 and its extension in Wayne County as follows:

Seymour:

Beginning on an unnamed street at 3rd Street; thence westerly and northerly to the north corporation line connecting with an unnamed street.

Beginning at the north corporation line of the City of Seymour connecting with an unnamed street; thence northerly following substantially the east quarter section line of Sections 14 and 11-T68N-R20W to a point

approximately 1300 feet west of the E ¼ Corner Section 11-T68N-R20W; thence in a northwesterly direction through Sections 11 and 2-T68N--R20W to a point near the center Section 2-T68N-R20W; thence northerly following substantially the center section line of Section 2-T68N-R20W and Sections 35 and 26-T69N-R20W to a point near the center of Section 26-T69N-R20W (junction Iowa 2).

REVISED: 5-13-87

OFFICIAL DESCRIPTION CHANGE

COUNTY: Wayne

CITY OF: Seymour

ROUTE: Iowa 55

APPROVAL DATE: 4-20-60

Commencing at the west side of the intersection of Third Street and Main Street; thence westerly on Main Street to Fifth Street; thence northerly on Fifth Street to the north corporation line.

OFFICIAL DESCRIPTION CHANGE

COUNTY: Wayne

APPROVAL DATE: 04-14-37

Connecting Curves.

North junction of Iowa 2 and US 65.

Beginning at a point approximately 600 feet west of the E ¼ Corner Section 21-T69N-R23W; thence curving in a northeasterly direction to a

point approximately 600 feet north of the E ¼ Corner Section 21-T69N-R23W.

South junction of Iowa 2 and US 65.

Beginning at a point approximately 600 feet south of the NW Corner Section 27-T69N-R23W; thence curving in a northeasterly direction to a point approximately 600 feet east of the NW Corner Section 27-T69N-R23W.

Junction of Iowa 2 and Iowa 55.

Beginning at a point approximately 200 feet south of the center of Section 26-T69N-R20W; thence curving in a northeasterly direction to a point approximately 200 feet east of the center of Section 26-T69N-R20W.

OFFICIAL DESCRIPTION CHANGE

COUNTY: Wayne

ROUTE: Iowa 55

APPROVAL DATE: 4-14-37

Beginning on the north corporation line of the Town of Seymour, connecting with Fifth Street; thence north following substantially the east quarter-quarter line of Section 14 and 11-T68N-R20W to a point approximately ¼ mile west of the E ¼ Corner Section 11-T68N-R20W; thence in a northwesterly direction through Section 11 and 2-T68N-R20W to a point near the center of Section 2-T68N-R20W; thence north following substantially the quarter section line to a point approximately 200 feet south of the center of Section 26-T69N-R20W; thence curving in a northwesterly direction to a point approximately 200 feet west of the center of Section 26-T69N-R20W.