

New Description – Iowa 86 and its extension in Dickinson County described as follows:

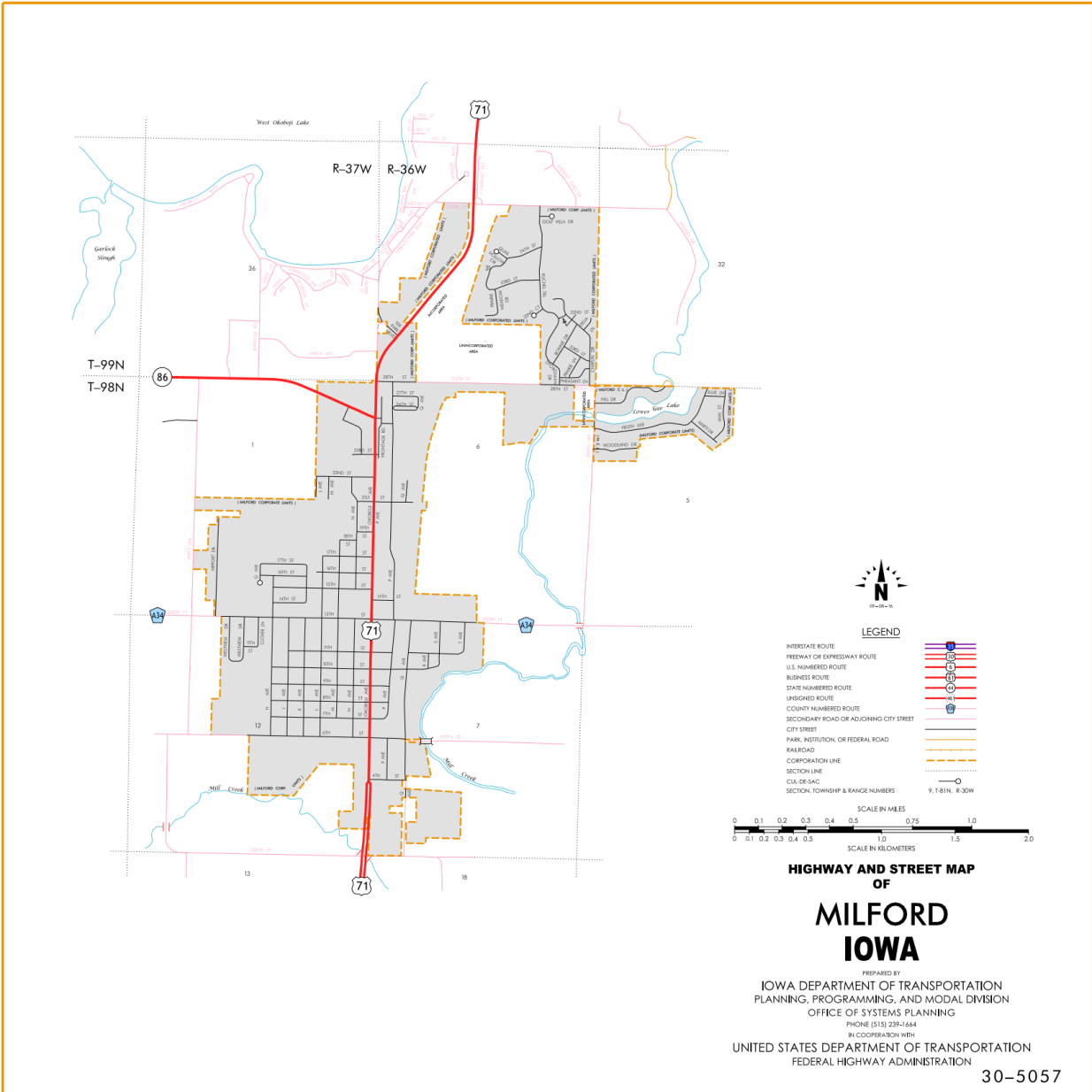

Milford:

Beginning at the junction of US 71 (approximately 400 feet south of the NE Corner of Section 1-T98N-R37W); thence northwesterly to the west corporation line.

Beginning again at the west corporation line of Milford curving northwesterly through Section 1-T98N-R37W to the south corporation line of West Okoboji.

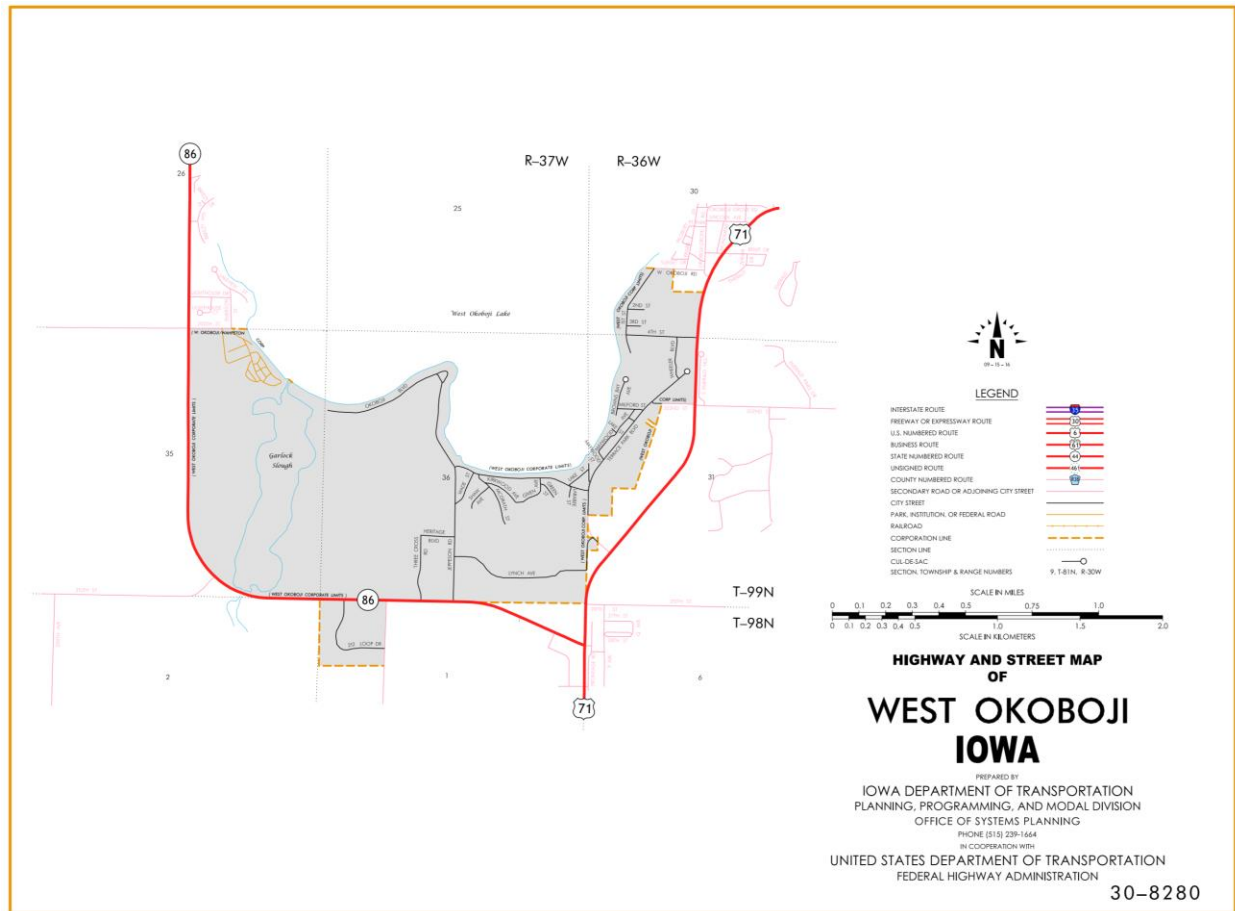

West Okoboji:

Beginning at the south corporation line; thence west, northwest and north to the north corporation line and south corporation line of Wahpeton.

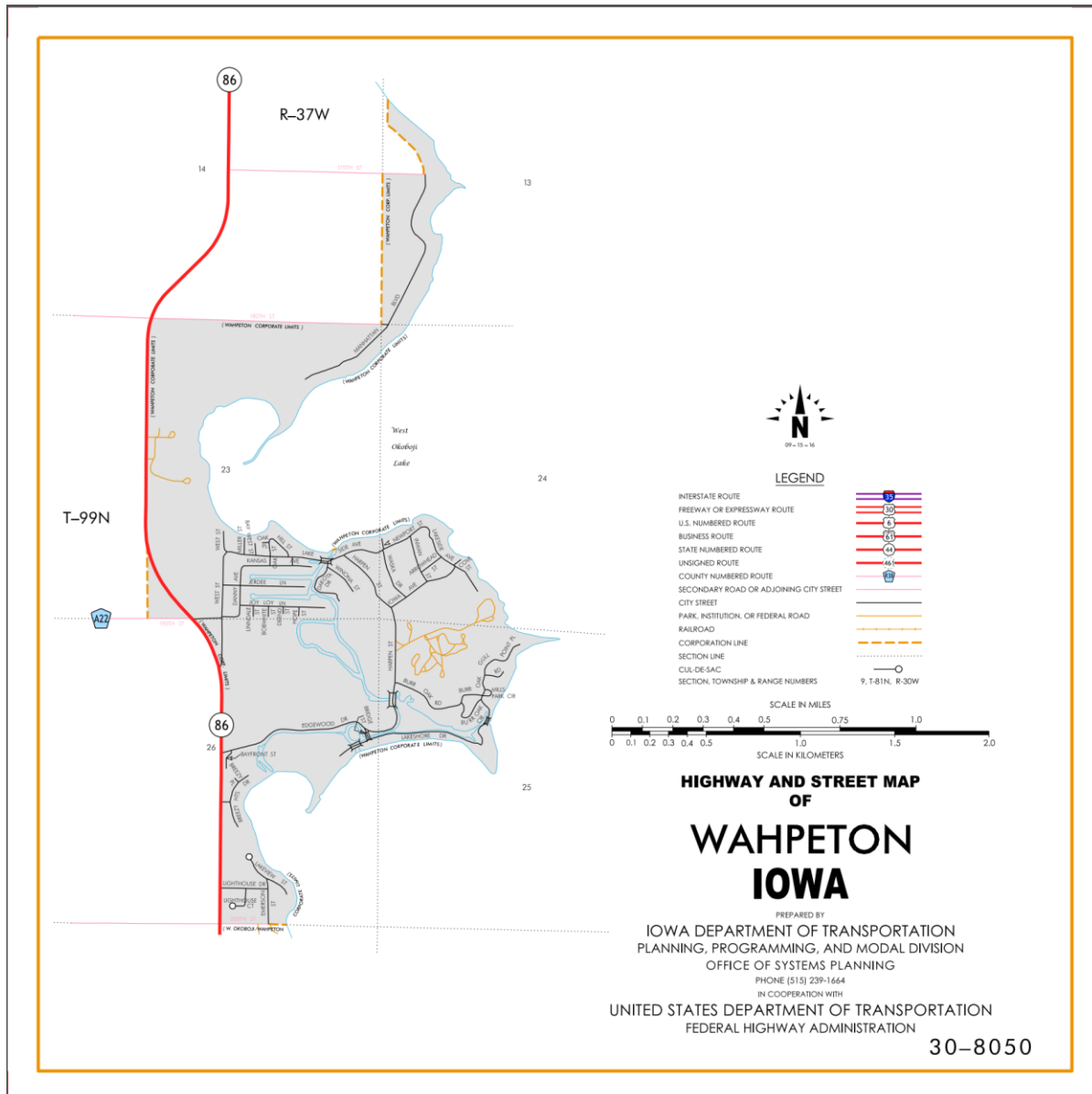

Wahpeton:

Beginning at the south corporation line; thence northwesterly and north to the north corporation line.

Beginning again on the north corporation line of Wahpeton; thence in a northerly direction through Sections 14, 11 and 2-T99N-R37W to a point near the N $\frac{1}{4}$ Corner of Section 2-T99N-R37W (junction Iowa 9); thence north

following substantially the center section line of Sections 35, 26, 23, 14–T100N–R37W; thence curving in a northeasterly direction to a point approximately to a point approximately 1,100 feet east of the N ¼ Corner Section 11–T100N–R37W on the Iowa–Minnesota State line.

OFFICIAL DESCRIPTION CHANGE

COUNTY: Dickinson

ROUTE: Iowa 86

STAFF ACTION NUMBER: S–87–703

APPROVAL DATE: 12–18–86

New Description – Iowa 86 and its extension in Dickinson County described as follows:

Beginning at a point approximately 400 feet south of the NE Corner of Section 1–T98N–R37W (junction US 71); thence curving in a northwesterly direction to a point approximately 400 feet west of the NE Corner of Section 1–T98N–R37W; thence westerly following substantially the section line of Sections 1 and 2–T98N–R37W to a point approximately 950 feet west of the NW Corner Section 2–T98N–R37W; thence northwesterly and northerly through Sections 35 and 26–T99N–R37W to the south corporation line of Wahpeton, connecting with an unnamed street.

Wahpeton:

Beginning on an unnamed street at the south corporation line; thence northwesterly on unnamed street to the west corporation line.

Beginning again on the west corporation line of Wahpeton, connecting with an unnamed street; thence in a northwesterly direction through Section 23–T99N–R37W to a point approximately one-quarter mile east and one-quarter mile north of the SW Corner of Section 23–T99N–R37W; thence in a northerly direction through Sections 23, 14, 11 and 2–T99N–R37W to a point

near the N $\frac{1}{4}$ Corner of Section 2-T99N-R37W (junction Iowa 9); thence north following substantially the center section line of Sections 35, 26, 23, 14 and 11-T100N-R37W to a point approximately 264 feet south of the N $\frac{1}{4}$ Corner Section 11-T100N-R37W; thence curving in a northeasterly direction to a point approximately 264 feet east of the N $\frac{1}{4}$ Corner Section 11-T100N-R37W on the Iowa-Minnesota State line; thence east following substantially the Section line of Section 11-T100N-R37W along the Iowa-Minnesota State line to a point approximately 1,100 feet east of the N $\frac{1}{4}$ Corner Section 11-T100N-R37W on the Iowa-Minnesota State line.

COMMISSION ORDER

DIVISION: Planning & Research

COMMISSION ORDER NUMBER: PR-81-418

SUBMITTED BY: Patrick R. Cain

MEETING DATE: 1-6-81

DISCUSSION/BACKGROUND:

Transfer of jurisdiction agreement number TJ-000-0 (1)--2M-30, between Dickinson County and the Iowa Department of Transportation, transferred the section of road from a junction with Iowa 9 and 32 near the S $\frac{1}{4}$ Corner Section 35-T100N-R37W north and east to the Iowa-Minnesota state line approximately 1100 feet east of the N $\frac{1}{4}$ Corner Section 11-T100N-R37W to state jurisdiction on July 1, 1980. The section is now designated Iowa 86.

To maintain continuity in the Iowa route numbering system Iowa 32 from a junction with US 71 approximately 400 feet south of the NE Corner of Section 1-T98N-R37W west and north to a junction with Iowa 9 near the N $\frac{1}{4}$ Corner Section 2-T99N-R37W should be re-designated as a portion of Iowa 86.

Iowa 86 begins at a junction with US 71 approximately one mile north of the City of Milford and proceeds westerly, northerly and easterly to the Iowa-Minnesota state line approximately seven miles northwest of the City of Spirit Lake.

PROPOSAL/ACTION RECOMMENDATION:

It is recommended the commission approve including the attached description of Iowa 86 in Dickinson County in the primary road system.

Locate Iowa 86 and its extension in Dickinson County as follows:

Beginning at a point approximately 400 feet south of the NE Corner of Section 1–T98N–R37W (junction US 71); thence curving in a northwesterly direction to a point approximately 400 feet west of the NE Corner of Section 1–T98N–R37W; thence westerly following substantially the section line of Sections 1 and 2–T98N–R37W and northwesterly northerly and northwesterly through Sections 35 and 26–T99N–R37W to the south corporation line of the City of Wahpeton, connecting with an unnamed street.

Wahpeton:

Beginning on unnamed street at the south corporation line. Thence northwesterly on unnamed street to the west corporation line.

Beginning again on the west corporation line of the City of Wahpeton, connecting with an unnamed street; thence in a northwesterly direction through Section 23–T99N–R37W to a point approximately one-quarter mile east and one-quarter mile north of the SW Corner of Section 23–T99N–R37W; thence in a northerly direction through Sections 23, 14, 11 and 2–T99N–R37W to a point near the N $\frac{1}{4}$ Corner of Section 2–T99N–R37W (junction Iowa 9); thence in a northerly direction following substantially the center section line of Sections 35, 26, 23, 14 and 11–T100N–R37W to a point approximately 264 feet south of the N $\frac{1}{4}$ Corner Section 11–T100N–R37W; thence curving in a northeasterly direction to a point approximately 264 feet east of the N $\frac{1}{4}$ Corner Section 11–T100N–R37W on the Iowa–Minnesota State line; thence easterly following substantially the Section line of Section 11–T100N–R37W along the Iowa–Minnesota State line to a point approximately 1100 feet east of the N $\frac{1}{4}$ Corner Section 11–T100N–R37W on the Iowa–Minnesota State line.