

EFFECTIVE DATE: 7-31-2020

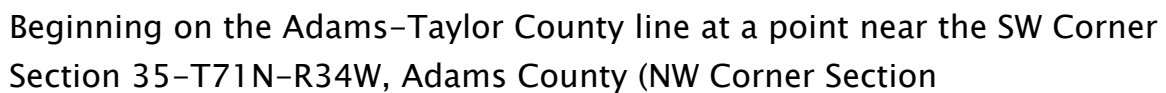

2-T70N-R34W, Taylor County); thence northerly following substantially the section line through Sections 35, 26, 23 and 14-T71N-R34W; thence northerly, northeasterly through Sections 11 and 2-T71N-R34W to the south corporation line of Corning connecting with Quincy Street.

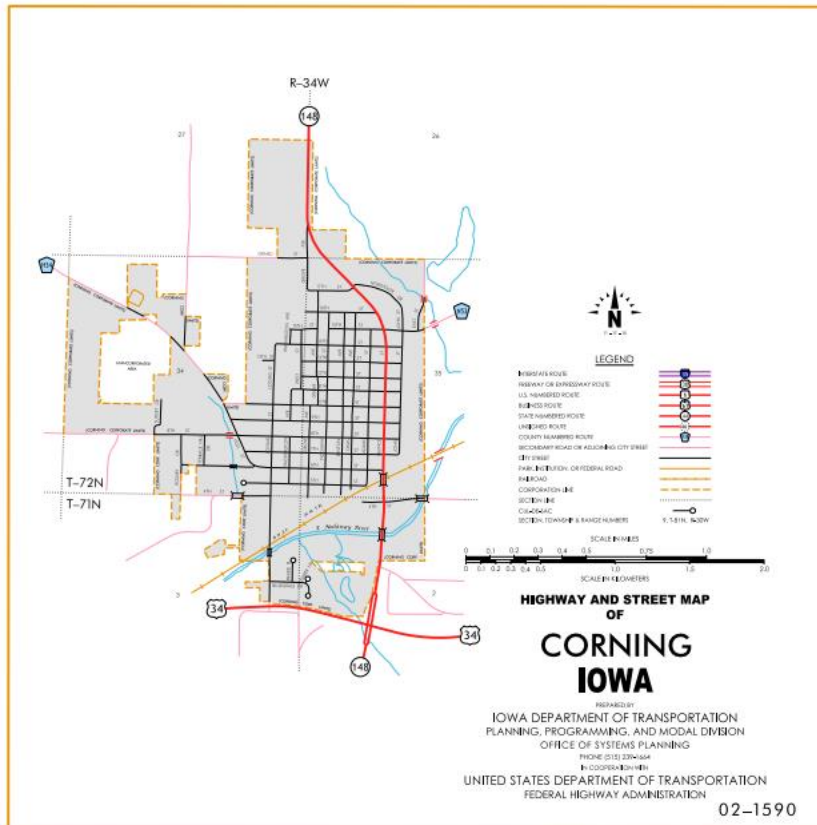

Corning:

Beginning at the south corporation line connecting with Quincy Street; thence northerly curving northwesterly on Quincy Street to the north corporation line.

Beginning again on the north corporation line of Corning connecting with Quincy Street; thence northerly, northwesterly, northerly through Sections 26, 23, 22, 15, 10, and 3-T72N-R34W; thence northerly through Sections

34, 27, 22, 15, 10 and 3-T73N-R34W to the Adams-Cass County line at a point near the NW Corner Section 3-T73N-R34W, Adams County (SW Corner Section 34-T74N-R34W, Cass County).

OFFICIAL DESCRIPTION CHANGE

COUNTY: Adams

ROUTE: Iowa 148

STAFF ACTION NUMBER: S-87-684

APPROVAL DATE: 12-18-86

New Description – Iowa 148 and its extension in Adams County described as follows:

Beginning on the Adams-Taylor County line at a point near the SW Corner Section 35-T71N-R34W, Adams County (NW Corner Section 2-T70N-R34W, Taylor County); thence northerly following substantially the section line through Sections 35, 26, 23 and 14-T71N-R34W; thence northerly, northeasterly through Sections 11 and 2-T71N-R34W to the south corporation line of Corning connecting with Quincy Street.

Corning:

Beginning at the south corporation line connecting with Quincy Street; thence northerly curving northwesterly on Quincy Street to the north corporation line.

Beginning again on the north corporation line of Corning connecting with Quincy Street; thence northerly, northwesterly, northerly through Sections 26, 23, 22, 15, 10, and 3-T72N-R34W; thence northerly through Sections 34, 27, 22, 15, 10 and 3-T73N-R34W to the Adams-Cass County line at a point near the NW Corner Section 3-T73N-R34W, Adams County (SW Corner Section 34-T74N-R34W, Cass County).

COMMISSION ORDER

DIVISION: Planning & Research

COMMISSION ORDER NUMBER: PR-79-272

SUBMITTED BY: C.I. MacGillivray

MEETING DATE: 11-2-78

DISCUSSION/BACKGROUND:

Due to the review of our Primary Road System Records, Iowa 148 in Adams County, Iowa should be deleted from the Primary System and the new description added should be officially included into the Primary Road System.

PROPOSAL/ACTION RECOMMENDATION:

Locate Iowa 148 in Adams County and its extension as follows:

Beginning on the Adams-Taylor County line at a point near the SW Corner Section 35-T71N-R34W, Adams County (NW Corner Section 2-T70N-R34W, Taylor County); thence northerly following substantially the section line through Sections 35, 26, 23 and 14-T71N-R34W; thence northerly, northeasterly through Sections 11 and 2-T71N-R34W to the south corporation line of the City of Corning connecting with an unnamed street.

Corning

Beginning at the south corporation line on an unnamed street; thence northerly curving northwesterly to the north corporation line.

Beginning again on the north corporation line of the City of Corning connecting with an unnamed street; thence northerly, northwesterly, northerly through Sections 26, 23, 22, 15, 10 and 3-T72N-R34W; thence northerly through Sections 34, 27, 22, 15, 10 and 3-T73N-R34W to the Adams-Cass County line at a point near the NW Corner Section 3-T73N-R34W, Adams County (SW Corner Section 34-T74N-R34W, Cass County).

NOW, THEREFORE: Be it resolved that the Iowa Department of Transportation approve the location of Iowa 148 in Adams County, Iowa.

NOTE: To become effective upon adoption of this resolution.

REVISED: 12-18-86

COMMISSION ORDER

DIVISION: Planning & Research

COMMISSION ORDER NUMBER: PR-76-497

SUBMITTED BY: Raymond L. Kassel

MEETING DATE: 4-20-76

DISCUSSION/BACKGROUND:

Due to the review of our Primary Road System Records, Iowa 148 in Adams County, Iowa should be deleted from the Primary System and tie new description added should be officially included into the Primary Road System.

PROPOSAL/ACTION RECOMMENDATION:

Locate Iowa 148 and its extension in Adams County as follows:

Beginning on the Adams–Taylor County line at a point near the SW Corner Section 35–T71N–R34W, Adams County (NW Corner Section 2–T70N–R34W, Taylor County); thence northerly following substantially the section line through Sections 35, 26, 23 and 14–T71N–R34W; thence northerly, northeasterly through Sections 11 and 2–T71N–R34W to the south corporation line of the City of Corning connecting with an unnamed street.

Corning

Beginning at the south corporation line on an unnamed street; thence northerly curving northwesterly to the north corporation line.

Beginning again on the north corporation line of the City of Corning connecting with an unnamed street; thence northerly, northwesterly, northerly through Sections 27, 23, 22, 15, 10 and 3–T72N–R34W; thence northerly through Sections 34, 27, 22, 15, 10 and 3–T73N–R34W to the Adams–Cass County line at a point near the NW Corner Section 3–T73N–R34W, Adams County (SW Corner Section 34–T74N–R34W, Cass County).

NOW, THEREFORE: Be it resolved that the Iowa Department of Transportation approve the location of Iowa 148 in Adams County, Iowa.

NOTE: To become effective upon adoption of this resolution.

COMMISSION RESOLUTION

DIVISION: Planning & Research

COMMISSION ORDER NUMBER: 74–773

SUBMITTED BY: Gene R. Mills

MEETING DATE: 6–26–74

Locate Iowa 148 and its extension in Adams County as follows:

Beginning on the Adams–Taylor County line at a point near the SW Corner Section 35–T71N–R34W, Adams County (NW Corner Section 2–T70N–R34W, Taylor County); thence north following substantially the section line to a point approximately 1,890 feet south of the NW Corner Section 11–T71N–R34W; thence northeasterly through Section 11 and 2–T71N–R34W to a point approximately 1,110 feet west and 257 feet south of the center of Section 2–T71N–R34W; thence northeasterly to the south corporation line of the City of Corning connecting with Quincy Street.

Corning

Commencing at the south corporation line on Quincy Street; thence northerly on Quincy Street to the Intersection of Fourteenth Street; thence curving northwesterly on Quincy Street to the north corporation line.

Beginning again on the north corporation line of the City of Corning connecting with Quincy Street; thence north to a point approximately 1,660 feet north of the NW Corner Section 26–T72N–R34W; thence in a northwesterly direction to a point approximately 200 feet south of the NW Corner Section 22–T72N–R34W; thence north following substantially the section line to the Adams–Cass County line at a point near the NW Corner Section 3–T73N–R34W, Adams County (SW Corner Section 34–T74N–R34W, Cass County).

NOW, THEREFORE: Be it resolved that the Iowa State Highway Commission approve the location of Iowa 148 in Adams County, Iowa, also its extension in Corning, Iowa.

OFFICIAL DESCRIPTION CHANGE

COUNTY: Adams

ROUTE: Iowa 148

COMMISSION ORDER NUMBER:

APPROVAL DATE: 5-29-63

Beginning on the Adams-Taylor County line at a point near the SW Corner Section 35-T71N-R34W, Adams County (NW Corner Section 2-T70N-R34W Taylor County); thence north following substantially the section line to a point approximately 1,890 feet south of the NW Corner Section 11-T71N-R34W; thence northeasterly through Section 11 and 2-T71N-R34W to a point approximately 1,110 feet west and 257 feet south of the center of Section 2-T71N-R34W; thence northeasterly to the south corporation line of the City of Corning connecting with an unnamed street.

Corning:

Commencing on an unnamed street thence northeasterly on an unnamed street to its intersection with Quincy Street; thence north on Quincy Street to the north line of Thirteenth Street; thence northwesterly 2,742 feet on an unnamed street to the north corporation line.

Beginning again on the north corporation line of the City of Corning connecting with an unnamed street; thence northwesterly to a point approximately 1,000 feet north of the SW Corner Section 26-T72N-R34W; thence north to a point approximately 1,700 feet north of the SE Corner Section 22-T72N-R34W; thence in a northwesterly direction to a point approximately 200 feet south of the NW Corner Section 22-T72N-R34W; thence north following substantially the section line to the Adams-Cass County line at a point near the NW Corner Section 3-T73N-R34W, Adams County (SW Corner Section 34-T74N-R34W, Cass County).

OFFICIAL DESCRIPTION CHANGE

COUNTY: Adams

ROUTE: Iowa 148

COMMISSION ORDER NUMBER:

APPROVAL DATE: 4-14-37

Beginning on the Adams-Taylor County line at a point near the SW Cor. of Sec. 35-T71-R34, Adams County, (NW Cor. of Sec. 2-T70R34, Taylor County), thence north following substantially the section line to a point approximately 1600 feet north of the SW Cor. of Sec. 2-T71-R34, thence in a northeasterly direction through Sec. 2-T71-R34 to the south corporation line of the City of Corning, connecting with an unnamed street at a point approximately 300 feet north and 200 feet west of the SE Cor. of irregular Lot 2 in the E. $\frac{1}{2}$ of the NW $\frac{1}{4}$ of Sec. 2-T71-R34.

Beginning again on the north corporation line of the City of Corning, connecting with an unnamed street at a point approximately 300 feet west of the NE Cor. of Lot 11 of the Ingalls subdivision of the City of Corning, in Sec. 35-T72-R34, thence northwesterly to a point approximately 1000 feet north of the SW Cor. of Sec. 26-T72-R34, thence north to a point approximately 1700 feet north of the SE Cor. of Sec. 22-T72-R34, thence in a northwesterly direction to a point approximately 200 feet south of the NW Cor. of Sec. 22-T72-R34, thence north following substantially the section line to the Adams-Cass County line at a point near the NW Cor. of Sec. 3-T73-R34, Adams County, (SW Cor. of Sec. 34-T74-R34, Cass County).

OFFICIAL DESCRIPTION CHANGE

COUNTY: Adams

ROUTE: US 148

APPROVAL DATE: 04-14-37

Beginning at a point approximately 600 feet north and 200 feet west of the center of Sec. 2-T71-R34, thence curving in a southwesterly direction

to a point approximately 500 feet north and 1 100 feet west of the center of Sec. 2-T71-R34.