

OFFICIAL DESCRIPTION CHANGE

OFFICE: Transportation Data

EFFECTIVE DATE: 07-01-2003

ENTERED BY: Stefani Wonders

ENTERED DATE: 08-22-2006

DISCUSSION/BACKGROUND:

Senate File 451 transferred Iowa 244 in its entirety, in Pottawattamie County, to city and county jurisdiction on July 1, 2003.

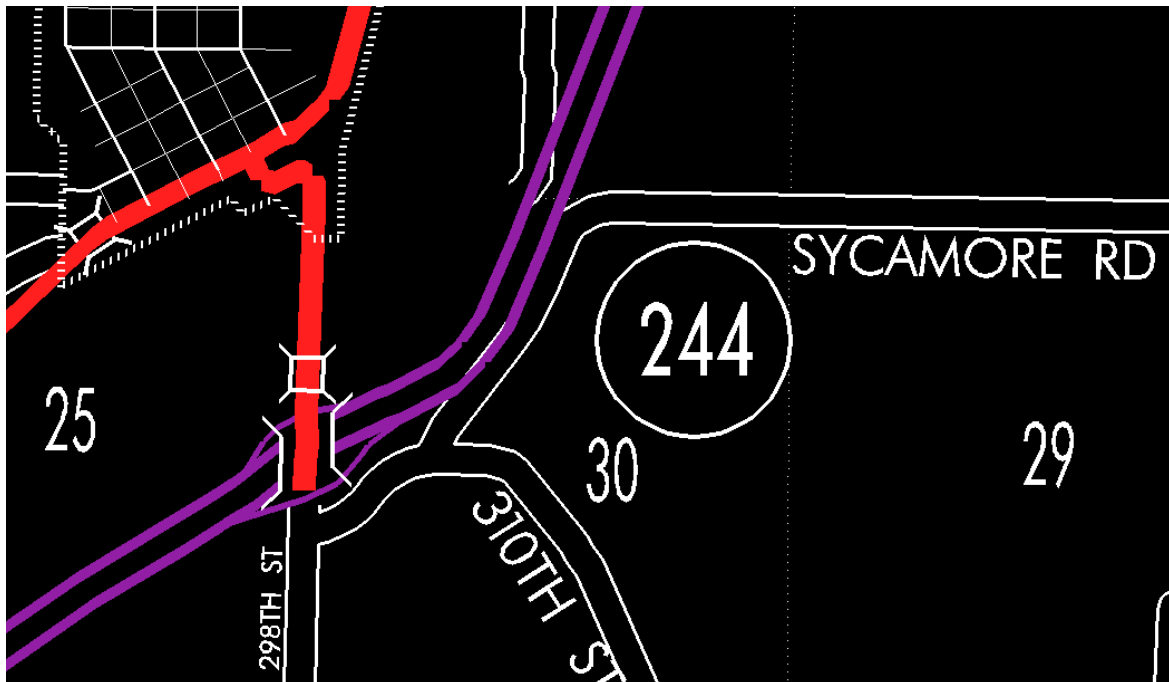

OFFICIAL DESCRIPTION CHANGE

COUNTY: Pottawattamie

ROUTE: Iowa 244

STAFF ACTION NUMBER: S-87-1517

APPROVAL DATE: 5-13-87

New Description Iowa 244 and its extension in Pottawattamie County described as follows:

Beginning at a point approximately 600 feet south of the W ¼ Corner Section 30-T77N-R41W (south ramps of Interstate 80); thence northerly following substantially the section line of said Section 30 (junction Interstate 60) to the south corporation line of Neola connecting with 2nd Street.

Neola:

Beginning on 2nd Street at the south corporation line; thence northerly, southwesterly and northwesterly on 2nd Street to Front Street (junction Iowa 191).

COMMISSION ORDER

DIVISION: Planning & Research

COMMISSION ORDER NUMBER: PR-81-711

SUBMITTED BY: Patrick R. Cain

MEETING DATE: 4-28-81

DISCUSSION/BACKGROUND:

Transfer of jurisdiction agreement number TJ-000-0(2)--2M-78, between Pottawattamie County and the Iowa Department of Transportation, transferred the section of road from the south ramps of Interstate 80 approximately 600 feet south of the W ¼ Corner Section 30-T77N-R41W north to the south corporation limits to the City of Neola to state jurisdiction on August 1, 1980. The road section is now designated as Iowa 244.

Transfer of jurisdiction agreement number TJ-000-0(3)--2M-78, between the City of Neola and the Iowa Department of Transportation, transferred the road section from south corporation line northerly, south-westerly and northwesterly to Front Street (US 191) to state jurisdiction on July 1, 1980. The road section is now designated Iowa 244.

Iowa 244 begins at the south ramps of Interstate 80 approximately one-half mile south of the City of Neola and travels generally northerly to Iowa 191 in the City of Neola.

PROPOSAL/ACTION RECOMMENDATION:

It is recommended the commission approve including the attached description of Iowa 244 in Pottawattamie County in the primary road system.

Locate Iowa 244 and its extension in Pottawattamie County as follows:

Beginning at a point approximately 600 feet south of the W $\frac{1}{4}$ Corner Section 30-T77N-R41W (south ramps of Interstate 80); thence northerly following substantially the section line of said Section 30 (junction 1-80) to the south corporation line of the City of Neola connecting with an unnamed street.

Neola:

Beginning on the south corporation line connecting with an unnamed street; thence northerly, southwesterly and northwesterly to Front Street (junction Iowa 191).

REVISED: 5-13-87