

**OFFICIAL DESCRIPTION CHANGE**

**OFFICE:** Transportation Data

**EFFECTIVE DATE:** 07-01-2003

**ENTERED BY:** Stefani Wonders

**ENTERED DATE:** 08-23-2006

**DISCUSSION/BACKGROUND:**

Senate File 451 transferred Iowa 301 in its entirety, in Harrison County, to city and county jurisdiction on July 1, 2003.

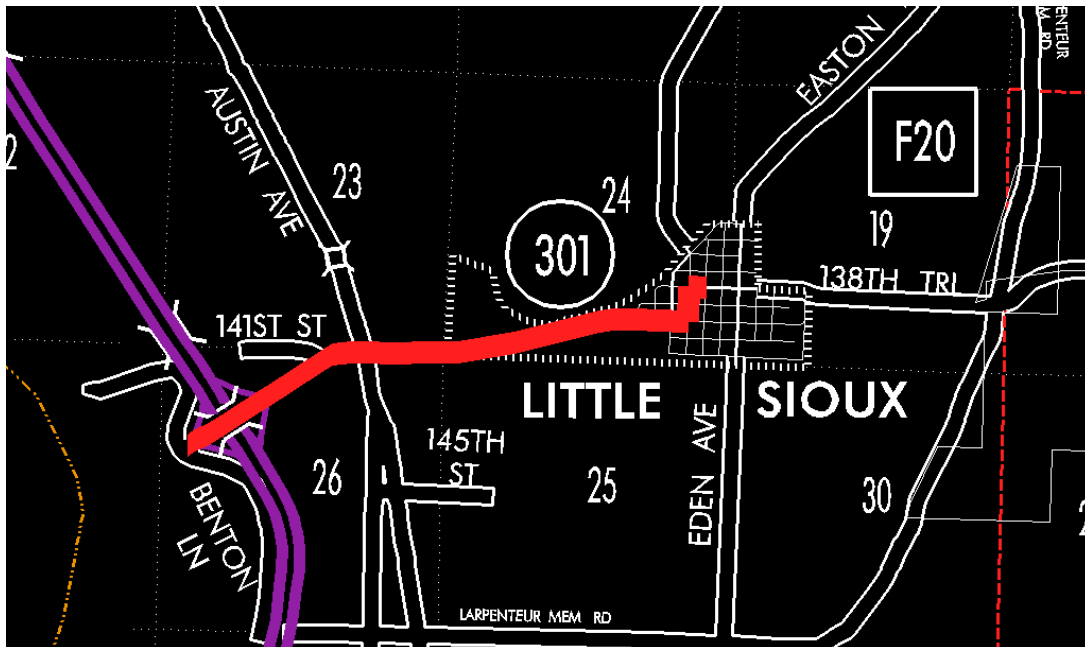

**OFFICIAL DESCRIPTION CHANGE**

**COUNTY:** Harrison

**ROUTE:** Iowa 301

**STAFF ACTION NUMBER:** S-87-732

**APPROVAL DATE:** 12-18-86

New Description – Iowa 301 and its extension in Harrison County described as follows:

Beginning at a point approximately 1,800 feet south and 500 feet east of the NW Corner Section 26–T81N–R45W (west ramps of Interstate 29); thence northeasterly through said Section 26 (junction Interstate 29) to a point approximately 1,000 feet east of the N ¼ Corner Section 26–T81N–R45W; thence easterly following substantially the section line said Section 26 to the west corporation line of Little Sioux, connecting with Vine Street.

Little Sioux:

Beginning on Vine Street at the west corporation line; thence northeast and east on Vine Street to 2nd Street; thence north on 2nd Street to Mulberry Street; thence east on Mulberry Street to 3rd Street.

**COMMISSION ORDER**

**DIVISION:** Planning & Research

**COMMISSION ORDER NUMBER:** PR–79–272

**SUBMITTED BY:** C.I. MacGillivray

**MEETING DATE:** 11–2–78

**DISCUSSION/BACKGROUND:**

Due to a review of our Primary Road System Records Iowa 301 in Harrison County should be deleted and the new description added should be officially included into the Primary System.

**PROPOSAL/ACTION RECOMMENDATION:**

It is recommended that the old description of Iowa 301 in Harrison County be deleted and the new description, as referred in the attached detailed description, be included in the Primary Road System effective upon the adoption of this resolution.

Locate Iowa 301 and its extension as follows:

Beginning at a point approximately 1800 feet south and 500 feet east of the NW Corner Section 26-T81N-R45W (west ramps of Interstate 29); thence northeasterly through said Section 26 (junction Interstate 29) to a point approximately 1000 feet east of the N  $\frac{1}{4}$  Corner Section 26-T81N-R45W; thence easterly following substantially the section line said Section 26 to the west corporation line of the City of Little Sioux, connecting with an unnamed street.

Little Sioux:

Beginning on the west corporation line connecting with an unnamed street; thence northeasterly, easterly, northerly and easterly to Third Street.

REVISED: 12-18-86

**COMMISSION RESOLUTION**

**DIVISION:** Planning & Research

**COMMISSION ORDER NUMBER:** 73-1392

**SUBMITTED BY:** Gene R. Mills

**MEETING DATE:** 11-7-73

Locate Iowa 301 in Harrison County as follows:

Beginning at a point near the center of the NW ¼ Section 26-T81N-R45W (Interstate 29); thence northeasterly to a point approximately 1,000 feet east of the N ¼ Corner Section 26-T81N-R45W; thence easterly following substantially the section line to the west corporation line of the Town of Little Sioux, connecting with an unnamed street.

NOW, THEREFORE: Be it resolved that the Iowa State Highway Commission approve the location of Iowa 301 in Harrison County, Iowa.

NOTE: To become effective upon adoption of this resolution.

REVISED: 1978

**OFFICIAL DESCRIPTION CHANGE**

**COUNTY:** Harrison

**ROUTE:** Iowa 301

**APPROVAL DATE:** 11-8-73

Beginning at a point near the center of the NW ¼ Section 26-T81N-R45W (Interstate 29); thence northeasterly to a point approximately 1,000 feet east of the N ¼ Corner Section 26-T81N-R45W; thence easterly following

substantially the section line to the west corporation line of the Town of Little Sioux, connecting with an unnamed street.

**OFFICIAL DESCRIPTION CHANGE**

**COUNTY:** Harrison

**ROUTE:** Iowa 301

**APPROVAL DATE:** 10-30-63

Beginning at a point near the SE Corner of the NW  $\frac{1}{4}$  NW  $\frac{1}{4}$  of Section 26-T81N-R45W; thence northeasterly to a point approximately 1000 feet east of the N  $\frac{1}{4}$  Corner of Section 26-T81N-R45W; thence easterly following substantially the section line to the west corporation line of the Town of Little Sioux connecting with an unnamed street.

**OFFICIAL DESCRIPTION CHANGE**

**COUNTY:** Harrison

**CITY OF:** Little Sioux

**ROUTE:** Iowa 301

**APPROVAL DATE:** 1-31-39

Commencing on unnamed street at the west corporation line; thence northeasterly on unnamed street approximately 3175 feet to Vine Street; thence east on Vine Street to Second Street; thence north on Second Street to Mulberry Street; thence east on Mulberry Street to Third Street.

**REVISED:** 1978