

OFFICIAL DESCRIPTION CHANGE

OFFICE: Transportation Data

EFFECTIVE DATE: 07-01-2003

ENTERED BY: Stefani Wonders

ENTERED DATE: 08-24-2006

DISCUSSION/BACKGROUND:

Senate File 451 transferred Iowa 324 in its entirety, in Monona County, to county jurisdiction on July 1, 2003.

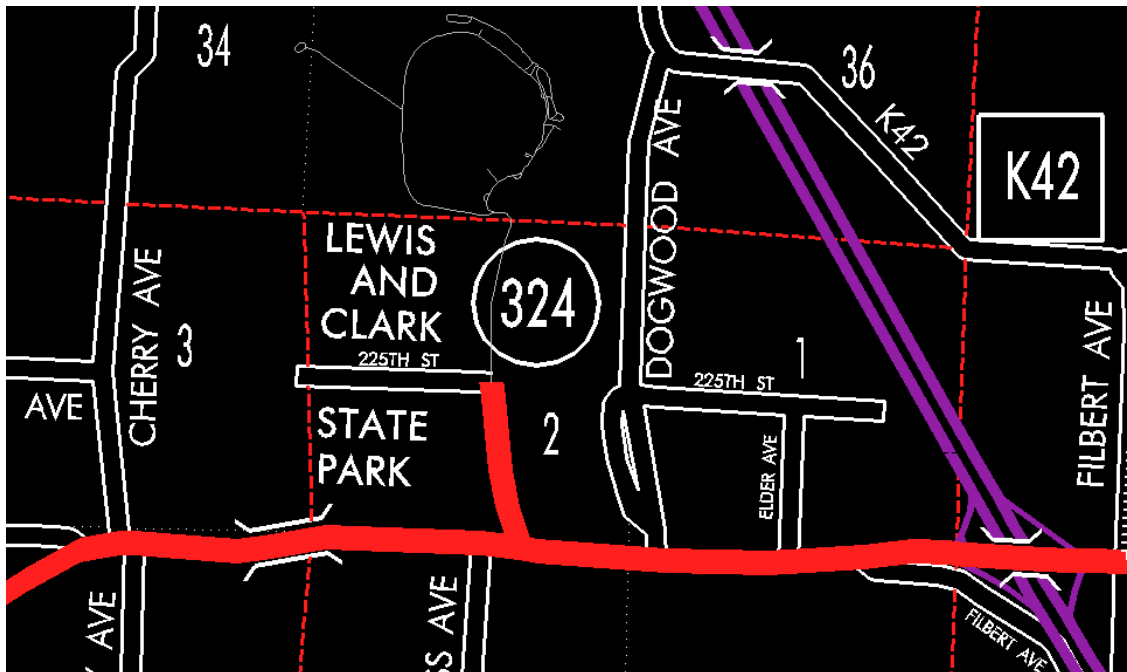

COMMISSION ORDER

DIVISION: Planning & Research

COMMISSION ORDER NUMBER: PR-79-272

SUBMITTED BY: C.I. MacGillivray

MEETING DATE: 11-2-78

DISCUSSION/BACKGROUND:

Due to a review of our Primary Road System records Iowa 324 in Monona County should be deleted and the new description added should be officially included into the Primary System.

Iowa 324 begins at Iowa 175 approximately 3 miles west of Onawa and runs northerly approximately ¼ mile to the entrance to Lewis and Clark State Park.

PROPOSAL/ACTION RECOMMENDATION:

Locate Iowa 324 in Monona County as follows:

Beginning at a point approximately 1900 feet west of the SE Corner Section 2–T83N–R46W (junction of Iowa 175); thence in a general northerly direction through the east part of Section 2–T83N–R46W to the entrance of Lewis and Clark State Park at a point approximately 500 feet east of the center of said Section 2.

NOW, THEREFORE: Be it resolved that the Iowa Department of Transportation approve the location of Iowa 324 in Monona County.

NOTE: To become effective upon the adoption of this resolution.

OFFICIAL DESCRIPTION CHANGE

COUNTY: Monona

ROUTE: Iowa 324

APPROVAL DATE: 2-25-56

Beginning at the entrance to Lewis and Clark State Park at a point approximately 500 feet east of the center of Section 2–T83N–R46W;

thence southerly to a point approximately 1900 feet west of the SE
Corner Section 2-T83N-R46W.

REVISED: 11-2-78