

**OFFICIAL DESCRIPTION CHANGE**

**OFFICE:** Transportation Data

**EFFECTIVE DATE:** 07-01-2003

**ENTERED BY:** Stefani Wonders

**ENTERED DATE:** 08-31-2006

**DISCUSSION/BACKGROUND:**

Senate File 451 transferred Iowa 325 in its entirety, in Winneshiek County, to county jurisdiction on July 1, 2003.

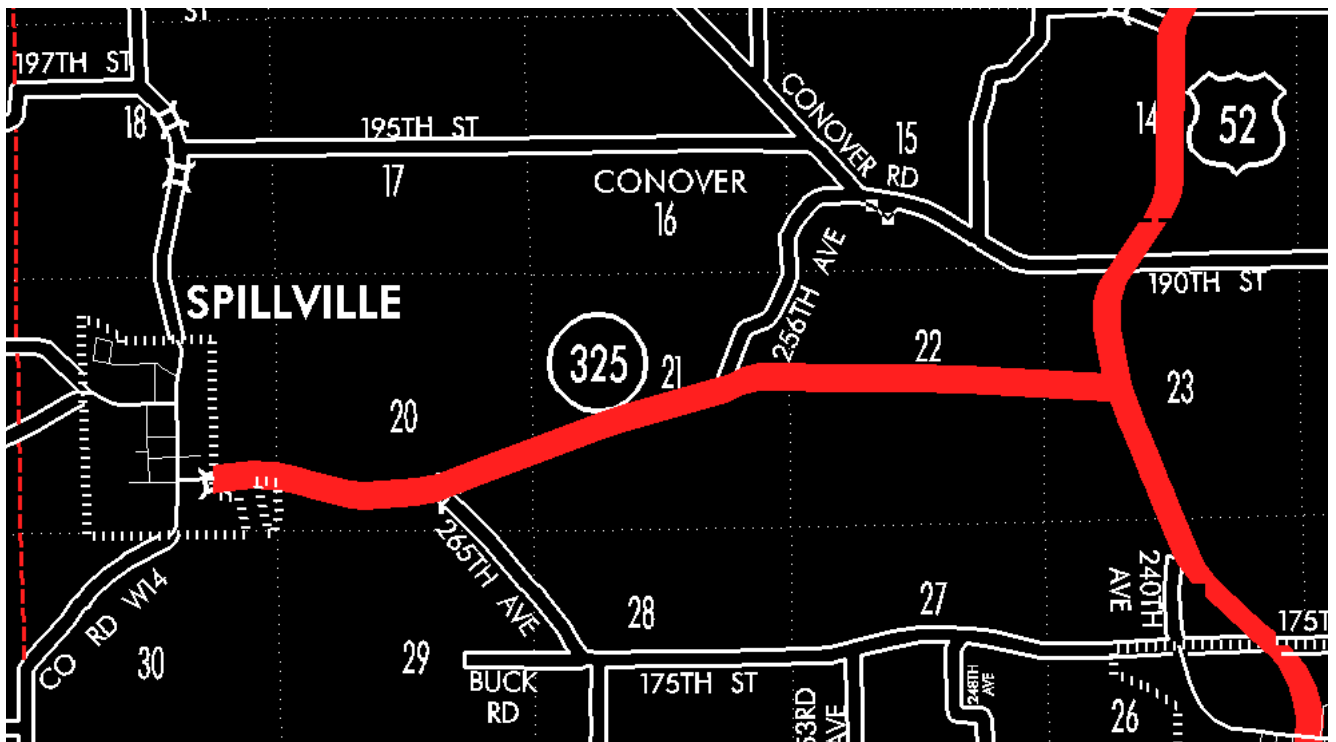

**OFFICIAL DESCRIPTION CHANGE**

**COUNTY:** Winneshiek

**ROUTE:** Iowa 325

**STAFF ACTION NUMBER:** S-87-1499

**APPROVAL DATE:** 5-13-87

New Description – Iowa 325 in Winneshiek County described as follows:

Beginning on the east corporation line of Spillville connecting with Bridge Street; then in an easterly, northeasterly and easterly direction through Sections 19, 20, 21, 22 and 23–T97N–R9W to a point approximately 1,100 feet west of the center of Section 23–T97N–R9W (junction US 52).

**COMMISSION ORDER**

**DIVISION:** Planning & Research

**COMMISSION ORDER NUMBER:** PR–82–469

**SUBMITTED BY:** Patrick R. Cain

**MEETING DATE:** 1–5–82

**DISCUSSION/BACKGROUND:**

Iowa 325 begins in the City of Spillville, and travels generally easterly to US 52 approximately three and one-half miles east of the City of Spillville.

Transfer of jurisdiction agreement number TJ–325–0(3), between the City of Spillville and the Iowa Department of Transportation, transferred that portion of Iowa 325 in the City of Spillville from Church Street southerly and easterly to the east corporation line to city jurisdiction on July 1, 1980.

**PROPOSAL/ACTION RECOMMENDATION:**

It is recommended the commission approve deleting the present description of Iowa 325 in Winneshiek County from the primary road system and approve including the attached new description of Iowa 325 in the primary road system.

Locate Iowa 325 in Winneshiek County as follows:

Beginning on the east corporation line of the City of Spillville connecting with an unnamed street; thence in an easterly, northeasterly, and easterly direction through Sections 19, 20, 21, 22, and 23-T97N-R9W to a point approximately 1100 feet west of the center of Section 23-T97N-R9W (junction US 52).

REVISED: 5-13-87

**COMMISSION ORDER**

**DIVISION:** Planning Research

**COMMISSION ORDER NUMBER:** PR-79-272

**SUBMITTED BY:** C.I. MacGillivray

**MEETING DATE:** 11-2-78

**DISCUSSION/BACKGROUND:**

Iowa 325 begins in Spillville, and travels generally southerly and easterly to US 52 approximately 1 ½ miles north-northwest of Calmar, Iowa.

Due to a review of our Primary Road System Records Iowa 325 in Winneshiek County should be deleted and the new description added should be officially included into the Primary System.

**PROPOSAL/ACTION RECOMMENDATION:**

It is recommended that the old description of Iowa 325 in Winneshiek County be deleted and the new description, as referred in the attached detailed description, be included in the Primary Road System effective upon the adoption of this resolution.

Locate Iowa 325 and its extension in Winneshiek County as follows:

Spillville:

Beginning on an unnamed street at Church Street; thence southerly and easterly to the east corporation line connecting with an unnamed street.

Beginning on the east corporation line of the City of Spillville connecting with an unnamed street; thence in an easterly, northeasterly, and easterly direction through Sections 19, 20, 21, 22, and 23-T97N-R9W to a point approximately 1100 feet west of the center of Section 23-T97N-R9W (junction US 52).

REVISED: 1-5-82

#### **OFFICIAL DESCRIPTION CHANGE**

**COUNTY:** Winneshiek

**ROUTE:** Iowa 325

**APPROVAL DATE:** 4-9-52

Beginning on the east corporation line of the Town of Spillville, connecting with Bridge Street; thence in an easterly, northeasterly and easterly direction through Sections 19, 20, 21, 22 and 23-T97N-R9W to a point a short distance west of the center of Section 23-T97N-R9W.

REVISED: 11-2-78

#### **OFFICIAL DESCRIPTION CHANGE**

**COUNTY:** Winneshiek

**APPROVAL DATE:** 4-14-37

Connecting Curves.

Junction of Iowa 9 and Iowa 139.

Beginning on the Winneshiek-Howard County line at a point approximately 600 feet south of the NW Corner Section 30-T99N-R10W, Winneshiek County, (NE Corner Section 25-T99N-R11W, Howard County); thence north along the Winneshiek-Howard County line to a point approximately 600 feet north of the SW Corner Section 19-T99N-R10W, Winneshiek County (SE Corner Section 24-T99N-R11W, Howard County).

Junction of US 52 and Iowa 325.

Beginning at a point approximately ¼ mile east of the northwest corner of Section 23-T97N-R9W; thence south to a point approximately ¼ mile east and 600 feet south of the NW Corner Section 23-T97N-R9W.

**OFFICIAL DESCRIPTION CHANGE**

**COUNTY:** Winneshiek

**CITY OF:** Spillville

**ROUTE:** Iowa 325

**APPROVAL DATE:** 2-5-36

Commencing on Bridge Street at the east corporation line; thence westerly on Bridge Street to Main Street; thence northerly on Main Street to Church Street.