

## OFFICIAL DESCRIPTION CHANGE

OFFICE: Transportation Data

EFFECTIVE DATE: 07-01-2003

ENTERED BY: Stefani Wonders

ENTERED DATE: 08-22-2006

## DISCUSSION/BACKGROUND:

Senate File 451 transferred Iowa 349 in its entirety, in Warren County, to county jurisdiction on July 1, 2003.

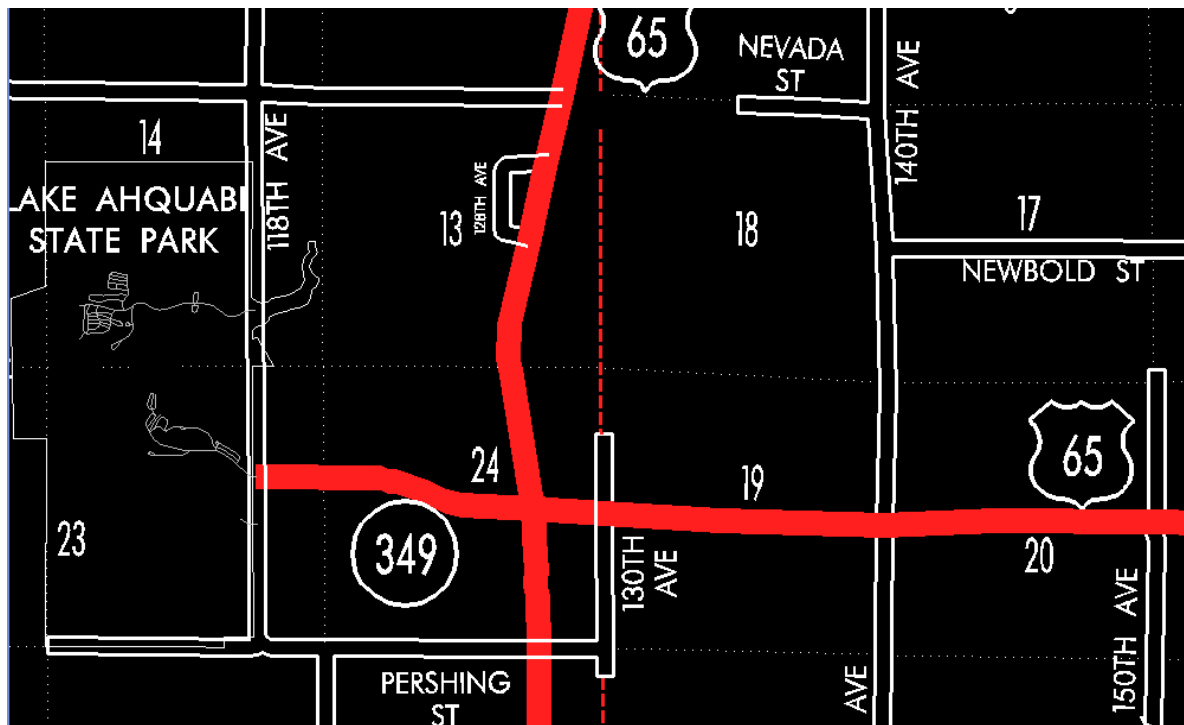

## COMMISSION ORDER

DIVISION: Planning & Research

COMMISSION ORDER NUMBER: PR-79-272

SUBMITTED BY: C.I. MacGillivray

MEETING DATE: 11-2-78

## **DISCUSSION/BACKGROUND:**

Iowa 349 begins at Lake Ahquabi State Park, and travels generally easterly approximately one mile to US 65 and 69.

Due to a review of our Primary Road System Records Iowa 349 in Warren County should be deleted and the new description added should be officially included into the Primary System.

## **PROPOSAL ACTION RECOMMENDATION:**

It is recommended that the old description of Iowa 349 in Warren County be deleted and the new description, as referred in the attached detailed description, be included in the Primary Road System effective upon the adoption of this resolution.

Locate Iowa 349 in Warren County as follows:

Beginning at a point approximately 650 feet north and 1300 feet west of the E  $\frac{1}{4}$  Corner Section 23-T75N-R24W (Lake Ahquabi State Park); thence southeasterly and easterly through Sections 23 and 24-T75N-R24W to a point approximately 1425 feet west of the E  $\frac{1}{4}$  Corner Section 24-T75N-R24W (junction US 65 & 69).

**OFFICIAL DESCRIPTION CHANGE**

**COUNTY:** Warren

**ROUTE:** Iowa 349

**APPROVAL DATE:** 8-30-38

Beginning at a point approximately 50 feet north and 1000 feet east of the center of Section 24 T75N-R24W; thence in a westerly direction approximately 1000 feet parallel to and 50 feet north of the east and west quarter line of Section 24-T75N-R24W; thence in a northwesterly direction to a point approximately 550 ft north of the center of the W  $\frac{1}{2}$  of Section 24-T75N-R24W; thence in a westerly direction approximately  $\frac{1}{2}$  mile to Ahquabi State Park at a point 660 feet north of the center of the E  $\frac{1}{2}$  of Section 23-T75N-R24W.