

## OFFICIAL DESCRIPTION CHANGE

OFFICE: Transportation Data

EFFECTIVE DATE: 05-08-2008

ENTERED BY: Darlene Bovee

ENTERED DATE: 05-28-2008

## DISCUSSION/BACKGROUND:

Transfer of jurisdiction agreement number 2003-TJ-040, between the City of Danville and the Iowa Department of Transportation, transferred that portion of unsigned Iowa 434 from the west corporation line connecting with an unnamed street; thence southeasterly on said unnamed street to the east corporation line (approximately 1750 feet east and 250 feet south of the W ¼ Corner Section 15-T70N-R4W) to city jurisdiction on May 8, 2008.



**OFFICIAL DESCRIPTION CHANGE****OFFICE:** Transportation Data**EFFECTIVE DATE:** 10/01/2007**ENTERED BY:** Darlene Bovee**ENTERED DATE:** 10/19/2007**DISCUSSION/BACKGROUND:**

Transfer of jurisdiction agreement number 2003-TJ-042, between Des Moines County and the Iowa Department of Transportation, transferred that portion of unsigned Iowa 434 from the west junction of US 34 (approximately 539 feet south and 1264 feet east of the W  $\frac{1}{4}$  Corner Section 9-T70N-R4W); thence southeasterly through Sections 9 and 16-T70N-R4W to the west corporation line of Danville connecting with an unnamed street (approximately 1798 feet west and 245 feet south of the NE Corner of said Section 16) to county jurisdiction on October 1, 2007.

Transfer of jurisdiction agreement number 2003-TJ-042 between Des Moines County and the Iowa Department of Transportation, transferred that portion of unsigned Iowa 434 from the east corporation line of Danville connecting with an unnamed street; thence southeasterly through Sections 15, 22, 23, and 25-T70N-R4W to the west corporation line of Middletown connecting with an unnamed street (approximately 923 feet north of the S  $\frac{1}{4}$  Corner of said Section 25) to county jurisdiction on October 1, 2007.

Transfer of jurisdiction agreement number 2003-TJ-042 between Des Moines County and the Iowa Department of Transportation, transferred that portion of unsigned Iowa 434 from the east corporation line of the City of Middletown connecting with an unnamed street; thence easterly following substantially the section line of Sections 31, 32, and 33-T70N-R3W to the west corporation the

City of West Burlington connecting with an unnamed street (approximately 1897 feet east of the NW Corner of said Section 33) to county jurisdiction on October 1, 2007.

New Description – Unsigned Iowa 434 and its extensions in Des Moines County described as follows:

Danville:

Beginning on an unnamed street at the west corporation line; thence southeasterly on said unnamed street to the east corporation line (approximately 1750 feet east and 250 feet south of the W  $\frac{1}{4}$  Corner Section 15-T70N-R4W).

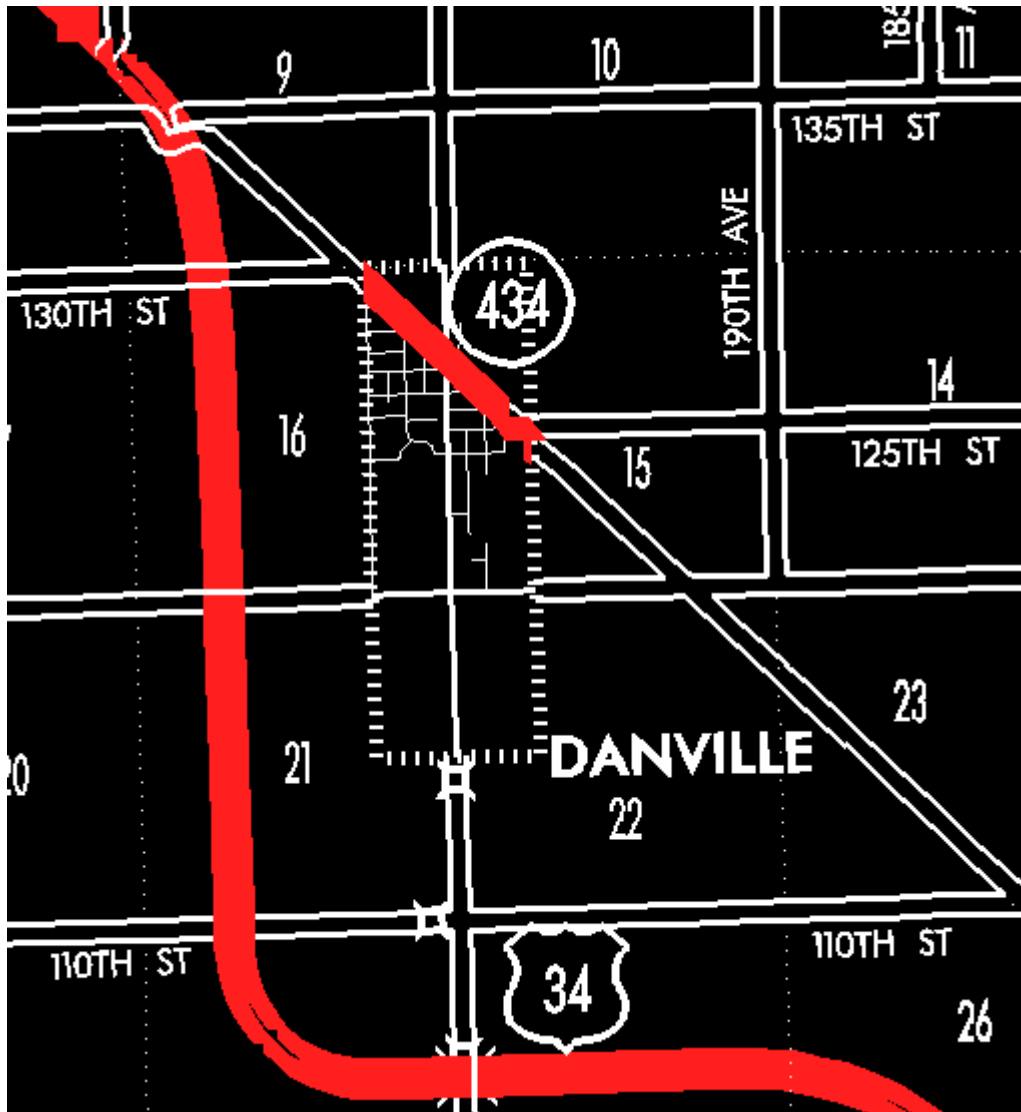

**OFFICIAL DESCRIPTION CHANGE**

OFFICE: Transportation Data

EFFECTIVE DATE: 08/01/2007

ENTERED BY: Darlene Bovee

ENTERED DATE: 10/19/2007

**DISCUSSION/BACKGROUND:**

Transfer of jurisdiction agreement number 2003-TJ-041, between the City of Middletown and the Iowa Department of Transportation, transferred that portion of unsigned Iowa 434 from the west corporation line; thence southeasterly and easterly on said unnamed street to the east corporation line (approximately 1192 feet east of the NW Corner Section 31-T70N-R3W) to city jurisdiction on August 1, 2007.

Transfer of jurisdiction agreement number 2003-TJ-043, between the City of West Burlington and the Iowa Department of Transportation, transferred that portion of unsigned Iowa 434 from the west corporation line connecting with an unnamed street; thence easterly to the east junction of US 34 (a point near the Center Section 34-T97N-R3W) to city jurisdiction on August 1, 2007.

New description - Unsigned Iowa 434 and its extensions in Des Moines County described as follows:

Beginning at the west junction of US 34 (approximately 539 feet south and 1264 feet east of the W  $\frac{1}{4}$  Corner Section 9-T70N-R4W); thence southeasterly through Sections 9 and 16-T70N-R4W to the west corporation line of Danville connecting with an unnamed street (approximately 1798 feet west and 245 feet south of the NE Corner of said Section 16).

Danville:

Beginning on an unnamed street at the west corporation line; thence southeasterly on said unnamed street to the east corporation line (approximately 1750 feet east and 250 feet south of the W  $\frac{1}{4}$  Corner Section 15-T70N-R4W).

Beginning again on the east corporation line of Danville connecting with an unnamed street; thence southeasterly through Sections 15, 22, 23, and 25-T70N-R4W to the west corporation line of Middletown connecting with an unnamed street (approximately 923 feet north of the S  $\frac{1}{4}$  Corner of said Section 25).

Beginning again on the east corporation line of the City of Middletown connecting with an unnamed street; thence easterly following substantially the section line of Sections 31, 32, and 33-T70N-R3W to the west corporation the City of West Burlington connecting with an unnamed street (approximately 1897 feet east of the NW Corner of said Section 33).

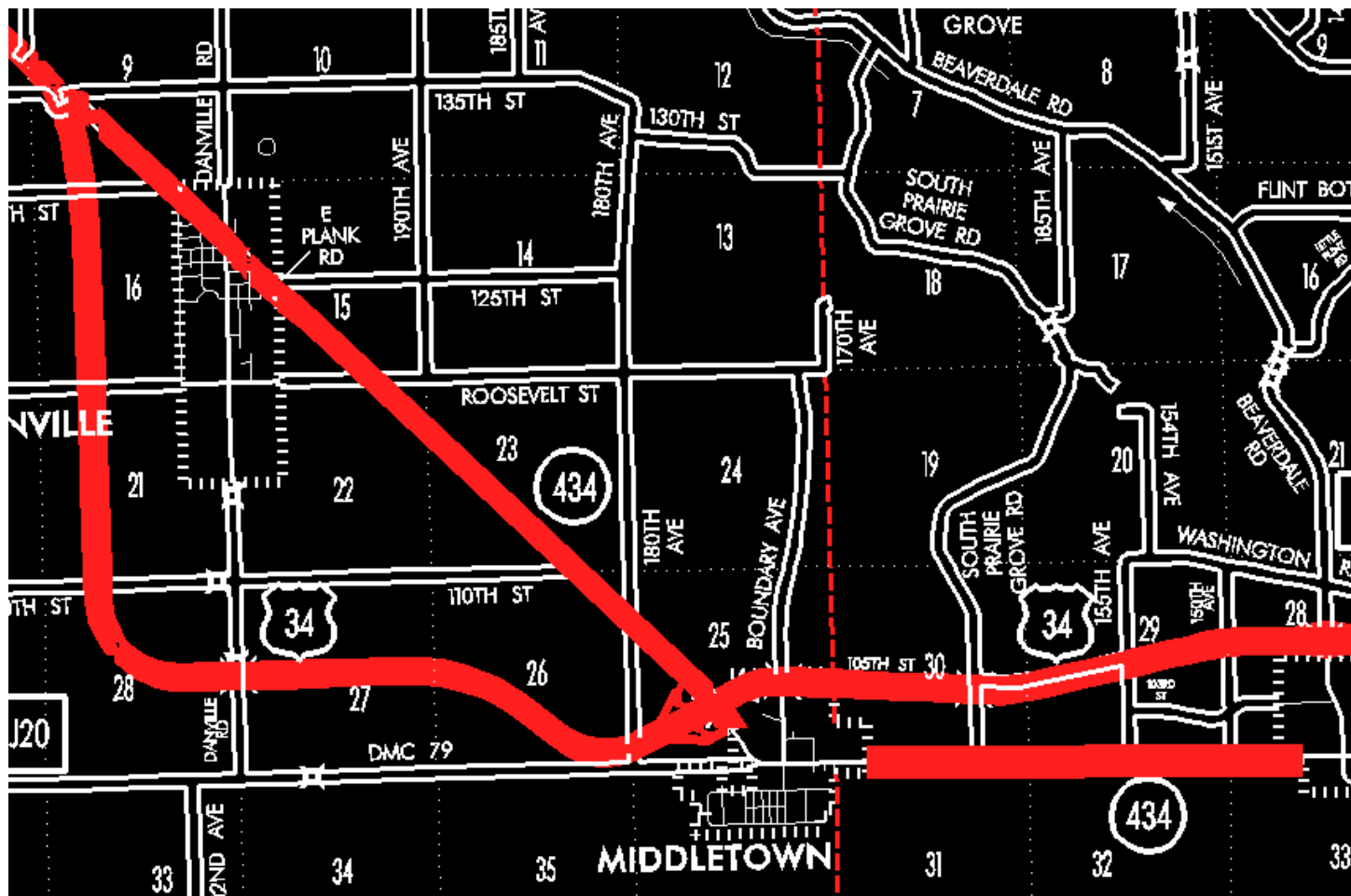

#### OFFICIAL DESCRIPTION CHANGE

OFFICE: Transportation Data

EFFECTIVE DATE: 1-4-2006

**ENTERED BY:** Stefani Wonders  
**ENTERED DATE:** 09-06-2006

**DISCUSSION/BACKGROUND:**

Due to the relocation of US 34, Old US 34 was designated Unsigned Iowa 434.

**PROPOSAL/ACTION RECOMMENDATION:**

New Description – Unsigned Iowa 434 and its extensions in Des Moines County described as follows:

Beginning at the west junction of US 34 (approximately 539 feet south and 1264 feet east of the W  $\frac{1}{4}$  Corner Section 9–T70N–R4W); thence southeasterly through Sections 9 and 16–T70N–R4W to the west corporation line of Danville connecting with an unnamed street (approximately 1798 feet west and 245 feet south of the NE Corner of said Section 16).

Danville:

Beginning on an unnamed street at the west corporation line; thence southeasterly on said unnamed street to the east corporation line (approximately 1750 feet east and 250 feet south of the W  $\frac{1}{4}$  Corner Section 15–T70N–R4W).

Beginning again on the east corporation line of Danville connecting with an unnamed street; thence southeasterly through Sections 15, 22, 23, and 25–T70N–R4W to the west corporation line of Middletown connecting with an unnamed street (approximately 923 feet north of the S  $\frac{1}{4}$  Corner of said Section 25).

Middletown:

Beginning again on the east corporation line of the City of Middletown connecting with an unnamed street; thence easterly following substantially the section line of Sections 31, 32, and 33-T70N-R3W to the west corporation the City of West Burlington connecting with an unnamed street (approximately 1897 feet east of the NW Corner of said Section 33).

Beginning on an unnamed street at the west corporation line; thence easterly to the east junction of US 34 (a point near the Center Section 34-T70N-R3W).

