

OFFICIAL DESCRIPTION CHANGE

OFFICE: Transportation Data

EFFECTIVE DATE: 07-01-2003

ENTERED BY: Stefani Wonders

ENTERED DATE: 08-28-2006

DISCUSSION/BACKGROUND:

Senate File 451 transferred Unsigned Iowa 916 in its entirety, in Oelwein, to city jurisdiction on July 1, 2003.

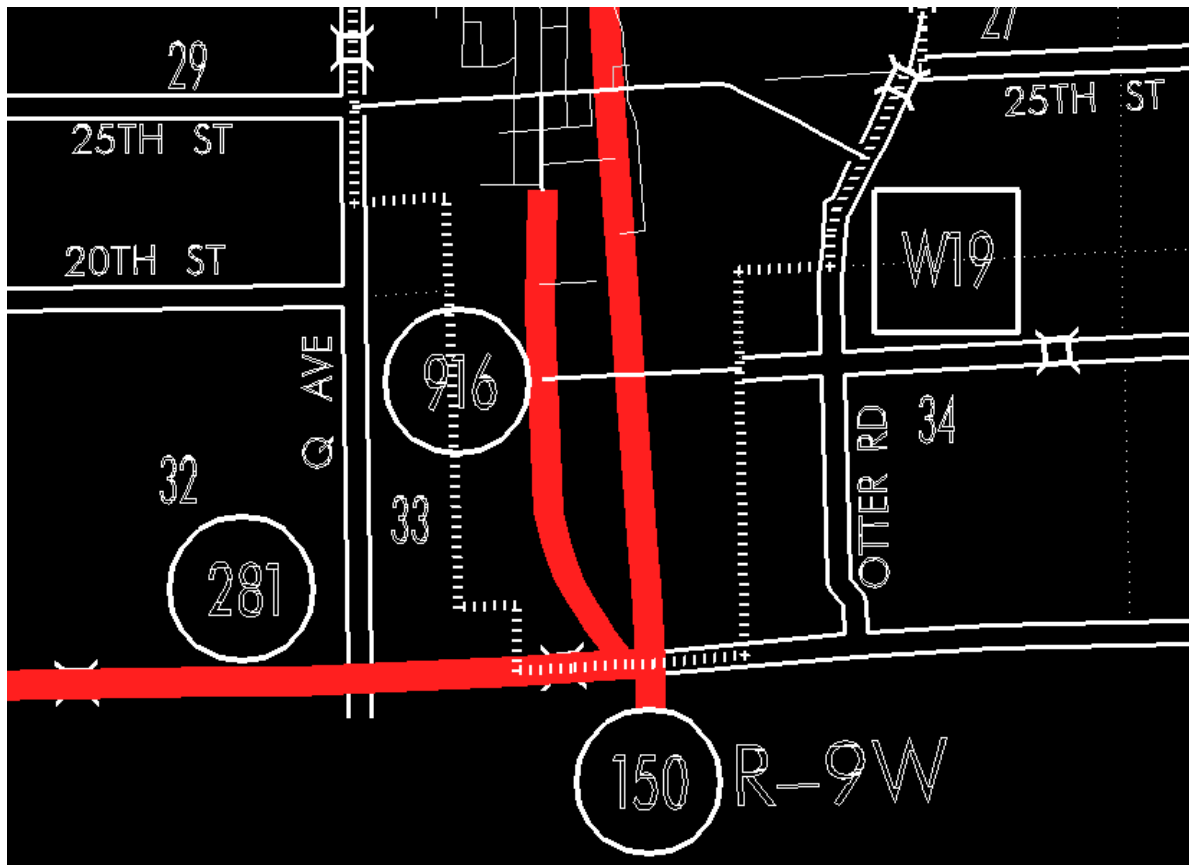

OFFICIAL DESCRIPTION CHANGE

OFFICE: Transportation Data
EFFECTIVE DATE: 2-2-96
ENTERED BY: Stefani Wonders
ENTERED DATE: 08-28-2006

DISCUSSION/BACKGROUND:

Due to an annexation by the city of Oelwein, the primary route description for Unsigned Iowa 916 has changed.

PROPOSAL/ACTION RECOMMENDATION:

New Description – Unsigned Iowa 916 in Fayette County described as follows:

Oelwein:

Beginning at the Fayette–Buchanan County line at the junction of Iowa 281 near the S ¼ Corner Section 33–T91N–R9W, Fayette County (N ¼ Corner Section 4–T90N–R9W, Buchanan County) (south corporation line of Oelwein) connecting with Frederick Avenue South; thence northwesterly direction on Frederick Avenue South to a point approximately 300 feet south of the center of Section 33–T91N–R9W; thence north on Frederick Avenue South following substantially the center section line of Sections 33 and 28–T91N–R9W to approximately 1310 feet north of the S ¼ Corner of said Section 28.

STAFF ACTION

OFFICE: Transportation Data
STAFF ACTION NUMBER: S-96-1211
SUBMITTED BY: Patrick R. Cain
SUBMITTAL DATE: 4-11-96

DISCUSSION/BACKGROUND:

Due to some work to be done on Unsigned Iowa 916 in Oelwein, the date given of December 1, 1986 for turning Unsigned Iowa 916 back to the city was incorrect. The date should have been August 7, 1990 by Commission Order H-91-49.

PROPOSAL/ACTION RECOMMENDATION:

The date the old section of Unsigned Iowa 916 in Oelwein was deleted from the primary road system should have been August 7, 1990 – not December 1, 1986, and the description of Unsigned Iowa 916 in the primary road system is described in the attachment.

New Description – Unsigned Iowa 916 in Fayette County described as follows:

Beginning on the Fayette–Buchanan County line at the junction of Iowa 281 near the S ¼ Corner Section 33–T91N–R9W, Fayette County (N ¼ Corner Section 4–T90N–R9W, Buchanan County); thence in a northwesterly direction to a point approximately 300 feet south of the center of Section 33–T91N–R9W; thence north following substantially the center section line of Sections 33 and 28–T91N–R9W to the south corporation line of Oelwein, connecting with Frederick Avenue.

STAFF ACTION

OFFICE: Transportation Data

STAFF ACTION NUMBER: S-95-327

SUBMITTED BY: Patrick R. Cain

SUBMITTAL DATE: 8-22-94

DISCUSSION/ BACKGROUND:

Due to the relocation of Iowa 3/150 in Oelwein, a portion of the former route of Iowa 3/150 was re-designated as Unsigned Iowa 916 and turned back to the city of Oelwein by the construction agreement on December 1, 1986. It should therefore be removed from the Primary Road System.

Unsigned Iowa 916 begins at the south corporation line of Oelwein and extends northerly to the junction of Unsigned Iowa 915.

PROPOSAL/ACTION RECOMMENDATION:

It is recommended that Unsigned Iowa 916 in Oelwein as described in the attachment, be deleted from the Primary Road System.

Locate Unsigned Iowa 916 in Oelwein as follows:

Beginning at south corporation line on Frederick Avenue; thence north on Frederick Avenue to junction of Charles Street and Unsigned Iowa 915.

STAFF ACTION

OFFICE: Transportation Inventory

STAFF ACTION NUMBER: S-93-642

SUBMITTED BY: Patrick R. Cain

SUBMITTAL DATE: 11-6-92

DISCUSSION/BACKGROUND:

Due to the relocation of Iowa 150 in Fayette County, a portion of the former route of Iowa 150 has been re-designated as Unsigned Iowa 916 and should be officially included in the primary road system.

Unsigned Iowa 916 begins at the junction with Iowa 281 approximately one mile south of Oelwein and extends northerly to the south corporate limits of Oelwein.

PROPOSAL/ACTION RECOMMENDATION:

It is recommended to approve the inclusion of the attached description of Unsigned Iowa 916 in Fayette County in the primary road system.

New Description – Unsigned Iowa 916 in Fayette County described as follows:

Beginning on the Fayette–Buchanan County Line at the junction of Iowa 281 near the S $\frac{1}{4}$ Corner Section 33–T91N–R9W, Fayette County (N $\frac{1}{4}$ Corner Section 4–T90N–R9W, Buchanan County); thence in a northwesterly direction to a point approximately 300 feet south of the center of Section 33–T91N–R9W; thence north following substantially the center section line of Sections 33 and 28–T91N–R9W to the south corporation line of Oelwein, connecting with Frederick Avenue.