

OFFICIAL DESCRIPTION CHANGE

OFFICE: Transportation Data

EFFECTIVE DATE: 07-01-2003

ENTERED BY: Stefani Wonders

ENTERED DATE: 08-24-2006

DISCUSSION/BACKGROUND:

Senate File 451 transferred Unsigned Iowa 920 in its entirety, in Linn County, to city and county jurisdiction on July 1, 2003.

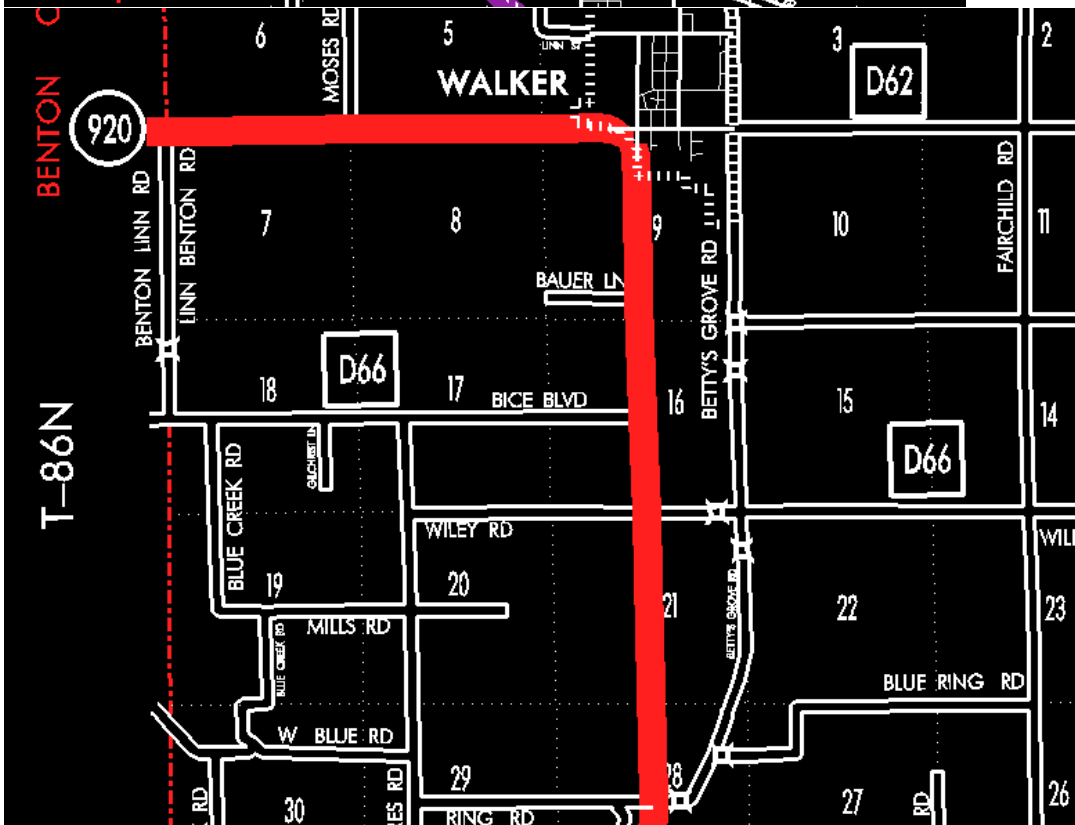
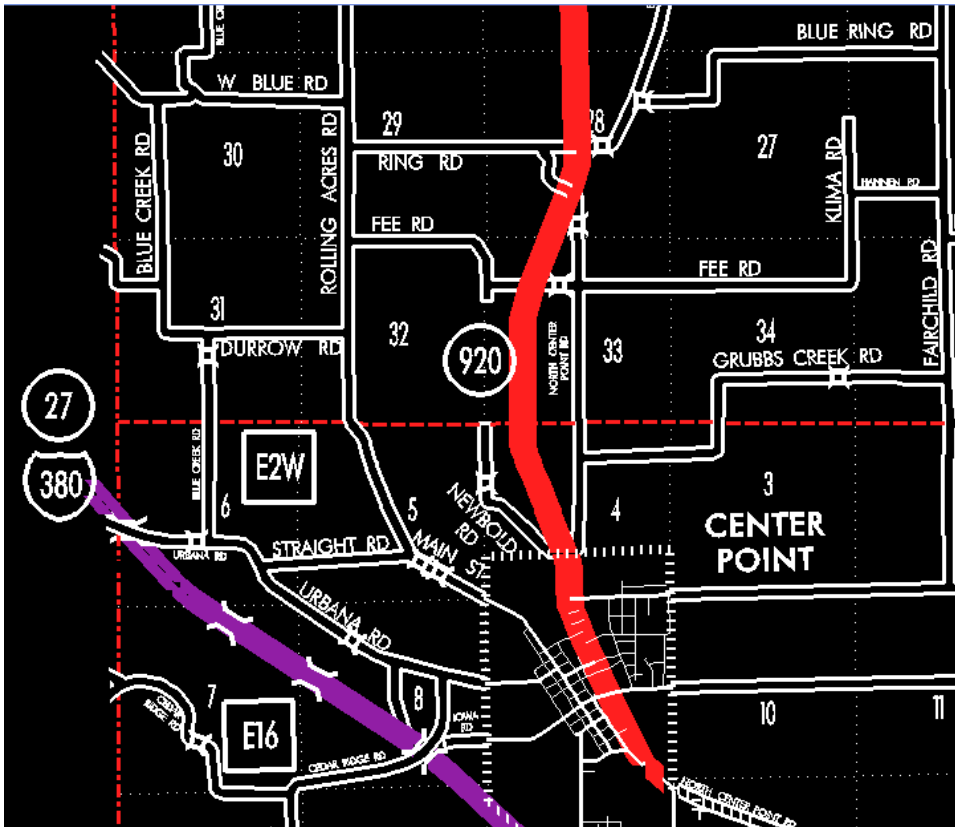

STAFF ACTION

OFFICE: Transportation Inventory

STAFF ACTION NUMBER: S-85-411

SUBMITTED BY: Patrick R. Cain

SUBMITTAL DATE: 10-18-84

DISCUSSION/BACKGROUND:

Interstate 380 was opened to traffic to an interchange with Iowa 101 north of Urbana August 14, 1984. In conjunction with this opening Iowa 101 in Benton County was re-designated as Iowa 150. The portion of old 150 in Linn County from the south corporation line of Center Point north and west to the Linn-Benton County line should be re-designed as unsigned Iowa 920 and its description should be added to the Primary Road System to reflect this re-designation.

Unsigned Iowa 920 begins at the south corporation line of the City of Center Point and travels northerly and westerly via the Cities of Center Point and Walker to the Linn-Benton County line approximately 2 ¼ miles west of the City of Walker.

PROPOSAL/ACTION RECOMMENDATION:

It is recommended to approve adding the description of unsigned Iowa 920 in Linn County to the Primary Road System.

New description – Unsigned Iowa 920 and its extensions in Linn County described as follows:

Center Point:

Beginning on Franklin Street at the south corporation line; thence northwesterly and northerly on Franklin Street to the north corporation line.

Beginning again on the north corporation line of the City of Center Point connecting with Franklin Street; thence in a northerly direction through Section 4-T85N-R8W and Sections 33 and 28-T86N-R8W to a point approximately 800 feet south of the center of Section 28-T86N-R8W; thence north following substantially the center section line through Sections 28, 21, 16 and 9-T86N-R8W to the south corporation line of the City of Walker connecting with Mill Street.

Walker:

Beginning again on Mill Street at the south corporation line; thence northerly to an unnamed street; thence curving northwesterly on an unnamed street to Grant Street; thence westerly on Grant Street to the west corporation line.

Beginning again on the west corporation line of the City of Walker connecting with Grant Street; thence west following substantially the section line of Sections 9, 8 and 7-T86N-R8W to the Linn-Benton County line at a point near the SW Corner of Section 6-T86N-R8W, Linn County (SE Corner of Section 1-T86N-R9W, Benton County).