

OFFICIAL DESCRIPTION CHANGE

OFFICE: Transportation Data

EFFECTIVE DATE: 07-01-2003

ENTERED BY: Stefani Wonders

ENTERED DATE: 08-28-2006

DISCUSSION/BACKGROUND:

Senate File 451 transferred Unsigned Iowa 928 in its entirety, in Hamilton County, to city and county jurisdiction on July 1, 2003.

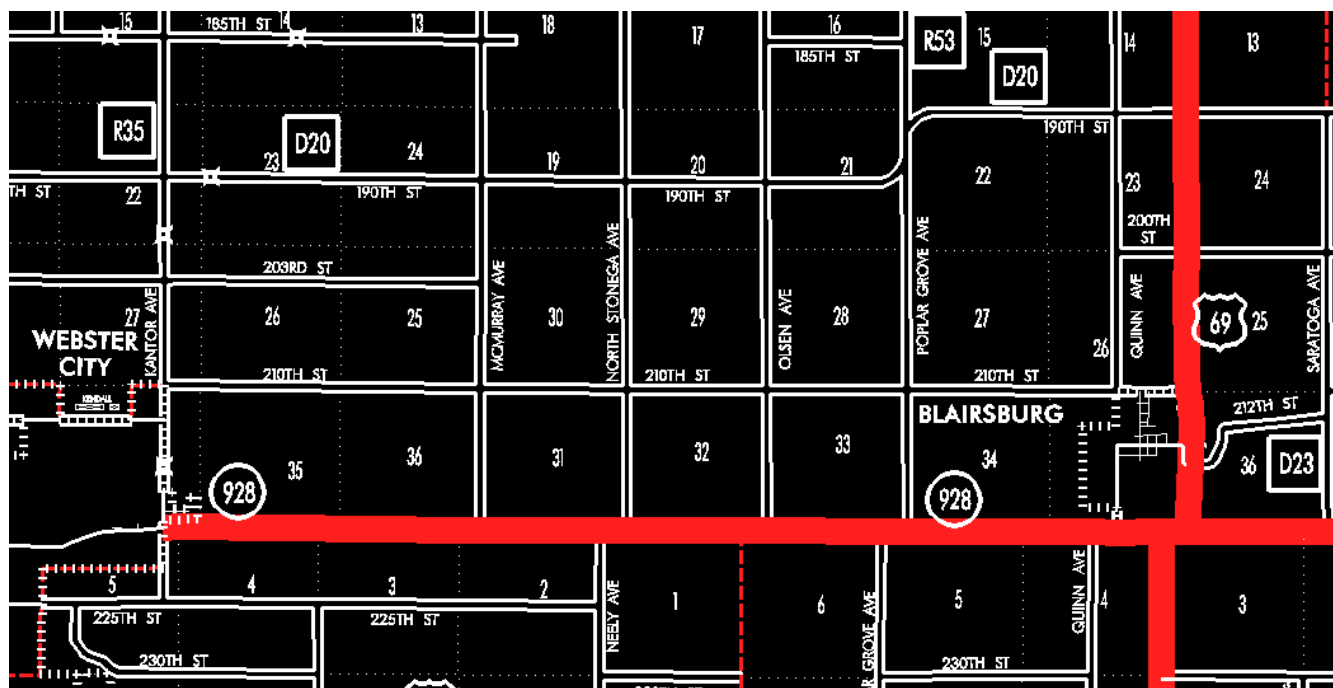



STAFF ACTION

OFFICE: Transportation Data

STAFF ACTION NUMBER: S-96-1250

SUBMITTED BY: Patrick R. Cain

SUBMITTAL DATE: 11-17-95

DISCUSSION/BACKGROUND:

Due to the relocation of US 20 in Hamilton County, a portion of the former route of US 20 was re-designated as Unsigned Iowa 928 on approximately July 1987.

Unsigned, Iowa 928 begins at Hamilton-Webster County; thence east to the junction of US 20.

PROPOSAL/ACTION RECOMMENDATION:

It is recommended to approve the re-designation of the section of road described above as Unsigned Iowa 928 in Webster County.

New Description – Unsigned Iowa 928 and its extension in Hamilton County described as follows:

Beginning at the Hamilton–Webster County line on the north side of the Illinois Central Railroad at a point approximately 100 feet north of the SW Corner of Section 31–T89N–R26W, Hamilton County (SE Corner of Section 36–T89N–R27W, Webster County); thence easterly along the north side of said railroad and substantially parallel thereto through the south part of Sections 31, 32, 33, (west junction Iowa 17).

Beginning again at a point approximately 150 feet north and 2,100 feet east of the SW Corner Section 34–T89N–R26W (east junction Iowa 17); thence east through the south part of Sections 34, 35 and 36–T89N–R26W to the west corporation line of Webster City connecting with James Street.

Beginning again on the east corporation line of Webster City connecting with 2nd Street; thence east following substantially the section line of Sections 4, 3, 2, and 1–T88N–R25W; thence through Sections 6, 5, 4, 3, (junction US 69) 2, and 1–T88N–R24W; and 1– T89N–R24W, and Sections 6 (Interstate 35 Interchange) and 5–T88N–R23W, to a point approximately 1,000 feet west of the N $\frac{1}{4}$ Corner of Section 5–T88N–R23W; thence curving northeasterly through Section 34–T89N–R23W to a point approximately 1,000 feet north of the S $\frac{1}{4}$ Corner Section 34–T89N–R23W; thence north following substantially the center section line of Section 34–T89N–R23W to the south corporation line of Williams, connecting with an unnamed street.

Williams:

Beginning on an unnamed street at the south corporation line; thence north on unnamed street to the north corporation line.

Beginning again on the north corporation line of Williams connecting with an unnamed street; thence north following substantially the center section line of Sections 27 and 22-T89N-R23W to a point approximately 1,000 feet south of the N $\frac{1}{4}$ Corner of Section 22-T89N-R23W; thence curving in a northeasterly direction to a point approximately 700 feet east of the N $\frac{1}{4}$ Corner of Section 22-T89N-R23W (junction US 20).

OFFICIAL DESCRIPTION CHANGE

COUNTY: Hamilton

ROUTE: Iowa 928

STAFF ACTION NUMBER: S-87-719

APPROVAL DATE: 12-18-86

New Description – Unsigned Iowa 928 and its extension in Hamilton County described as follows:

Beginning at a point approximately 150 feet north and 2,100 feet east of the SW Corner Section 34-T89N-R26W (junction US 20 and Iowa 17); thence east through the south part of Sections 34, 35 and 36-T89N-R26W to the west corporation line of Webster City connecting with James Street.

Beginning again on the east corporation line of Webster City connecting with 2nd Street; thence east following substantially the section line of Sections 4, 3, 2, and 1-T88N-R25W; thence through Sections 6, 5, 4, 3, (junction US 69) 2, and 1-T88N-R24W; and 1-T89N-R24W, and Sections 6 (Interstate 35 Interchange) and 5-T88N-R23W, to a point approximately 1,000 feet west of the N $\frac{1}{4}$ Corner of Section 5-T88N-R23W; thence curving northeasterly through Section 34-T89N-R23W to a point approximately 1,000 feet north of the S $\frac{1}{4}$ Corner Section 34-T89N-R23W; thence north following substantially the center section line of Section 34-T89N-R23W to the south corporation line of Williams, connecting with an unnamed street.

Williams:

Beginning on an unnamed street at the south corporation line; thence north on unnamed street to the north corporation line.

Beginning again on the north corporation line of Williams connecting with an unnamed street; thence north following substantially the center section line of Sections 27 and 22-T89N-R23W to a point approximately 1,000 feet south of the N ¼ Corner of Section 22-T89N-R23W; thence curving in a northeasterly direction to a point approximately 700 feet east of the N ¼ Corner of Section 22-T89N-R23W (junction US 20).

COMMISSION ORDER

DIVISION: Planning & Research

COMMISSION ORDER NUMBER: PR-81-759

SUBMITTED BY: Patrick R. Cain

MEETING DATE: 5-12-81

DISCUSSION/BACKGROUND:

Due to the relocation of US 20 in Hamilton County, Unsigned Iowa 928 has been created and its description should be officially included in the primary road system.

Unsigned Iowa 928 begins at a junction with US 20 and Iowa 17 approximately three miles west of the City of Webster City and proceeds easterly to the west corporation line of the City of Webster City; beginning again on the east corporation line of the City of Webster City traveling easterly and northerly via the City of Williams to a junction with US 20 approximately one mile north of the City of Williams.

PROPOSAL/ACTION RECOMMENDATION:

It is recommended the commission approve including the attached description of Unsigned Iowa 928 in Hamilton County in the primary road system.

Locate Unsigned Iowa 928 and its extension in Hamilton County as follows:

Beginning at a point approximately 150 feet north and 2100 feet east of the SW Corner Section 34-T89N-R26W (junction US 20 and Iowa 17); thence easterly through the south part of Sections 34, 35 and 36-T89N-R26W to the west corporation line of the City of Webster City connecting with an unnamed street.

Beginning again on the east corporation line of the City of Webster City connecting with an unnamed street; thence easterly following substantially the section line of Sections 4, 3, 2 and 1-T88N-R25W; thence through Sections 6, 5, 4, 3 (junction US 69), 2 and 1-T89N-R24W, and Sections 6 (Interstate 35 Interchange) and 5-T88N-R23W to a point approximately 1,000 feet west of the N $\frac{1}{4}$ Corner of Section 5-T88N-R23W; thence curving northeasterly through Section 34-T89N-R23W to a point approximately 1,000 feet north of the S $\frac{1}{4}$ Corner Section 34-T89N R23W; thence north following substantially the center section line of Section 34-T89N-R23W to the south corporation line of the City of Williams, connecting with an unnamed street.

Williams:

Beginning at the south corporation line connecting with an unnamed street; thence north to the north corporation line connecting with an unnamed street.

Beginning again on the north corporation line of the City of Williams connecting with an unnamed street; thence northerly following substantially the center section line of Sections 27 and 22-T89N-R23W to a point approximately 1000 feet south of the N $\frac{1}{4}$ Corner of Section 22-T89N-R23W; thence curving in a northeasterly direction to a point approximately 700 feet east of the N $\frac{1}{4}$ Corner of Section 22-T89N-R23W (junction US 20).

REVISED: 12-18-86