

OFFICIAL DESCRIPTION CHANGE

OFFICE: Transportation Data

EFFECTIVE DATE: 07-01-2003

ENTERED BY: Stefani Wonders

ENTERED DATE: 08-28-2006

DISCUSSION/BACKGROUND:

Senate File 451 transferred Unsigned Iowa 932 in its entirety, in Delaware County, to county jurisdiction on July 1, 2003.

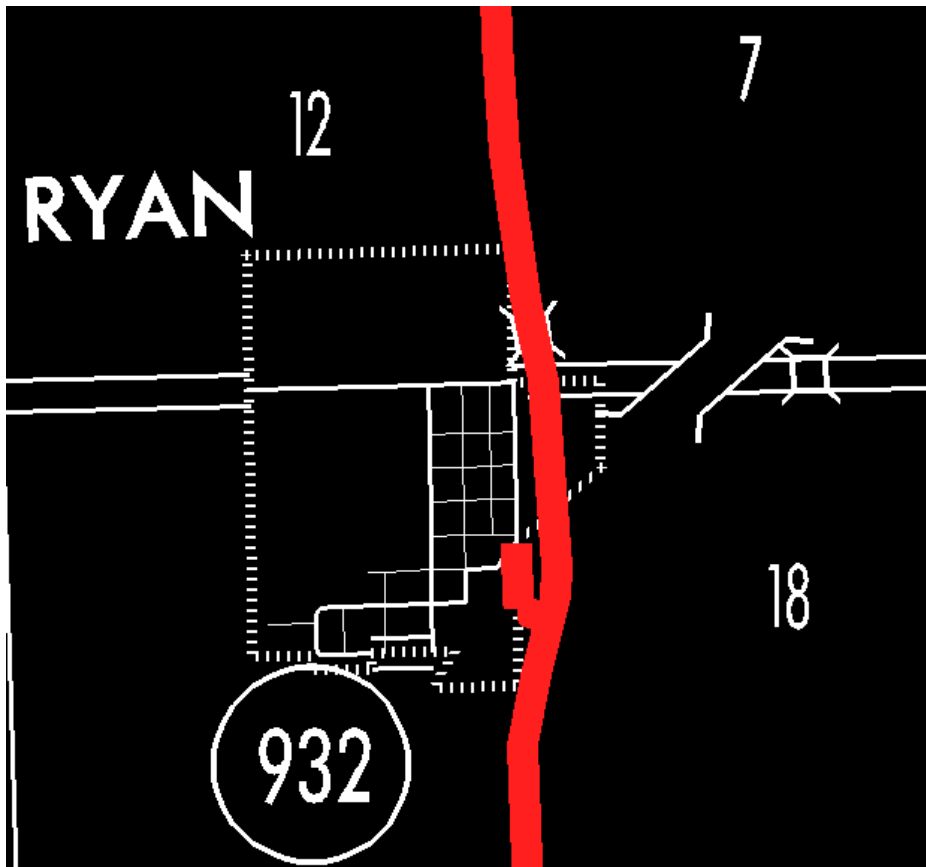

OFFICIAL DESCRIPTION CHANGE

COUNTY: Delaware

ROUTE: Unsigned Iowa 932

STAFF ACTION NUMBER: S-87-705

APPROVAL DATE: 12-18-86

New Description – Unsigned Iowa 932 in Delaware County described as follows:

Beginning at a point approximately 260 feet east and 2,880 feet north of the SW Corner of Section 18-T87N-R5W (junction of Iowa 13); thence in a northwesterly and northerly direction through Section 18-T87N-R5W to the south corporation line of the City of Ryan connecting with Adams Street.

COMMISSION ORDER

DIVISION: Planning & Research

COMMISSION ORDER NUMBER: PR-80-231

SUBMITTED BY: Leland D. Smithson

MEETING DATE: 10-23-79

DISCUSSION/BACKGROUND:

Unsigned Iowa 932 begins at the junction of Iowa 13 approximately 1,000 feet southeast of Ryan, Iowa, and travels northerly into Ryan.

Due to a review of our primary road system records, Unsigned Iowa 932 in Delaware County should be deleted and the new description added should be officially included into the primary system.

PROPOSAL/ACTION RECOMMENDATION:

It is recommended that the old description of Unsigned Iowa 932 in Delaware County be deleted and the new description, as referred to in the attached detailed description, be included in the primary road system.

Locate Unsigned Iowa 932 in Delaware County as follows:

Beginning at a point approximately 260 feet east and 2880 feet north of the SW Corner of Section 18-T87N-R5W (south junction of Iowa 13); thence in a northwesterly and northerly direction through Section 18-T87N-R5W to the south corporation line of the City of Ryan connecting with an unnamed street.

REVISED: 12-18-86

COMMISSION ORDER

DIVISION: Planning & Research

COMMISSION ORDER NUMBER: PR-79-272

SUBMITTED BY: C.I. MacGillivray

MEETING DATE: 11-2-78

DISCUSSION/BACKGROUND:

The new alignment of Iowa 13 in an area near Ryan in Delaware County has created Unsigned Iowa 932 and should be officially included into the Primary Road System.

Unsigned Iowa 932 begins at the junction of Iowa 13 approximately 1000 feet southeast of Ryan, Iowa and travels northerly and easterly via Ryan terminating at another junction of Iowa 13 approximately 300 feet east of Ryan, Iowa.

PROPOSAL/ACTION RECOMMENDATION:

Locate Unsigned Iowa 932 and its extension in Delaware County as follows:

Beginning at a point approximately 260 feet east and 2880 feet north of the SW Corner of Section 18-T87N-R5W (south junction of Iowa 13); thence in a northwesterly and northerly direction through Section 18-T87N-R5W to the south corporation line of the City of Ryan connecting with an unnamed street.

Ryan:

Beginning on the south corporation line connecting with an unnamed street; thence northerly to the north corporation line connecting with an unnamed street.

Beginning again on the north corporation line of the City of Ryan connecting with an unnamed street; thence easterly following substantially the section line of Section 18-T87N-R5W (north junction of Iowa 13) to a point approximately 320 feet east of the NW Corner of Section 18-T87N-R5W.

NOW, THEREFORE: Be it resolved that the Iowa Department of Transportation approve the location of Unsigned Iowa 932 in Delaware County, Iowa.

NOTE: To become effective upon the adoption of this resolution.

REVISED: 10-23-79

COMMISSION ORDER

DIVISION: Planning & Research

COMMISSION ORDER NUMBER: PR-77-278

SUBMITTED BY: Raymond L. Kassel

MEETING DATE: 11-30-76

DISCUSSION/BACKGROUND:

The new alignment of Iowa 13 in an area near Ryan in Delaware County has created Unsigned Iowa 932 and should be officially included into the Primary Road System.

Unsigned Iowa 932 begins at the junction of Iowa 13 approximately 1000 feet southeast of Ryan, Iowa and travels northerly and easterly via Ryan terminating at another junction of Iowa 13 approximately 300 feet east of Ryan, Iowa.

PROPOSAL/ACTION RECOMMENDATION:

Locate Unsigned Iowa 932 and its extension in Delaware County as follows:

Beginning at a point approximately 260 feet east and 2880 feet north of the SW Corner of Section 18-T87N-R5W (south junction of Iowa 13); thence in a northwesterly and northerly direction through Section 18-T87N-R5W to the south corporation line of the City of Ryan connecting with an unnamed street.

Ryan:

Beginning on the south corporation line connecting with an unnamed street; thence northerly to the north corporation line connecting with an unnamed street.

Beginning again on the north corporation line of the City of Ryan connecting with an unnamed street; thence easterly following substantially the section line of Section 18-T87N-R5W (north junction of

Iowa 13) to a point approximately 320 feet east of the NW Corner of Section 18-T87N-R5W.

NOW, THEREFORE: Be it resolved that the Iowa Department of Transportation approve the location of Unsigned Iowa 932 in Delaware County, Iowa.

NOTE: To become effective upon the adoption of this resolution.