

## OFFICIAL DESCRIPTION CHANGE

OFFICE: Transportation Data

EFFECTIVE DATE: 07-01-2003

ENTERED BY: Stefani Wonders

ENTERED DATE: 08-23-2006

## DISCUSSION/BACKGROUND:

Senate File 451 transferred Unsigned Iowa 937 in its entirety, in Dallas County, to county jurisdiction on July 1, 2003.

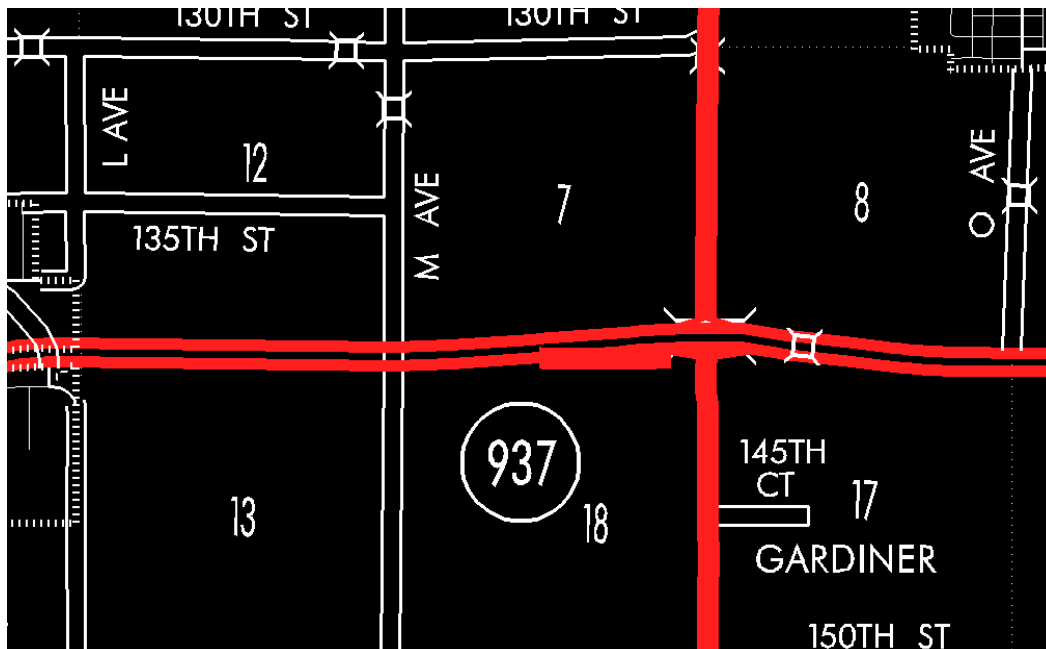

## COMMISSION ORDER

DIVISION: Planning & Research

COMMISSION ORDER NUMBER: PR-79-272

SUBMITTED BY: C.I. MacGillivray

MEETING DATE: 11-2-78

## DISCUSSION/BACKGROUND:

The new alignment of Iowa 141 east of Perry in Dallas County has created Unsigned Iowa 937, which should be officially included into the Primary Road System.

Unsigned Iowa 937 begins at a junction with Iowa 141 approximately 2 miles east of the east corporation line of Perry, and travels easterly approximately ½ mile.

**PROPOSAL/ACTION RECOMMENDATION:**

It is recommended that the description of Unsigned Iowa 937 in Dallas County, as referred in the attached detailed description, be included in the Primary Road System effective upon the adoption of the resolution.

Locate Unsigned Iowa 937 in Dallas County as follows:

Beginning at a point approximately 200 feet north and 225 feet west of the S ¼ Corner Section 7–T81N–R27W, Dallas County (junction Iowa 141); thence in a southeasterly direction through said Section 7 to a point approximately 150 feet west of the N ¼ Corner Section 18–T81N–R27W; thence in an easterly direction following substantially the section line said Section 18 approximately 2300 feet.