

OFFICIAL DESCRIPTION CHANGE

OFFICE: Transportation Data

EFFECTIVE DATE: 07-01-2003

ENTERED BY: Stefani Wonders

ENTERED DATE: 08-22-2006

DISCUSSION/BACKGROUND:

Senate File 451 transferred Unsigned Iowa 942 in its entirety, in the City of Woodburn, to city jurisdiction on July 1, 2003.

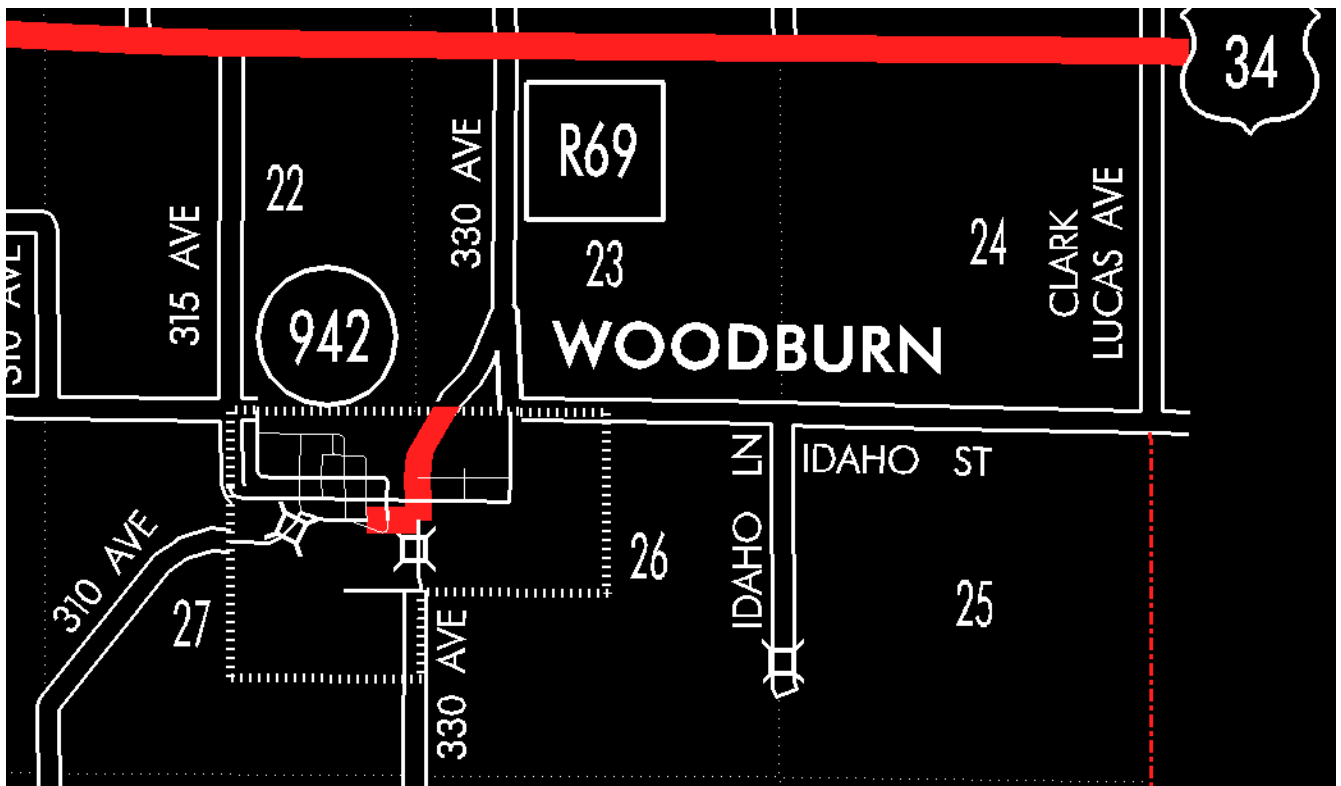

OFFICIAL DESCRIPTION CHANGE

COUNTY: Clarke

ROUTE: Unsigned Iowa 942

STAFF ACTION NUMBER: S-87-696

APPROVAL DATE: 12-18-86

New Description – Unsigned Iowa 942 and its extension in Clarke County described as follows:

Woodburn:

Beginning on Sigler Street at Vine Street; thence easterly on Sigler Street to Mill Street; thence northerly and northeasterly on Mill Street to the north corporation line.

COMMISSION ORDER

DIVISION: Planning & Research

COMMISSION ORDER NUMBER: PR-82-443

SUBMITTED BY: Patrick R. Cain

MEETING DATE: 1-5-82

DISCUSSION/BACKGROUND:

Transfer of jurisdiction agreement number TJ-104-0 (2), between the Iowa Department of Transportation and Clarke County, transferred the portion of Iowa 104 from the north corporation line of the City of Woodburn north to a junction with US 34 to county jurisdiction on October 27, 1980. The remaining portion of Iowa 104 in the City of Woodburn should be re-designated as Unsigned Iowa 942 and its description officially included in the primary road system.

Unsigned Iowa 942 begins at Vine Street in the City of Woodburn, and travels easterly, northerly and northeasterly to the north corporation line.

PROPOSAL/ACTION RECOMMENDATION:

It is recommended the commission approve including the attached description of Unsigned Iowa 942 in Clarke County in the primary road system.

Locate Unsigned Iowa 942 in Clarke County as follows:

Woodburn:

Beginning on an unnamed street at Vine Street; thence easterly and northerly to the north corporation line connecting with an unnamed street.

REVISED: 12-18-86