

OFFICIAL DESCRIPTION CHANGE

OFFICE: Transportation Data

EFFECTIVE DATE: 07-01-2003

ENTERED BY: Stefani Wonders

ENTERED DATE: 08-28-2006

DISCUSSION/BACKGROUND:

Senate File 451 transferred Unsigned Iowa 952 in its entirety, in Dubuque County, to county jurisdiction on July 1, 2003.

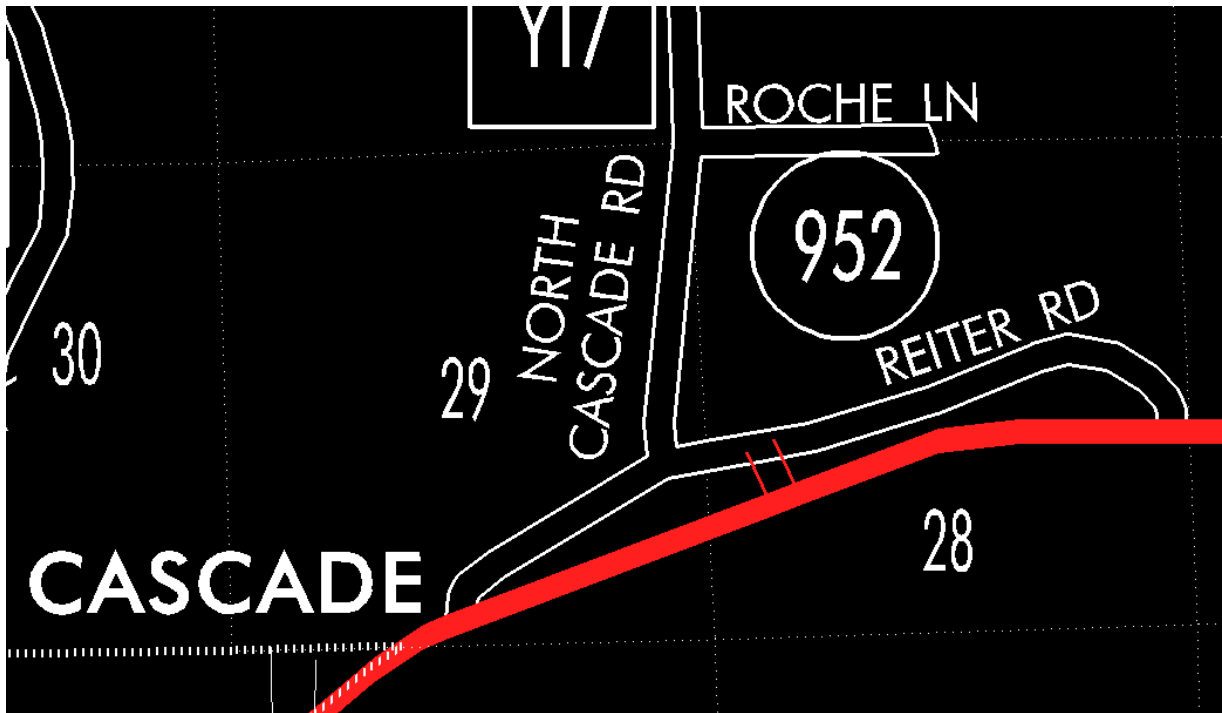

STAFF ACTION

OFFICE: Transportation Data

STAFF ACTION NUMBER: S-96-1243

SUBMITTED BY: Patrick R. Cain

SUBMITTAL DATE: 2-26-96

DISCUSSION/BACKGROUND:

Due to the relocation of US 151 in Dubuque County in 1973, a connecting road was built between the old US 151 and the new US 151. This became Unsigned Iowa 952 and was added to the Primary Road System in August 1992.

PROPOSAL/ACTION RECOMMENDATION:

It is recommended that Unsigned Iowa 952 in Dubuque County, as described in the attachment, be included in the Primary Road System.

Locate Unsigned Iowa 952 in Dubuque County as follows:

Beginning near center SW $\frac{1}{4}$ Section 28-T87N-R1W; thence northwesterly approximately 800 feet in Section 28-T87N-R1W.