

## OFFICIAL DESCRIPTION CHANGE

OFFICE: Transportation Data

EFFECTIVE DATE: 07-01-2003

ENTERED BY: Stefani Wonders

ENTERED DATE: 08-24-2006

## DISCUSSION/BACKGROUND:

Senate File 451 transferred Unsigned Iowa 985 in its entirety, in Jackson County, to county jurisdiction on July 1, 2003.

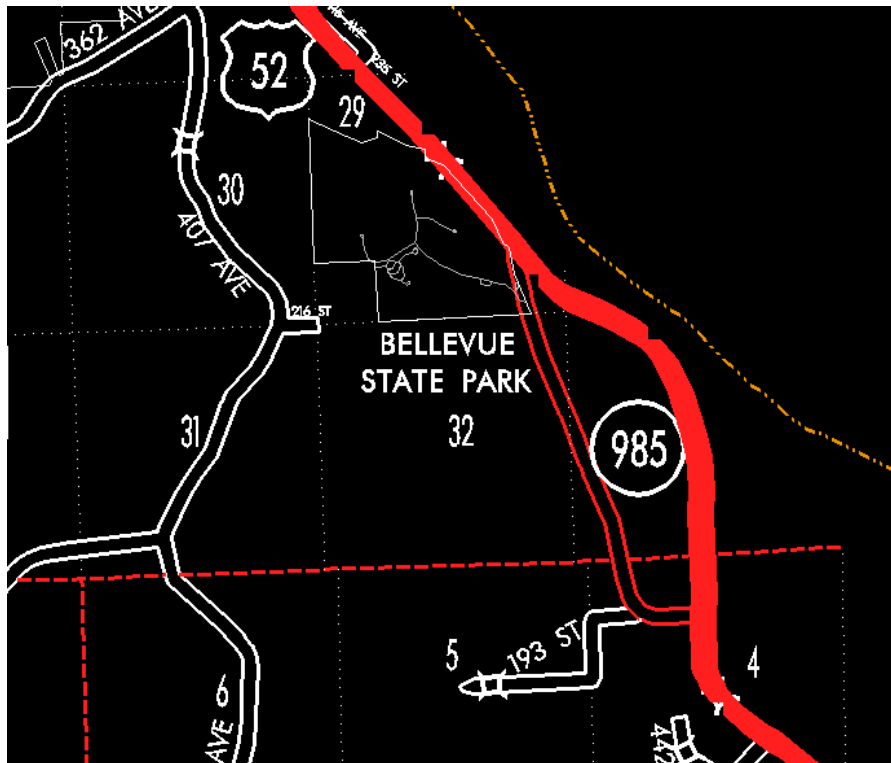

## COMMISSION ORDER

DIVISION: Planning & Research

COMMISSION ORDER NUMBER: PR-81-632

SUBMITTED BY: Patrick R. Cain

**MEETING DATE:** 4-14-81

**DISCUSSION/BACKGROUND:**

Transfer of jurisdiction agreement number TJ-000-0 (2) --2M-49, between Jackson County and the Iowa Department of Transportation, transferred the section of road from a point approximately 2,550 feet east and 1,150 feet south of the NW Corner Section 4-T85N-R5E westerly and northerly to a point approximately 1,100 feet north and 650 feet west of the SE Corner Section 29-T86N-R5E to state jurisdiction on October 1, 1980. The section is now designated as Unsigned Iowa 985.

Unsigned Iowa 985 begins at a junction with US 52 approximately four miles southeast of the City of Bellevue and proceeds westerly and northerly to another junction with US 52 approximately two miles southeast of the City of Bellevue.

**PROPOSAL/ACTION RECOMMENDATION:**

It is recommended the commission approve including the attached description of Unsigned Iowa 985 in Jackson County in the primary road system.

Locate Unsigned Iowa 985 in Jackson County as follows:

Beginning at a point approximately 1,150 feet south and 2,250 feet east of the NW Corner Section 4-T85N-R5E (south junction US 52); thence westerly through said Section 4 to a point approximately 1,100 feet south and 500 feet east of the NW Corner Section 4-T85N-R5E; thence in a northerly and northwesterly direction through Section 4-T85N-R5E and 33, 32 and 29-T86N-R5E to a point approximately 1,100 feet north and 650 feet west of the SE Corner Section 29-T86N-R5E (north junction US 52).