

OFFICIAL DESCRIPTION CHANGE

OFFICE: Research and Analytics

EFFECTIVE DATE: 10-18-2016

COUNTY: Polk

ROUTE: US 6

ENTERED BY: Paul Mauer

ENTERED DATE: 12-19-2019

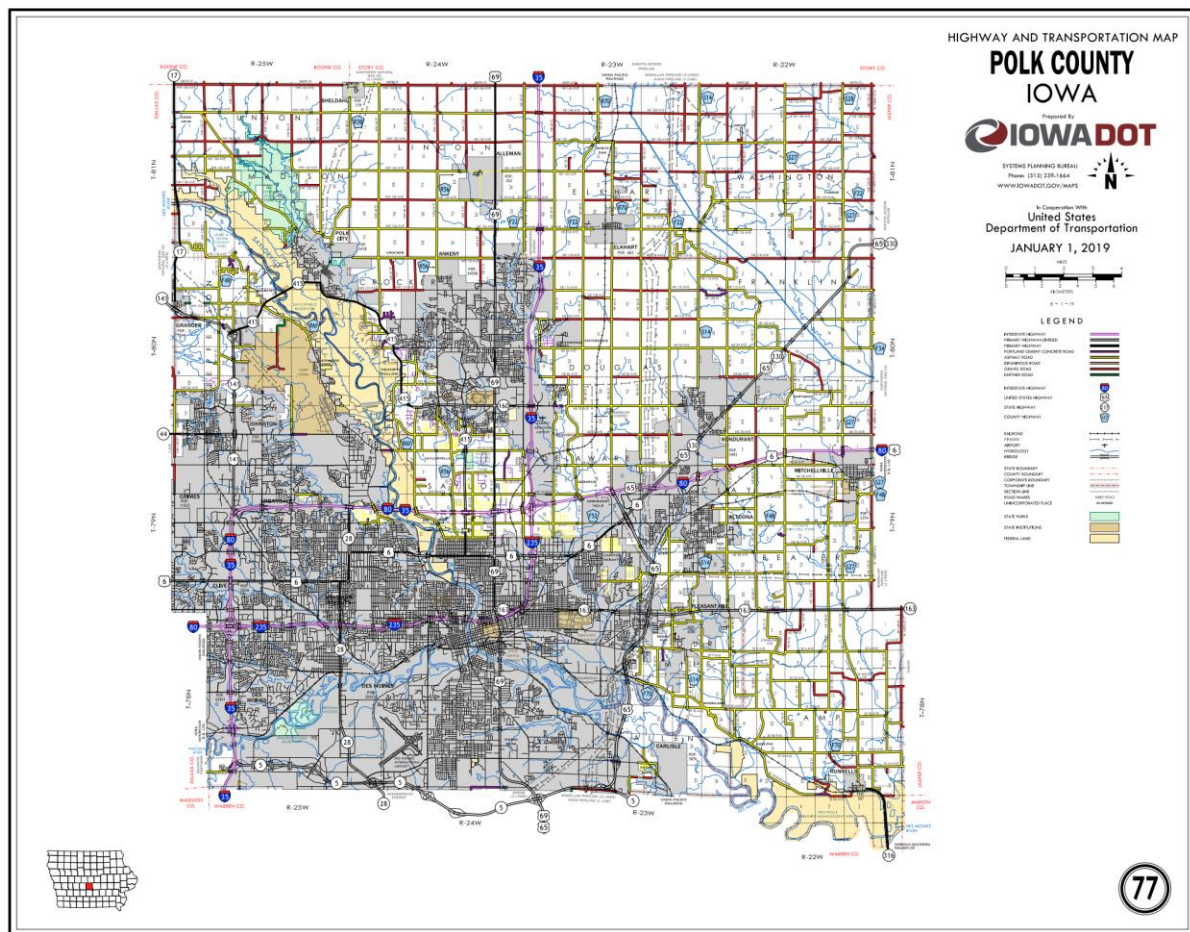

New Description – US 6 and its extensions in Polk County described as follows:

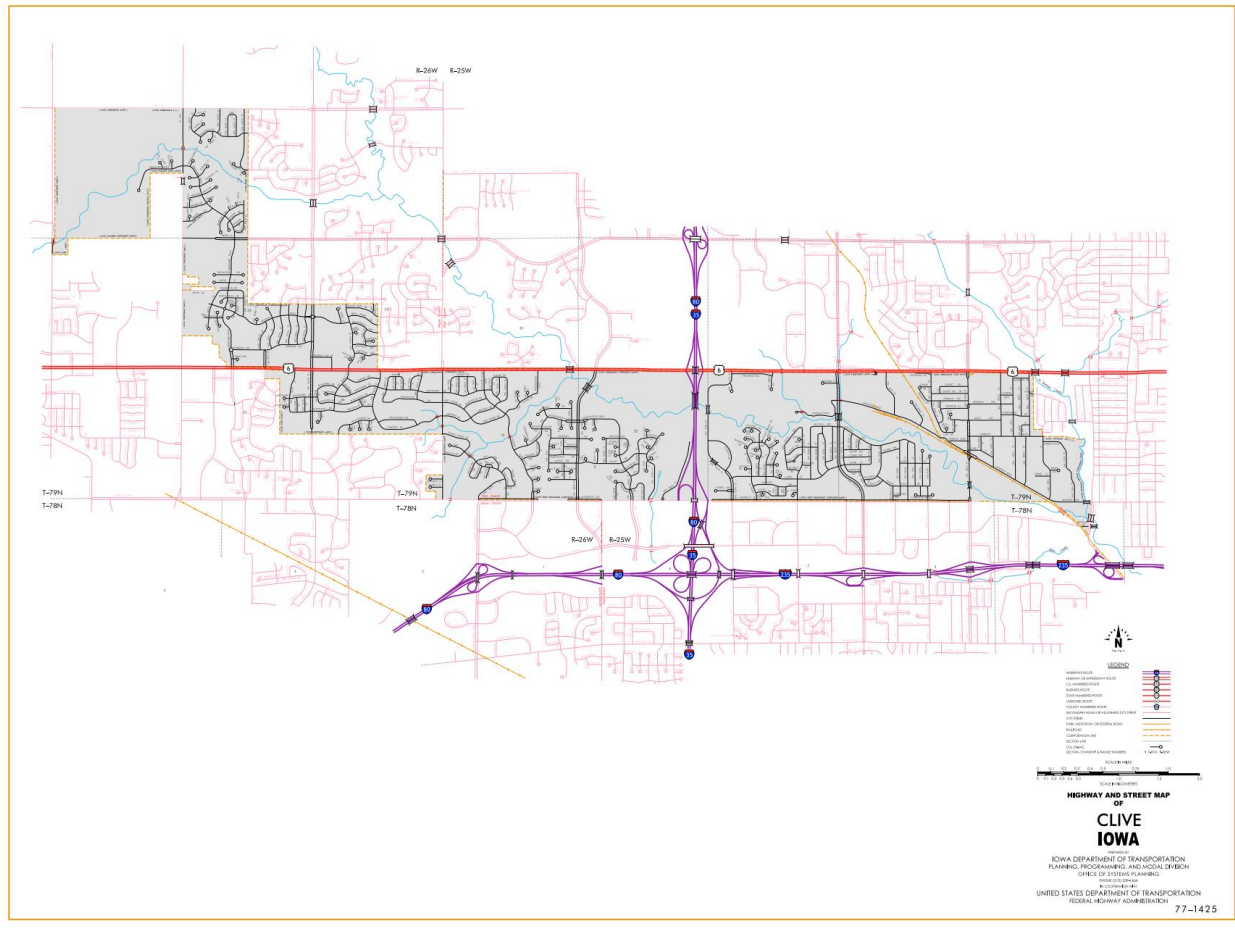

Clive:

Beginning on Hickman Road on the Polk–Dallas County line at a point near the NW Corner Section 31–T79N–R25W, Polk County (NE Corner Section 36–T79N–R26W, Dallas County); thence east following substantially the section line of Sections 31, 32 (center of interchange with Interstate 35 and 80), and 33–T79N–R25W; thence east on Hickman Road through the north section line of Sections 35 and 36–T79N–R25W to the west corporation line of Des Moines.

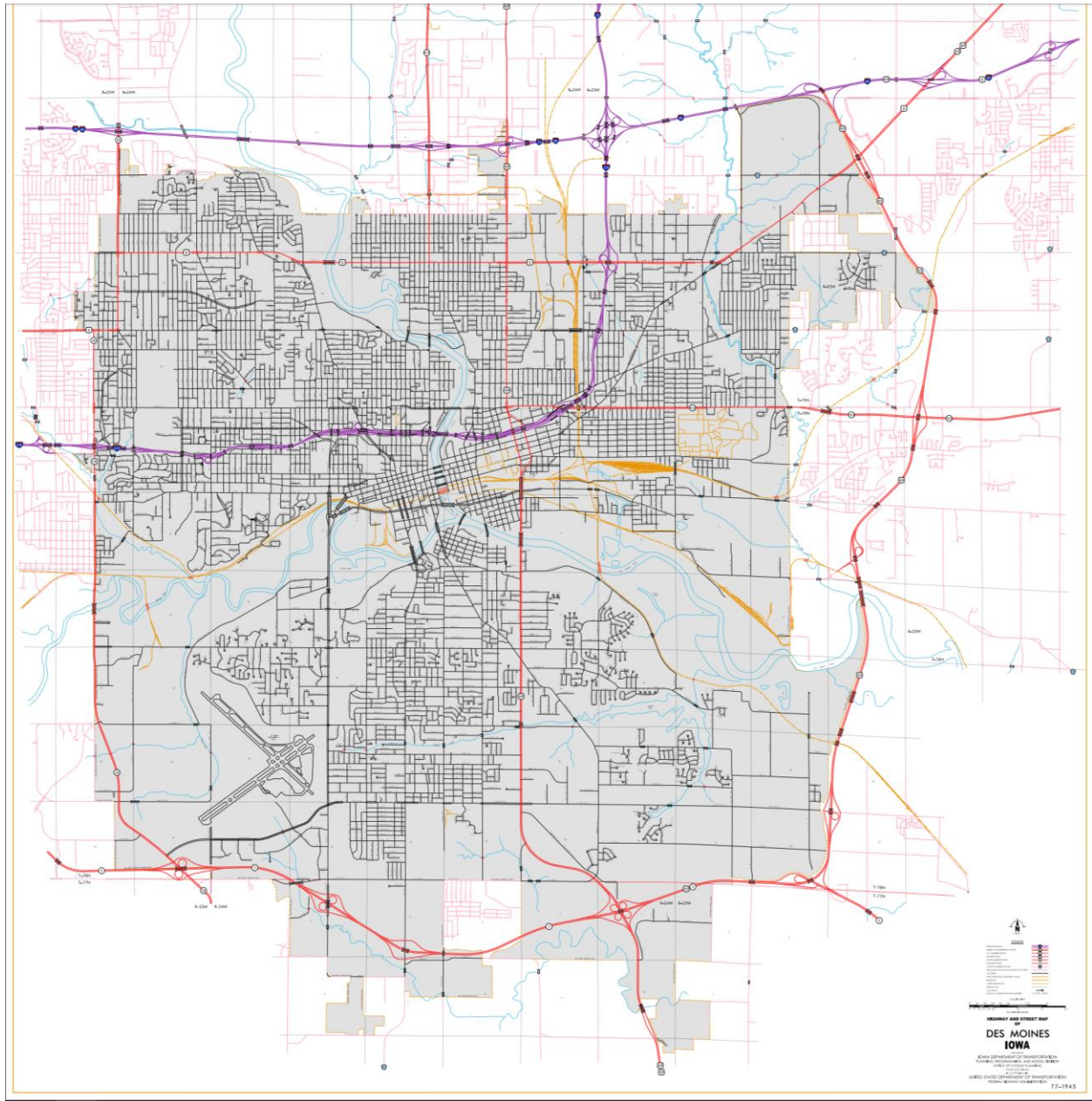

Des Moines:

Beginning on Hickman Road at the west corporation line; thence east on Hickman Road to Merle Hay Road; thence north on Merle Hay Road to Douglas Avenue; thence east and southeast on Douglas Avenue to Euclid Avenue; thence east on Euclid Avenue (junction Iowa 415) to East Euclid Avenue; thence east on East Euclid Avenue (junction US 69) and through the center of interchange

Interstate 235 to Frederick M Hubbell Avenue; thence northeast on Frederick M Hubbell Avenue to the east corporation line.

Beginning again on the east corporation line of Des Moines connecting with Frederick M Hubbell Avenue; thence northeast through Section 15-T79N-R23W (west junction US 65) to the west corporation line of Altoona connecting with Frederick M Hubbell Avenue.

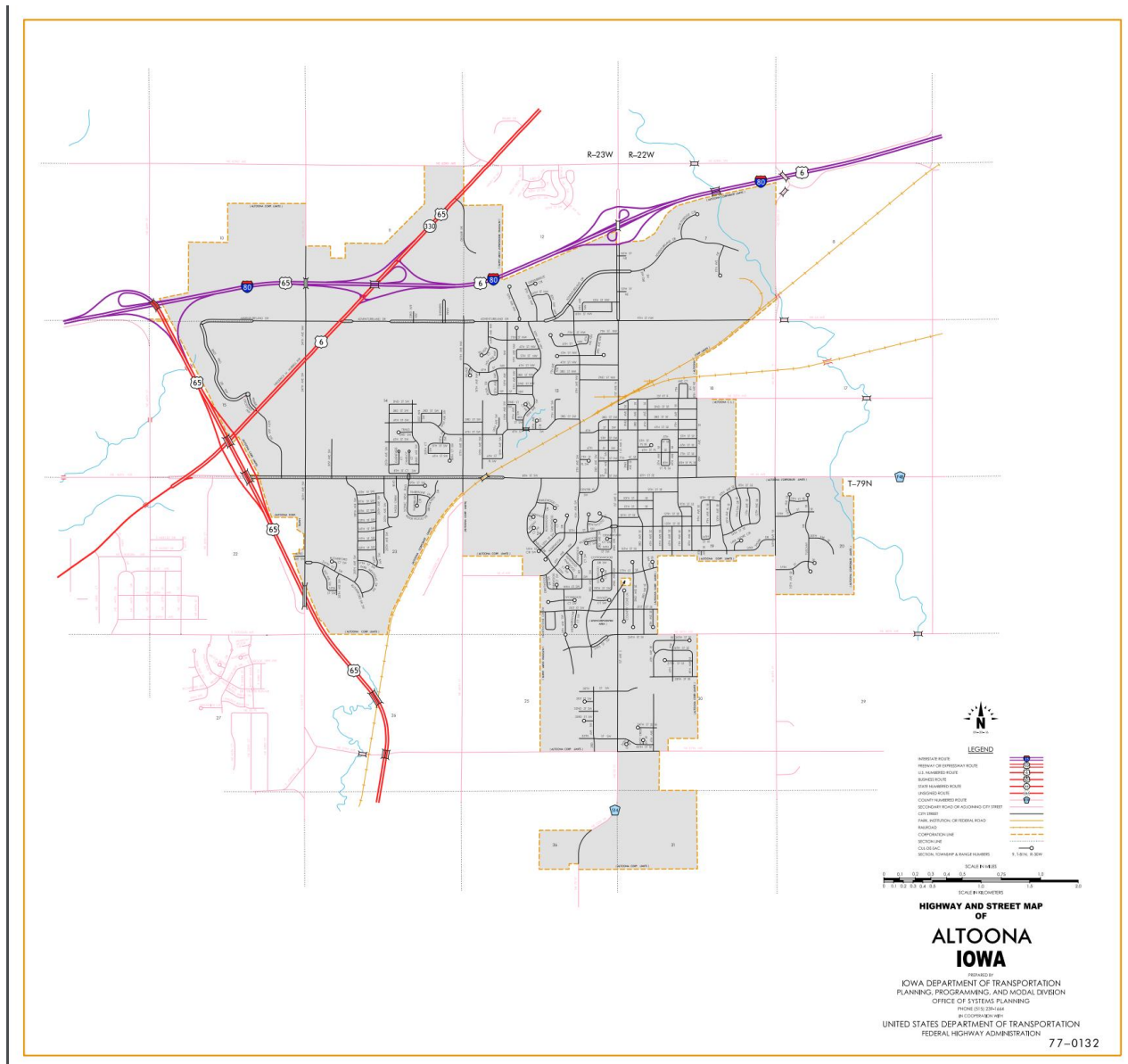

Altoona:

Beginning at the west corporation line of Altoona on Frederick M Hubbell Avenue; thence northeast to the east junction of Interstate 80, US 65 and Iowa 330 connecting with Interstate 80; thence east and northeast to the north corporation line.

Beginning again on the north corporation line of Altoona; thence northeast through Section 12-T79N-R23W and Sections 7, 8, 5 and 4-T79N-R22W to a point approximately 110 meters (360 feet) south of the E $\frac{1}{4}$ Corner of Section 4-T79N-R22W; thence curving easterly and following substantially the center section line through Sections 3, 2 and 1-T79N-R22W to the Polk-Jasper County line at a point approximately 41 meters (136 feet) north of the E $\frac{1}{4}$ Corner Section 1-T79N-R22W, Polk County (W $\frac{1}{4}$ Corner Section 6-T79N-R21W, Jasper County).

STAFF ACTION

OFFICE: Transportation Inventory

SUBMITTED BY: Patrick R. Cain

SUBMITTAL DATE: 04-10-97

TITLE: Official Description Change: US 6 in Polk County

DISCUSSION/BACKGROUND:

As per transfer of jurisdiction agreement number 96-TJ-007 between the Iowa Department of Transportation, the City of Altoona and Polk County, the State agrees to take back the diagonal section of the old location of US 6 and US 65 from the relocated US 65 interchange northeast to the interchange with Interstate 80 and US 65. This section will again be by US 6.

Effective date was August 19, 1996.

PROPOSAL/ACTION RECOMMENDATION:

It is recommended the old description of US 6 in Polk County be deleted from the Primary Road System and the new description, as described in the attachment, be included in the Primary Road System.

New Description – US 6 and its extensions in Polk County described as follows:

Beginning on the Polk–Dallas County line at a point near the NW Corner Section 31–T79N–R25W, Polk County (NE Corner Section 36–T79N–R26W, Dallas County); thence east following substantially the section line of Sections 31, 32 (center of interchange with Interstate 35 and 80), and 33–T79N–R25W to the west corporation line of Clive, connecting with Hickman Road.

Clive:

Beginning on the west corporation line of Clive connecting with Hickman Road; thence east on Hickman Road to the east corporation line.

Beginning again on the east corporation line of Clive connecting with Hickman Road; thence east through the north part of Sections 35 and 36–T79N–R25W to the west corporation line of Des Moines, connecting with Hickman Road.

Des Moines:

Beginning on Hickman Road at the west corporation line; thence east on Hickman Road to Merle Hay Road; thence north on Merle Hay Road to Douglas Avenue; thence east on Douglas Avenue to Lower Beaver Road; thence southeast on Lower Beaver Avenue Road to 30th Street and Euclid Avenue; thence east on Euclid Avenue to Frederick M Hubbell Avenue; thence northeast on Frederick M Hubbell Avenue to the east corporation line.

Beginning again on the east corporation line of Des Moines connecting with Frederick M Hubbell Avenue; thence northeast through Sections 21, 22 and 15-T79N-R23W to the west corporation line of Altoona, connecting with an unnamed street.

Altoona:

Beginning again at the west corporation line of Altoona on unnamed street; thence northeast to the north corporation line connecting with an unnamed street.

Beginning again on the north corporation line of Altoona connecting with an unnamed street; thence northeast through Section 11-T79N-R23W to a point in the south $\frac{1}{2}$ of said Section 11 (east junction Interstate 80 and US 65); thence easterly through Section 11-T79N-R23W to a point approximately 360 meters (1,182 feet) north of the SE Corner of said Section 11; thence northeast through Section 12-T79N-R23W and Sections 7, 8, 5 and 4-T79N-R22W to a point approximately 110 meters (360 feet) south of the E $\frac{1}{4}$ Corner of Section 4-T79N-R22W; thence curving easterly and following substantially the center section line through Sections 3, 2 and 1-T79N-R22W to the Polk-Jasper County line at a point approximately 41 meters (136 feet) north of the E $\frac{1}{4}$ Corner Section 1-T79N-R22W, Polk County (W $\frac{1}{4}$ Corner Section 6-T79N-R21W, Jasper County).

STAFF ACTION

OFFICE: Transportation Data

STAFF ACTION NUMBER:

SUBMITTED BY: Patrick R. Cain

SUBMITTAL DATE: 07-23-96

TITLE: Official Description Change: US 6 in Polk County

DISCUSSION/BACKGROUND:

Due to the relocation of US 6 in Polk County in 1994, the office description in the Primary Road System should be revised to reflect this change.

At the same time the old section of US 6 went back to Polk County and the City of Altoona.

PROPOSAL/ACTION RECOMMENDATION:

It is recommended the old description of US 6 in Polk county be deleted from the Primary Road System and the new description, as described in the attachment, be included in the Primary Road System

New Description – US 6 and its extensions in Polk County described as follows:

Beginning on the Polk–Dallas County line at a point near the NW Corner Section 31–T79N–R25W, Polk County (NE Corner Section 36–T79N–R26W, Dallas County); thence east following substantially the section line of Sections 31, 32 (center of interchange with Interstate 35 and 80), and 33–T79N–R25W to the west corporation line of Clive, connecting with Hickman Road.

Clive:

Beginning on the west corporation line of Clive connecting with Hickman Road; thence east on Hickman Road to the east corporation line.

Beginning again on the east corporation line of Clive connecting with Hickman Road; thence east through the north part of Sections 35 and 36–T79N–R25W to the west corporation line of Des Moines, connecting with Hickman Road.

Des Moines:

Beginning on Hickman Road at the west corporation line; thence east on Hickman Road to Merle Hay Road; thence north on Merle Hay Road to Douglas

Avenue; thence east on Douglas Avenue to Lower Beaver Road; thence southeast on Lower Beaver Avenue Road to 30th Street and Euclid Avenue; thence east on Euclid Avenue to Frederick M Hubbell Avenue; thence northeast on Frederick M Hubbell Avenue to the east corporation line.

Beginning again on the east corporation line of Des Moines connecting with Frederick M Hubbell Avenue; thence northeast through Sections 21, 22 and 15-T79NR23W to the west corporation line of Altoona, connecting with an unnamed street (west junction of US 65).

Altoona:

Beginning again at the west corporation line of Altoona on unnamed street; thence northwest following the west corporation line to the north corporation line of Altoona (west junction of Interstate 80 and US 65).

Beginning again at the north corporation line of Altoona; thence easterly on Interstate 80 through Sections 10 and 11 to near E $\frac{1}{4}$ Corner SW $\frac{1}{4}$ of Section 11-T79N-R23W (east junction of Interstate 80 and US 65); thence easterly through Section 11-T79NR23W to a point approximately 1,182 feet north of the SE Corner of said Section 11; thence northeast through Section 12-T79N-R23W and Sections 7, 8, 5 and 4-T79NR22W to a point approximately 360 feet south of the E $\frac{1}{4}$ Corner of Section 4T79N-R22W; thence curving easterly and following substantially the center section line through Sections 3, 2 and 1-T79N-R22W to Polk-Jasper County line at a point approximately 136 feet north of the E $\frac{1}{4}$ Corner Section 1-T79NR22W, Polk County (W $\frac{1}{4}$ Corner Section 6-T79N-R21W, Jasper County).

OFFICIAL DESCRIPTION CHANGE

COUNTY: Polk

ROUTE: US 6

STAFF ACTION NUMBER: S-87-1518

APPROVAL DATE: 5-13-87

New Description – US 6 and its extensions in Polk County described as follows:

Beginning on the Polk–Dallas County line at a point near the NW Corner Section 31–T79N–R25W, Polk County (NE Corner Section 36–T79N–R26W, Dallas County); thence east following substantially the section line of Sections 31, 32 (center of interchange with Interstate 35 and 80) and 33–T79N–R25W to the west corporation line of Clive, connecting with Hickman Road.

Clive:

Beginning on the west corporation line of Clive connecting with Hickman Road; thence east on Hickman Road to the east corporation line.

Beginning again on the east corporation line of Clive connecting with Hickman Road; thence east through the north part of Sections 35 and 36–T79N–R25W to the west corporation line of Des Moines connecting with Hickman Road.

Des Moines:

Beginning on Hickman Road at the west corporation line; thence east on Hickman Road to Merle Hay Road; thence north on Merle Hay Road to Douglas Avenue; thence east on Douglas Avenue to Lower Beaver Road; thence southeast on Lower Beaver Avenue Road to 30th Street and Euclid Avenue; thence east on Euclid Avenue to Frederick M Hubbell Avenue; thence northeast on Frederick M Hubbell Avenue to the east corporation line.

Beginning again on the east corporation line of Des Moines connecting with Frederick M Hubbell Avenue; thence northeast through Sections 21, 22 and 15–T79N–R23W to the west corporation line of Altoona, connecting with an unnamed street.

Altoona:

Beginning on the west corporation line connecting with an unnamed street; thence northeast to the north corporation line connecting with an unnamed street.

Beginning again on the north corporation line of Altoona connecting with an unnamed street; thence northeast through Section 11-T79N-R23W to a point in the south $\frac{1}{2}$ of said Section 11 (east junction Interstate 80 and US 65); thence easterly through Section 11-T79N-R23W to a point approximately 1,182 feet north of the SE Corner of said Section 11; thence northeast through Section 12-T79N-R23W and Sections 7, 8, 5 and 4-T79N-R22W to a point approximately 360 feet south of the E $\frac{1}{4}$ Corner of Section 4-T79N-R22W; thence curving easterly and following substantially the center section line through Sections 3, 2 and 1-T79N-R22W to the Polk-Jasper County line at a point approximately 136 feet north of the E $\frac{1}{4}$ Corner Section 1-T79N-R22W, Polk County (W $\frac{1}{4}$ Corner Section 6-T79N-R21W, Jasper County).

COMMISSION ORDER

DIVISION: Planning & Research

COMMISSION ORDER NUMBER: PR-81-697

SUBMITTED BY: Patrick R. Cain

MEETING DATE: 4-28-81

TITLE: Official Description Change: US 6, Polk County

DISCUSSION/BACKGROUND:

To maintain continuity in the US route numbering system, the present description of US 6 in Polk County should be deleted and the new description added should be officially included in the primary road system.

US 6 begins on the Polk-Dallas County line approximately one mile south of the City of Grimes, and travels in a general easterly and northeasterly direction via the cities of Clive, Des Moines and Altoona to the Polk-Jasper County line northeast of the City of Mitchellville.

PROPOSAL/ACTION RECOMMENDATION:

It is recommended the commission approve deleting the present description of US 6 in Polk County from the primary road system and approve including the attached new description of US 6 in the primary road system.

Locate US 6 and its extensions in Polk County as follows:

Beginning on the Polk-Dallas County line at a point near the NW Corner Section 31-T79N-R25W, Polk County (NE Corner Section 36-T79N-R26W, Dallas County); thence easterly following substantially the section line of Sections 31,

32 (center of interchange with Interstate 35 and 80), and 33-T79N-R25W to the west corporation line of the City of Clive connecting with an unnamed street.

Clive:

Beginning on the west corporation line connecting with an unnamed street; thence easterly to the east corporation line connecting with an unnamed street.

Beginning again on the east corporation line of the City of Clive connecting with an unnamed street; thence easterly through the north part of Sections 35 and 36-T79N-R25W to the west corporation line of the City of Des Moines connecting with an unnamed street.

Des Moines:

Beginning on the west corporation line connecting with an unnamed street; thence in a general easterly and northeasterly direction to the east corporation line connecting with an unnamed street.

Beginning again on the east corporation line of the City of Des Moines connecting with an unnamed street; thence northeasterly through Sections 21, 22, and 15-T79N-R23W to the west corporation line of the City of Altoona connecting with an unnamed street.

Altoona:

Beginning on the west corporation line connecting with an unnamed street; thence northeasterly to the north corporation line connecting with an unnamed street.

Beginning again on the north corporation line of the City of Altoona connecting with an unnamed street; thence northeasterly through Section 11-T79N-R23W to a point in the south $\frac{1}{2}$ said Section 11 (east junction Interstate 80 and US 65); thence easterly through Section 11-T79N-R23W to a point approximately 1182 feet north of the SE Corner of said Section 11; thence northeasterly through

Section 12-T79N-R23W and Sections 7, 8, 5, and 4-T79N-R22W to a point approximately 360 feet south of the E ¼ Corner of Section 4-T79N-R22W; thence curving easterly and following substantially the center section line through Sections 3, 2, and 1-T79N-R22W to the Polk-Jasper County line at a point approximately 136 feet north of the E ¼ Corner Section 1-T79N-R22W, Polk County (W ¼ Corner Section 6-T79N-R21W, Jasper County).

REVISED: 5-13-87

COMMISSION ORDER

DIVISION: Planning & Research

COMMISSION ORDER NUMBER: PR-79-272

SUBMITTED BY: C.I. MacGillivray

MEETING DATE: 11-2-78

TITLE: US 6, Polk County, Iowa

DISCUSSION/BACKGROUND:

Due to a review of our Primary Road System records, US 6 in Polk County should be deleted and the new description added should be officially included into the Primary System.

US 6 begins on the Polk-Dallas County line approximately one mile south of the south corporation line of Grimes, and travels in a general easterly and northeasterly direction via Clive, Des Moines and Altoona to the Polk-Jasper County line east of Mitchellville, Iowa.

PROPOSAL/ACTION RECOMMENDATION:

Locate US 6 and its extensions in Polk County as follows:

Beginning on the Polk–Dallas County line at a point near the NW Corner Section 31–T79N–R25W, Polk County (NE Corner Section 36–T79N–R26W, Dallas County); thence easterly following substantially the section line of Sections 31, 32 (center of interchange with Interstate 35 and 80), and 33–T79N–R25W to the west corporation line of the City of Clive connecting with an unnamed street.

Clive:

Beginning on the west corporation line connecting with an unnamed street; thence easterly to the east corporation line connecting with an unnamed street.

Beginning again on the east corporation line of the City of Clive connecting with an unnamed street; thence easterly through the north part of Sections 35 and 36–T79N–R25W to the west corporation line of the City of Des Moines connecting with an unnamed street.

Des Moines:

Beginning on the west corporation line connecting with an unnamed street; thence in a general easterly and northeasterly direction to the east corporation line connecting with an unnamed street.

Beginning again on the east corporation line of the City of Des Moines connecting with an unnamed street; thence northeasterly through Sections 21 and 22–T79N–R23W to a point (east junction US 65) approximately $\frac{1}{4}$ mile east of the NW Corner Section 22–T79N–R23W; thence easterly following substantially the section line of Sections 22 and 23–T79N–R23W to the west corporation line of the City of Altoona connecting with an unnamed street.

Altoona:

Beginning on the west corporation line connecting with an unnamed street; thence easterly to the easterly corporation line connecting with an unnamed street.

Beginning again on the easterly corporation line of the City of Altoona connecting with an unnamed street; thence easterly following substantially the section line of Section 24-T79N-R23W to the westerly corporation line of the City of Altoona connecting with an unnamed street.

Altoona:

Beginning on the westerly corporation line connecting with an unnamed street; thence easterly to the east corporation line connecting with an unnamed street.

Beginning again on the east corporation line of the City of Altoona connecting with an unnamed street; thence easterly following substantially the section line of Sections 19, 20, 21, 22, 23, and 24-T79N-R22W to a point approximately 1150 feet west of the S $\frac{1}{4}$ Corner Section 13-T79N-R22W; thence curving in a northeasterly direction to a point approximately 1150 feet north of the S $\frac{1}{4}$ Corner Section 13-T79N-R22W; thence northerly to a point approximately 1530 feet south of the N $\frac{1}{4}$ Corner Section 13-T79N-R22W; thence curving in a northeasterly direction to a point approximately 1530 feet east of the N $\frac{1}{4}$ Corner Section 13-T79N-R22W; thence easterly following substantially the section line of Section 13-T79N-R22W to the Polk-Jasper County line at a point near the NE Corner Section 13-T79N-R22W, Polk County (NW Corner Section 18-T79N-R21W, Jasper County).

NOW, THEREFORE: Be it resolved that the Iowa Department of Transportation approve the location of US 6 in Polk County, Iowa.

NOTE: To become effective upon the adoption of this resolution.

REVISED: 4-28-81

OFFICIAL DESCRIPTION CHANGE

COUNTY: Polk

ROUTE: US 6

Beginning on the Polk–Dallas County Line at a point near the NW Corner Section 31–T79N–R25W, Polk County (NE Corner Section 36–T79N–R26W, Dallas County); thence east to the west corporation line of the Town of Clive connecting with Hickman Road.

Beginning again on the east corporation line of the Town of Clive connecting with Hickman Road; thence easterly to the west corporation line of the City of Des Moines connecting with Hickman Road.

Beginning again on the east corporation line of the City of Des Moines connecting with Frederick M Hubbell Avenue; thence in a northeasterly direction through Sections 21 and 22–T79N–R23W to a point approximately $\frac{1}{4}$ mile east of the NW Corner Section 22–T79N–R23W; thence east following substantially the section line to the west corporation line of the Town of Altoona connecting with an unnamed street.

Beginning again on the east corporation line of the Town of Altoona connecting with an unnamed street; thence east following substantially the section line to a point approximately 1,150 feet west of the S $\frac{1}{4}$ Corner Section 13–T79N–R22W; thence curving in a northeasterly direction to a point approximately 1,150 feet north of the S $\frac{1}{4}$ Corner Section 13–T79N–R22W; thence north to a point approximately 1,530 feet south of the N $\frac{1}{4}$ Corner Section 13–T79N–R22W; thence curving in a northeasterly direction to a point approximately 1,530 feet east of the N $\frac{1}{4}$ Corner Section 13–T79N–R22W; thence east to the Polk Jasper County line at a point near the NE Corner Section 13–T79N–R22W, Polk County (NW Corner Section 18–T79N–R21W, Jasper County).

REVISED: 11-2-78

OFFICIAL DESCRIPTION CHANGE

COUNTY: Polk

APPROVAL DATE: 12-31-68

Connecting Curves

Junction of US 6 and Iowa 126

Beginning at a point approximately 200 feet north of the S $\frac{1}{4}$ Corner Section 12-T79N-R22W; thence curving in a southeasterly direction to a point approximately 200 feet east of the S $\frac{1}{4}$ Corner Section 12-T79N-R22W.

Junction of US 6 and Iowa 126 south of Mitchellville

Beginning at a point approximately 200 feet east of the S $\frac{1}{4}$ Corner Section 12-T79N-R22W; thence east to a point approximately 1530 feet east of the south quarter corner said Section 12.

OFFICIAL DESCRIPTION CHANGE

COUNTY: Polk

CITY OF: Des Moines

ROUTE: US 6

APPROVAL DATE: 12-13-66

Beginning on Hickman Road at the west corporation line; thence easterly on Hickman Road to Merle Hay Road; thence northerly on Merle Hay Road to Douglas Avenue; thence easterly on Douglas Avenue to Lower Beaver Road; thence southeasterly on Lower Beaver Road to Thirtieth Street and Euclid

Avenue; thence easterly on Euclid Avenue to Frederick M Hubbell Avenue;
thence northeasterly on Frederick M Hubbell Avenue to the east corporation
line.

REVISED: 11-2-78

COMMISSION ORDER

DIVISION: Planning & Research

SUBMITTED BY: Gene Mills

MEETING DATE: 12-13-66

TITLE: US 6 in Polk County

Locate the Extension of US 6 on streets or roads as follows:

Commencing on 8th Street SW at the west corporation line; thence easterly on 8th Street SW and 8th Street SE to the east corporation line.

BE IT FURTHER RESOLVED that the description of the extension of US 6 in the City (Town) of Altoona, Polk County, as described and the attached description is adopted.

NOTE: To become effective upon adoption of this resolution.

REVISED: 11-2-78

COMMISSION RESOLUTION

DIVISION: Planning & Research

SUBMITTED BY: Gene Mills

DATE: 11-16-60

TITLE: US 6 in Polk County

Beginning on the Polk-Dallas County Line at a point near the NW Corner Section 31-T79N-R25W, Polk County (NE Corner Section 36-T79N-R26W, Dallas County); thence east following substantially the section line to the west corporation line of the City of Des Moines connecting with Hickman Avenue.

Beginning again on the east corporation line of the City of Des Moines connecting with Frederick M Hubbell Avenue; thence in a northeasterly direction through Sections 21 and 22-T79N-R23W to a point approximately $\frac{1}{4}$ mile east of the NW Corner Section 22-T79N-R23W; thence east following substantially the section line to the west corporation line of the Town of Altoona connecting with an unnamed street at a point near the S $\frac{1}{4}$ Corner Section 13-T79N-R23W.

Beginning again on the east corporation line of the Town of Altoona connecting with an unnamed street on the south line of Section 18-T79N-R22W; thence east following substantially the section line to a point approximately 1150 feet west of the S $\frac{1}{4}$ Corner Section 13-T79N-R22W; thence curving in a northeasterly direction to a point approximately 1150 feet north of the S $\frac{1}{4}$ Corner Section 13-T79N-R22W thence north to a point approximately 1530 feet south of the N $\frac{1}{4}$ Corner Section 13-T79N-R22W; thence curving in a northeasterly direction to a point approximately 1530 feet east of the N $\frac{1}{4}$ Corner Section 13-T79N-R22W; thence east to the Polk-Jasper County line at a point near the NE Corner Section 13-T79N-R22W, Polk County (NW Corner Section 18-T79N-R21W, Jasper County).

BE IT FURTHER RESOLVED that the description of US 6 in Polk County per the Commission's minutes of November 16, 1960, is hereby rescinded and the attached description adopted.

NOTE: To become effective upon adoption of this resolution.

REVISED: 11-2-78

OFFICIAL DESCRIPTION CHANGE

COUNTY: Polk

CITY OF: Clive

ROUTE: US 6

DATE: 11-16-60

Beginning on the west corporation line of the Town of Clive connecting with Hickman Road; thence easterly on Hickman Road to the east corporation line.

REVISED: 11-2-78

COMMISSION RESOLUTION

DIVISION: Planning & Research

SUBMITTED BY: Gene Mills

DATE: 11-16-60

TITLE: US 6 in Polk County

Locate the Extension of US 6 on streets or roads as follows:

Commencing on Hickman Avenue at the west corporation line; thence easterly on Hickman Avenue to Fifty-eighth Street; thence northerly on Fifty-eighth Street to Douglas Avenue; thence easterly on Douglas Avenue to Lower Beaver Road; thence southeasterly on Lower Beaver Road to Thirtieth Street and Euclid Avenue; thence easterly on Euclid Avenue to Frederick M Hubbell Avenue; thence northeasterly on Frederick M Hubbell Avenue to the east corporation line.

BE IT FURTHER RESOLVED that the description of the extension of US 6 in the City (Town) of Des Moines, Polk County, as described in the Commission's minutes of November 16, 1960, is hereby rescinded and the attached description is adopted therefore.

NOTE: To become effective upon adoption of this resolution.

REVISED: 11-2-78

COMMISSION RESOLUTION

DIVISION: Planning & Research

DATE: 11-16-60

TITLE: US 6 in Polk County

Remove from the Primary Road System and Federal Aid System the road,

Beginning on the Polk-Dallas County line at a point approximately 1400 feet south of the NW Corner Section 30-T78N-R25W, Polk County (NE Corner Section 25-T78N-R26W, Dallas County); thence in a northeasterly direction crossing the Chicago, Rock Island & Pacific Railway overpass to a point approximately 300 feet west of the N $\frac{1}{4}$ Corner Section 30-T78N-R25W; thence east approximately 300 feet to the west corporation line of the City of West Des Moines connecting with a unnamed street at a point 6 feet west of the S $\frac{1}{4}$ Corner Section 19-T78N-R25W.

Beginning again on the north corporation line of the City of West Des Moines connecting with an unnamed street at a point approximately 750 feet west of the SE Corner Section 32-T79N-R25W; thence in a northerly direction through Sections 32, 29 and 20-T79N-R25W to a point approximately 560 feet west of the SE Corner Section 17-T79N-R25W; thence curving in a northeasterly and easterly direction through the SE $\frac{1}{4}$ Section 17-T79N-R25W and the SW $\frac{1}{4}$ Section 16-T79N-R25W to a point near the center of Section 16-T79N-R25W; thence in an easterly direction through Sections 16, 15 and 14-T79N-R25W to a point approximately 520 feet north of the E $\frac{1}{4}$ Corner Section 14-T79N-R25W; thence continuing in an easterly direction through Section 13-T79N-R25W and Sections 18, 17, 16, 15, 14 and 13-T79N-R24W and Section 18-T79N-R23W to a point approximately $\frac{1}{4}$ mile east of the W $\frac{1}{4}$ Corner Section 18-T79N-R23W; thence easterly and northeasterly through Sections 18, 17, and 16-T79N-R23W to a point approximately 172 feet east of the N $\frac{1}{4}$

Corner Section 16-T79N-R23W, and continuing in a northeasterly and easterly direction through Sections 9, 10 and 11-T79N-R23W to a point approximately 1182 feet north of the SE Corner Section 11-T79N-R23W; thence northeasterly through Section 12 T79N-R23W and Sections 27, 8, 5 and 4-T79N-R22W; thence curving easterly and following substantially the quarter section line through Sections 3,2 and 1-T79N-R22W to the Polk-Jasper County Line at a point approximately 136 feet north of the E ¼ Corner Section 1-T79N-R22W, Polk county (W ¼ Corner Section 6-T79N-R21W, Jasper County).

BE IT FURTHER RESOLVED that the description of US 6 in Polk County in the Commission's minutes of November 16, 1960 is hereby rescinded.

NOTE: To become effective upon adoption of this resolution.

COMMISSION RESOLUTION

DIVISION: Planning & Research

DATE: 11-19-58

TITLE: US 6 in Polk County

Remove the Extension of US 6 from the streets or roads as follows:

Commencing on an unnamed street at the west corporation line at a point 6 feet west of the S $\frac{1}{4}$ Corner Section 19-T78N-R25W; thence east following the section line approximately 1416 feet to a point 1222 feet west of the SE Corner Section 19-T78N-R25W; thence northerly on an unnamed street through Section 19, 18, 7, and 6-T78N-R25W to the north corporation line at a point approximately 750 feet west of the SE Corner Section 32-T79N-R25W.

BE IT FURTHER RESOLVED that the description of the extension of US 6 in the City (Town) of West Des Moines, Polk County, as described in the Commission's minutes of November 19, 1958, is hereby rescinded.

NOTE: To become effective upon adoption of this resolution.