

OFFICIAL DESCRIPTION CHANGE

OFFICE: Research and Analytics

EFFECTIVE DATE: 6-14-2019

COUNTY: Dubuque

ROUTE: US 20

ENTERED BY: Paul Mauer

ENTERED DATE: 08-14-2020

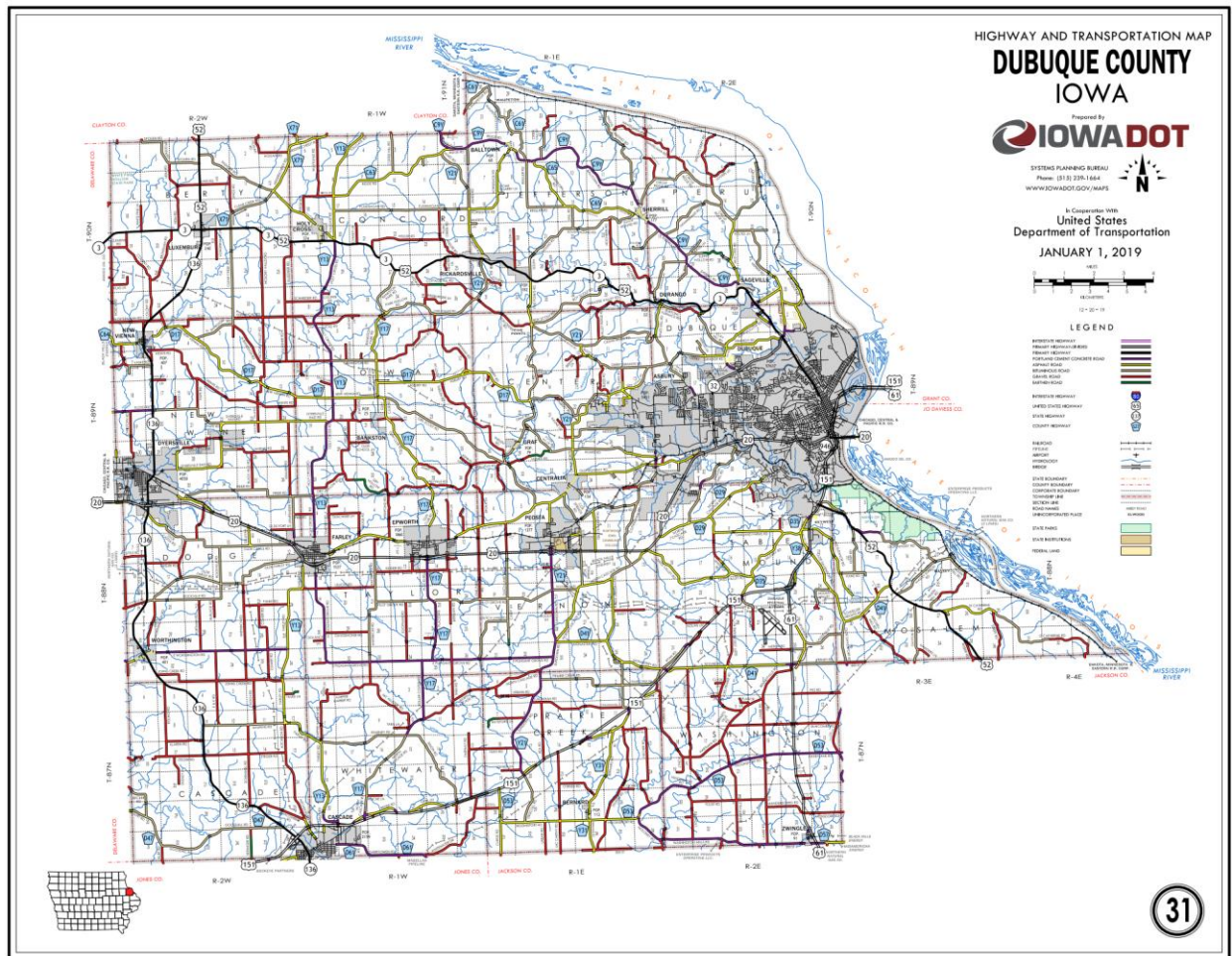

New Description – US 20 and its extensions in Dubuque County described as follows:

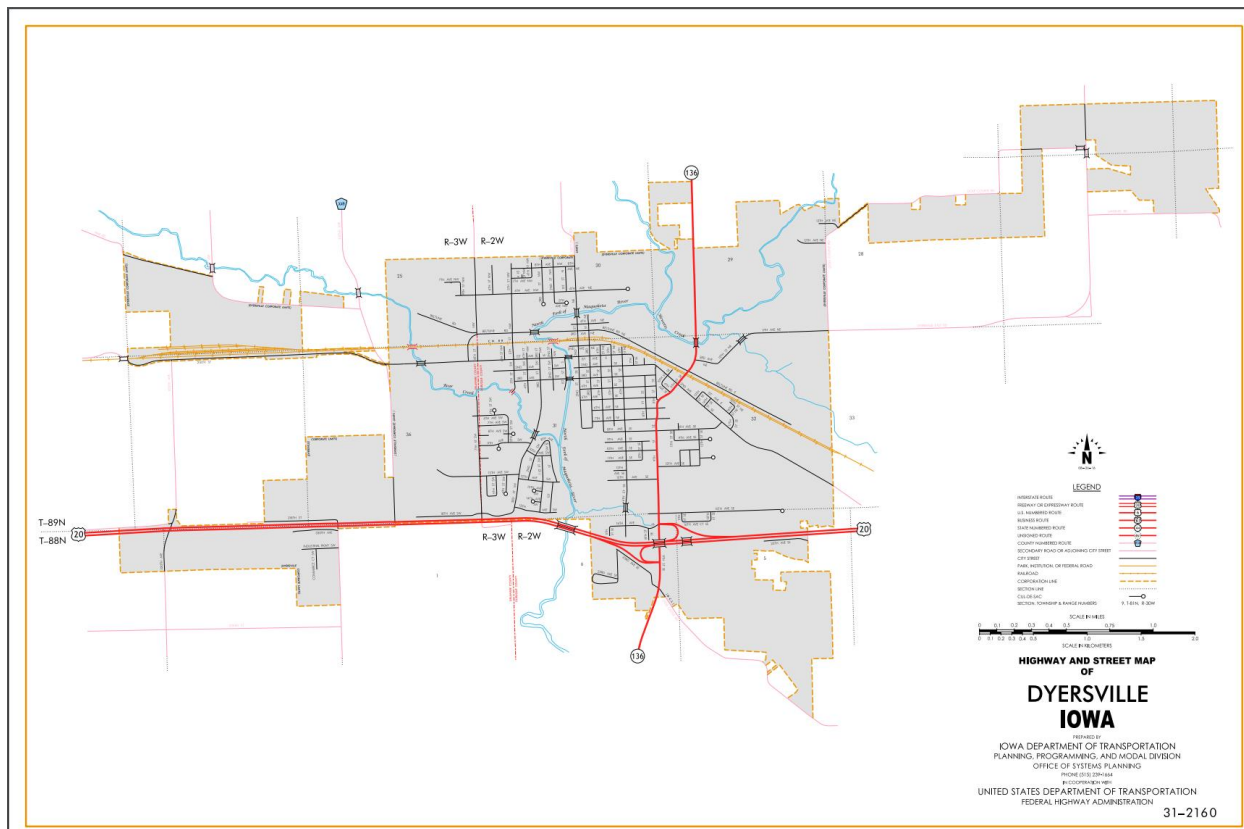

Dyersville:

Beginning on the Dubuque-Delaware County line at a point near the NW Corner Section 6-T88N-R2W, Dubuque County (NE Corner Section 1-T88N-R3W, Delaware County); thence in an easterly and southeasterly direction to the south corporation line.

Beginning again at the south corporation line of Dyersville; thence in a southeasterly direction through Section 6-T88N-R2W to the west corporation line of Dyersville.

Dyersville:

Beginning at the west corporation line; thence easterly to the east corporation line.

Beginning again at the east corporation line of Dyersville; thence east and southeast through Sections 5, 4, and 3-T88N-R2W to a point approximately 535 feet north and 770 feet east of the W $\frac{1}{4}$ Corner of Section 3-T88N-R2W on the south side of the Illinois Central Railroad; thence southeast along the south side of said railroad and substantially parallel thereto through Sections 3, 2, 11, and 12-T88N-R2W to the west corporation line of Farley.

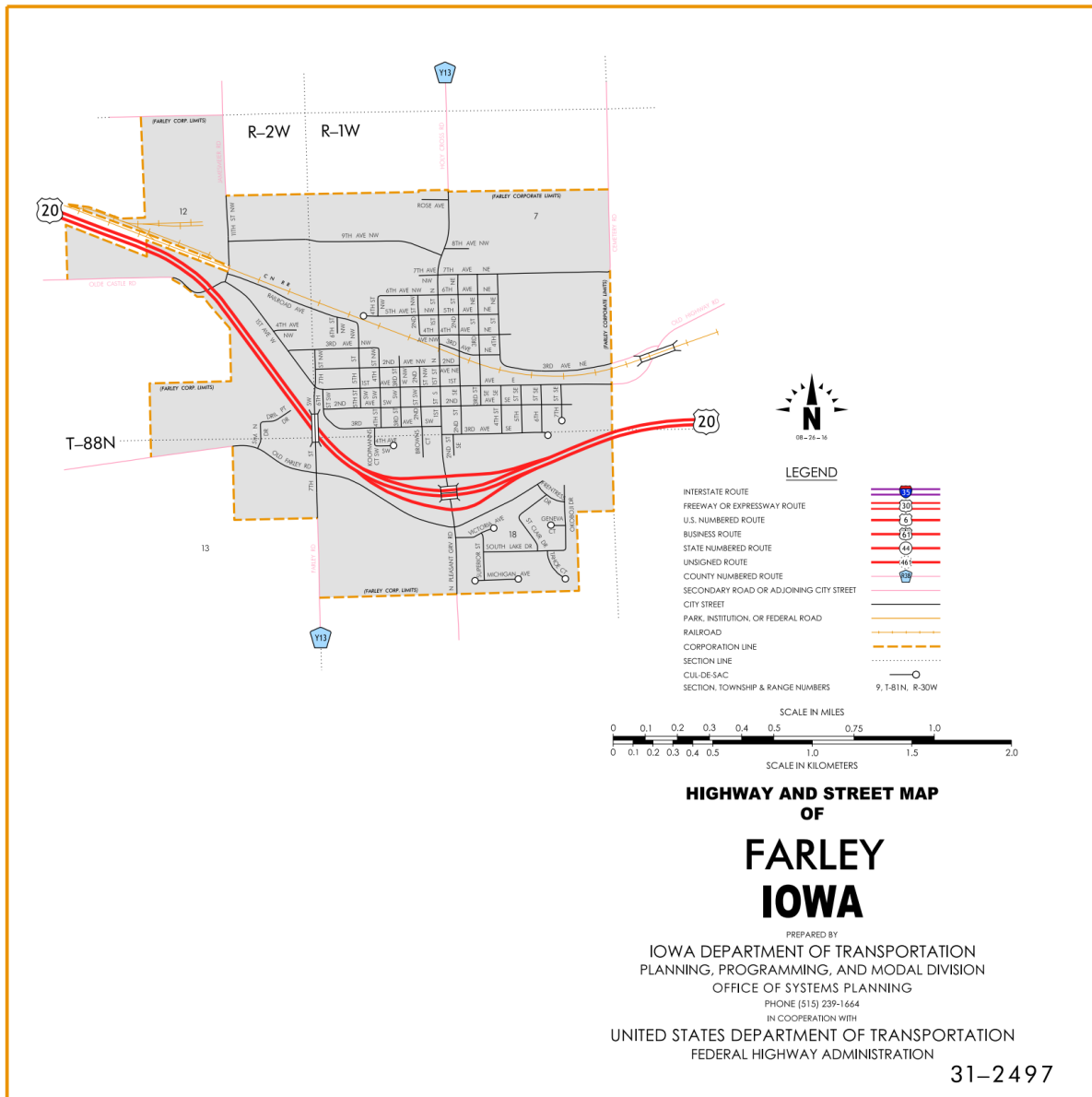

Farley:

Beginning at the west corporation line; thence southeasterly, easterly, and northeasterly to the east corporation line.

Beginning again on the east corporation line of Farley; thence east following substantially the section line of Sections 17, 16 and 15-T88N-R1W to the west

corporation line of Epworth. 14, and 13-T88N-R1W; thence continuing in an easterly direction through the south part of Section 12-T88N-R1W and Sections 7, 8, 9, and 10-T88N-R1E; and east following substantially the section line of sections 15, 14, and 13-T88N-R1E to a point approximately 1,500 feet west of the NE Corner of Section 13-T88N-R1E; thence curving in a northeasterly direction through Section 12-T88N-R1E and continuing northeasterly, northerly, and northeasterly through Sections 7 and 6-T88N-R2E, and Sections 31, 32, and 29-T89N-R2E to the west corporation line of Dubuque connecting with Dodge Street.

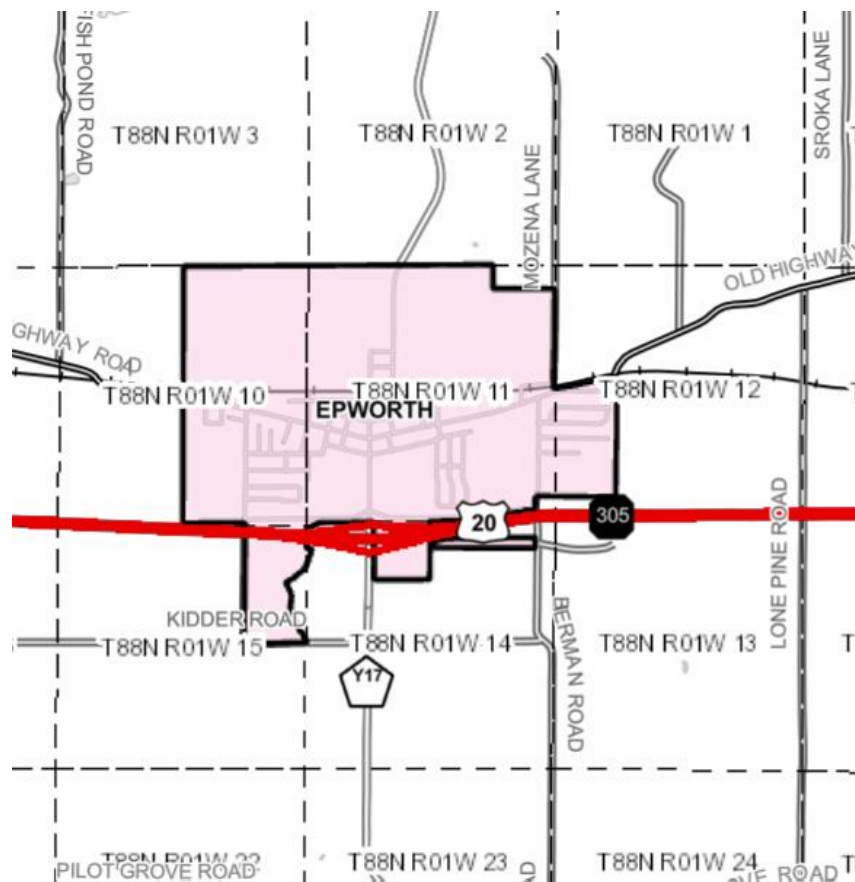

Epworth:

Beginning at the west corporation line; thence east to the east corporation line.

Beginning again at the east corporation line of Epworth; thence east through Section 14-T88N-R1W to the west corporation line of Epworth.

Beginning at the west corporation line; thence east and northeasterly to the east corporation line.

Beginning again at the east corporation line of Epworth; thence continuing in an easterly direction through Sections 14, and 13-T88N-R1W; thence continuing in an easterly direction through the south part of Section 12-T88N-R1W and Sections 7, 8, 9, and 10-T88N-R1E; and east following substantially the section line of sections 15, 14, and 13-T88N-R1E to a point approximately 1,500 feet west of the NE Corner of Section 13-T88N-R1E; thence curving in a northeasterly direction through Section 12-T88N-R1E and continuing northeasterly, northerly, and northeasterly through Sections 7 and 6-T88N-R2E to the west corporation line of Dubuque connecting with Dodge Street., and Sections 31, 32, and 29-T89N-R2E to the west corporation line of Dubuque connecting with Dodge Street.

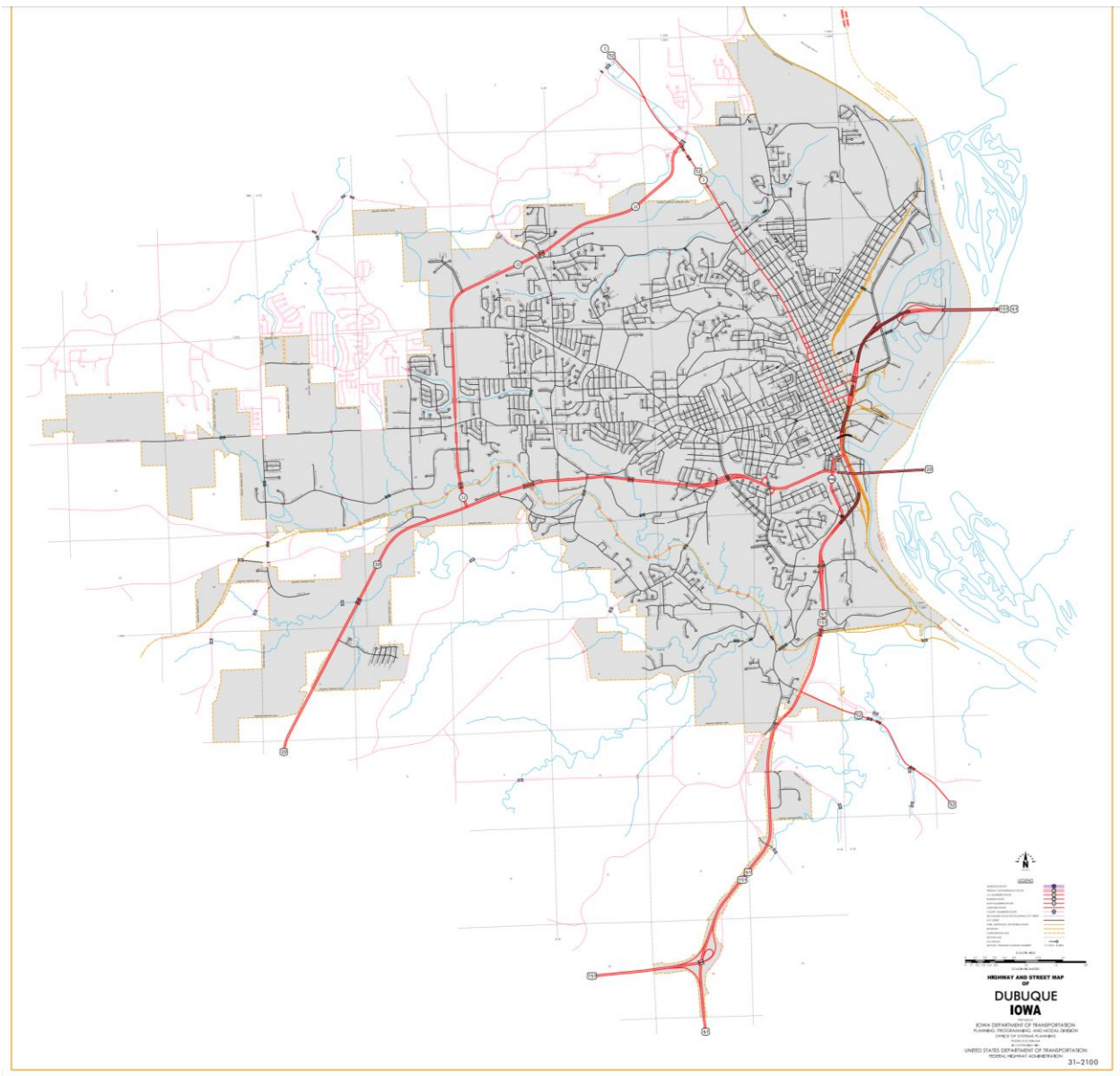

Dubuque:

Beginning on Dodge Street at the west corporation line; thence northeast and easterly on Dodge Street (junction Iowa 32) and (junction Iowa 946) to the east corporation line at the Iowa–Illinois state line on the Julien–Dubuque Bridge over the Mississippi River.

OFFICIAL DESCRIPTION CHANGE

COUNTY: Dubuque

ROUTE: US 20

STAFF ACTION NUMBER: S-87-718

APPROVAL DATE: 12-18-86

New Description – US 20 and its extensions in Dubuque County described as follows:

Beginning on the Dubuque–Delaware County line at a point near the NW Corner Section 6–T88N–R2W, Dubuque County (NE Corner Section 1–T88N–R3W, Delaware County); thence in an easterly and southeasterly direction through Section 6–T88N–R2W to the west corporation line of Dyersville connecting with an unnamed street.

Dyersville:

Beginning on an unnamed street at the west corporation line; thence easterly on unnamed street to the east corporation line.

Beginning again at the east corporation line of Dyersville connecting with an unnamed street; thence east and southeast through Sections 5, 4, and 3–T88N–R2W to a point approximately 535 feet north and 770 feet east of the W $\frac{1}{4}$ Corner of Section 3–T88N–R2W on the south side of the Illinois Central Railroad; thence southeast along the south side of said railroad and substantially parallel thereto through Sections 3, 2, 11, and 12–T88N–R2W to the west corporation line of Farley, connecting with an unnamed street.

Farley:

Beginning on an unnamed street at the west corporation line; thence southeasterly, easterly, and northeasterly on unnamed street to the east corporation line.

Beginning again on the east corporation line of Farley connecting with an unnamed street; thence east following substantially the section line of Sections 17, 16, 15, 14, and 13-T88N-R1W; thence continuing in an easterly direction through the south part of Section 12-T88N-R1W and Sections 7, 8, 9, and 10-T88N-R1E; and east following substantially the section line of sections 15, 14, and 13-T88N-R1E to a point approximately 1,500 feet west of the NE Corner of Section 13-T88N-R1E; thence curving in a northeasterly direction through Section 12-T88N-R1E and continuing northeasterly, northerly, and northeasterly through Sections 7 and 6-T88N-R2E, and Sections 31, 32, and 29-T89N-R2E to the west corporation line of Dubuque connecting with Dodge Street.

Dubuque:

Beginning on Dodge Street at the west corporation line; thence northeast and easterly on Dodge Street to the east corporation line at the Iowa-Illinois state line on the Julien-Dubuque Bridge over the Mississippi River.

Durango:

Beginning on an unnamed street at the west corporation line; thence easterly, northeasterly and easterly an unnamed street to the east corporation line.

Beginning again on the east corporation line of Durango, connecting with an unnamed street; thence in an easterly and southeasterly direction through Sections 31 and 32-T90N-R2E and Section 5-T89N-R2E to a point approximately 700 feet south and 700 feet west of the NE Corner of Section 5-T89N-R2E; thence in a northeasterly and southeasterly direction through Section 5-T89N-R2E and Sections 33 and 34-T90N-R2E and in a southeasterly

direction through Sections 3, 2, and 11–T89N–R2E to the north corporation line of Dubuque, connecting with Central Avenue.

Dubuque:

Beginning on Central Avenue at the north corporation line; thence southeasterly on Central Avenue to 21st Street (begin one-way southbound); thence continuing southeasterly on Central Avenue to 5th Street; thence southwesterly on 5th Street to Bluff Street; thence southeasterly on Bluff Street to Dodge Street (US 20) (end one-way southbound).

Also with a spur

Beginning at the intersection of Dodge and Locust Street; thence northerly (one-way northbound) and Locust Street to 4th Street; thence easterly on 4th Street to White Street; thence northwesterly on White Street to 21st Street; thence southwesterly on 21st Street to Central Avenue (end one-way northbound).

COMMISSION ORDER

DIVISION: Planning & Research

COMMISSION ORDER NUMBER: PR–80–375

SUBMITTED BY: Leland D. Smithson

MEETING DATE: 1–8–90

DISCUSSION/BACKGROUND:

US 20 begins at the Dubuque–Delaware County line near the southwest edge of Dyersville and travels in a southeasterly, easterly, and northeasterly direction to the Iowa–Illinois State line in Dubuque via Dyersville and Farley.

Due to an involuntary annexation to the City of Dubuque extending the corporation line westerly and southerly the present description of US 20 in Dubuque County should be revised. The new description added should be officially included in the primary road system to reflect this change in corporate limits.

PROPOSAL/ACTION RECOMMENDATION:

It is recommended that the present description of US 20 in Dubuque County be deleted and the new description, as referred to in the attached detailed description, be included in the primary road system.

Locate US 20 and its extensions in Dubuque County as follows:

Beginning on the Dubuque–Delaware County line at a point near the NW Corner Section 6–T88N–R2W, Dubuque County (NE Corner Section 1–T88N–R3W, Delaware County); thence in an easterly and southeasterly direction through Section 6–T88–R2W to the west corporation line of the City of Dyersville connecting with an unnamed street.

Dyersville:

Beginning at the west corporation line connecting with an unnamed street; thence easterly to the east corporation line, connecting with an unnamed street.

Beginning again at the east corporation line of the City of Dyersville connecting with an unnamed street; thence in an easterly and southeasterly direction through Sections 5, 4, and 3–T88N–R2W to a point approximately 535 feet north and 770 feet east of the W $\frac{1}{4}$ Corner of Section 3–T88N–R2W, on the south side of the Illinois Central Railroad; thence in a southeasterly direction along the south side of said railroad and substantially parallel thereto through

Sections 3, 2, 11, and 12-T88N-R2W to the west corporation line of the City of Farley, connecting with an unnamed street.

Farley:

Beginning at the west corporation line connecting with an unnamed street; thence southeasterly, easterly, and northeasterly to the east corporation line connecting with an unnamed street.

Beginning again on the east corporation line of the City of Farley connecting with an unnamed street; thence easterly following substantially the section line of Sections 17, 16, 15, 14, and 13-T88N-R1W; easterly through the south part of Section 12-T88N-R1W and Sections 7, 8, 9 and 10-T88N-R1E; and easterly following substantially the section line of Sections 15, 14, and 13-T88N-R1E to a point approximately 1500 feet west of the NE Corner of Section 13-T88N-R1E; thence curving in a northeasterly direction through Section 12-T88N-R1E and continuing northeasterly, northerly, and northeasterly through Sections 7 and 6-T88N-R2E, and Sections 31, 32, and 29-T89N-R2E to the west corporation line of the City of Dubuque connecting with an unnamed street.

Dubuque:

Beginning at the west corporation line connecting with an unnamed street; thence easterly to the east corporation line at the Iowa-Illinois State line.

COMMISSION ORDER

DIVISION: Planning & Research

COMMISSION ORDER NUMBER: PR-77-172

SUBMITTED BY: C.I. MacGillivray

MEETING DATE: 11-2-78

DISCUSSION/BACKGROUND:

Due to a review of our Primary Road System records, US 20 in Dubuque County should be deleted and the new description added should be officially included into the Primary Road System.

US 20 begins at the Dubuque–Delaware County line near the southwest edge of Dyersville traveling in a southeasterly, easterly, and northeasterly direction to the Iowa–Illinois State line in Dubuque via Dyersville and Farley, Iowa.

PROPOSAL/ACTION RECOMMENDATION:

Locate US 20 and its extensions in Dubuque County as follows:

Beginning on the Dubuque–Delaware County line at a point near the NW Corner Section 6–T88N–R2W, Dubuque County (NE Corner Section 1–T88N–R3W, Delaware County): thence in an easterly and southeasterly direction through Section 6–T88–R2W to the west corporation line of the City of Dyersville connecting with an unnamed street.

Dyersville:

Beginning at the west corporation line connecting with an unnamed street; thence easterly to the east corporation line, connecting with an unnamed street.

Beginning again at the east corporation line of the City of Dyersville connecting with an unnamed street; thence in an easterly and southeasterly direction through Sections 5, 4, and 3–T88N–R2W to a point approximately 535 feet north and 770 feet east of the W ¼ Corner of Section 3–T88N–R2W, on the south side of the Illinois Central Railroad; thence in a southeasterly direction along the south side of said railroad and substantially parallel thereto through

Sections 3, 2, 11, and 12-T88N-R2W to the west corporation line of the City of Farley, connecting with an unnamed street.

Farley:

Beginning at the west corporation line connecting with an unnamed street; thence southeasterly, easterly, and northeasterly to the east corporation line connecting with an unnamed street.

Beginning again on the east corporation line of the City of Farley connecting with an unnamed street; thence easterly following substantially the section line of Sections 17, 16, 15, 14, and 13-T88N-R1W, and Sections 18, 17, 16, 15, 14, and 13-T88N-R1E to a point approximately 1500 feet west of the NE Corner of Section 13-T88N-R1E; thence curving in a northeasterly direction through Section 12-T88N-R1E and continuing northeasterly, northerly, and northeasterly through Sections 7 and 6-T88N-R2E, and Sections 31, 32, 29, and 28-T89N-R2E to a point approximately 1,650 feet east and ¼ mile north of the SW Corner Section 28-T89N-R2E; thence in a northeasterly and easterly direction through Section 23-T89N-R2E to the west corporation line of the City of Dubuque connecting with an unnamed street.

Dubuque:

Beginning at the west corporation line connecting with an unnamed street; thence easterly to the east corporation line at the Iowa-Illinois State line.

NOW, THEREFORE: Be it resolved that the Iowa Department of Transportation approve the location of US 20, Dubuque-County, Iowa.

NOTE: To become effective upon the adoption of this resolution.

COMMISSION ORDER

DIVISION: Planning & Research

SUBMITTED BY: Raymond L. Kassel

MEETING DATE: 10-5-76

DISCUSSION/BACKGROUND:

Due to a review of our Primary Road System records, US 20 in Dubuque County should be deleted and the new description added should be officially included into the Primary Road System.

US 20 begins at the Dubuque–Delaware County line near the southwest edge of Dyersville traveling in a southeasterly, easterly, and northeasterly direction to the Iowa–Illinois State line in Dubuque via Dyersville and Farley, Iowa.

PROPOSAL/ACTION RECOMMENDATION:

Locate US 20 and its extensions in Dubuque County as follows:

Beginning on the Dubuque–Delaware County line at a point near the NW Corner Section 6–T88N–R2W, Dubuque County (NE Corner Section 1–T88N–R3W, Delaware County); thence in an easterly and southeasterly direction through Section 6–T88–R2W to the west corporation line of the City of Dyersville connecting with an unnamed street.

Dyersville:

Beginning at the west corporation line connecting with an unnamed street; thence easterly to the east corporation line, connecting with an unnamed street.

Beginning again at the east corporation line of the City of Dyersville connecting with an unnamed street; thence in an easterly and southeasterly direction through Sections 5, 4, and 3-T88N-R2W to a point approximately 535 feet north and 770 feet east of the W $\frac{1}{4}$ Corner of Section 3-T88N-R2W, on the south side of the Illinois Central Railroad; thence in a southeasterly direction along the south side of said railroad and substantially parallel thereto through Sections 3, 2, 11, and 12-T88N-R2W to the west corporation line of the City of Farley, connecting with an unnamed street.

Farley:

Beginning at the west corporation line connecting with an unnamed street; thence southeasterly, easterly, and northeasterly to the east corporation line connecting with an unnamed street.

Beginning again on the east corporation line of the City of Farley connecting with an unnamed street; thence easterly following substantially the section line of Sections 17, 16, 15, 14, and 13-T88N-R1W, and Sections 18, 17, 16, 15, 14, and 13-T88N-R1E to a point approximately 1500 feet west of the NE Corner of Section 13-T88N-R1E; thence curving in a northeasterly direction through Section 12-T88N-R1E and continuing northeasterly, northerly, and northeasterly through Sections 7 and 6-T88N-R2E, and Sections 31, 32, 29, and 28-T89N-R2E to a point approximately 1,650 feet east and $\frac{1}{4}$ mile north of the SW Corner Section 28-T89N-R2E; thence in a northeasterly and easterly direction through Section 28-T89N-R2E to the west corporation line of the City of Dubuque connecting with an unnamed street.

Dubuque:

Beginning at the west corporation line connecting with an unnamed street; thence easterly to the east corporation line at the Iowa-Illinois State line.

NOW, THEREFORE: Be it resolved that the Iowa Department of Transportation approve the location of US 20, Dubuque County, Iowa.

NOTE: To become effective upon the adoption of this resolution.

OFFICIAL DESCRIPTION CHANGE

COUNTY: Dubuque

ROUTE: US 20

APPROVAL DATE: 4-2-58

Beginning on the Dubuque-Delaware County line at the SW Corner Section 1-T89N-R2W Dubuque County (SE Corner Section 36-T89N-R3W Delaware County); thence east to a point approximately 394 feet east of the NW Corner Section 6-T88N-R2W; thence curving in a southeasterly and easterly direction through Sections 6 and 5-T88N-R2W, and southeasterly through Sections 4 and 3-T88N-R2W to a point approximately 535 feet north and 770 feet east of the W $\frac{1}{4}$ Corner Section 3-T88N-R2W, on the south side of the Illinois Central Railroad; thence in a southeasterly direction along the south side of said railroad and substantially parallel thereto through Sections 3, 2, 11 and 12-T88N-R2W to the west corporation line of the Town of Farley, connecting with an unnamed street.

Beginning again on the east corporation line of the Town of Farley, connecting with an unnamed street; thence easterly following substantially the section line to a point approximately $\frac{1}{2}$ mile east of the SW Corner Section 12-T88N-R1E; thence curving in a northeasterly direction through said Section 12 and continuing northeasterly, northerly and northeasterly through Sections 7 and 6-T88N-R2E and Sections 31, 32, 29 and 28-T89N-R2E to a point approximately 1,650 feet east and $\frac{1}{4}$ mile north of the SW Corner Section 28-T89N-R2E; thence in a northeasterly and easterly direction through Sections

28 and 27-T89N-R2E to the west corporation line of the City of Dubuque connecting with Dodge Street.

Note: Designation to become effective upon the completion and opening to traffic of relocation US 20, more specifically project F-FN-305.

OFFICIAL DESCRIPTION CHANGE

COUNTY: Dubuque

CITY OF: Farley

ROUTE: US 20

APPROVAL DATE: 4-2-58

Beginning on unnamed street at the west corporation line; thence southeasterly, easterly and northeasterly on unnamed street to the east corporation line.

Note: Designation to become effective upon the completion & opening to traffic of relocation US 20, more specifically project F-FN-305.

OFFICIAL DESCRIPTION CHANGE

COUNTY: Dubuque

CITY OF: Dubuque

ROUTE: US 20

APPROVAL DATE: 4-7-53

Beginning on the west corporation line connecting with Dodge Street; thence easterly on Dodge Street to the east corporation line on the Julien-Dubuque Bridge over the Mississippi River.