

ENTERED DATE: 08-14-2020

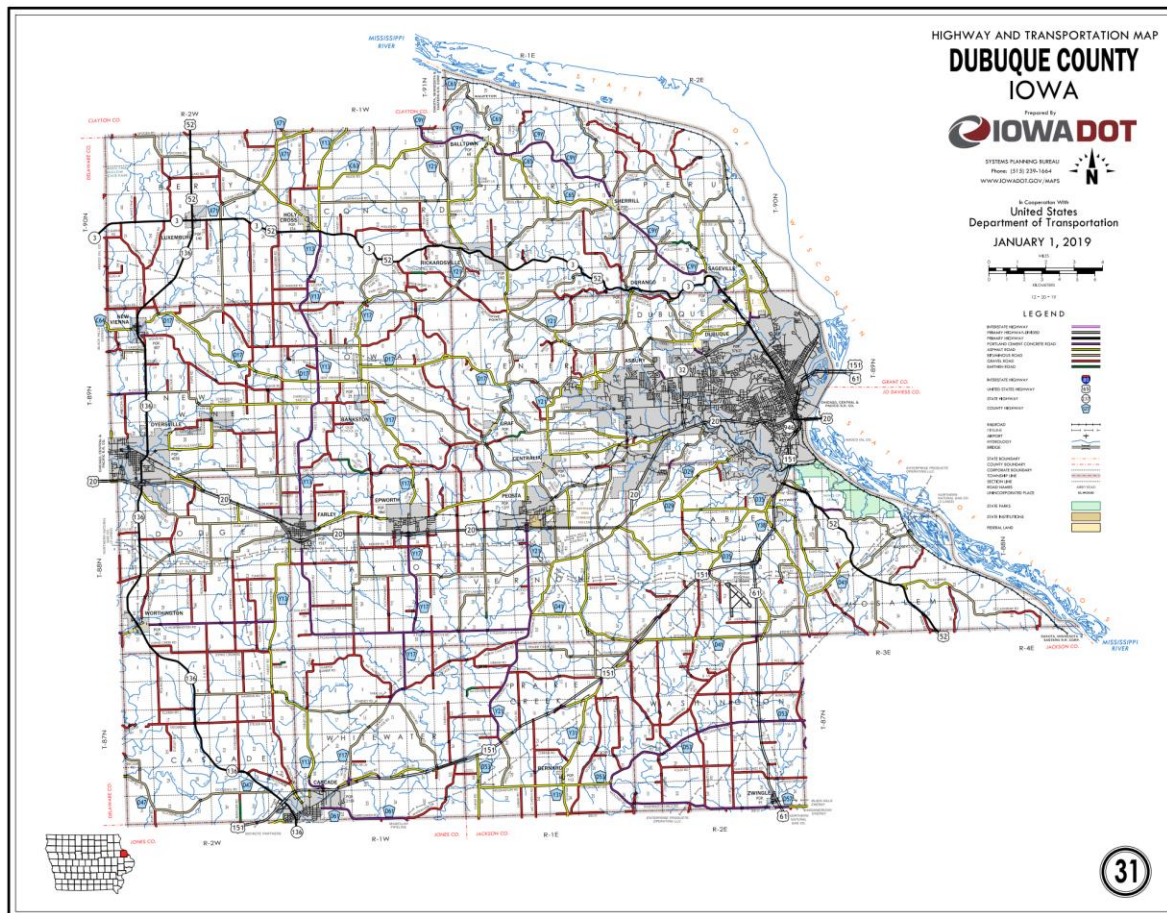

New Description – US 52 and its extensions in Dubuque County described as follows:

Beginning on the Dubuque–Jackson County line at a point approximately 1,700 feet west of the SE Corner of Section 35–T88N–R3E, Dubuque County (NE Corner of Section 2–T87N–R3E, Jackson County); thence in a northwesterly direction through Sections 35, 34, 27, 28, 21, 20, 21, 16, 17, 8, 7 and 6–T88N–R3E, and in a northwesterly direction in Section 1–T88N–R2E to a point approximately $\frac{1}{4}$ mile north of 0.4 mile west of the SE Corner of Section 1–T88N–R2E (south junction US 61 and US 151); thence southeast through Section 1–T88N–R02E to the north corporation line of the City of Dubuque.

Dubuque:

Beginning at the north corporation line; then southeast and south then northwest on SW Arterial to the west corporation line.

Beginning again at the west corporation line of the city of Dubuque; thence northwesterly through Sections 14, 11, 2, 3, 4 and 5–T88N–R02E; thence northwest through Section 32–T89N–R02E to the east corporation line of Dubuque.

Dubuque:

Beginning at the east corporation then northwest connecting with US 20; then southwesterly to the south corporation line.

Beginning again at the south corporation line of Dubuque; thence southwesterly through Sections 6 and 7–T88N–R02E; continuing southwest through Section 12–T88N–R01E; then west following substantially the section line of Sections 13, 14, and 15–T88N–R1E; thence continuing west through the south part of Section 12–T88N–R1W and Sections 7, 8, 9, and 10–T88N–R01E; thence continuing in an westerly direction through Sections 13, and 14–T88N–R01W to the east corporation line of Epworth.

Epworth:

Beginning at the east corporation line; thence east to the west corporation line.

Beginning again at the east corporation line of Epworth; thence west through Section 14-T88N-R1W to the east corporation line of Epworth.

Epworth:

Beginning at the east corporation line; thence west and northwesterly to the west corporation line.

Beginning again at the west corporation line of Epworth; thence west following substantially the section line of Sections 15, 16 and 17-T88N-R01W to the east corporation line of Farley.

Farley:

Beginning at the east corporation line; thence northwesterly, westerly, and northwesterly to the west corporation line.

Beginning again at the west corporation line of Farley; thence northwest along the south side of the Illinois Central Railroad and substantially parallel thereto through Sections 12, 11, 2, 3-T88N-R02W; thence northwest and west through Sections 4 and 5--T88N-R02W to the east corporation line of Dyersville.

Dyersville:

Beginning at the east corporation line, then west to the junction of Iowa 136, then north connecting with Iowa 136, then northeast and north to the north corporation line of Dyersville.

Beginning again on the north corporation line of Dyersville; thence in a northerly direction through the west part of Sections 29, 20, 17, and 8-T89N-R2W to the south corporation line of New Vienna connecting with Columbus Street.

New Vienna:

Beginning on Columbus Street at the south corporation line; thence northwest and north on Columbus Street to the north corporation line.

Beginning again on the north corporation line of the City of New Vienna connecting with Columbus Street; thence northeasterly through Section 5-T89N-R2W and Sections 32, 33, 28, 21, and 22-T90N-R2W to the south corporation line of the City of Luxemburg connecting with William Andre Street.

Luxemburg:

Beginning on William Andre Street at the south corporation line; thence north through the junction of Iowa 3 to the north corporation line.

Beginning again on the north corporation line of Luxemburg connecting with William Andre Street; thence north following substantially the section line of Sections 15, 10, and 3-T90N-R02W to the Dubuque-Clayton County line at a point near the NW Corner of Section 3-T90N-R02W, Dubuque County (SW Corner of Section 34-T91N-R2W, Clayton County).

OFFICIAL DESCRIPTION CHANGE

OFFICE: Research and Analytics

EFFECTIVE DATE: 6-14-2019

COUNTY: Dubuque

ROUTE: US 52

ENTERED BY: Paul Mauer

ENTERED DATE: 1-31-2020

New Description – US 52 and its extensions in Dubuque County described as follows:

Beginning on the Dubuque–Jackson County line at a point approximately 1,700 feet west of the SE Corner of Section 35–T88N–R3E, Dubuque County (NE Corner of Section 2–T87N–R3E, Jackson County); thence in a northwesterly direction through Sections 35, 34, 27, 28, 21, 20, 21, 16, 17, 8, 7 and 6–T88N–R3E, and in a northwesterly direction in Section 1–T88N–R2E to a point approximately $\frac{1}{4}$ mile north of 0.4 mile west of the SE Corner of Section 1–T88N–R2E (south junction US 61 and US 151); thence southeast through Section 1–T88N–R02E to the north corporation line of the City of Dubuque.

Dubuque:

Beginning at the north corporation line; then southeast and south to the south corporation line.

Beginning on Kerrigan Road at the south corporation line; thence north on Kerrigan Road to South Locust Street; thence northeast and north on unnamed street to 9th and 11th Street off ramp; thence northeast on off ramp (begin

one-way northbound) to 11th Street; thence southwesterly on 11th Street to White Street; thence northwesterly on White Street to 21st Street; thence southwesterly on 21st Street to Central Avenue (end one-way northbound); thence northwesterly on Central Avenue to the north corporation line.

Also

Beginning on Central Avenue at an intersection with 21st Street (begin one-way southbound); thence southeasterly on Central Avenue to East 9th Street; thence northwesterly on East 9th Street to southbound onramp; thence southbound to unnamed street (end one-way southbound).

Beginning on the north corporation line of Dubuque connecting with Central Avenue; thence in a northwesterly direction through Sections 11-T89N-R2E to the south corporation line of Sageville.

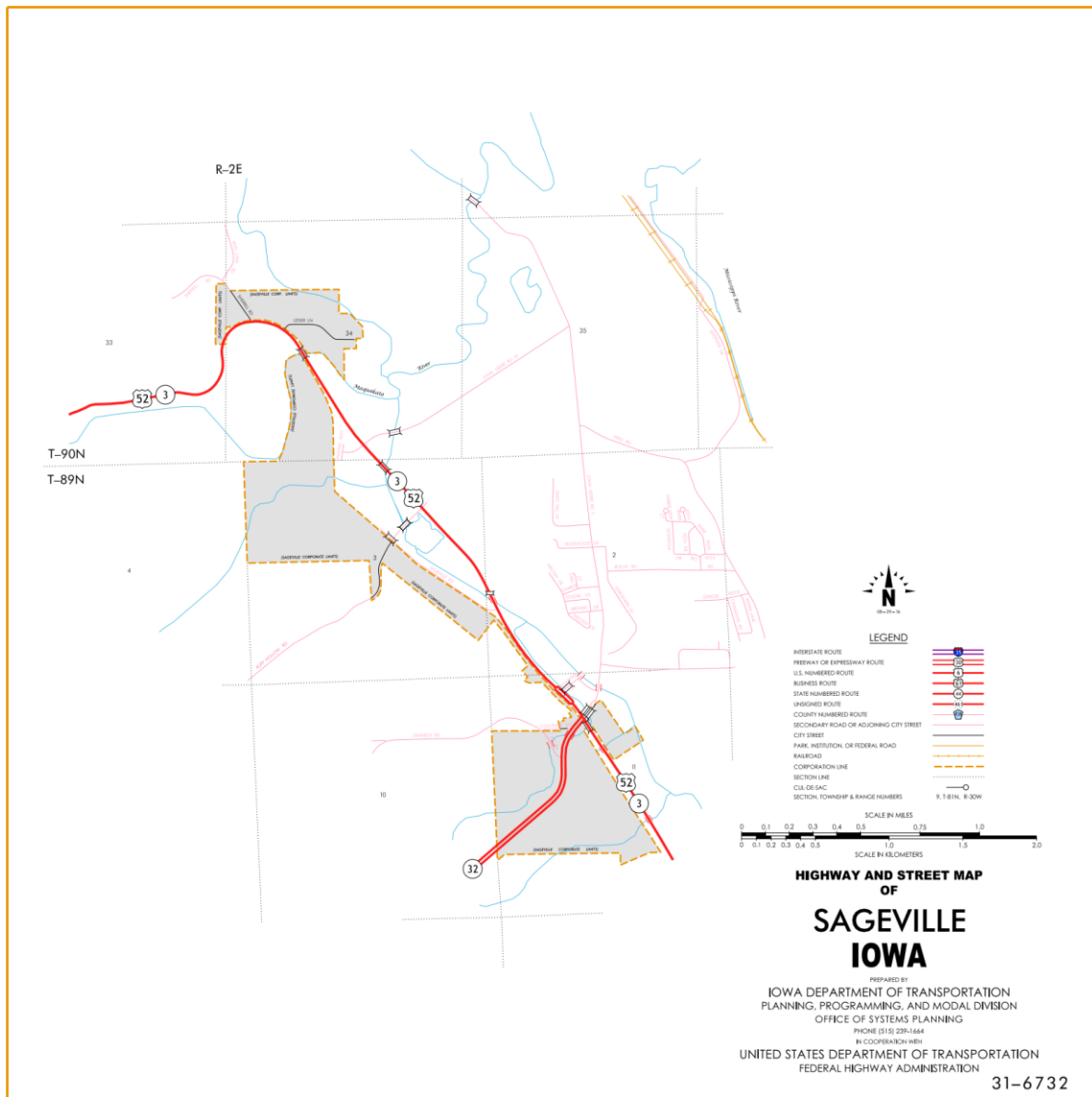

Sageville:

Beginning at the south corporation line then northwesterly to the north corporation line.

Beginning again at north corporation line of Sageville; thence in a northwesterly direction through Sections 11, 2 and 3-T89N-R2E, in a northwesterly and

southwesterly direction through Section 34-T90N-R2E to the east corporation line of Sageville.

Sageville:

Beginning at the east corporation line, then southwesterly to the south corporation line.

Beginning again at the south corporation line of Sageville; thence southwesterly through Section 33-T90N-R2E, and Sections 4 and 5-T89N-R2E to a point approximately 700 feet south and 700 feet west of the NE Corner of Section 5-T89N-R2E; thence in a northwesterly and westerly direction through Section 5-T89N-R2E and Sections 32 and 31-T90N-R2E to the east corporation line of Durango.

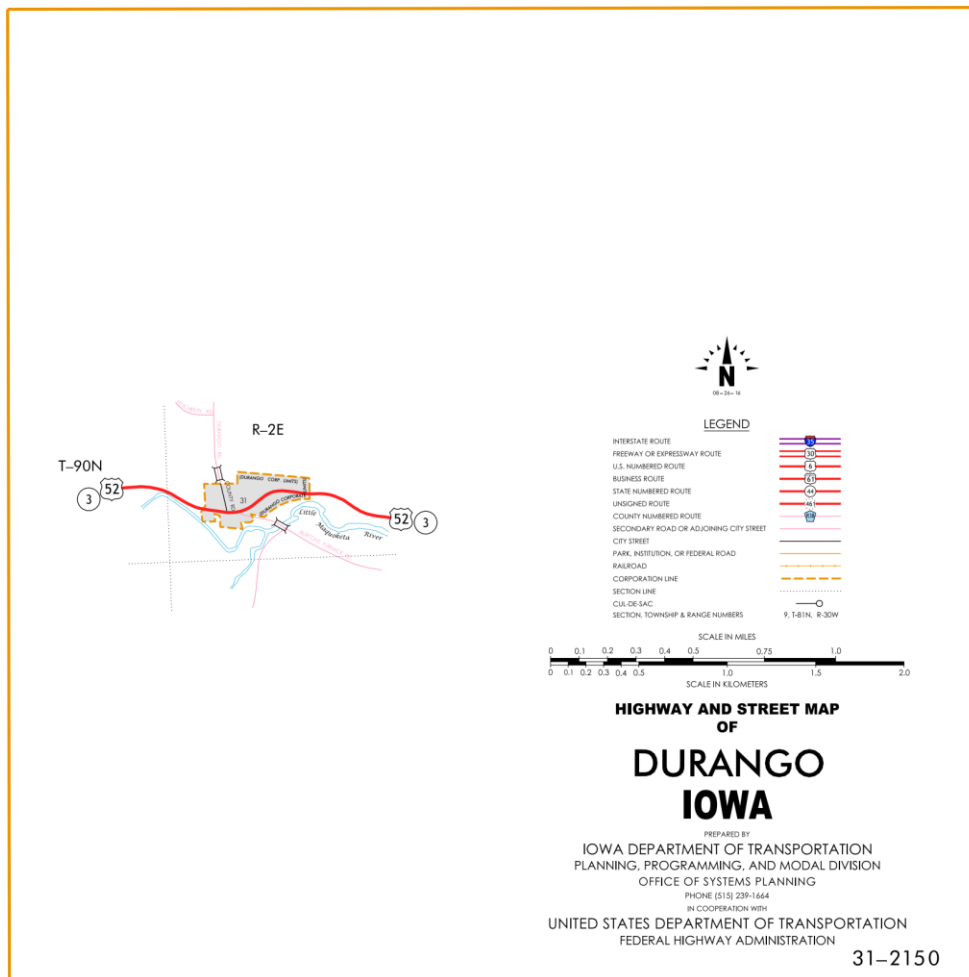

Durango:

Beginning at the east corporation line; thence westerly, southwesterly, and westerly to the west corporation line.

Beginning again on the west corporation line of Durango; thence in a northwesterly direction through Section 31-T90N-R2E and Sections 36, 35, 26, 27 and 28-T90N-R1E to the east corporation line of Rickardsville connecting with Main Street.

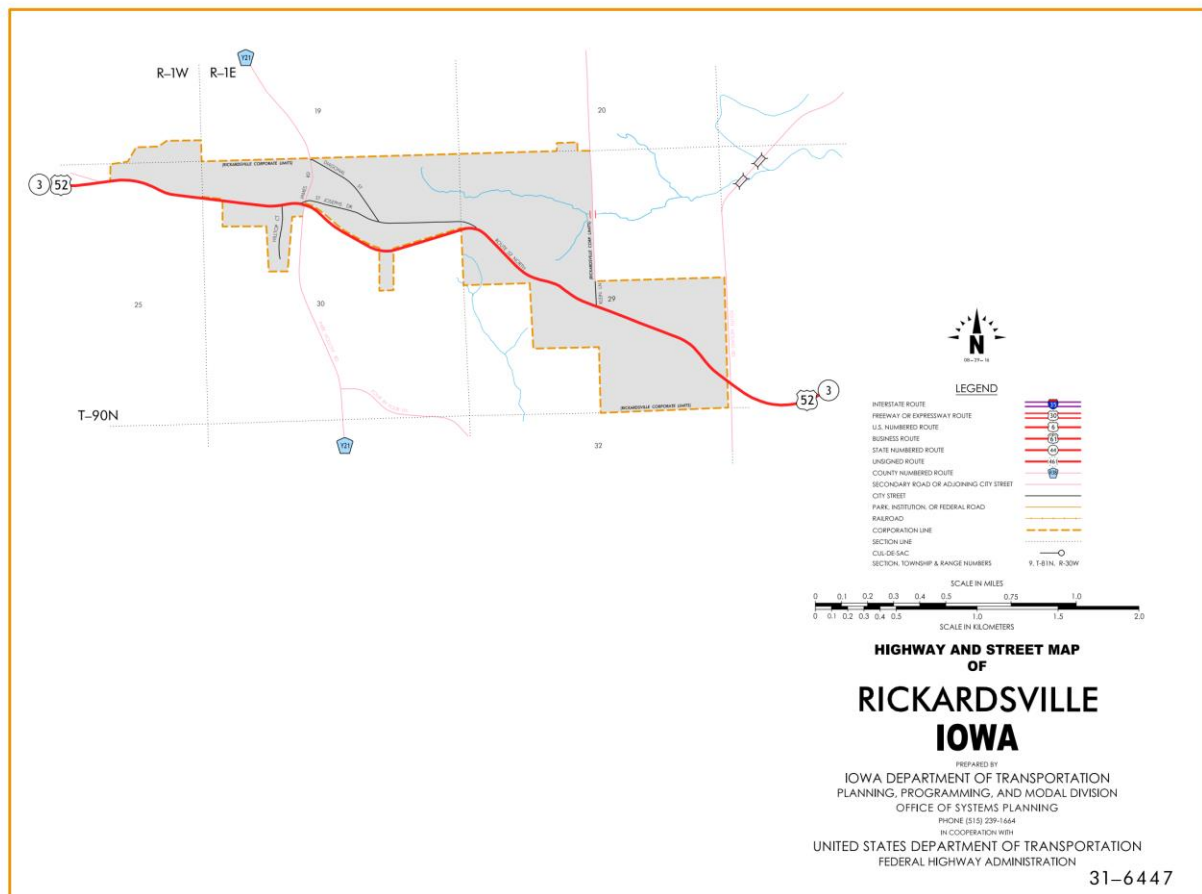

Rickardsville:

Beginning on Main Street at the east corporation line; thence westerly on Main Street to the west corporation line.

Beginning again on the west corporation line of Rickardsville connecting with Main Street; thence in a northwesterly direction through Sections 29 and 30-T90N-R1E to the east corporation line of Rickardsville connecting with Main Street.

Rickardsville:

Beginning again on Main Street at the east corporation line; thence westerly on Main Street to the west corporation line.

Beginning on the west corporation line of Rickardsville connecting with Main Street; thence in a westerly direction through Section 30-T90N-R1E to the west corporation line of Rickardsville.

Rickardsville:

Beginning at the east corporation line, then westerly to the west corporation line.

Beginning again at the west corporation line of Rickardsville; thence westerly and northwesterly through Sections 25, 26, 27, 28, 21 and 20-T90N-R1W to the east corporation line of Holy Cross.

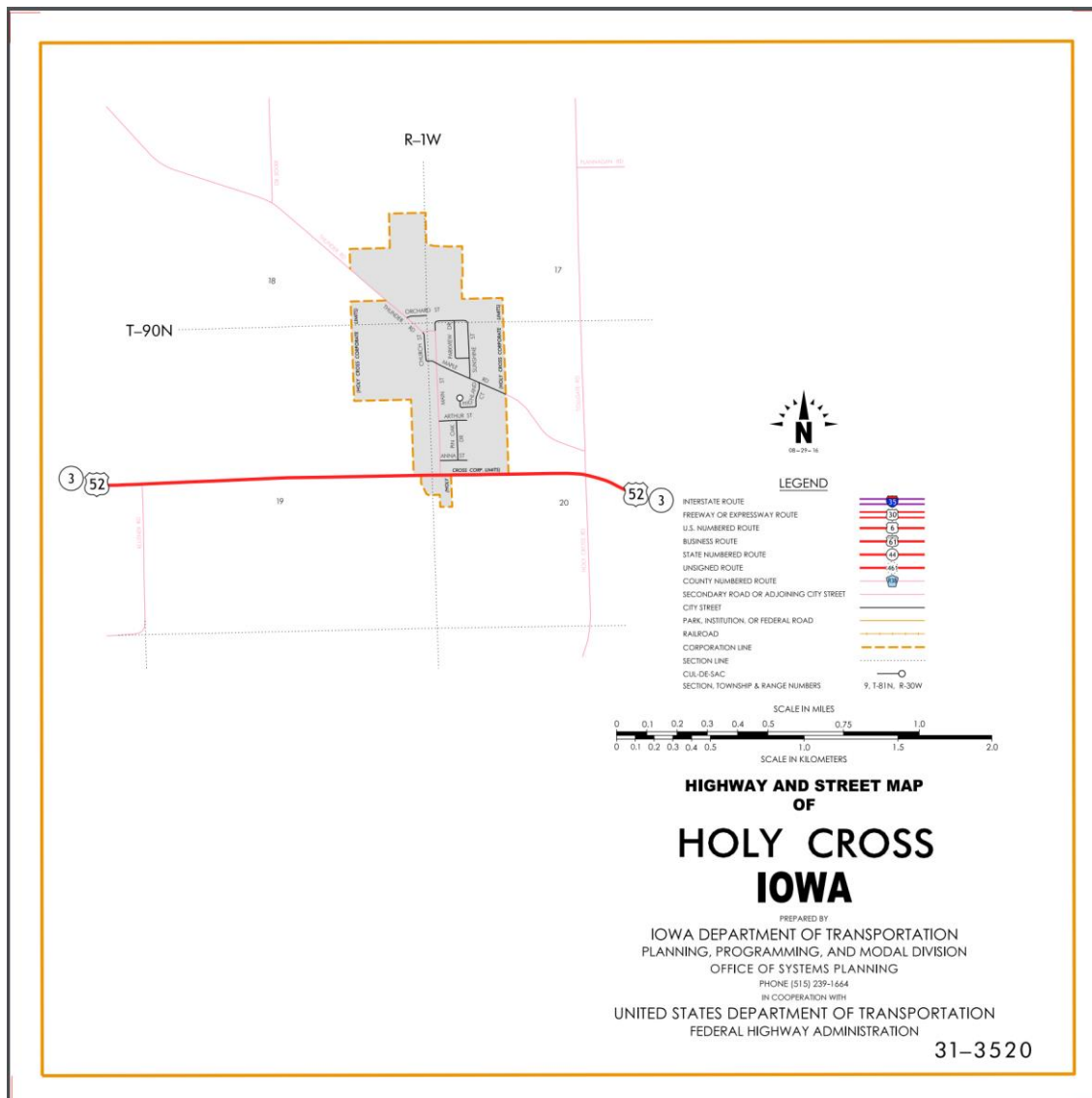

Holy Cross:

Beginning at the east corporation line, then west to the west corporation line.

Beginning again at the west corporation line of Holy Cross; thence west following substantially the center section line of Sections 19-T90N-R1W and Section 24-T90N-R2W to a point approximately 500 feet west of the E $\frac{1}{4}$ Corner of Section 24-T90N-R2W; thence in a northwesterly direction through Sections 24 and 23-T90N-R2W to a point approximately $\frac{1}{4}$ mile west of the NE Corner of Section 23-T90N-R2W; thence west following substantially the section line of

Sections 23 and 22–T90N–R2W to the east corporation line of Luxemburg connecting with Main Street.

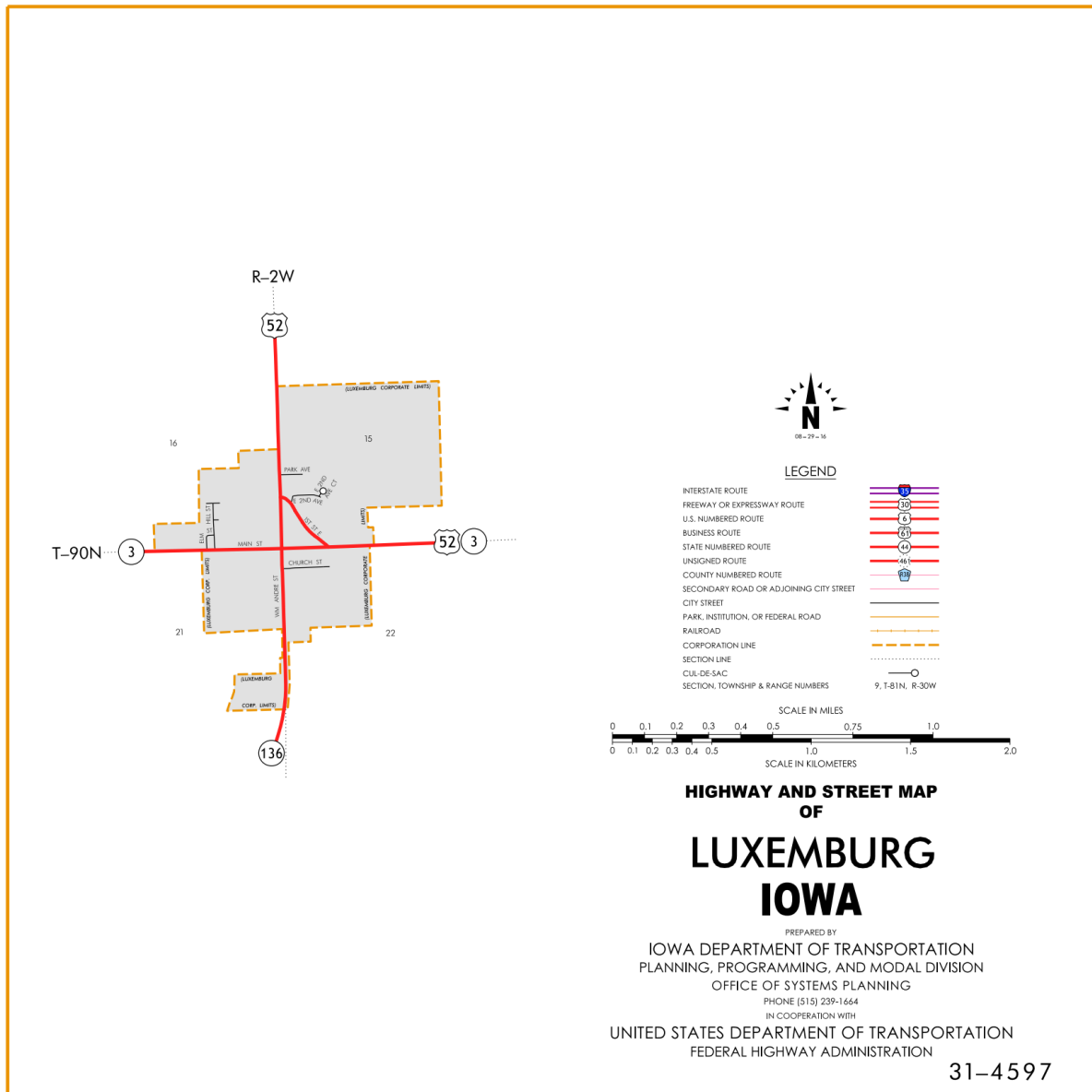

Luxemburg:

Beginning on Main Street at the east corporation line; thence west on Main

Street to William Andre Street; thence north on William Andre Street to the north corporation line.

Beginning again on the north corporation line of Luxemburg connecting with William Andre Street; thence north following substantially the section line of Sections 15, 10, and 3-T90N-R2W to the Dubuque-Clayton County line at a point near the NW Corner of Section 3-T90N-R2W, Dubuque County (SW Corner of Section 34-T91N-R2W, Clayton County).

Beginning on the Dubuque–Jackson County line at a point approximately 1,700 feet west of the SE Corner of Section 35–T88N–R3E, Dubuque County (NE Corner of Section 2–T87N–R3E, Jackson County); thence in a northwesterly direction through Sections 35, 34, 27, 28, 21, 20, 21, 16, 17, 8, 7 and 6–T88N–R3E, and in a northwesterly direction in Section 1–T88N–R2E to a point approximately $\frac{1}{4}$ mile north of 0.4 mile west of the SE Corner of Section 1–T88N–R2E (south junction US 61 and US 151); thence in a northeasterly and northerly direction through Section 1–T88N–R2E to the south corporation line of Dubuque connecting with Kerrigan Road.

Dubuque:

Beginning on Kerrigan Road at the south corporation line; thence north on Kerrigan Road to South Locust Street; thence northeast and north on unnamed street to 9th and 11th Street off ramp; thence northeast on off ramp (begin one-way northbound) to 11th Street; thence southwesterly on 11th Street to White Street; thence northwesterly on White Street to 21st Street; thence southwesterly on 21st Street to Central Avenue (end one-way northbound); thence northwesterly on Central Avenue to the north corporation line.

Also

Beginning on Central Avenue at an intersection with 21st Street (begin one-way southbound); thence southeasterly on Central Avenue to East 9th Street; thence northwesterly on East 9th Street to southbound onramp; thence southbound to unnamed street (end one-way southbound).

Beginning on the north corporation line of Dubuque connecting with Central Avenue; thence in a northwesterly direction through Sections 11, 2 and 3–T89N–R2E, in a northwesterly and southwesterly direction through Sections 34 and 33–T90N–R2E, and Sections 4 and 5–T89N–R2E to a point approximately 700 feet south and 700 feet west of the NE Corner of Section 5–T89N–R2E; thence in a northwesterly and westerly direction through Section 5–T89N–R2E

and Sections 32 and 31–T90N–R2E to the east corporation line of Durango connecting with an unnamed street.

Durango:

Beginning on an unnamed street at the east corporation line; thence westerly, southwesterly, and westerly on unnamed street to the west corporation line.

Beginning again on the west corporation line of Durango connecting with an unnamed street; thence in a northwesterly direction through Section 31–T90N–R2E and Sections 36, 35, 26, 27 and 28–T90N–R1E to the east corporation line of Rickardsville connecting with Main Street.

Rickardsville:

Beginning on Main Street at the east corporation line; thence westerly on Main Street to the west corporation line.

Beginning again on the west corporation line of Rickardsville connecting with Main Street; thence in a northwesterly direction through Sections 29 and 30–T90N–R1E to the east corporation line of Rickardsville connecting with Main Street.

Rickardsville:

Beginning again on Main Street at the east corporation line; thence westerly on Main Street to the west corporation line.

Beginning on the west corporation line of Rickardsville connecting with Main Street; thence in a westerly direction through Section 30–T90N–R1E and Section 25, 26, 27, 28, 21 and 20–T90N–R1W to a point near the center of Section 20–T90N–R1W; thence west following substantially the center section line of Sections 20 and 19–T90N–R1W and Section 24–T90N–R2W to a point approximately 500 feet west of the E ¼ Corner of Section 24–T90N–R2W;

thence in a northwesterly direction through Sections 24 and 23-T90N-R2W to a point approximately ¼ mile west of the NE Corner of Section 23-T90N-R2W; thence west following substantially the section line of Sections 23 and 22-T90N-R2W to the east corporation line of Luxemburg connecting with Main Street.

Luxemburg:

Beginning on Main Street at the east corporation line; thence west on Main Street to William Andre Street; thence north on William Andre Street to the north corporation line.

Beginning again on the north corporation line of Luxemburg connecting with William Andre Street; thence north following substantially the section line of Sections 15, 10, and 3-T90N-R2W to the Dubuque-Clayton County line at a point near the NW Corner of Section 3-T90N-R2W, Dubuque County (SW Corner of Section 34-T91N-R2W, Clayton County).

STAFF ACTION

OFFICE: Transportation Data

STAFF ACTION NUMBER: S-97-0511

SUBMITTED BY: Patrick R. Cain

SUBMITTAL DATE: 11-06-96

DISCUSSION/BACKGROUND:

Transfer of jurisdiction agreement number 96-TJ-001 between the Iowa Department of Transportation and the city of Dubuque transferred sections of 11th Street, White Street and 21st Street to the State on November 1, 1996. (City and State will have co-jurisdiction.)

PROPOSAL/ACTION RECOMMENDATION:

It is recommended that the old description of US 52 in Dubuque County be deleted from the Primary Road System and the new description, as described in the attachment, be included in the Primary Road System.

New Description – US 52 and its extensions in Dubuque County described as follows:

Beginning on the Dubuque–Jackson County line at a point approximately 1,700 feet west of the SE Corner of Section 35–T88N–R3E, Dubuque County (NE Corner of Section 2–T87N–R3E, Jackson County); thence in a northwesterly direction through Sections 35, 34, 27, 28, 21, 20, 21, 16, 17, 8, 7 and 6–T88N–R3E, and in a northwesterly direction in Section 1–T88N–R2E to a point approximately ¼ mile north of 0.4 mile west of the SE Corner of Section 1–T88N–R2E (south junction US 61 and US 151); thence in a northeasterly and northerly direction through Section 1–T88N–R2E to the south corporation line of Dubuque connecting with Kerrigan Road.

Dubuque:

Beginning on Kerrigan Road at the south corporation line; thence north on Kerrigan Road to South Locust Street; thence northeast and north on unnamed street to 9th and 11th Street off ramp; thence northeast on off ramp (begin one-way northbound) to 11th Street; thence southwesterly on 11th Street to White Street; thence northwesterly on White Street to 21st Street; thence southwesterly on 21st Street to Central Avenue (end one-way northbound); thence northwesterly on Central Avenue to the north corporation line.

Also

Beginning on Central Avenue at an intersection with 21st Street (begin one-way southbound); thence southeasterly on Central Avenue to East 9th Street; thence northwesterly on East 9th Street to southbound onramp; thence southbound to unnamed street (end one-way southbound).

Beginning on the north corporation line of Dubuque connecting with Central Avenue; thence in a northwesterly direction through Sections 11, 2 and 3-T89N-R2E, in a northwesterly and southwesterly direction through Sections 34 and 33-T90N-R2E, and Sections 4 and 5-T89N-R2E to a point approximately 700 feet south and 700 feet west of the NE Corner of Section 5-T89N-R2E; thence in a northwesterly and westerly direction through Section 5-T89N-R2E and Sections 32 and 31-T90N-R2E to the east corporation line of Durango connecting with an unnamed street.

Durango:

Beginning on an unnamed street at the east corporation line; thence westerly, southwesterly, and westerly on unnamed street to the west corporation line.

Beginning again on the west corporation line of Durango connecting with an unnamed street; thence in a northwesterly direction through Section 31-T90N-R2E and Sections 36, 35, 26, 27 and 28-T90N-R1E to the east corporation line of Rickardsville connecting with Main Street.

Rickardsville:

Beginning on Main Street at the east corporation line; thence westerly on Main Street to the west corporation line.

Beginning again on the west corporation line of Rickardsville connecting with Main Street; thence in a northwesterly direction through Sections 29 and 30-T90N-R1E to the east corporation line of Rickardsville connecting with Main Street.

Rickardsville:

Beginning again on Main Street at the east corporation line; thence westerly on Main Street to the west corporation line.

Beginning on the west corporation line of Rickardsville connecting with Main Street; thence in a westerly direction through Section 30-T90N-R1E and Section 25, 26, 27, 28, 21 and 20-T90N-R1W to a point near the center of Section 20-T90N-R1W; thence west following substantially the center section line of Sections 20 and 19-T90N-R1W and Section 24-T90N-R2W to a point approximately 500 feet west of the E $\frac{1}{4}$ Corner of Section 24-T90N-R2W; thence in a northwesterly direction through Sections 24 and 23-T90N-R2W to a point approximately $\frac{1}{4}$ mile west of the NE Corner of Section 23-T90N-R2W; thence west following substantially the section line of Sections 23 and 22-T90N-R2W to the east corporation line of Luxemburg connecting with Main Street.

Luxemburg:

Beginning on Main Street at the east corporation line; thence west on Main Street to William Andre Street; thence north on William Andre Street to the north corporation line.

Beginning again on the north corporation line of Luxemburg connecting with William Andre Street; thence north following substantially the section line of Sections 15, 10, and 3-T90N-R2W to the Dubuque-Clayton County line at a point near the NW Corner of Section 3-T90N-R2W, Dubuque County (SW Corner of Section 34-T91N-R2W, Clayton County).

STAFF ACTION

OFFICE: Transportation Data

STAFF ACTION NUMBER: S-96-1279

SUBMITTED BY: Patrick R. Cain

SUBMITTAL DATE: 2-14-96

DISCUSSION/BACKGROUND:

Due to the relocation of several routes in Dubuque in 1991, the routing for US 52 was revised and the official description in the Primary Road System should be revised to reflect this change.

PROPOSAL/ACTION RECOMMENDATION:

It is recommended that the old description of US 52 in Dubuque County be deleted from the Primary Road System and the new description, as described in the attachment, be included in the Primary Road System.

New Description – US 52 and its extensions in Dubuque County described as follows:

Beginning on the Dubuque–Jackson County line at a point approximately 1,700 feet west of the SE Corner of Section 35–T88N–R3E, Dubuque County (NE Corner of Section 2–T87N–R3E, Jackson County); thence in a northwesterly direction through Sections 35, 34, 27, 28, 21, 20, 21, 16, 17, 8, 7 and 6–T88N–R3E, and in a northwesterly direction in Section 1–T88N–R2E to a point approximately $\frac{1}{4}$ mile north of 0.4 mile west of the SE Corner of Section 1–T88N–R2E (south junction US 61 and US 151); thence in a northeasterly and northerly direction through Section 1–T88N–R2E to the south corporation line of Dubuque connecting with Kerrigan Road.

Dubuque:

Beginning on Kerrigan Road at the south corporation line; thence north on Kerrigan Road to South Locust Street; thence northeast and north on unnamed street to near 3rd Street; thence northeast (begin one-way northbound) to White Street; thence northwesterly on White Street to 21st Street; thence southwesterly on 21st Street to Central Avenue (end one-way northbound); thence northwesterly on Central Avenue to the north corporation line.

Also

Beginning on Central Avenue at an intersection with 21st Street (begin one-way southbound); thence southeasterly on Central Avenue to 4th Street; thence southwesterly on unnamed street to near 3rd street (end one-way southbound).

Beginning on the north corporation line of Dubuque connecting with Central Avenue; thence in a northwesterly direction through Sections 11, 2 and 3-T89N-R2E, in a northwesterly and southwesterly direction through Sections 34 and 33-T90N-R2E, and Sections 4 and 5-T89N-R2E to a point approximately 700 feet south and 700 feet west of the NE Corner of Section 5-T89N-R2E; thence in a northwesterly and westerly direction through Section 5-T89N-R2E and Sections 32 and 31-T90N-R2E to the east corporation line of Durango connecting with an unnamed street.

Durango:

Beginning on an unnamed street at the east corporation line; thence westerly, southwesterly, and westerly on unnamed street to the west corporation line.

Beginning again on the west corporation line of Durango connecting with an unnamed street; thence in a northwesterly direction through Section 31-T90N-R2E and Sections 36, 35, 26, 27 and 28-T90N-R1E to the east corporation line of Rickardsville connecting with Main Street.

Rickardsville:

Beginning on Main Street at the east corporation line; thence westerly on Main Street to the west corporation line.

Beginning again on the west corporation line of Rickardsville connecting with Main Street; thence in a northwesterly direction through Sections 29 and 30-T90N-R1E to the east corporation line of Rickardsville connecting with Main Street.

Rickardsville:

Beginning again on Main Street at the east corporation line; thence westerly on Main Street to the west corporation line.

Beginning on the west corporation line of Rickardsville connecting with Main Street; thence in a westerly direction through Section 30-T90N-R1E and Section 25, 26, 27, 28, 21 and 20-T90N-R1W to a point near the center of Section 20-T90N-R1W; thence west following substantially the center section line of Sections 20 and 19-T90N-R1W and Section 24-T90N-R2W to a point approximately 500 feet west of the E $\frac{1}{4}$ Corner of Section 24-T90N-R2W; thence in a northwesterly direction through Sections 24 and 23-T90N-R2W to a point approximately $\frac{1}{4}$ mile west of the NE Corner of Section 23-T90N-R2W; thence west following substantially the section line of Sections 23 and 22-T90N-R2W to the east corporation line of Luxemburg connecting with Main Street.

Luxemburg:

Beginning on Main Street at the east corporation line; thence west on Main Street to William Andre Street; thence north on William Andre Street to the north corporation line.

Beginning again on the north corporation line of Luxemburg connecting with William Andre Street; thence north following substantially the section line of Sections 15, 10, and 3-T90N-R2W to the Dubuque-Clayton County line at a point near the NW Corner of Section 3-T90N-R2W, Dubuque County (SW Corner of Section 34-T91N-R2W, Clayton County).

STAFF ACTION

OFFICE: Transportation Data

STAFF ACTION NUMBER: S-96-1237

SUBMITTED BY: Patrick R. Cain

SUBMITTAL DATE: 3-5-96

DISCUSSION/BACKGROUND:

Due to the relocation of US 52 in Dubuque in 1993, the official description in the Primary Road System should be revised to reflect this change.

Transfer of jurisdiction agreement number 93-TJ-004 between the Iowa Department of Transportation and the City of Dubuque transferred the section of Central Avenue to the city on October 8, 1993.

At the same time the section of White Street which was already the city's but being used by the Department of Transportation, was given back to the city.

PROPOSAL/ACTION RECOMMENDATION:

It is recommended that the old description of US 52 in Dubuque County be deleted from the Primary Road System and the new description, as described in the attachment, be included in the Primary Road System.

New Description – US 52 and its extensions in Dubuque County described as follows:

Beginning on the Dubuque–Jackson County line at a point approximately 1,700 feet west of the SE Corner of Section 35–T88N–R3E, Dubuque County (NE Corner of Section 2–T87N–R3E, Jackson County); thence in northwesterly direction through Sections 35, 34, 27, 28, 21, 20, 21, 16, 17, 8, 7 and 6–T88N–R3E, and in a northwesterly direction in Section 1–T88N–R2E to a point approximately $\frac{1}{4}$ mile north of 0.4 mile west of the SE Corner of Section 1–T88N–R2E; (south junction US 61 and US 151); thence in a northeasterly and northerly direction through Section 1–T88N–R2E to the south corporation line of Dubuque connecting with Kerrigan Road.

Dubuque:

Beginning on Kerrigan Road at the south corporation line; thence north on Kerrigan Road to South Locust Street; thence northeast and north on unnamed street to near E. 6th Street; thence northeast on off ramp (begin one-way northbound) to 11th Street; thence southwesterly on 11th Street to White Street; thence northwesterly on White Street to 21st Street; thence southwesterly on 21st Street to Central Avenue (end one-way northbound); thence northwesterly on Central Avenue to the north corporation line.

Also

Beginning on Central Avenue at an intersection with 21st Street (begin one-way southbound); thence southeasterly on Central Avenue to East 9th Street; thence northeasterly on East 9th Street to southbound onramp; thence southbound to unnamed street (end one-way southbound).

Beginning on the north corporation line of Dubuque connecting with Central Avenue; thence in a northwesterly direction through Sections 11, 2 and 3–T89N–R2E, in a northwesterly and southwesterly direction through Sections 34 and 33–T90N–R2E, and Sections 4 and 5–T89N–R2E to a point approximately

700 feet south and 700 feet west of the NE Corner of Section 5-T89N-R2E; thence in a northwesterly and westerly direction through Section 5-T89N-R2E and Sections 32 and 31-T90N-R2E to the east corporation line of Durango connecting with an unnamed street.

Durango:

Beginning on an unnamed street at the east corporation line; thence westerly, southwesterly, and westerly on unnamed street to the west corporation line.

Beginning again on the west corporation line of Durango connecting with an unnamed street; thence in a northwesterly direction through Section 31-T90N-R2E and Sections 36, 35, 26, 27 and 28-T90N-R1E to the east corporation line of Rickardsville connecting with Main Street.

Rickardsville:

Beginning on Main Street at the east corporation line; thence westerly on Main Street to the west corporation line.

Beginning again on the west corporation line of Rickardsville connecting with Main Street; thence in a northwesterly direction through Sections 29 and 30-T90N-R1E to the east corporation line of Rickardsville connecting with Main Street.

Rickardsville:

Beginning again on Main Street at the east corporation line; thence westerly on Main Street to the west corporation line.

Beginning on the west corporation line of Rickardsville connecting with Main Street; thence in a westerly direction through Section 30-T90N-R1E and Section 25, 26, 27, 28, 21 and 20-T90N-R1W to a point near the center of Section 20-T90N-R1W; thence west following substantially the center section line of

Sections 20 and 19–T90N–R1W and Section 24–T90N–R2W to a point approximately 500 feet west of the E ¼ Corner of Section 24–T90N–R2W; thence in a northwesterly direction through Sections 24 and 23–T90N–R2W to a point approximately ¼ mile west of the NE Corner of Section 23–T90N–R2W; thence west following substantially the section line of Sections 23 and 22–T90N–R2W to the east corporation line of Luxemburg connecting with Main Street.

Luxemburg:

Beginning on Main Street at the east corporation line; thence west on Main Street to William Andre Street; thence on William Andre Street to the north corporation line.

Beginning again on the north corporation line of Luxemburg connecting with William Andre Street; thence north following substantially the section line of Sections 15, 10 and 3–T90N–R2W to the Dubuque–Clayton County line at a point near the NW Corner of Section 3–T90N–R2W, Dubuque County (SW Corner of Section 34–T91N–R2W, Clayton County).

OFFICIAL DESCRIPTION CHANGE

COUNTY: Dubuque

ROUTE: US 52

STAFF ACTION NUMBER: S–87–718

APPROVAL DATE: 12–18–86

New Description – US 52 and its extensions in Dubuque County described as follows:

Beginning on the Dubuque–Jackson County line at a point approximately 1,700 feet west of the SE Corner of Section 35–T88N–R3E, Dubuque County (NE

Corner of Section 2-T87N-R3E, Jackson County); thence in a northwesterly direction through Sections 35, 34, 27, 28, 21, 20, 21, 16, 17, 8, 7, and 6-T88N-R3E, and in a northwesterly direction in Section 1-T88N-R2E to a point approximately $\frac{1}{4}$ mile north and 0.4 mile west of the SE Corner of Section 1-T88N-R2E; (south junction US 61 and US 151); thence in a northeasterly and northerly direction through Section 1-T88N-R2E to the south corporation line of Dubuque connecting with Kerrigan Road.

Dubuque:

Beginning on Kerrigan Road at the south corporation line; thence north on Kerrigan Road to South Locust Street; thence north on South Locust Street to Dodge Street; thence north (begin one way northbound) on Locust Street to 4th Street; thence east on 4th Street to White Street; thence northwesterly on White Street to 21st Street; thence southwesterly on 21st Street to Central Avenue; (end one way northbound); thence northwesterly on Central Avenue to the north corporation line.

Also with a spur

Beginning on Central Avenue at an intersection with 21st Street (begin one way southbound); thence southeasterly on Central Avenue to 5th Street; thence southwesterly on 5th Street to Bluff Street; thence southeasterly on Bluff Street to Dodge Street (US 20) (end one way southbound).

Beginning on the north corporation line of Dubuque connecting with Central Avenue; thence in a northwesterly direction through Sections 11, 2, and 3-T89N-R2E, in a northwesterly and southwesterly direction through Sections 34 and 33-T90N-R2E, and Sections 4 and 5-T89N-R2E to a point approximately 700 feet south and 700 feet west of the NE Corner of Section 5-T89N-R2E; thence in a northwesterly and westerly direction through Section 5-T89N-R2E and Sections 32 and 31-T90N-R2E to the east corporation line of Durango connecting with an unnamed street.

Durango:

Beginning on an unnamed street at the east corporation line; thence westerly, southwesterly, and westerly on unnamed street to the west corporation line.

Beginning again on the west corporation line of Durango connecting with an unnamed street; thence in a northwesterly direction through Section 31-T90N-R2E and Sections 36, 35, 26, 27, and 28-T90N-R1E to the east corporation line of Rickardsville connecting with Main Street.

Rickardsville:

Beginning on Main Street at the east corporation line; thence westerly on Main Street to the west corporation line.

Beginning again on the west corporation line of Rickardsville connecting with Main Street; thence in a northwesterly direction through Sections 29 and 30-T90N-R1E to the east corporation line of Rickardsville connecting with Main Street.

Rickardsville:

Beginning again on Main Street at the east corporation line; thence westerly on Main Street to the west corporation line.

Beginning again on the west corporation line of Rickardsville connecting with Main Street; thence in a westerly direction through Section 30-T90N-R1E and Section 25, 26, 27, 28, 21, and 20-T90N-R1W to a point near the center of Section 20-T90N-R1W; thence west following substantially the center section line of Seas. 20 and 19-T90N-R1W and Section 24-T90N-R2W to a point approximately 500 feet west of the E $\frac{1}{4}$ Corner of Section 24-T90N-R2W; thence in a northwesterly direction through Sections 24 and 23-T90N-R2W to a point approximately $\frac{1}{4}$ mile west of the NE Corner of Section 23-T90N-R2W; thence west following substantially the section line of Sections 23 and

22-T90N-R2W to the east corporation line of Luxemburg connecting with Main Street.

Luxemburg:

Beginning on Main Street at the east corporation line; thence west on Main Street to William Andre Street; thence north on William Andre Street to the north corporation line.

Beginning again on the north corporation line of Luxemburg connecting with William Andre Street; thence north following substantially the section line of Sections 15, 10, and 3-T90N-R2W to the Dubuque-Clayton county line at a point near the NW Corner of Section 3-T90N-R2W, Dubuque County (SW Corner of Section 34-T91N-R2W, Clayton County).

COMMISSION ORDER

DIVISION: Planning & Research

COMMISSION ORDER NUMBER: PR-82-747

SUBMITTED BY: Patrick R. Cain

MEETING DATE: 6-8-82

DISCUSSION/BACKGROUND:

In Dubuque County, US 52 begins at the Jackson County line approximately eight miles southeast of the City of Dubuque, and travels generally northwesterly via the cities of Dubuque, Durango, Rickardsville and Luxemburg to the Clayton County line approximately three miles north of the City of Luxemburg.

The official description for US 52 in Dubuque County was found to be incorrect in our official records. The existing description should be replaced with the corrected version.

PROPOSAL/ACTION RECOMMENDATION:

It is recommended the commission approve deleting the present description of US 52 in Dubuque County from the primary road system and approve including the attached new description of US 52 in the primary road system.

Locate US 52 and its extensions in Dubuque County as follows:

Beginning on the Dubuque–Jackson County line at a point approximately 1,700 feet west of the SE Corner of Section 35–T88N–R3E, Dubuque County (NE Corner of Section 2–T87N–R3E, Jackson County); thence in a northwesterly direction through Sections 35, 34, 27, 28, 21, 20, 21, 16, 17, 8, 7, and 6–T88N–R3E, and in a northwesterly direction in Section 1–T88N–R2E to a point approximately $\frac{1}{4}$ mile north and 0.4 mile west of the SE Corner of Section 1–T88N–R2E; (south junction US 61 and US 151); thence in a northeasterly and northerly direction through Section 1–T88N–R2E to the south corporation line of the City of Dubuque connecting with an unnamed street.

Dubuque:

Beginning at the south corporation line connecting with an unnamed street; thence northerly, northwesterly, northeasterly, and northwesterly to the north corporation line connecting with an unnamed street.

Also with a spur

Beginning at the intersection of Central Avenue and East 21st Street (begin one way southbound); thence southeasterly, southwesterly, and southeasterly to Dodge Street (end of one way southbound).

Beginning on the north corporation line of the City of Dubuque connecting with an unnamed street; thence in a northwesterly direction through Sections 11, 2, and 3-T89N-R2E, in a northwesterly and southwesterly direction through Sections 34 and 33-T90N-R2E, and Sections 4 and 5-T89N-R2E to a point approximately 700 feet south and 700 feet west of the NE Corner of Section 5-T89N-R2E; thence in a northwesterly and westerly direction through Section 5-T89N-R2E and Sections 32 and 31-T90N-R2E to the east corporation line of the City of Durango connecting with an unnamed street.

Durango:

Beginning at the east corporation line connecting with an unnamed street; thence westerly, southwesterly, and westerly to the west corporation line connecting with an unnamed street.

Beginning again on the west corporation line of the City of Durango connecting with an unnamed street; thence in a northwesterly direction through Section 31-T90N-R2E and Sections 36, 35, 26, 27, and 28-T90N-R1E to the east corporation line of the City of Rickardsville connecting with an unnamed street.

Rickardsville:

Beginning on the east corporation line connecting with an unnamed street; thence westerly to the west corporation line connecting with an unnamed street.

Beginning again on the west corporation line of the City of Rickardsville connecting with an unnamed street; thence in a northwesterly direction through Sections 29 and 30-T90N-R1E to the east corporation line of the City of Rickardsville connecting with an unnamed street.

Rickardsville:

Beginning again on the east corporation line connecting with an unnamed street; thence westerly to the west corporation line connecting with an unnamed street.

Beginning again on the west corporation line of the City of Rickardsville connecting with an unnamed street; thence in a westerly direction through Section 30-T90N-R1E and Sections 25, 26, 27, 28, 21, and 20-T90N-R1W to a point near the center of Section 20-T90N-R1W; thence west following substantially the center section line of Sections 20 and 19-T90N-R1W and Section 24-T90N-R2W to a point approximately 500 feet west of the E $\frac{1}{4}$ Corner of Section 24-T90N-R2W; thence in a northwesterly direction through Sections 24 and 23-T90N-R2W to a point approximately $\frac{1}{4}$ mile west of the NE Corner of Section 23-T90N-R2W; thence west following substantially the section line of Sections 23 and 22-T90N-R2W to the east corporation line of the City of Luxemburg connecting with an unnamed street.

Luxemburg:

Beginning at the east corporation line connecting with an unnamed street; thence westerly and northerly to the north corporation line connecting with an unnamed street.

Beginning again on the north corporation line of the City of Luxemburg connecting with an unnamed street; thence north following substantially the section line of Sections 15, 10, and 3-T90N-R2W to the Dubuque-Clayton county line at a point near the NW Corner of Section 3-T90N-R2W; Dubuque County (SW Corner of Section 34-T91N-R2W, Clayton County).

REVISED: 12-18-86

COMMISSION ORDER

DIVISION: Planning & Research

COMMISSION ORDER NUMBER: PR-79-272

SUBMITTED BY: C.I. MacGillivray

MEETING DATE: 11-2-78

DISCUSSION/BACKGROUND:

Due to a review of our Primary Road System records, US 52 in Dubuque County should be deleted, and the new description added should be officially included into the Primary Road System.

US 52 begins at the Dubuque-Jackson County line approximately 8 miles southeast of Dubuque and travels in a northwesterly direction to the Dubuque-Delaware County line approximately 2 ½ miles north of Luxemburg via the Cities of Dubuque, Durango, Rickardsville, and Luxemburg, Iowa.

PROPOSAL/ACTION RECOMMENDATION:

Locate US 52 and its extensions in Dubuque County as follows:

Beginning on the Dubuque-Jackson County line at a point approximately 1,700 feet west of the SE Corner of Section 35-T88N-R3E, Dubuque County (NE Corner of Section 2-T87N-R3E, Jackson County); thence in a northwesterly direction through Sections 35, 34, 27, 28, 21, 20, 17, 8, 7, and 6-T88N-R3E, and in a northwesterly direction in Section 1-T88N-R2E to a point approximately ¼ mile north and 0.4 mile west of the SE Corner of Section 1-T88N-R2E; thence in a northeasterly and northerly direction through Section 1-T88N-R2E to the south corporation line of the City of Dubuque connecting with an unnamed street.

Dubuque:

Beginning at the south corporation line connecting with an unnamed street; thence northerly, northwesterly, northeasterly and northwesterly to the north corporation line connecting with an unnamed street.

Also with a spur

Beginning at the intersection of Central Avenue and East 21st Street (begin one way southbound); thence southeasterly, southwesterly, and southeasterly to Dodge Street (end of one way southbound).

Beginning on the north corporation line of the City of Dubuque connecting with an unnamed street; thence in a northwesterly direction through Sections 11, 2, and 3-T89N-R2E, in a northwesterly and southwesterly direction through Sections 34 and 33-T90N-R2E, and Section 5-T89N-R2E to a point approximately 700 feet south and 700 feet west of the NE Corner of Section 5-T89N-R2E; thence in a northwesterly and westerly direction through Section 5-T89N-R2E and Sections 32 and 31-T90N-R2E to the east corporation line of the City of Durango connecting with an unnamed street.

Durango:

Beginning at the east corporation line connecting with an unnamed street; thence westerly, southwesterly, and westerly to the west corporation line connecting with an unnamed street.

Beginning again on the west corporation line of the City of Durango connecting with an unnamed street; thence in a northwesterly direction through Section 31-T90N-R2E and Sections 36, 35, 26, 27, and 28-T90N-R1E to the east corporation line of the City of Rickardsville connecting with an unnamed street.

Rickardsville:

Beginning on the east corporation line connecting with an unnamed street thence westerly to the west corporation line connecting with an unnamed street.

Beginning again on the west corporation line of the City of Rickardsville connecting with an unnamed street; thence in a southwesterly and northwesterly direction to the east corporation line of the City of Rickardsville connecting with an unnamed street.

Rickardsville:

Beginning again on the east corporation line connecting with an unnamed street; thence westerly to the west corporation line connecting with an unnamed street.

Beginning again on the west corporation line of the City of Rickardsville connecting with an unnamed street; thence in a westerly direction through Section 30-T90N-R1E and Sections 25, 26, 27, 28, 21, and 20-T90N-R1W to a point near the center of Section 20-T90N-R1W; thence west following substantially the center section line of Sections 20 and 19-T90N-R1W and Section 24-T90N-R2W to a point approximately 500 feet west of the E $\frac{1}{4}$ Corner of Section 24-T90N-R2W; thence in a northwesterly direction through Sections 24 and 23-T90N-R2W to a point approximately $\frac{1}{4}$ mile west of the NE Corner of Section 23-T90N-R2W; thence west following substantially the section line of Sections 23 and 22-T90N-R2W to the east corporation line of the City of Luxemburg connecting with an unnamed street.

Luxemburg:

Beginning at the east corporation line connecting with an unnamed street; thence westerly and northerly to the north corporation line connecting with an unnamed street.

Beginning again on the north corporation line of the City of Luxemburg connecting with an unnamed street; thence north following substantially the section line of Sections 15, 10, and 3-T90N-R2W to the Dubuque-Clayton County line at a point near the NW Corner of Section 3-T90N-R2W, Dubuque County (SW Corner of Section 34-T91N-R2W, Clayton County).

NOW, THEREFORE: Be it resolved that the Iowa Department of Transportation approve the location of US 52, in Dubuque County, Iowa.

NOTE: To become effective upon the adoption of this resolution.

COMMISSION ORDER

DIVISION: Planning & Research

SUBMITTED BY: Raymond L. Kassel

MEETING DATE: 10-5-76

DISCUSSION/BACKGROUND:

Due to a review of our Primary Road System records, US 52 in Dubuque County should be deleted, and the new description added should be officially included into the Primary Road System.

US 52 begins at the Dubuque-Jackson County line approximately 8 miles southeast of Dubuque and travels in a northwesterly direction to the Dubuque-Delaware County line approximately 2 ½ miles north of Luxemburg via the Cities of Dubuque, Durango, Rickardsville, and Luxemburg, Iowa.

PROPOSAL/ACTION RECOMMENDATION:

Locate US 52 and its extensions in Dubuque County as follows:

Beginning on the Dubuque–Jackson County line at a point approximately 1,700 feet west of the SE Corner of Section 35–T88N–R3E, Dubuque County (NE Corner of Section 2–T87N–R3E, Jackson County); thence in a northwesterly direction through Sections 35, 34, 27, 28, 21, 20, 17, 8, 7, and 6–T88N–R3E, and in a northwesterly direction in Section 1–T88N–R2E to a point approximately $\frac{1}{4}$ mile north and 0.4 mile west of the SE Corner of Section 1–T88N–R2E; thence in a northeasterly and northerly direction through Section 1–T88N–R2E to the south corporation line of the City of Dubuque connecting with an unnamed street.

Dubuque:

Beginning at the south corporation line connecting with an unnamed street; thence northerly, northwesterly, northeasterly, and northwesterly to the north corporation line connecting with an unnamed street.

Also with a spur

Beginning at the intersection of Central Avenue and East 21st Street (begin one way southbound); thence southeasterly, southwesterly, and southeasterly to Dodge Street (end of one way southbound).

Beginning on the north corporation line of the City of Dubuque connecting with an unnamed street; thence in a northwesterly direction through Sections 11, 2, and 3–T89N–R2E, in a northwesterly and southwesterly direction through Sections 34 and 33–T90N–R2E, and Section 5–T89N–R2E to a point approximately 700 feet south and 700 feet west of the NE Corner of Section 5–T89N–R2E; thence in a northwesterly and westerly direction through Section 5–T89N–R2E and Sections 32 and 31–T90N–R2E to the east corporation line of the City of Durango connecting with an unnamed street.

Durango:

Beginning at the east corporation line connecting with an unnamed street; thence westerly, southwesterly, and westerly to the west corporation line connecting with an unnamed street.

Beginning again on the west corporation line of the City of Durango connecting with an unnamed street; thence in a northwesterly direction through Section 31-T90N-R2E and Sections 36, 35, 26, 27, and 28-T90N-R1E to the east corporation line of the City of Rickardsville connecting with an unnamed street.

Rickardsville:

Beginning on the east corporation line connecting with an unnamed street thence westerly to the west corporation line connecting with an unnamed street.

Beginning again on the west corporation line of the City of Rickardsville connecting with an unnamed street; thence in a southwesterly and northwesterly direction to the east corporation line of the City of Rickardsville connecting with an unnamed street.

Rickardsville:

Beginning again on the east corporation line connecting with an unnamed street; thence westerly to the west corporation line connecting with an unnamed street.

Beginning again on the west corporation line of the City of Rickardsville connecting with an unnamed street; thence in a westerly direction through Section 30-T90N-R1E and Sections 25, 26, 27, 28, 21, and 20-T90N-R1W to a point near the center of Section 20-T90N-R1W; thence west following substantially the center section line of Sections 20 and 19-T90N-R1W and Section 24-T90N-R2W to a point approximately 500 feet west of the E ¼ Corner of Section 24-T90N-R2W; thence in a

northwesterly direction through Sections 24 and 23-T90N-R2W to a point approximately ¼ mile west of the NE Corner of Section 23-T90N-R2W; thence west following substantially the section line of Sections 23 and 22-T90N-R2W to the east corporation line of the City of Luxemburg connecting with an unnamed street.

Luxemburg:

Beginning at the east corporation line connecting with an unnamed street; thence westerly and northerly to the north corporation line connecting with an unnamed street.

Beginning again on the north corporation line of the City of Luxemburg connecting with an unnamed street; thence north following substantially the section line of Sections 15, 10, and 3-T90N-R2W to the Dubuque-Clayton County line at a point near the NW Corner of Section 3-T90N-R2W, Dubuque County (SW Corner of Section 34-T91N-R2W, Clayton County).

NOW, THEREFORE: Be it resolved that the Iowa Department of Transportation approve the location of US 52 in Dubuque County, Iowa.

NOTE: To become effective upon the adoption of this resolution.

COMMISSION ORDER

DIVISION: Planning & Research

COMMISSION ORDER NUMBER: pr-76-405

SUBMITTED BY: Raymond L. Kassel

MEETING DATE: 3-9-76

DISCUSSION/BACKGROUND:

US 52 was relocated north of Dubuque. The new alignment of US 52 in Dubuque County should be officially included in the State Primary System. In accord with the project agreement with the Dubuque County Board of Supervisors, disposition of sections of the old alignment should be made.

PROPOSAL/ACTION RECOMMENDATION:

Locate US 52 and its extensions in Dubuque County as follows:

Beginning on the Dubuque–Jackson County line at a point approximately 1,700 feet west of the SE Corner of Section 35–T88N–R3E Dubuque County (NE Corner of Section 2–T87N–R3E Jackson County); thence in a northwesterly direction through Sections 35, 34, 27, 28, 21, 20, 17, 8, 7, and 6–T88N–R3E; and in a northwesterly direction in Section 1–T86N–R2E to a point approximately ¼ mile north and 0.4 mile west of the SE Corner of Section 1–T88N–R2E; thence in a northeasterly and northerly direction to the south corporation line of the City of Dubuque connecting with Kerrigan Road.

Beginning on the north corporation line of the City of Dubuque connecting with Central Avenue; thence in a northwesterly direction through Sections 11, 2 and 3–T89N–R2E, in a northwesterly and southwesterly direction through Sections 34 and 33–T90N–R2E, to a point approximately 700 feet south and 700 feet west of the NE Corner of Section 5–T89N–R2E; thence in a northwesterly and westerly direction along the north side of the Chicago, Great Western Railroad and substantially parallel thereto through Section 5–T89N–R2E and Sections 32 and 31–T90N–R2E to the east corporation line of the City of Durango connecting with an unnamed street.

Beginning again on the west corporation line of the City of Durango connecting with an unnamed street; thence in a northwesterly direction through Section 31–T90N–R2E and Sections 36, 35, 26, 27, and

28-T90N-R1E to the east corporation line of the Town of Rickardsville connecting with Main Street.

Beginning again on the west corporation line of the City of Rickardsville connecting with Main Street; thence in a southwesterly and northwesterly direction to the east corporation line of the Town of Rickardsville connecting with Main Street.

Beginning again on the west corporation line of the City of Rickardsville; thence in a westerly direction through Sections 25, 26, 27, 28, 21, and 20-T90N-R1W to a point near the center of Section 20-T90N-R1W; thence west following substantially the quarter section line to a point approximately 500 feet west of the E $\frac{1}{4}$ Corner of Section 24-T90N-R2W; thence in a northwesterly direction to a point approximately $\frac{1}{4}$ mile west of the NE Corner of Section 23-T90N-R2W; thence west following substantially the section line to the east corporation line of the Town of Luxemburg connecting with Main Street.

Beginning again on the north corporation line of the City of Luxemburg connecting with William Andre Street; thence north following substantially the section line to the Dubuque-Clayton County line at a point near the NW Corner of Section 3-T90N-R2W Dubuque County (SW Corner of Section 34-T91N-R2W Clayton County).

Dubuque:

Beginning on Kerrigan Road at the south corporation line; thence northerly on Kerrigan Road to South Locust Street; thence northerly on South Locust Street to Dodge Street; thence northerly (begin one way north-bound) on Locust Street to Fourth Street; thence easterly on Fourth Street to White Street; thence northwesterly on White Street to 21st Street; thence southwesterly on 21st Street to Central Avenue; (end one way northbound); thence northwesterly on Central Avenue to the north corporation line.

Beginning on the north corporation connecting with Central Avenue; thence southeasterly on Central Avenue to 21st Street (begin one way southbound); thence continuing southeasterly on Central Avenue to 5th Street; thence southwesterly on 5th Street to Bluff Street; thence southeasterly on Bluff Street to Dodge Street (US 20)(end one way southbound).

Rickardsville:

Commencing on Main Street on the east corporation line; thence westerly on Main Street to the west corporation line.

Beginning again on Main Street on the east corporation line; thence westerly on Main Street to the west corporation line.

Luxemburg:

Beginning on Main Street at the east corporation line; thence west on Main Street to William Andre Street; thence north on William Andre Street to the north corporation line.

NOW, THEREFORE: Be it resolved that the Iowa Department of Transportation approve the location of US 52 and its extension in Dubuque County, Iowa.

NOTE: In accordance with the agreement signed by the Dubuque County Board of Supervisors, dated September 3, 1974, two sections of Old US 52, the first from approximately 300 feet north of the intersection with Rupp Road southerly approximately six tenths (0.6) of a mile to the connection of Old US 52 with New US 52, the second, a short 500-foot section of Old US 52 just west of the north junction of Iowa 386 and New US 52 will revert to the Dubuque County Secondary System. This is to become effective upon adoption of this resolution.

COMMISSION RESOLUTION

DIVISION: Planning & Research

COMMISSION ORDER NUMBER: 67-1634

SUBMITTED BY: Raymond L. Kassel

MEETING DATE: 11-8-67

Locate US 52 in Dubuque County as follows:

Dubuque:

Beginning at the intersection of Dodge and Locust Streets; thence northerly on Locust Street to Fourth Street; thence easterly on Fourth Street to Central Avenue; thence northwesterly on Central Avenue to the north corporation line.

Beginning on the north corporation line of the City of Dubuque connecting with Central Avenue; thence in a northwesterly direction through Sees. 11, 2 and 3-T89N-R2E, in a northwesterly and southwesterly direction through Sections 34 and 33-T90N-R2E, to a point approximately 700 feet south and 700 feet west of the NE Corner of Section 5-T89N-R2E; thence in a northwesterly and westerly direction along the north side of the Chicago, Great Western Railroad and substantially parallel thereto through Section 5-T89N-R2E and Section 32 and 31-T90N-R2E to the east corporation line of the Town of Durango connecting with an unnamed street.

Durango:

Beginning on an unnamed street at the east corporation line; thence westerly, southwesterly, and westerly on said unnamed street to the west corporation line.

Beginning again on the west corporation line of the Town of Durango connecting with an unnamed street at a point approximately 800 feet east and 900 feet north of the SW Corner of Section 31-T90N-R2E; thence in a westerly direction through Section 31-T90N-R2E, Sections 36, 35, 26, 27, 28, 29 and 30-T90N-R1E and Sections 25, 26, 27, 28, 21 and 20-T90N-R1W to a point near the center of Section 20-T90N-R1W; thence west following substantially the quarter section line to a point approximately 500 feet west of the E $\frac{1}{4}$ Corner of Section 24-T90N-R2W; thence in a northwesterly direction to a point approximately $\frac{1}{4}$ mile west of the NE Corner of Section 23-T90N-R2W; thence west following substantially the section line to the east corporation line of the Town of Luxemburg connecting with Main Street.

Luxemburg:

Beginning on the east corporation line connecting with Main Street; thence westerly on Main Street approximately 235 feet; thence northwesterly on an unnamed street to William Andre Street; thence northerly on William Andre Street to the north corporation line.