

**ENTERED DATE: 11-8-2019**

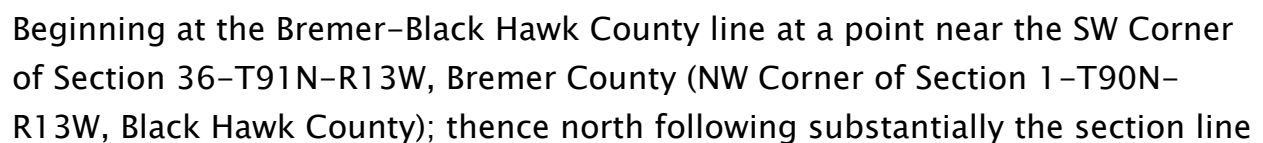

of Sections 36 and 25-T91N-R13W to the W ¼ Corner SW ¼ Section 25-T91N-R13W; thence northwesterly through Section 26-T91N-R13W to the south corporation line of Denver.

Denver:

Beginning at the south corporation line; thence northwesterly, northerly and northeasterly to the north corporation line.

Beginning again at the north corporation line of Denver: then northeasterly through Section 23-T91N-R13W to near W ¼ Corner NW ¼ Section 24-T91N-R13W; thence north following substantially the section line of Sections 24, 13, 12 (junction of Iowa 3) and 1-T91N-R13W continuing north following substantially the section line of Sections 36, 25, 24, 13, 12 (junction of Iowa 93) and 1-T92N-R13W continuing north following substantially the section line of Sections 36, 25 (junction of Iowa 188) 24, 13, 12-T93N-R13W; thence curving northeasterly along Sections 12 and 1-T93N-R13W and north along Section 6-T93N-R12W to the NW Corner of Section 6-T93N-R12W, Bremer County (SE Corner of Section 36-T94N-R13W, Chickasaw County).

#### **STAFF ACTION**

**OFFICE:** Transportation Data

**STAFF ACTION NUMBER:** S-96-1229

**SUBMITTED BY:** Patrick R. Cain

**SUBMITTAL DATE:** 2-9-96

#### **DISCUSSION/BACKGROUND:**

Due to the relocation of US 63 in the Denver area in 1994, the present description of US 63 in Bremer County should be deleted and changed to include the relocated portion of US 63.

#### **PROPOSAL/ACTION RECOMMENDATION:**

It is recommended to approve deleting the present road system and approve including the attached new description of US 63 in the Primary Road System.

New Description – US 63 and its extensions in Bremer County described as follows:

Beginning at the Bremer–Black Hawk County line at a point near the SW Corner of Section 36–T91N–R13W, Bremer County (NW Corner of Section 1–T90N–R13W, Black Hawk County); thence north following substantially the section line of Sections 36 and 25–T91N–R13W to the W  $\frac{1}{4}$  Corner SW  $\frac{1}{4}$  Section 25–T91N–R13W; thence northwesterly through Section 26–T91N–R13W to the south corporation line of Denver connecting with unnamed street.

Denver:

Beginning on unnamed street at the south corporation line; thence northwesterly, northerly and northeasterly to the north corporation line.

Beginning again at the north corporation line of Denver connecting with unnamed street: then northeasterly through Section 23–T91N–R13W to near W  $\frac{1}{4}$  Corner NW  $\frac{1}{4}$  Section 24–T91N–R13W; thence north following substantially the section line of Sections 24, 13, 12 (junction of Iowa 3) and 1–T91N–R13W continuing north following substantially the section line of Sections 36, 25, 24, 13, 12 (junction of Iowa 93) and 1–T92N–R13W continuing north following substantially the section line of Sections 36, 25 (junction of Iowa 188) 24, 13, 12 and 1–T93N–R13W to a point approximately 1,100 feet south of the NW Corner of Section 1–T93N–R13W; thence curving in a northeasterly direction to the Bremer–Chickasaw County line at a point approximately 1,100 feet east of the NW Corner of Section 1–T93N–R13W, Bremer County (SW Corner Section 36–T94N–R13W, Chickasaw County); thence east along the Bremer–Chickasaw County line to a point approximately 1,100 feet west of the NE Corner of Section 1–T93N–R13W, Bremer County (SE Corner of Section 36–T94N–R13W, Chickasaw County).

**OFFICIAL DESCRIPTION CHANGE**

**COUNTY:** Bremer

**ROUTE:** US 63

**STAFF ACTION NUMBER:** S-87-691

**APPROVAL DATE:** 12-18-86

New Description – US 63 and its extensions in Bremer County described as follows:

Beginning at the Bremer-Black Hawk County line at a point near the SW Corner of Section 36-T91N-R13W, Bremer County (NW Corner of Section 1-T90N-R13W, Black Hawk County); thence north following substantially the section line of Sections 36 and 25-T91N-R13W to the south corporation line of Denver connecting with State Street.

Denver:

Beginning on State Street at the south corporation line; thence north on State Street to the north corporation line.

Beginning again at the north corporation line of Denver connecting with State Street; thence north following substantially the section line of Sections 24, 13, 12, (junction Iowa 3), and 1-T91N-R13W continuing north following substantially the section line of Sections 36, 25, 24, 13, 12, (junction of Iowa 93), and 1-T92N-R13W continuing north following substantially the section line of Sections 36, 25 (junction of Iowa 188), 24, 13, 12, and 1-T93N-R13W to a point approximately 1,100 feet south of the NW Corner of Section 1-T93N-R13W; thence curving in a northeasterly direction to the Bremer-Chickasaw County line at a point approximately 1,100 feet east of the NW Corner of Section 1-T93N-R13W, Bremer County (SW Corner Section 36-T94N-R13W, Chickasaw County); thence east along the Bremer-Chickasaw County line to a point approximately 1,100 feet west of the NE Corner of

Section 1–T93N–R13W, Bremer County (SE Corner of Section 36–T94N–R13W, Chickasaw County).

**COMMISSION ORDER**

**DIVISION:** Planning & Research

**COMMISSION ORDER NUMBER:** PR–79–272

**SUBMITTED BY:** C.I. MacGillivray

**MEETING DATE:** 11–2–78

**DISCUSSION/BACKGROUND:**

Due to a review of the Primary Road System records, US 63 in Bremer County should be deleted and the new description should be officially included into the Primary System.

US 63 begins at the Bremer–Black Hawk County line approximately 1½ miles south of Denver and travels northerly through the City of Denver and intersecting with Iowa 3, 93, 188, and 334 curving northeasterly and thence northerly to the Chickasaw County line approximately 1½ miles north of Frederika.

**PROPOSAL/ACTION RECOMMENDATION:**

Locate US 63 and its extension in Bremer County as follows:

Beginning at the Bremer–Black Hawk County line at a point near the SW Corner of Section 36–T91N–R13W, Bremer County (NW Corner of Section 1–T90N–R13W, Black Hawk County); thence north following substantially the section line of Sections 36 and 25–T91N–R13W to the south corporation line of the City of Denver connecting with an unnamed street.

Denver:

Beginning on the south corporation line, connecting with an unnamed street; thence northerly to the north corporation line connecting with an unnamed street.

Beginning again at the north corporation line of Denver connecting with an unnamed street; thence northerly following substantially the section line of Sections 24, 13, 12, (junction Iowa 3), and 1-T91N-R13W continuing northerly following substantially the section line of Sections 36, 25, 24, 13, 12, (junction of Iowa 93), and 1-T92N-R13W continuing northerly following substantially the section line of Sections 36, 25 (junction of Iowa 188), 24, 13, 12, and 1-T93N-R13W to a point approximately 1,100 feet south of the NW Corner of Section 1-R93N-R13W; thence curving in a northeasterly direction to the Bremer-Chickasaw County line at a point approximately 1,100 feet east of the NW Corner of Section 1-93N-R13W, Bremer County (SW Corner Section 36-T94N-R13W, Chickasaw County thence east along the Bremer-Chickasaw County line to a point approximately 1,100 feet west of the NE Corner of Section 1-T93N-R13W, Bremer County (SE Corner of Section 36-T94N-R13W, Chickasaw County).

NOW, THEREFORE: Be it resolved that the Iowa Department of Transportation approve the location of US 63 in Bremer County, Iowa.

NOTE: To become effective upon the adoption of this resolution.

REVISED: 12-18-86

**COMMISSION ORDER**

**DIVISION:** Planning & Research

**SUBMITTED BY:** Raymond L. Kassel

**MEETING DATE:** 8-10-76

**DISCUSSION/BACKGROUND:**

Due to a review of the Primary Road System records, US 63 in Bremer County should be deleted and the new description should be officially included into the Primary System.

US 63 begins at the Bremer-Black Hawk line approximately 1 ½ miles south of Denver and travels northerly through the City of Denver and intersecting with Iowa 3, 93, 188, and 334 curving northeasterly and thence northerly to the Chickasaw County line approximately 1 ½ miles north of Frederika.

**PROPOSAL/ACTION RECOMMENDATION:**

Locate US 63 and its extensions in Bremer County as follows:

Beginning at the Bremer-Black Hawk County line at a point near the SW Corner of Section 36-T91N-R13W, Bremer County (NW Corner of Section 1-T90N-R13W, Black Hawk County); thence north following substantially the section line of Sections 36 and 25-T91N-R13W to the south corporation line of the City of Denver connecting with an unnamed street.

Denver:

Beginning on the south corporation line, connecting with an unnamed street; thence northerly to the north corporation line connecting with an unnamed street.

Beginning again at the north corporation line of Denver connecting with an unnamed street; thence northerly following substantially the section line of Sections 24, 13, 12 (junction of Iowa 3), and 1-T91N-R13W continuing northerly following substantially the section line of Sections 36, 25, 24, 13, 12, (junction of Iowa 93), and 1-T92N-R13W continuing northerly following substantially the section line of Sections 36, 25 (junction of Iowa 188), 24, 13, 12, and 1-T93N-R13W to a point approximately 1,100 feet south of the NW Corner of Section 1-R93N-R13W; thence curving in a northeasterly direction to the Bremer-Chickasaw County line at a point approximately 1,100 feet east of the NW Corner of Section 1-93N-R13W, Bremer County (SW Corner Section 36-T94N-R13W, Chickasaw County); thence east along the Bremer-Chickasaw County line to a point approximately 1,100 feet west of the NE Corner of Section 1-T93N-R13W, Bremer County (SE Corner of Section 36-T94N-R13W, Chickasaw County).

NOW THEREFORE: Be it resolved that the Iowa Department of Transportation approve the location of US 63 in Bremer County, Iowa.

NOTE: To become effective upon the adoption of this resolution.

#### **OFFICIAL DESCRIPTION CHANGE**

**COUNTY:** Bremer

**CITY OF:** Plainfield

**ROUTE:** Iowa 63

**APPROVAL DATE:** 05-25-38

Beginning at a point approximately 600 feet south of the NW Cor. of Sec. 12-T92-R13, thence curving in a northeasterly direction to a point



approximately 600 feet east of the NW Cor. of Sec. 12-T92-R13, thence east following substantially the section line to the west corporation line of the Town of Tripoli connecting with an unnamed street on the south line of Sec. 4-T92-R12.

Beginning again on the north corporation line of the Town of Tripoli, connecting with Main Street, thence north following substantially the section line to a point approximately 500 feet north of the SW Cor. of Sec. 27-T93-R12, thence in a northeasterly direction through Sec. 27-T93-R12, to a point approximately 1000 feet west of the NE cor. of Sec. 27-T93-R12, thence east following substantially the section line to the west corporation line of the Town of Sumner, connecting with First Street.

#### **OFFICIAL DESCRIPTION CHANGE**

**COUNTY:** Bremer

**APPROVAL DATE:** 4-14-37

#### Connecting Curves.

#### Junction of US 63 and Iowa 93:

Beginning at a point approximately 600 feet north of the SW Corner of Section 1-T92-R13; thence curving in a southeasterly direction to a point approximately 600 feet east of the SW Corner of Section 1-T91-R13.

#### **OFFICIAL DESCRIPTION CHANGE**

**COUNTY:** Bremer

**ROUTE:** US 63

**APPROVAL DATE:** 4-14-37

Connecting Curves.

Junction of Primary Road No. 10 and Primary Road No. US 63.

Beginning at a point approximately 600 feet west of the NE Cor. of Sec. 11-T91-R13, thence curving in a southeasterly direction to a point approximately 600 feet south of the NE Cor. of Sec. 11-T91-R13.

Beginning at a point approximately 600 feet west of the SE Cor. of Sec. 2-T91-R13, thence curving in a northeasterly direction to a point approximately 600 feet north of the SE Cor. of Sec. 2-T91-R13.

Beginning at a point approximately 600 feet east of the SW Cor. of Sec. 1-T91-R13, thence curving in a northwesterly direction to a point approximately 600 feet north of the SW Cor. of Sec. 1-T91-R13.

Beginning at a point approximately 600 feet east of the NW Cor. of Sec. 12-T91-R13, thence curving in a southwesterly direction to a point approximately 600 feet south of the NW Cor. of Sec. 12-T91-R13.

**OFFICIAL DESCRIPTION CHANGE**

**COUNTY:** Bremer

**ROUTE:** US 63

**APPROVAL DATE:** 4-14-37

Beginning on the Bremer-Black Hawk County line at a point near the SW Corner of Section 36-T91N-R13W, Bremer County (NW Corner of Section 1-T90N-R13W, Black Hawk County); thence north following substantially

the section line to the south corporation line of the Town of Denver, connecting with State Street.

Beginning again on the north corporation line of the Town of Denver, connecting with State Street; thence north following substantially the section line to a point approximately 1,100 feet south of the NW Corner of Section 1-T93N-R13W; thence curving in a northeasterly direction to the Bremer-Chickasaw County line at a point approximately 1,100 feet east of the NW Corner of Section 1-T93N-R13W, Bremer County (SW Corner Section 36-T94N-R13W, Chickasaw County); thence east along the Bremer-Chickasaw County line to a point approximately 1,100 feet west of the NE Corner of Section 1-T93N-R13W, Bremer County (SE Corner of Section 36-T94N-R13W, Chickasaw County).

#### **OFFICIAL DESCRIPTION CHANGE**

**COUNTY:** Bremer

**CITY OF:** Denver

**ROUTE:** US 63

**APPROVAL DATE:** 2-5-36

Commencing on State Street at the south corporation line; thence northerly on State Street to the north corporation line.