

OFFICIAL DESCRIPTION CHANGE

OFFICE: Research and Analytics

EFFECTIVE DATE: 8-22-2019

COUNTY: Story

ROUTE: US 69

ENTERED BY: Paul Mauer

ENTERED DATE: 12-23-2019

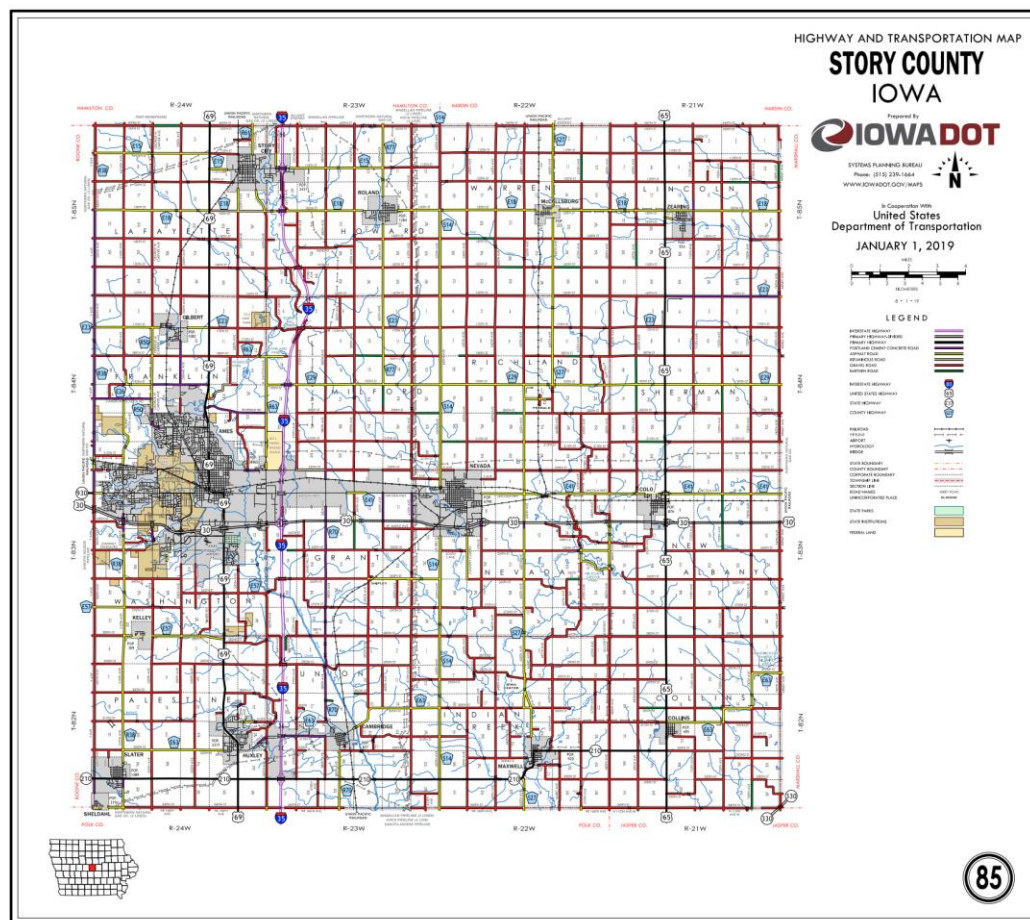

New Description – US 69 and its extensions in Story County described as follows:

Beginning on the Story-Polk County line at a point near the SW Corner Section 36-T82N-R24W, Story County (NW Corner Section 1-T81N-R24W, Polk County);

thence north following substantially the section line of Sections 36 (junction Iowa 210) and 25–T82N–R24W to the south corporation line of Huxley.

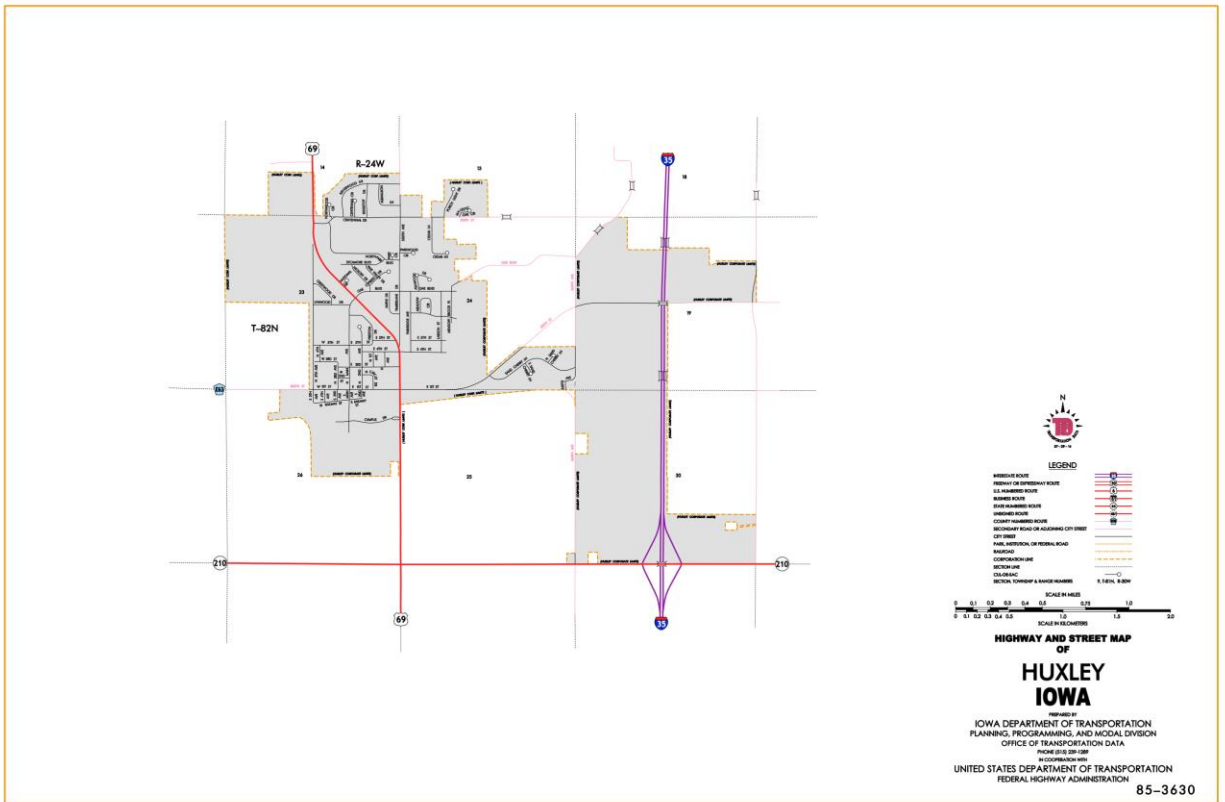

Huxley:

Beginning at the south corporation line; thence north and northwest on said to the north corporation line.

Beginning again at the north corporation line of Huxley; thence north through Section 14–T82N–R24W to a point approximately 200 feet north of the center of Section 14–T82N–R24W; thence northeast and northwest through Sections 14 and 11–T82N–R24W to a point approximately 700 feet north of the center of Section 11–T82N–R24W; thence north following substantially the center section line through Sections 11 and 2–T82N–R24W and Sections 35, 26 and 23–T83N–R24W to the south corporation line of Ames, connecting with South Duff Avenue.

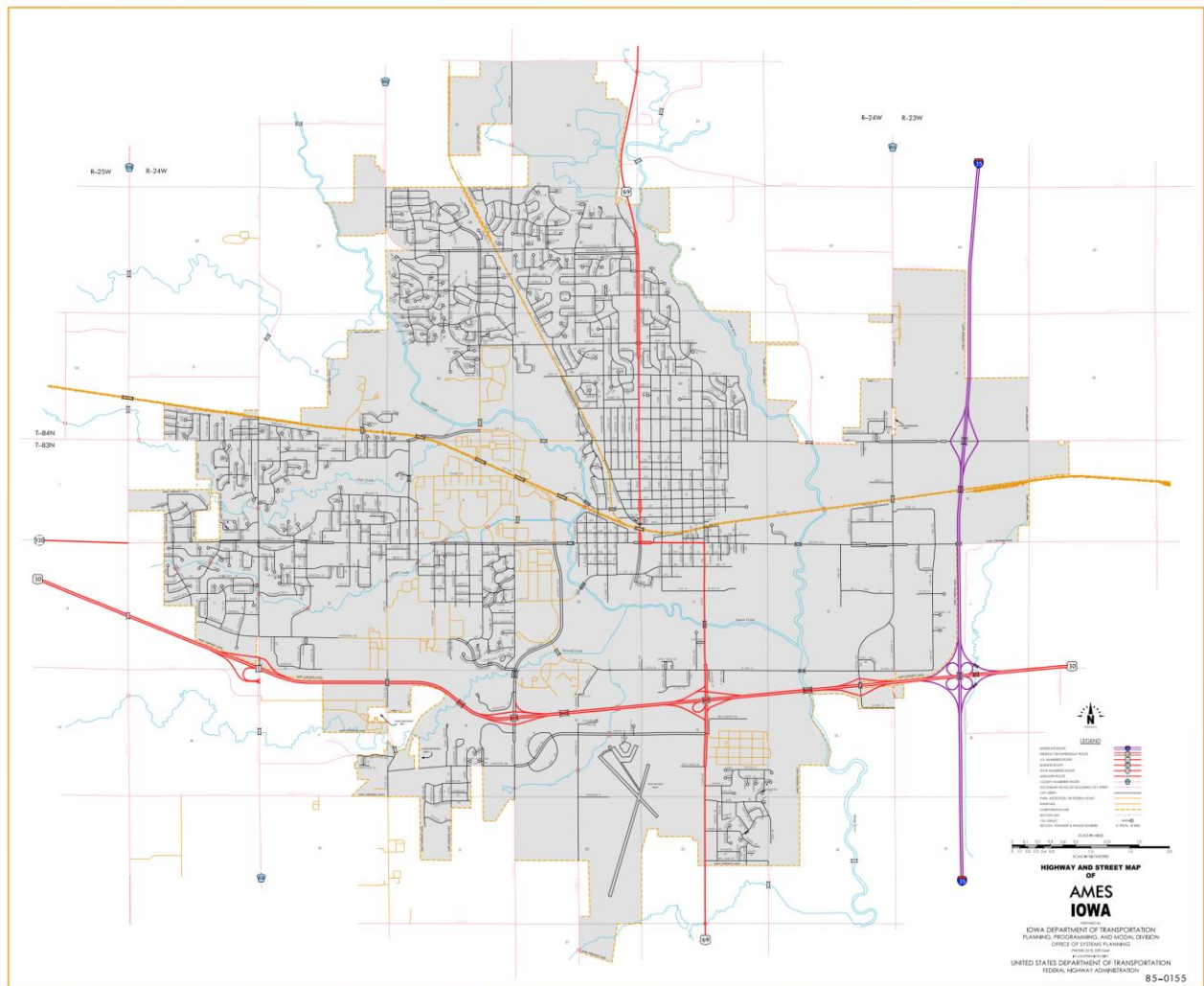

Ames:

Beginning on South Duff Avenue at the south corporation line; thence north on South Duff Avenue to Lincoln Way; thence west on Lincoln Way to Grand Avenue; thence north on Grand Avenue to the north corporation line. Beginning again on the north corporation line of Ames connecting with Grand Avenue; thence in a northwesterly, northerly and northeasterly direction through Section 27 and 22-T84N-R24W to a point approximately 200 feet south of the NE Corner Section 22-T84N-R24W; thence north following substantially the section line of Sections 22, 14, 11 and 2-T84N-R24W and Sections 35, 26, 23, 14, 11 and 2-T85N-R24W to the Story-Hamilton County

line at a point near the NE Corner Section 3–T85N–R24W, Story County (SE Corner Section 34–T86N–R24W, Hamilton County).

OFFICIAL DESCRIPTION CHANGE

County: Story

ROUTE: US 69

STAFF ACTION NUMBER: S–87–1510

APPROVAL DATE: 5–13–87

New Description – US 69 and its extensions in Story County described as follows:

Beginning on the Story–Polk County line at a point near the SW Corner Section 36–T82N–R24W, Story County (NW Corner Section 1–T81N–R24W, Polk County); thence north following substantially the section line of Sections 36 (junction Iowa 210) and 25–T82N–R24W to the south corporation line of Huxley, connecting with an unnamed street.

Huxley:

Beginning on an unnamed street at the south corporation line; thence north and northwest on said unnamed street to the north corporation line.

Beginning again on the north corporation line of Huxley connecting with an unnamed street; thence in a northwesterly direction through Section 23–T82N–R24W to a point approximately 500 feet south of the N $\frac{1}{4}$ Corner Section 23–T82N–R24W; thence north through Sections 23 and 14–T82N–R24W to a point approximately 200 feet north of the center of Section 14–T82N–R24W; thence northeast and northwest through Sections 14 and 11–T82N–R24W to a point approximately 700 feet north of the center of Section 11–T82N–R24W; thence north following substantially the center section line through Sections 11 and 2–T82N–R24W and Sections 35, 26 and 23–T83N–R24W to the south corporation line of Ames, connecting with South Duff Avenue.

Ames:

Beginning on South Duff Avenue at the south corporation line; thence north on South Duff Avenue to Lincoln Way; thence west on Lincoln Way to Grand Avenue; thence north on Grand Avenue to the north corporation line.

Beginning again on the north corporation line of Ames connecting with Grand Avenue; thence in a northwesterly, northerly and northeasterly direction through Section 27 and 22-T84N-R24W to a point approximately 200 feet south of the NE Corner Section 22-T84N-R24W; thence north following substantially the section line of Sections 22, 14, 11 and 2-T84N-R24W and Sections 35, 26, 23, 14, 11 and 2-T85N-R24W to the Story-Hamilton County line at a point near the NE Corner Section 3-T85N-R24W, Story County (SE Corner Section 34-T86N-R24W, Hamilton County).

COMMISSION ORDER

DIVISION: Planning & Research

COMMISSION ORDER NUMBER: PR-79-272

SUBMITTED BY: C.I. MacGillivray

MEETING DATE: 11-2-78

TITLE: US 69, Story County, Iowa

DISCUSSION/BACKGROUND:

US 69 begins on the Story-Polk County line approximately 2 miles south of Huxley, and travels generally northerly via Huxley and Ames to the Story-Hamilton County line approximately 2 miles northwest of Story City.

Due to a review of our Primary Road System Records US 69 in Story County should be deleted and the new description added should be officially included into the Primary System.

PROPOSAL/ACTION RECOMMENDATION:

It is recommended that the old description of US 69 in Story County be deleted and the new description, as referred in the attached detailed description, be included in the Primary Road System effective upon the adoption of this resolution.

Locate US 69 and its extensions in Story County as follows:

Beginning on the Story–Polk County line at a point near the SW Corner Section 36–T82N–R24W, Story County (NW Corner Section 1–T81N–R24W, Polk County); thence north following substantially the section line of Sections 36 and 25–T82N–R24W to the south corporation line of the City of Huxley, connecting with an unnamed street.

Huxley:

Beginning on an unnamed street at the south corporation line; thence northerly and northwesterly on said unnamed street to the north corporation line.

Beginning again on the north corporation line of the City of Huxley connecting with an unnamed street; thence in a northwesterly direction through Section 23–T82N–R24W to a point approximately 500 feet south of the N $\frac{1}{4}$ Corner Section 23–T82N–R24W; thence northerly through Sections 23 and 14–T32N–R24W to a point approximately 200 feet north of the center of Section 14–T82N–R24W; thence northeasterly and northwesterly through Sections 14 and 11–T82N–R24W to a point approximately 700 feet north of the center of Section 11–T82N–R24W; thence northerly following substantially the center section line through Sections 11 and 2–T82N–R24W and Sections 35, 26, and 23–T83N–R24W to the south corporation line of the City of Ames connecting with an unnamed street.

Ames:

Beginning on the south corporation line connecting with an unnamed street; thence northerly, westerly and northerly to the north corporation line connecting with an unnamed street.

Beginning again on the north corporation line of the City of Ames connecting with an unnamed street; thence in a northwesterly, northerly and northeasterly direction through Section 27 and 22–T84N–R24W to a point approximately 200

feet south of NE Corner Section 22-T84N-R24W; thence north following substantially the section line of Sections 22, 14, 11, and 2-T84N-R24W and Sections 35, 26, 23, 14, 11, and 2-T85N-R24W to the Story-Hamilton County line at a point near the NE Corner Section 3-T85-R24W, Story County (SE Corner Section 34-T86N-R24W, Hamilton County).

REVISED: 5-13-87

COMMISSION RESOLUTION

DIVISION: Planning & Research

COMMISSION ORDER NUMBER: 73-804

SUBMITTED BY: Gene R. Mills

MEETING DATE: 6-27-73

TITLE: Approving the Location of US 69 and its Extensions in Story County

Locate US 69 and Extensions in Story County, Iowa, as follows:

Beginning on the Story-Polk County line at a point near the SW Corner Section 36-T82N-R24W, Story County (NW Corner Section 1-T81N-R24W, Polk-County) thence north following substantially the section line through sections 36 and 25-T82N-R24W to the south corporation of the Town of Huxley, connecting with an unnamed street.

Huxley:

Beginning on an unnamed street at the south corporation line; thence northerly and northwesterly on said unnamed street to the north corporation line.

Beginning again on the north corporation line of the town of Huxley connecting with an unnamed street; thence in a northwesterly direction to a point approximately 500 feet south of the N $\frac{1}{4}$ Corner Section 23-T82N-R24W;

thence north to a point approximately 200 feet north of the center of section 14-T82N-R24W; thence in a northeasterly direction through Section 11-T82N-R24W, to a point approximately 700 feet north of the center of section 11-T82N-R24W; thence north following substantially the quarter section line to the south corporation line of the City of Ames connecting with Duff Avenue.

Ames:

Beginning on Duff Avenue at the south corporation line; thence northerly on Duff Avenue to Lincoln Way; thence westerly on Lincoln Way to Grand Avenue; thence northerly on Grand Avenue to the north corporation line.

Beginning again on the north corporation line of the City of Ames connecting with Grand Avenue; thence north following substantially the section line to a point near the E $\frac{1}{4}$ Corner Section 27-T84-R24W; thence in a northwesterly, northerly and northeasterly direction through Sections 27 and 22-T84N-R24W to a point approximately 200 feet south of the NE Corner Section 22-T84N-R24W; thence north following substantially the section line to the Story-Hamilton County line at a point near the NE Corner Section 3-T85N-R24W, Story County (SE Corner Section 34-T86N-R24W, Hamilton County).

NOW, THEREFORE: Be it resolved that the Iowa State Highway Commission approve the location of US 69 and its extensions in Story County, Iowa.

OFFICIAL DESCRIPTION CHANGE

County: Story

ROUTE: US 69

APPROVAL DATE: 11-14-56

Beginning on the Story-Polk County line at a point near the SW Corner Section 36-T82N-R24W, Story County (NW Corner Section 1-T81N-R24W, Polk County) thence north following substantially the section line to the south corporation line of the Town of Huxley, connecting with an unnamed street at a point near the W $\frac{1}{4}$ Corner Section 25-T82N-R24W.

Beginning again on the north corporation line of the Town of Huxley, connecting with an unnamed street at a point approximately $\frac{1}{4}$ mile east of the center of Section 23-T82N-R24W; thence in a northwesterly direction to a point approximately 500 feet south of the N $\frac{1}{4}$ Corner Section 23-T82N-R24W; thence north to a point approximately 200 feet north of the center of Section 14-T82N-R24W; thence in a northeasterly direction through Section 14-T82N-R24W, and in a northwesterly direction through Section 11-T82N-R24W, to a point approximately 700 feet north of the center of Section 11-T82N-R24W; thence north following substantially the quarter section line to the south corporation line of the City of Ames, connecting with Duff Avenue.

Beginning again on the north corporation line of the City of Ames connecting with Grand Avenue; thence north following substantially the section line to a point near the east Corner Section 27-T84N-R24W; thence in a northwesterly, northerly and northeasterly direction through Section 27 and 22-T84N-R24W to a point approximately 200 feet south of the Northeast Corner Section 22-T84N-R24W; thence north following substantially the section line to the Story-Hamilton County line at a point near the NE Corner Section 3-T85N-R24W Story County (SE Corner Section 34-T86N-R24W Hamilton County).

OFFICIAL DESCRIPTION CHANGE

County: Story

CITY OF: Huxley

ROUTE: US 69

APPROVAL DATE: 4-14-37

Commencing on unnamed Street at the south corporation line at the W $\frac{1}{4}$ corner of Section 25-T82N-R24W; thence northerly and northwesterly on unnamed Street to the north corporation line at a point near the center of the E $\frac{1}{2}$ of Section 23-T82N-R24W.

OFFICIAL DESCRIPTION CHANGE

County: Story

APPROVAL DATE: 4-14-37

CONNECTING CURVES

Junction of US 69 and Iowa 1197

Beginning at a point approximately 200 feet north of the W $\frac{1}{4}$ Corner Section 11-T85N-R24W; thence curving in a southeasterly direction to a point approximately 200 feet east of the W $\frac{1}{4}$ Corner Section 11-T85N-R24W.

REMOVED

OFFICIAL DESCRIPTION CHANGE

County: Story

CITY OF: Ames

ROUTE: US 69

APPROVAL DATE: 2-5-36

Commencing on Duff Avenue at the south corporation line; thence northerly on Duff Avenue to Lincoln Way; thence westerly on Lincoln Way to Grand Avenue; thence northerly on Grand Avenue to the north corporation line.